



kreon projects catalogue

"Beauty is not the result of adding more details, but rather the art of removing the last"

A luminaire, with its ability to reflect and seamlessly integrate into the purest architectural form, serves to enrich and enhance its surroundings. To achieve this, a profound comprehension of the intrinsic nature and unified components of architectural styles is indispensable. Our primary objectives lie in achieving optimal luminance and illumination. Embodying a mindset of reduction, the design of our collection distills each product to its essential components without compromise. These components are then harnessed into elemental forms, skillfully employed within kreon's creations. In this design philosophy, the minutiae of an object go beyond mere adornment, playing a pivotal role in defining the product's very essence.

kreon's products, even in their most simplified state, transcend austere minimalism and instead become architectural marvels that engage in a harmonious dialogue with space, irrespective of the style. This meticulous approach, combined with careful planning, epitomizes the true essence of 'architectural lighting'.

Apart from its architectural product line, kreon extends its offerings to include a series of products with a more decorative appeal. However, even in these designs, the fundamental essence remains rooted in architecture. The core principles of 'unity in design, simplicity in techniques, and precision in detail' are ever-present. These exceptional products can be discovered within the kreon oran series, kreon up glass, and kreon esprit. Notably, these ranges seamlessly complement kreon's architectural product collections, allowing for a perfect integration of styles.

kreon's light purity empowers you to craft the conditions wherein the beauty of architecture gracefully emerges.

- Kristof Pycke, Art Director

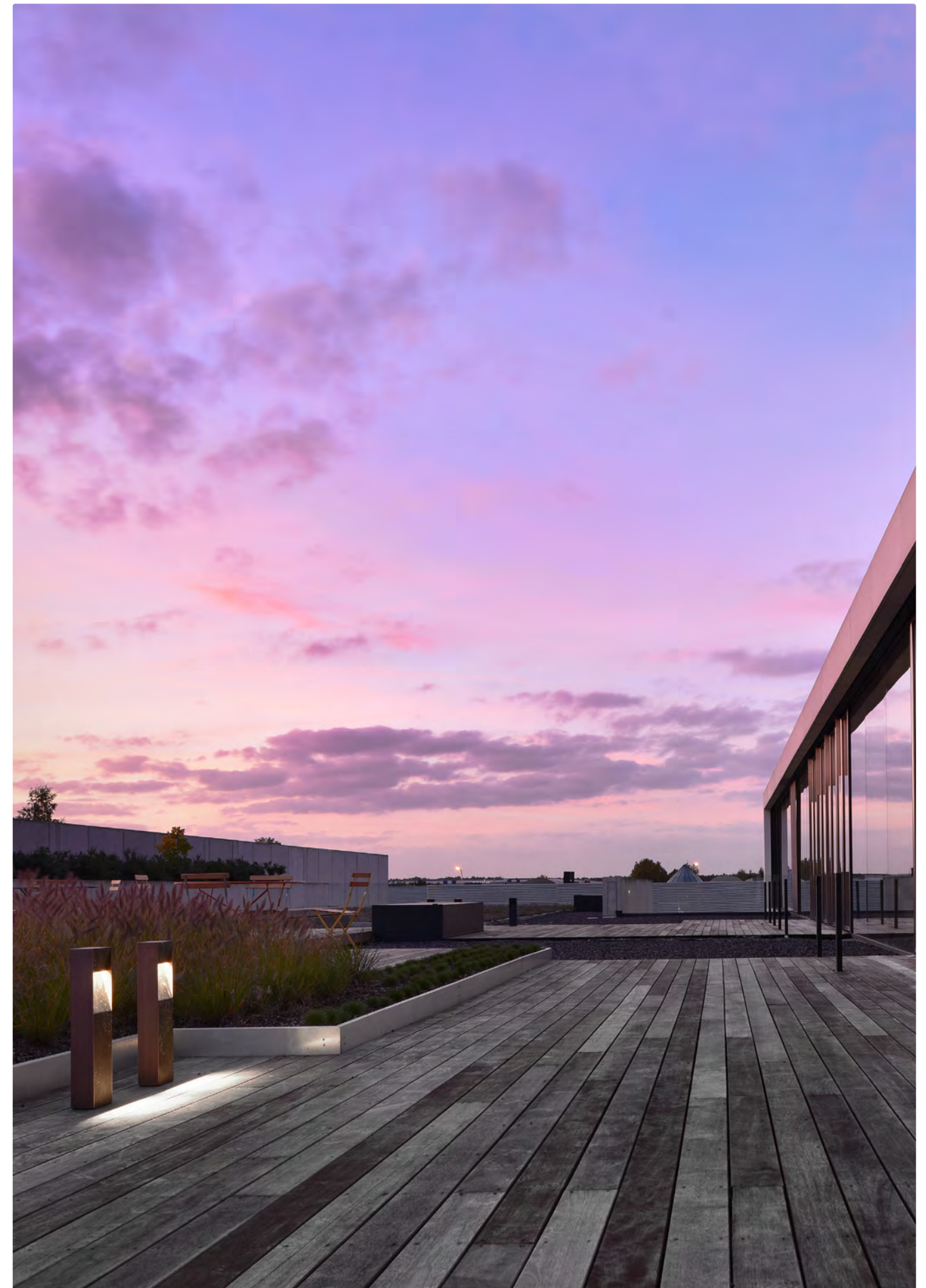

Welcome to the new **kreon tools of light projects catalogue**, your gateway to the mesmerizing **#worldofkreon**! This catalogue has been meticulously curated to ignite your imagination, whether you're an architect, interior designer, passionate about architecture, or simply someone with ambitious renovation or construction plans.

At kreon, we understand the profound impact that the right lighting can have on the atmosphere and functionality of any space. Our extensive collection of lighting solutions, ranging from downlights to uplights, sidelights to pendant lights and versatile profile systems, is designed to cater to every lighting need. Whether your project is residential, hospitality, retail, or anything in between, we are equipped to deliver the perfect lighting plan to enhance your vision.

In the pages that follow, we proudly present a handpicked selection of finished projects from across the globe, showcasing the remarkable synergy between form and function achieved through kreon's lighting solutions. Each project is a testament to our commitment to pushing the boundaries of design and innovation in the world of lighting.

For those seeking detailed technical information about our products, the **kreon tools of light technical catalogue** is readily available for download as a PDF on our website. It serves as a valuable resource to support your lighting journey, offering in-depth insights into the specifications and capabilities of our lighting fixtures.

As you explore this catalogue, we hope it inspires you, leaving you with a profound appreciation for the transformative power of light in architecture. Welcome to the **#worldofkreon**, where every project is illuminated by the perfect balance of artistry and technology.

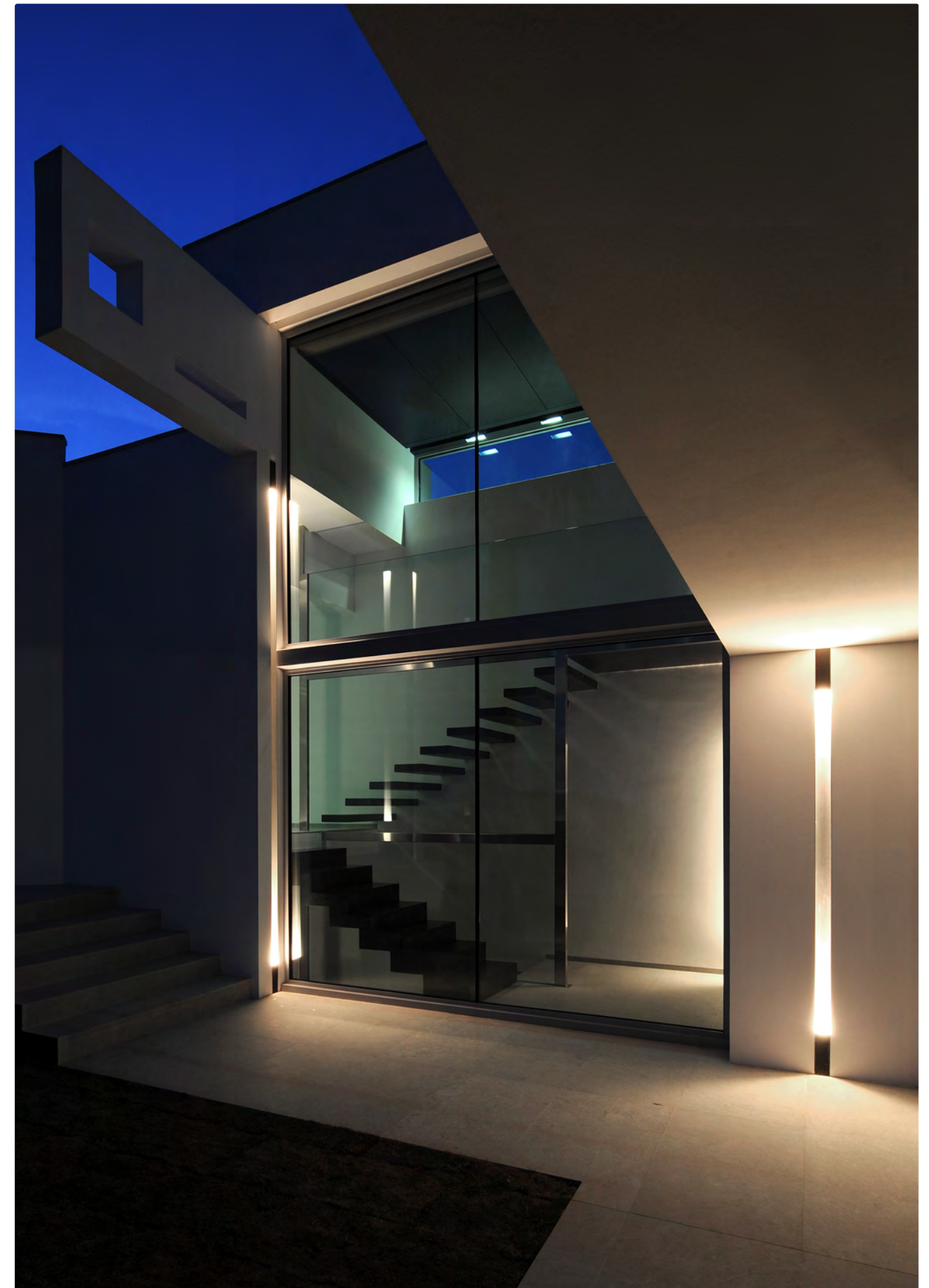

kreon latest additions

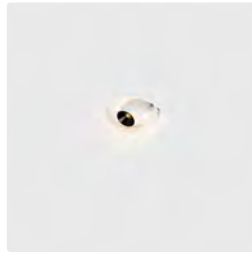

kreon inti

kreon inti is a fully recessed downlight with a refined patented optical system. kreon inti is available as a fixed downlight or as a directional spotlight.

The unique combination of a diffused downlight with a directional projector make kreon inti a two-in-one recessed ceiling luminaire.

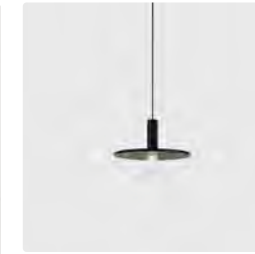

kreon oran glass

kreon oran pendant glass, a collection of highly elegant pendant luminaires, comes in 4 different stylish glass shapes all with or without lampshade. Each model consists of a subtle combination of clear simply shaped glass bodies with diffusing sandblasted accents.

kreon down in-line 60

kreon down in-line 60 is a new range of square shaped recessed downlights with an aperture of 60mm.

Equipped with the latest high performance faceted reflector in a fixed downlight or wallwash luminaire they offer optimal efficiency and uniformity.

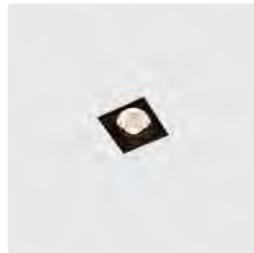

kreon kagi pendant

kreon kagi is an innovative profile system combining linear and accent lighting. The basic 24V profile, initially available as a recessed or surface mounted profile can now be installed as a pendant profile luminaire.



kreon holon 40 gearbox

kreon holon 40 gearbox allows you to make a 230V surface mounted connection. This means the product can be perfectly integrated into any project, whether it's a new construction or a renovation project.

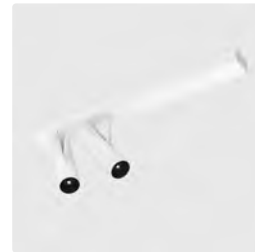

kreon kagi gearbox

The kreon kagi product family expands with kreon kagi gearbox. This gearbox is an extension to the kreon kagi range and allows you to make a 230V surface mounted connection.

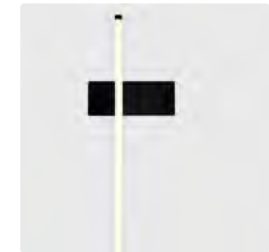

kreon holon 60

kreon holon is a range of surface mounted, recessed mounted, track mounted and pendant cylindrical downlights characterised by its compact form and deep set LED position. The range now becomes available with a diameter of 60mm, filling the gap between the already existing kreon holon dimensions.

With a choice of fixed or directional units, kreon holon 60 can provide a discreet yet functional solution to general or accent lighting within architecture.



kreon holon 60 deco

kreon holon 60 deco is the latest addition to the kreon holon 60 family.

With its matte acrylic glass terminal, this beauty creates a soft, subtle 360° halo effect, casting a diffused ambient light.



Recessed downlights
14

aplis



aplis in-line

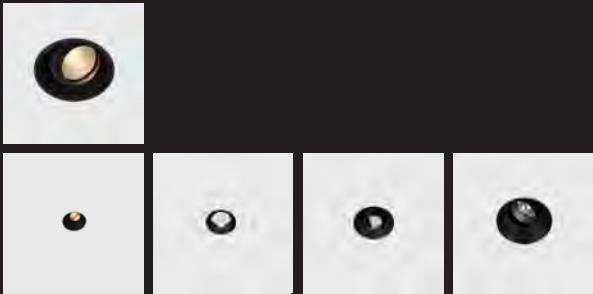

ato



ato in-line



down



down in-line

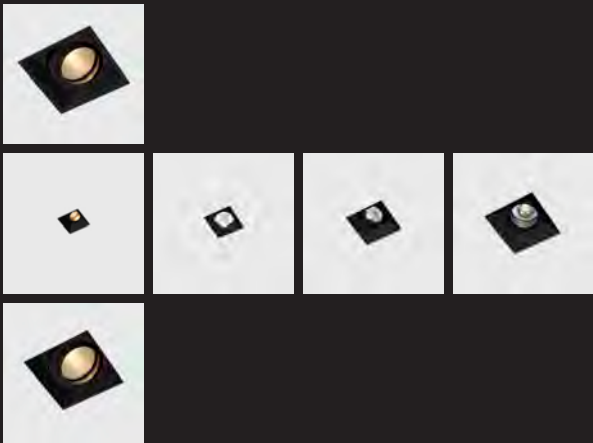

Ceiling luminaires
68

inti

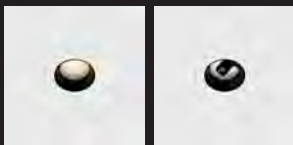

oran in-line

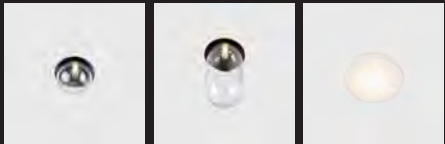

up



diapason



erubo



holon



nuit



prologe



stripe



up

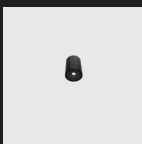

Wall luminaires
102

erubo



holon



onn-wall

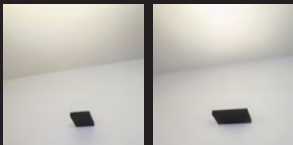

oran

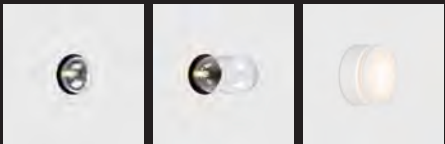

rokko

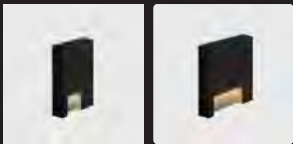

side

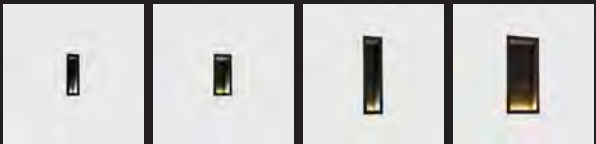

side in-line

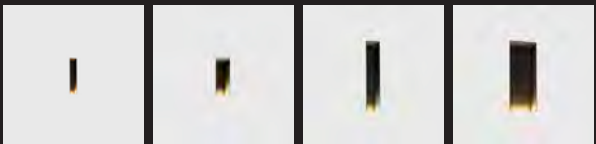

up



wabi wall



Pendant luminaires
130

cadre



esprit

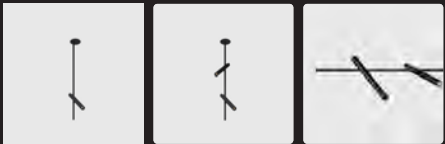

fuga

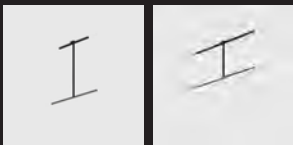

holon

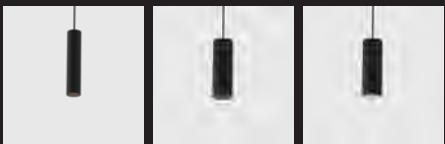

oran

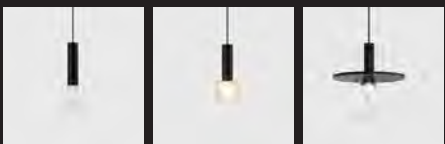

Recessed floor
luminaires
160

up

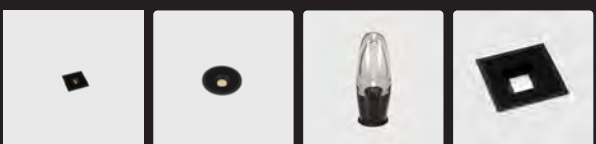

up in-line



Free standing
luminaires
172

esprit



Profile systems
182

cana



dolma



kagi

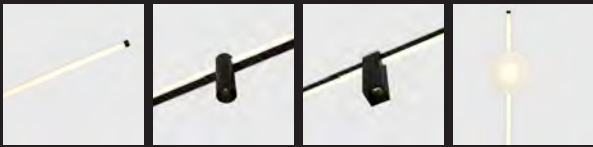

lini



nuît



prologe



rei



Desk lighting
222

esprit desk

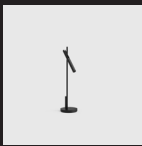

oran object

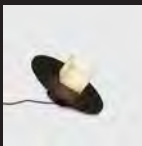

Outdoor lighting
228

raga



rokko



up



up in-line



wabi



Track systems &
projectors
266

48V track



3~230V track



kreon recessed downlights

kreon offers a wide range of downlights to suit the most precise and demanding applications. All kreon downlights are precision engineered and finished to the highest standards, and utilise quality components and electronics. All products in the range are available in black or white paint finish as standard. In addition to various recessed downlights series, we also provide standard special finishes, including copper, chrome, gold, and more. These finishes add a touch of uniqueness and elegance to the kreon downlights, allowing customers to personalize and tailor their choices to suit their preferences and design needs. Our downlights are available in five sizes from 40mm up to 165mm visual aperture dimension in both square and circular formats. Options for fixed, directional or wall wash light distributions are available along with a choice of LED colour temperature, lumen output and colour rendering index. Trims can be minimal overlap or invisible plaster-in for optimum integration.

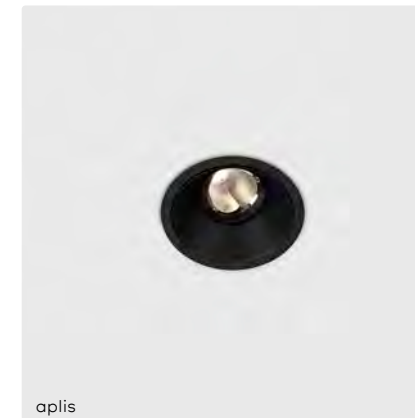

aplis

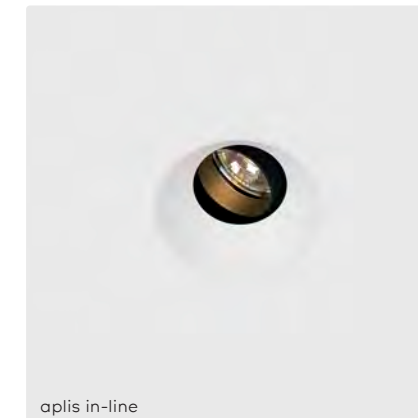

aplis in-line

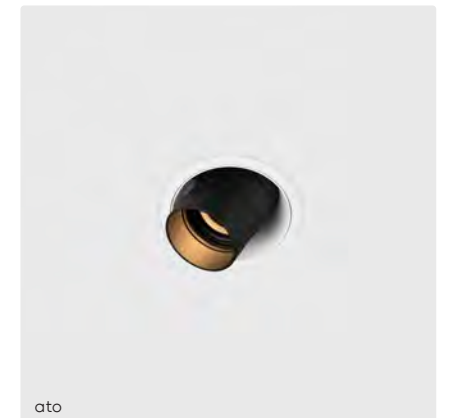

ato

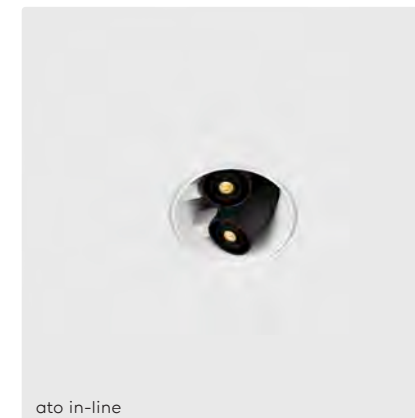

ato in-line



down

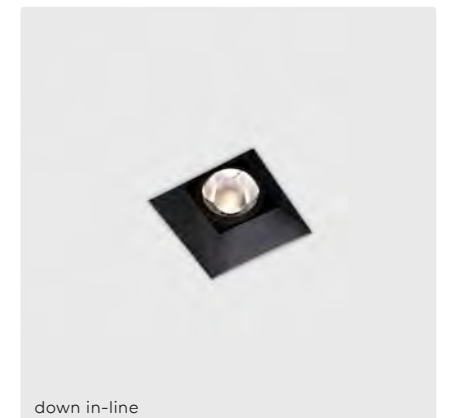

down in-line

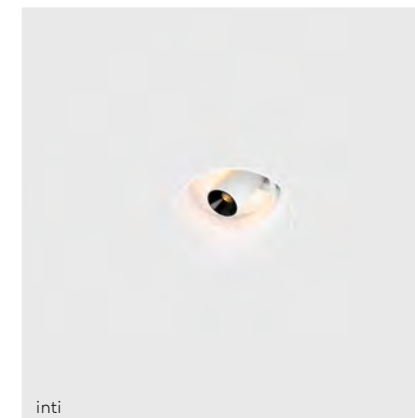

inti

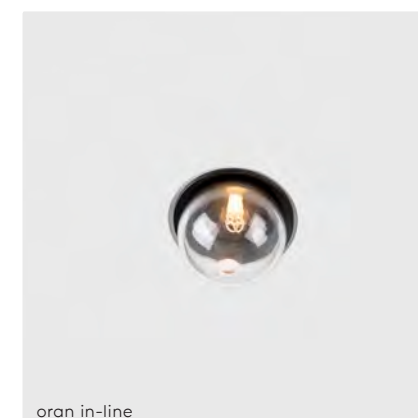

oran in-line















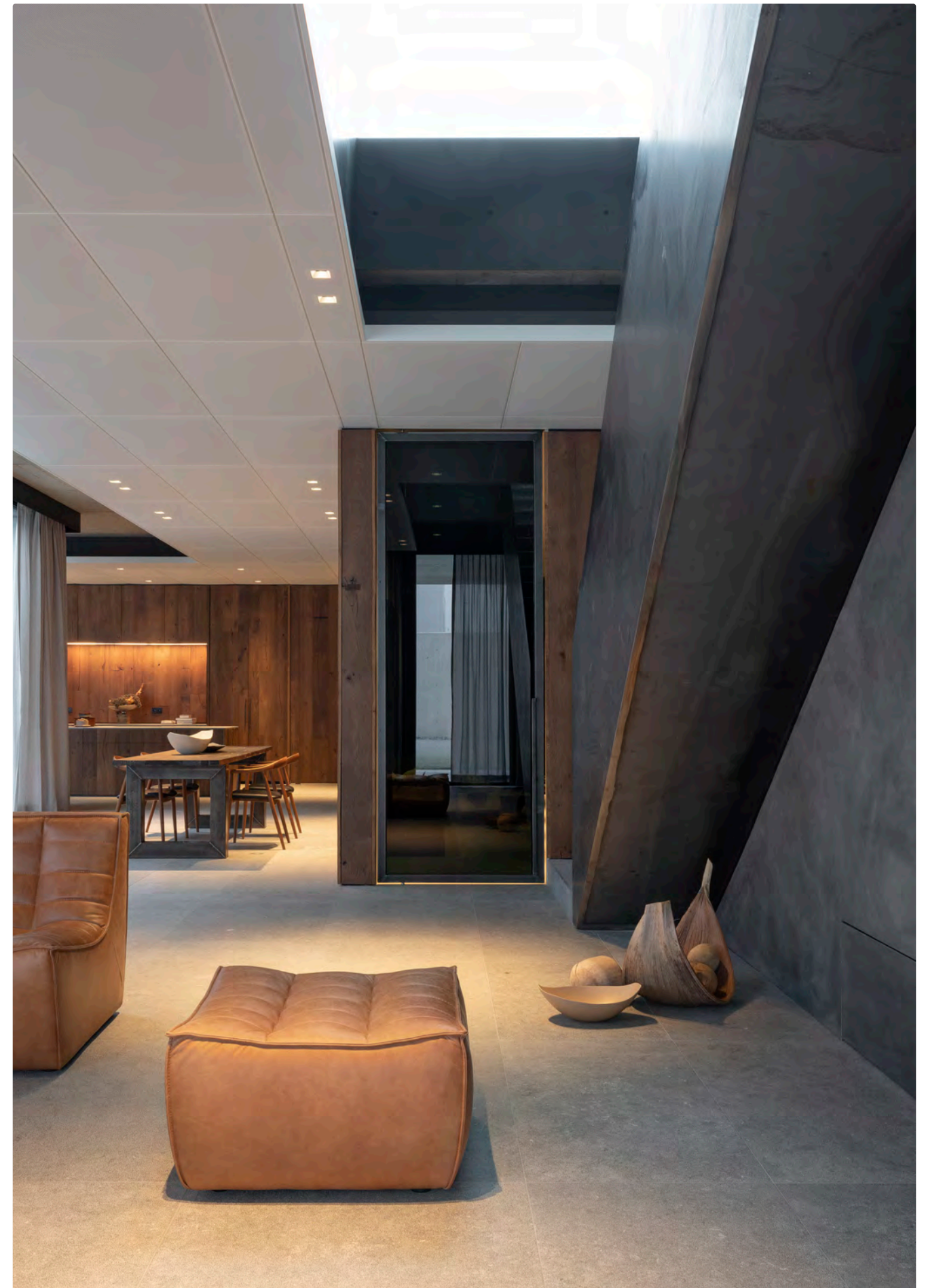



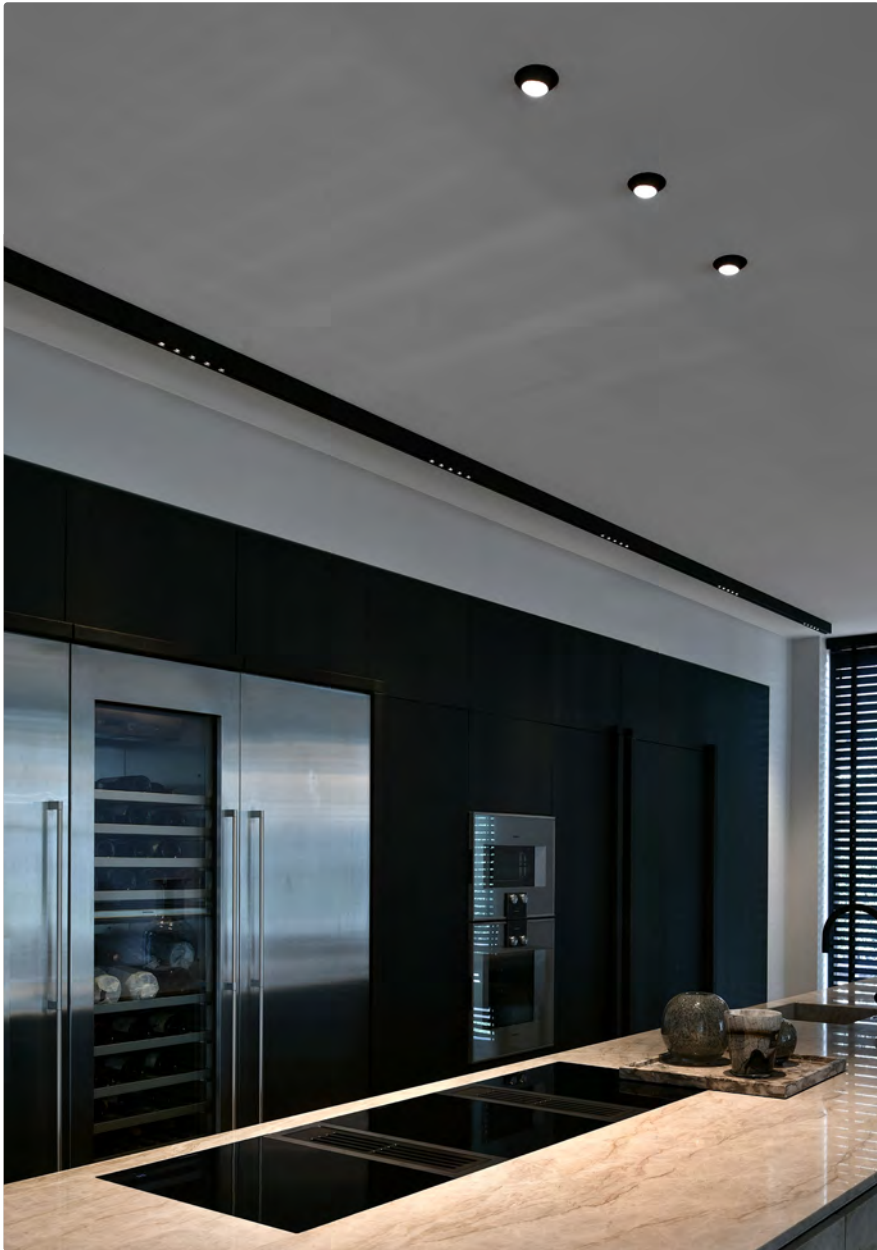











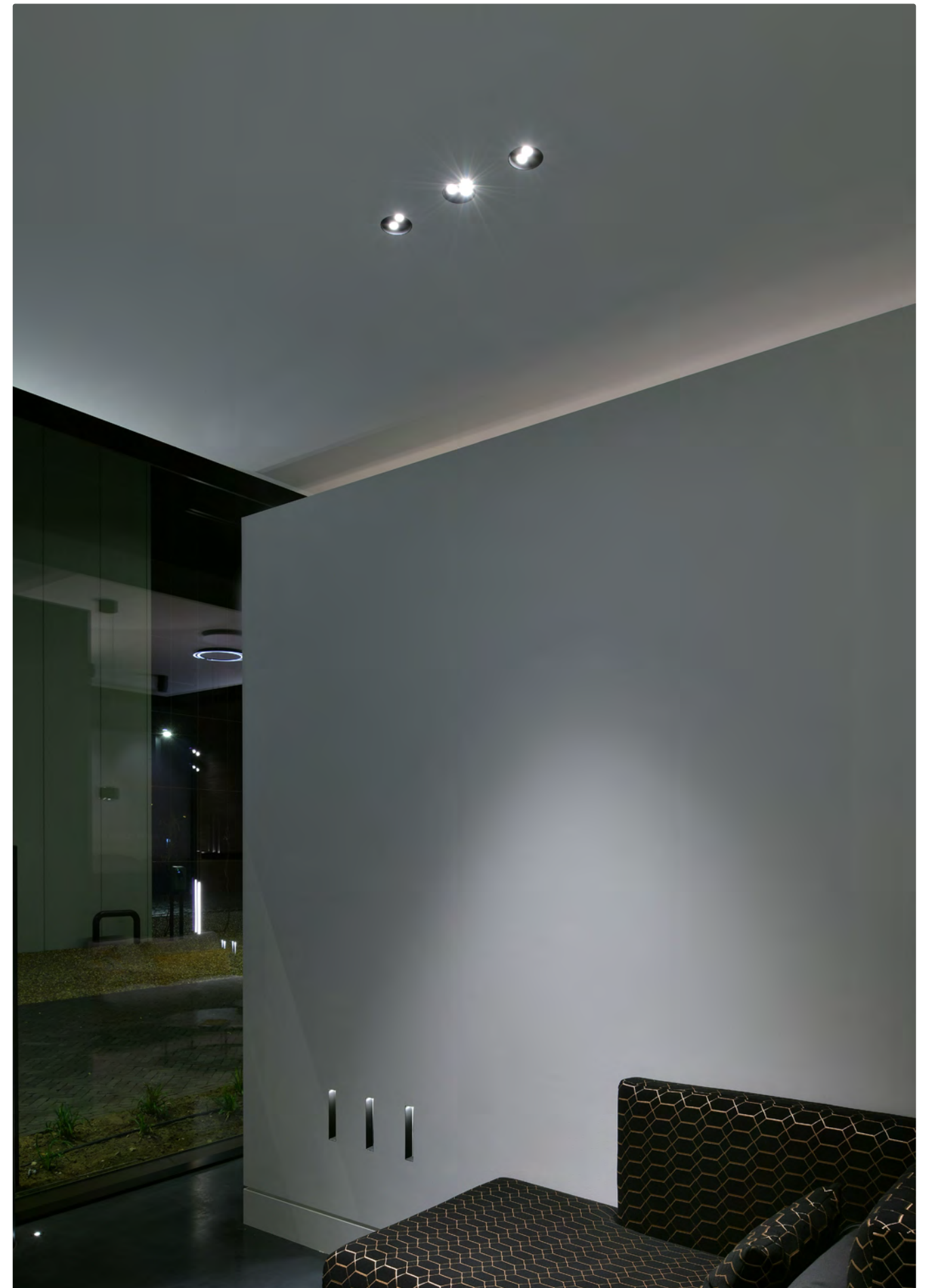







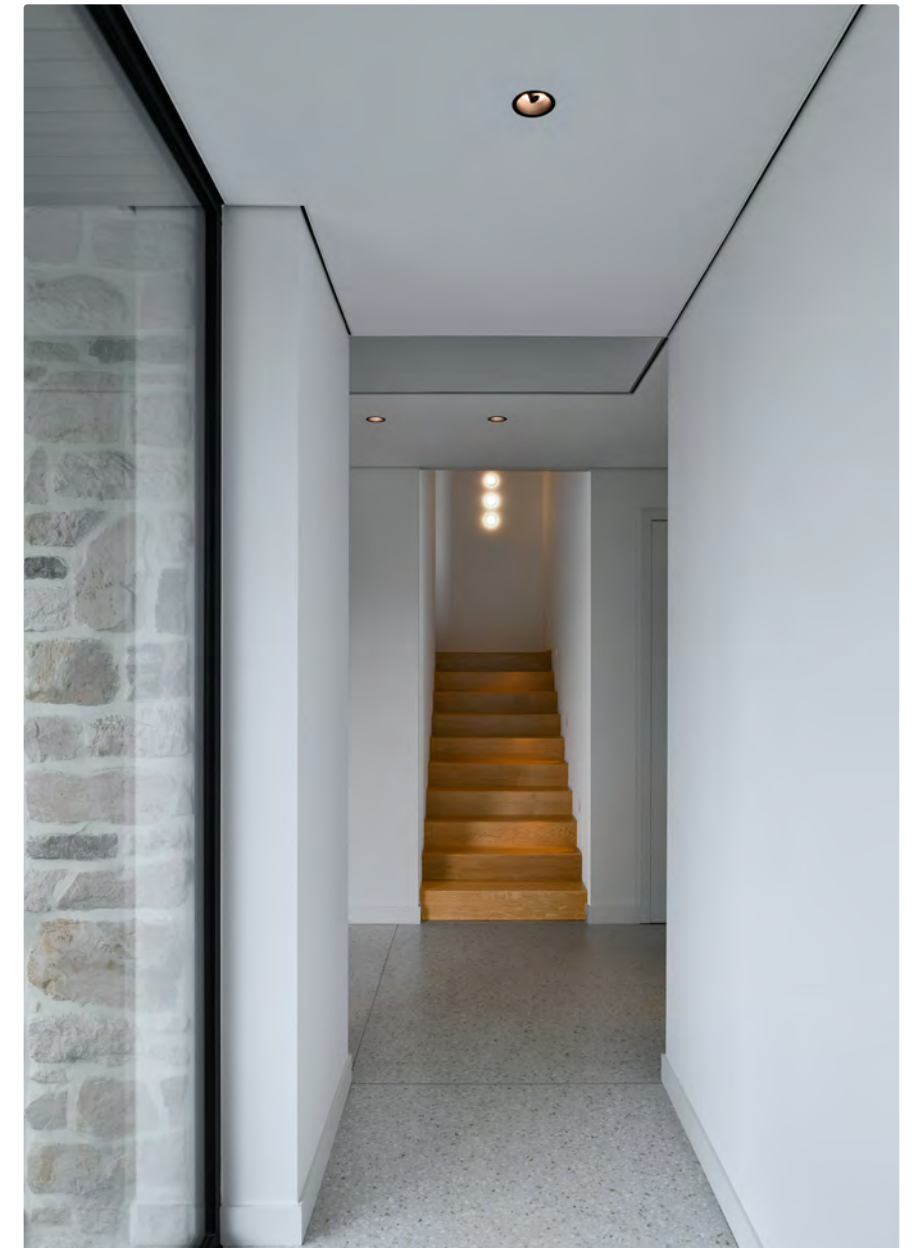



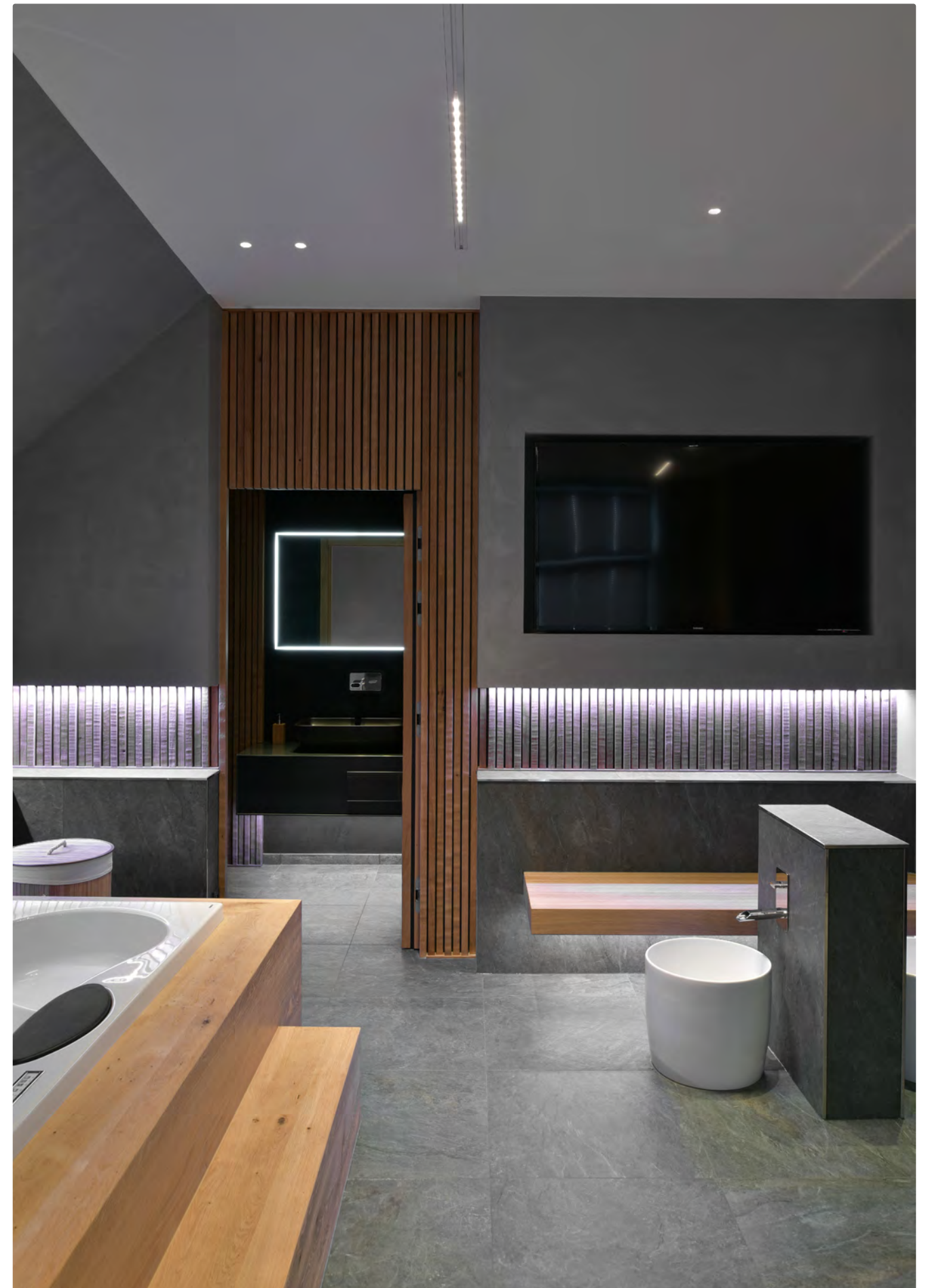

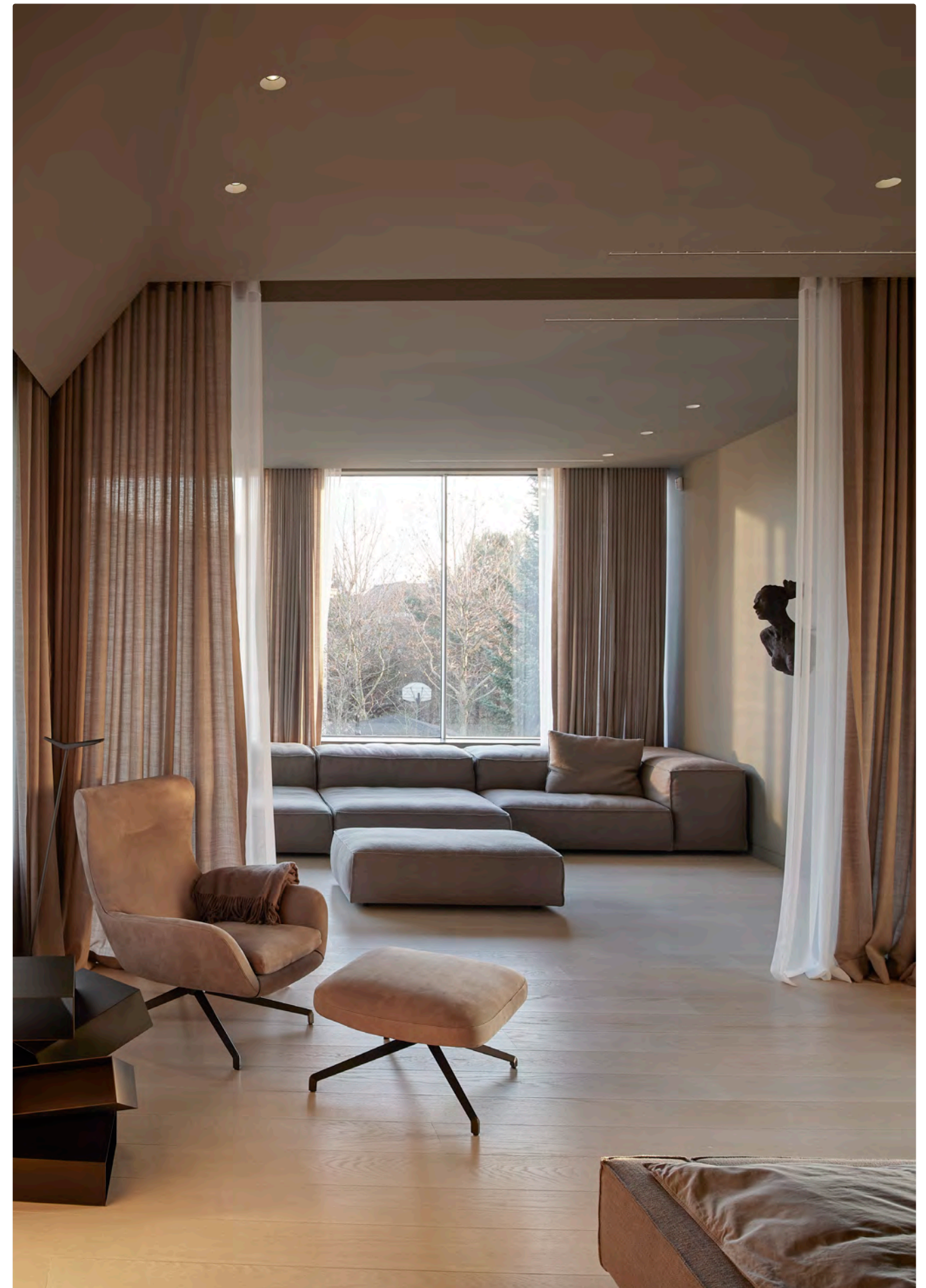







kreon ceiling luminaires

kreon ceiling luminaires are precision engineered and are meticulously crafted to meet the most exacting standards. These luminaires incorporate premium components and cutting-edge electronics. Our product lineup includes standard black or white paint finishes, with a variety of sizes in both cylindrical and cubic designs to choose from. If you desire alternative colour options, please feel free to inquire about our special request offerings.



diapason



erubo



holon



nuit

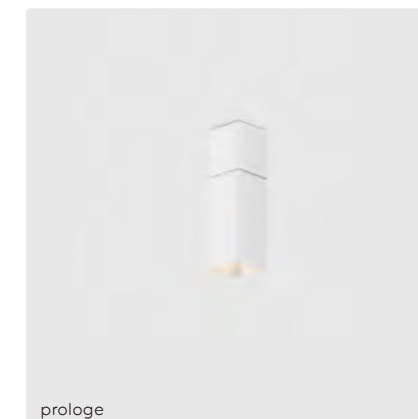

prologe



stripe



up









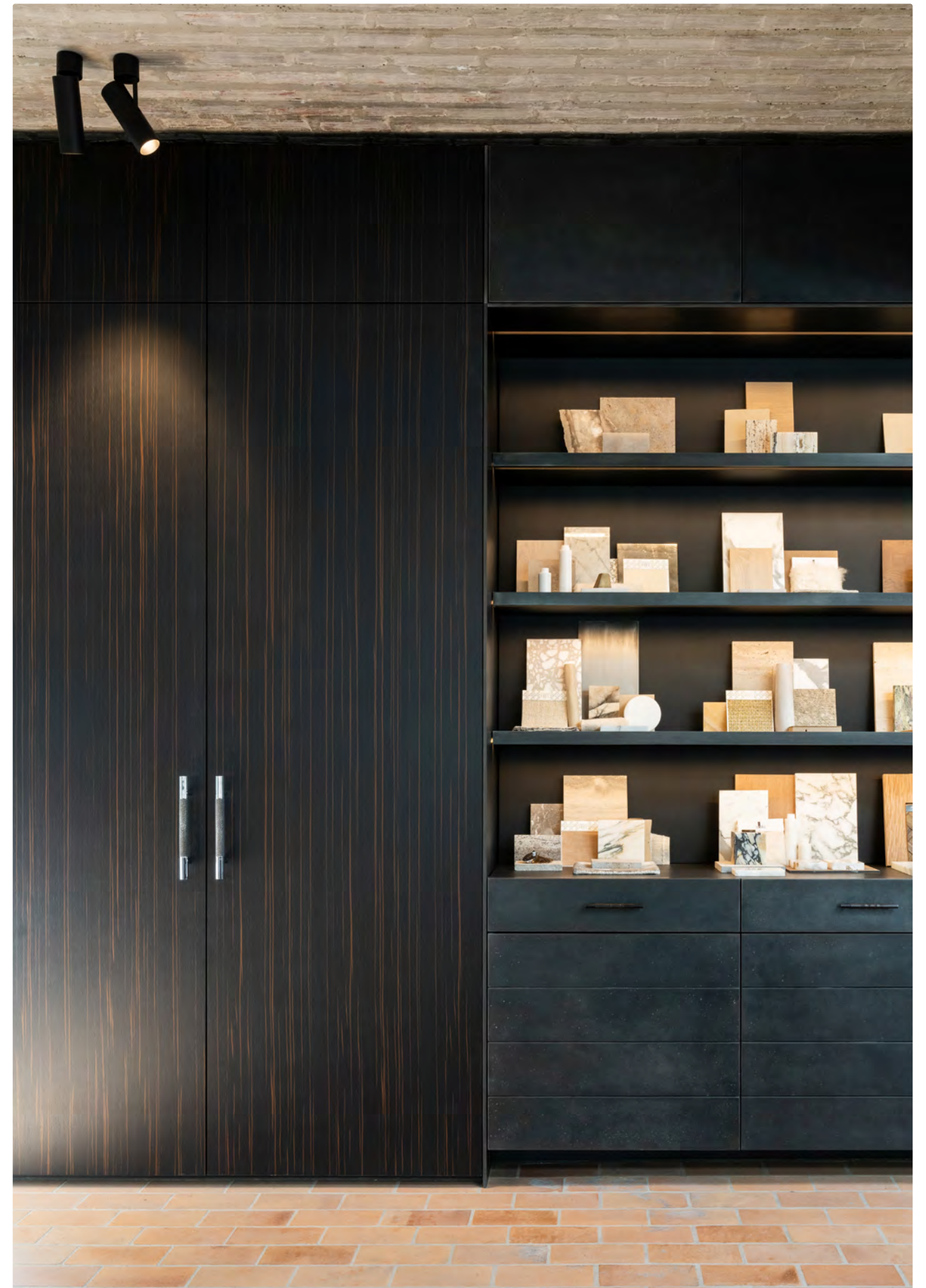























kreon wall luminaires

Recessed wall luminaires are often used in a minimalistic way, which makes their light beam an important part of their design.

Different wall luminaires perform different functions. The kreon side ranges can be used as floor- or wallwashers. kreon rokko is the ideal outdoor steplight, while dolma creates a strong contrast between light and shade in both indoor and outdoor locations.

In comparison to the minimalistic design of recessed wall luminaires, wall-mounted luminaires often have a more decorative design that allows for more flexibility. The kreon erubo and kreon holon wall-mounted luminaires can be rotated and tilted to direct the light in the right direction.

kreon onn-wall is an exception to all those features. This uplighter with a unique optical system, in its pure and simple form, is optimised to project light away from the wall and into the room.

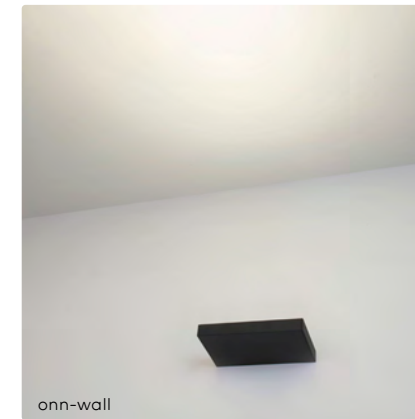



side in-line (left)
oran stone wall (right)

Project private residence
Location Eupen, Belgium

Architect Raphael Schoffers
Photographer Serge Brison



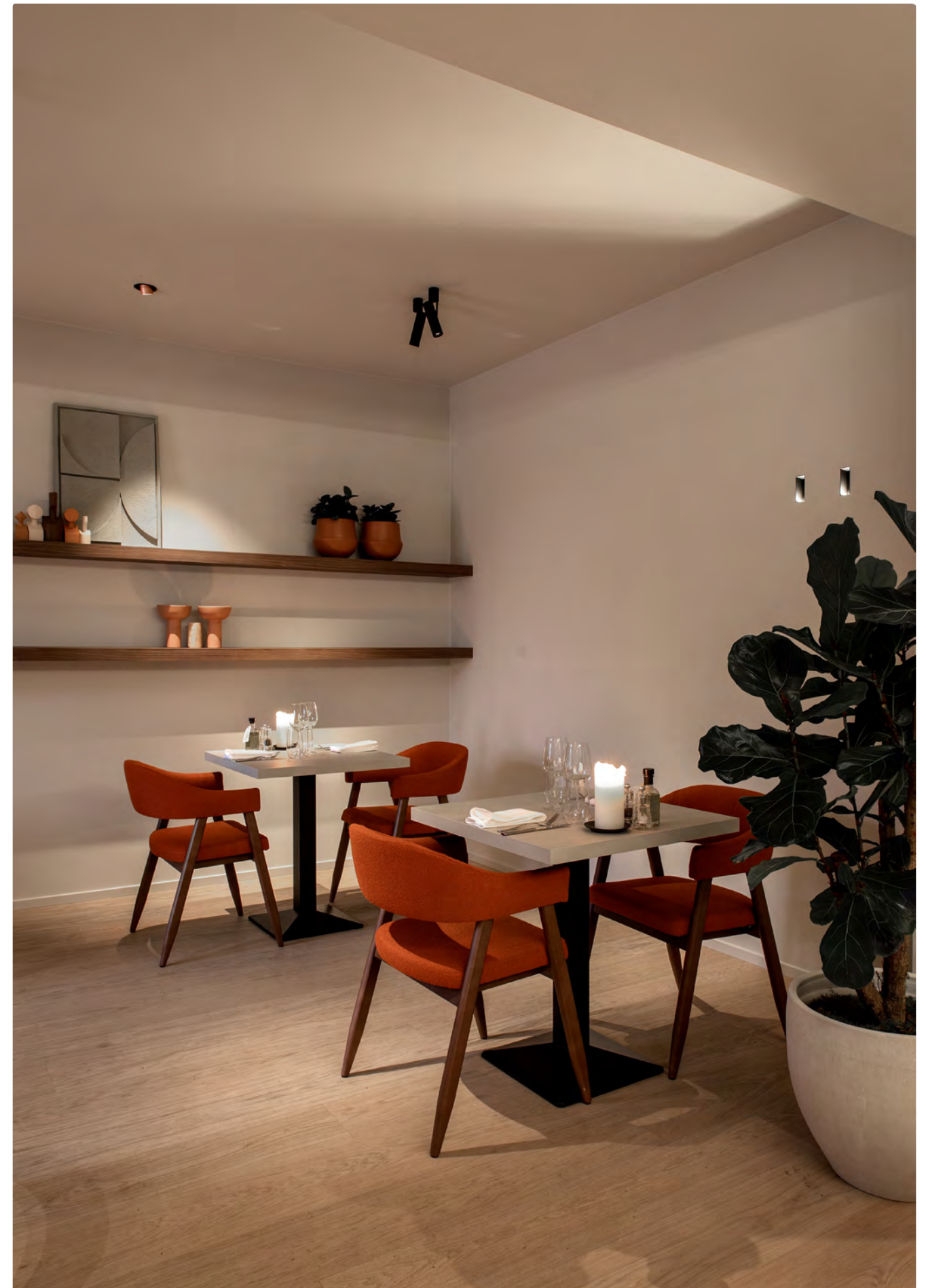



















Project private residence
Location The Netherlands

Int. Architect Marc Engelen Interieur Vormgeving
Photographer Serge Brison



holon 40 (left)
onn-wall 300 (right)

Project private residence
Location Knokke, Belgium

Architect Blower
Photographer Evenbeeld



kreon pendant luminaires

kreon pendant luminaires provide focus by bringing the illuminant closer to the task area. When the intent is to provide an intimate pool of light over a table or object, a pendant light can be positioned even lower so that a dramatic contrast will be created by the constraints of the illuminated area. kreon pendants are available in various formats and finishes to suit many applications.



cadre



esprit

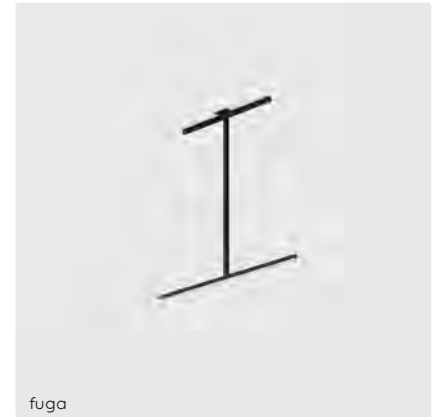

fuga

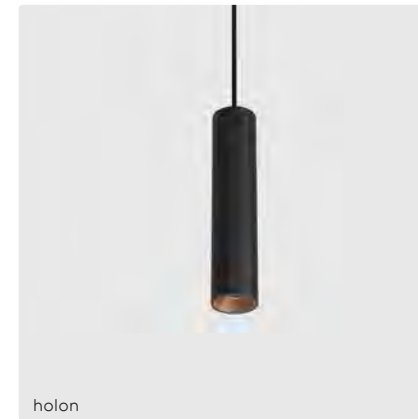

holon

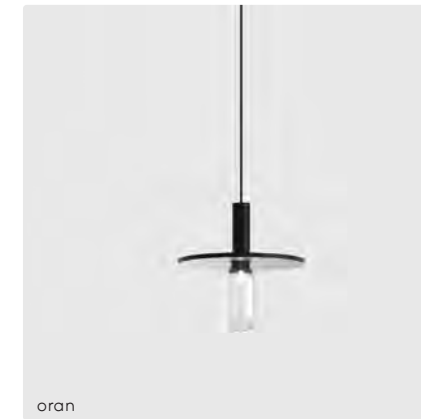

oran





















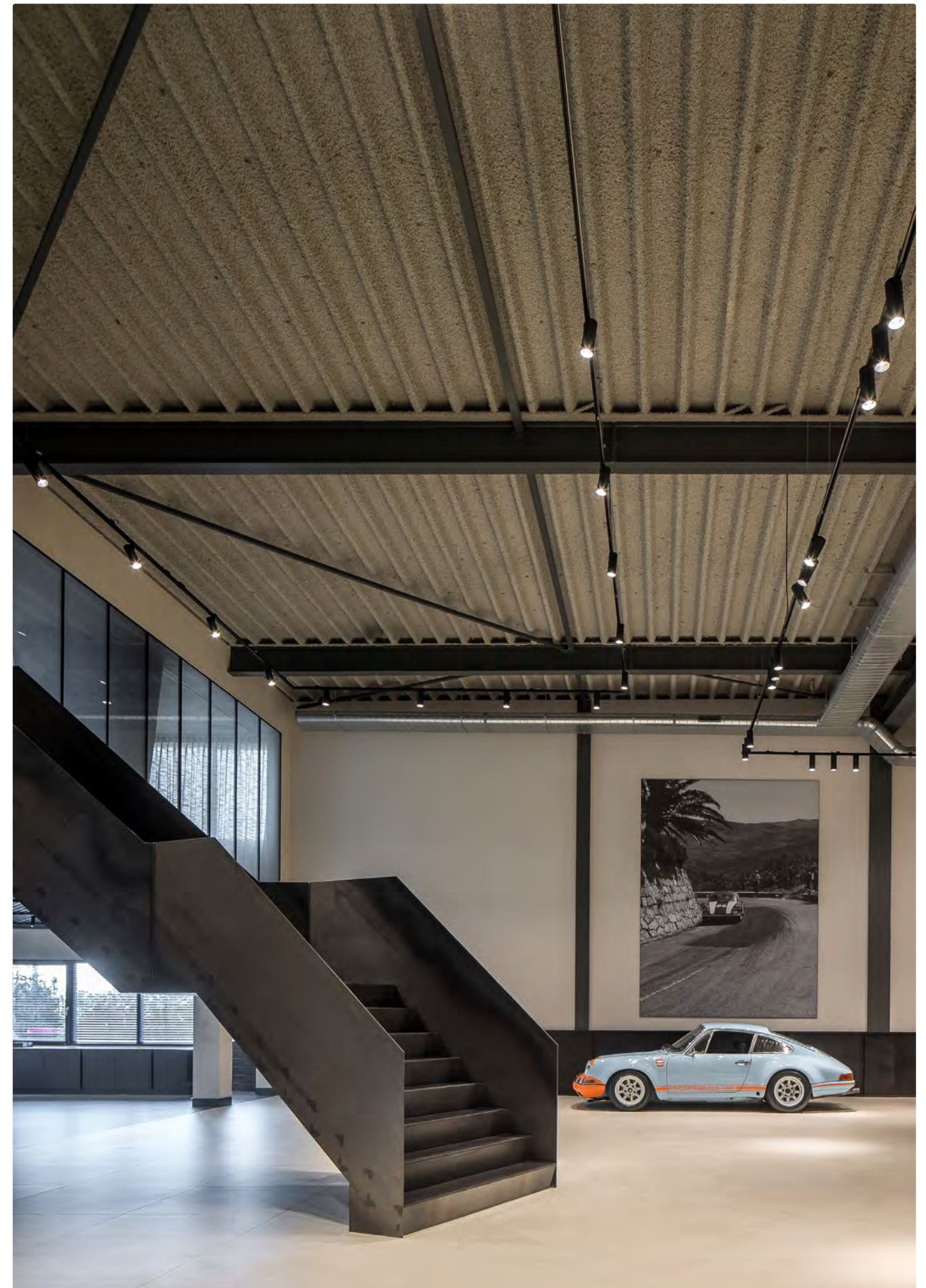







kreon recessed floor luminaires

Uplighters are the perfect illumination to enhance orientation, but are also suitable to highlight a wall, as an alternative to a ceiling downlight. Furthermore, they can be used to create indirect illumination by letting the light bounce of surfaces such as walls or ceilings.

A professional lightplan should always hold a combination of luminaire types and search for a balance between downlights, wall lights and uplights.

By providing illumination from below, floor luminaires can strengthen the architectural lines already existing in a building.

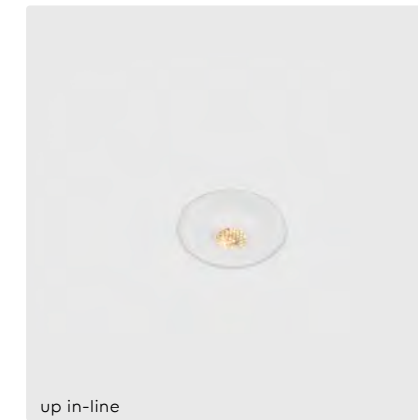

kreon recessed floor luminaires

up in-line 80 circular

Project Station House
Location Londen, UK

Architect LBMV Architects







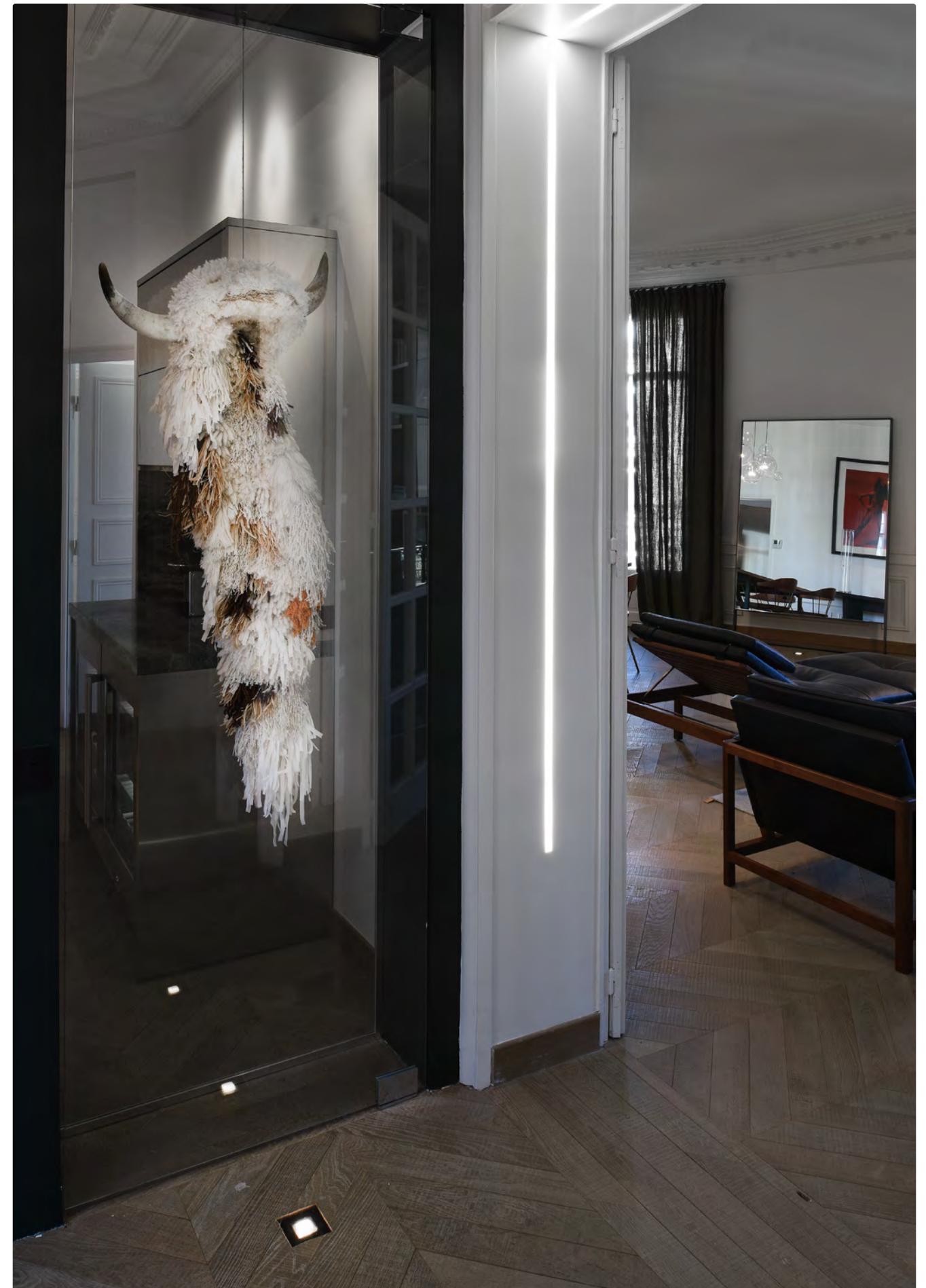



kreon free standing luminaires

Even contemporary light plans should hold a place for free standing luminaires.

These fixtures can determine the ambience of a room and bring light where no other light sources are available.

Free standing fixtures and table lights are often of a more decorative kind and more susceptible to trends, colours and materials, evolving together with the decor of an interior. They serve more as a design object than as a luminaire. Such design classics can add value to the interior both by their shape as well as their light image.

However, this is not necessarily always the case.

An uplighter near a houseplant can create a brilliant atmosphere without being dominantly present in the room.











kreon profile systems

kreon profile systems provide the perfect containment for luminaires. By limiting the apparent disruption to a ceiling that an array of downlights may present, a profile system can add character and architectural unity to a space. All kreon profiles are precision engineered and finished to the highest standards and utilise quality components and electronics. Profiles are available in black and white as standard and are available in various sizes and formats for recessed, surface and pendant mounting.



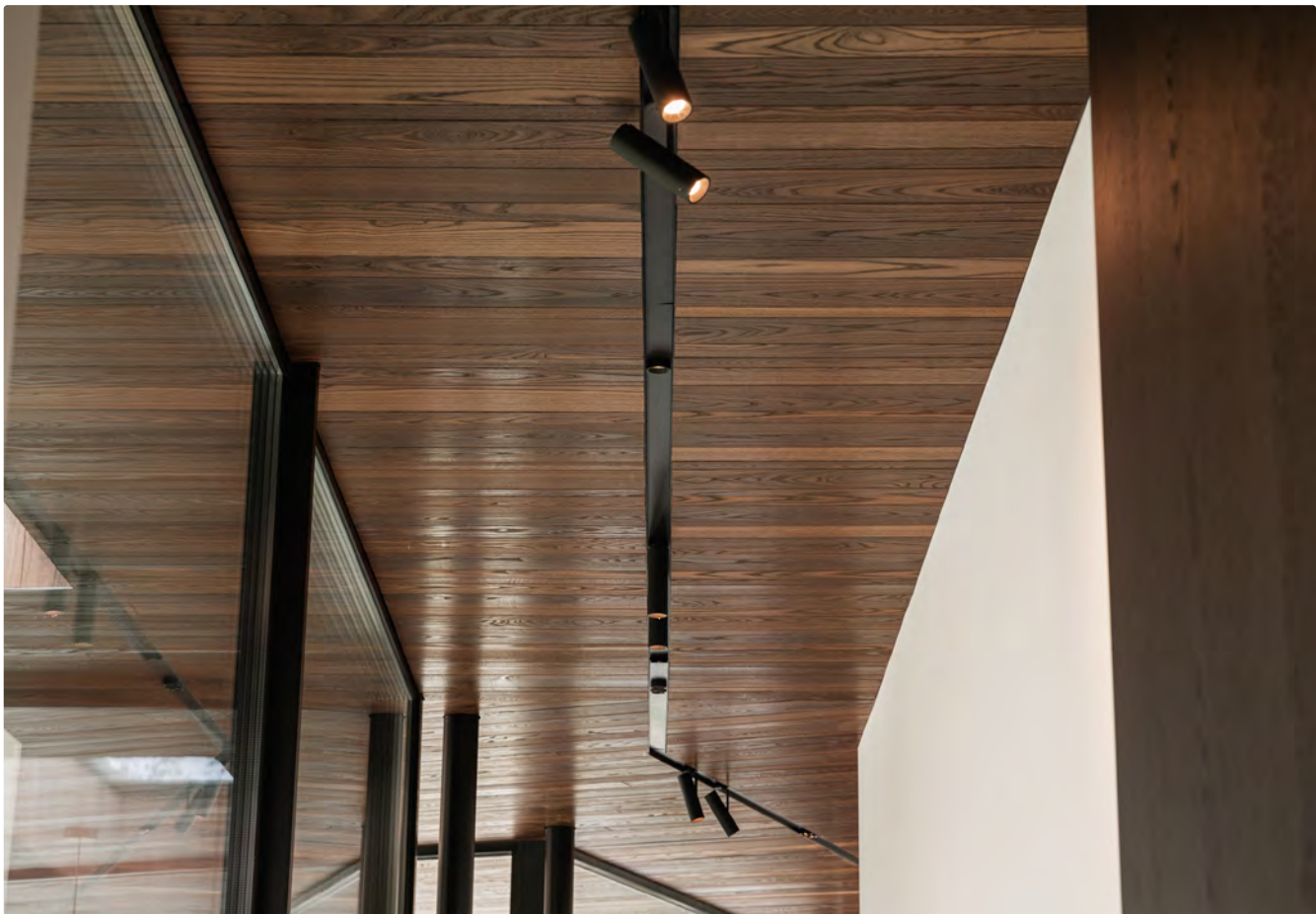















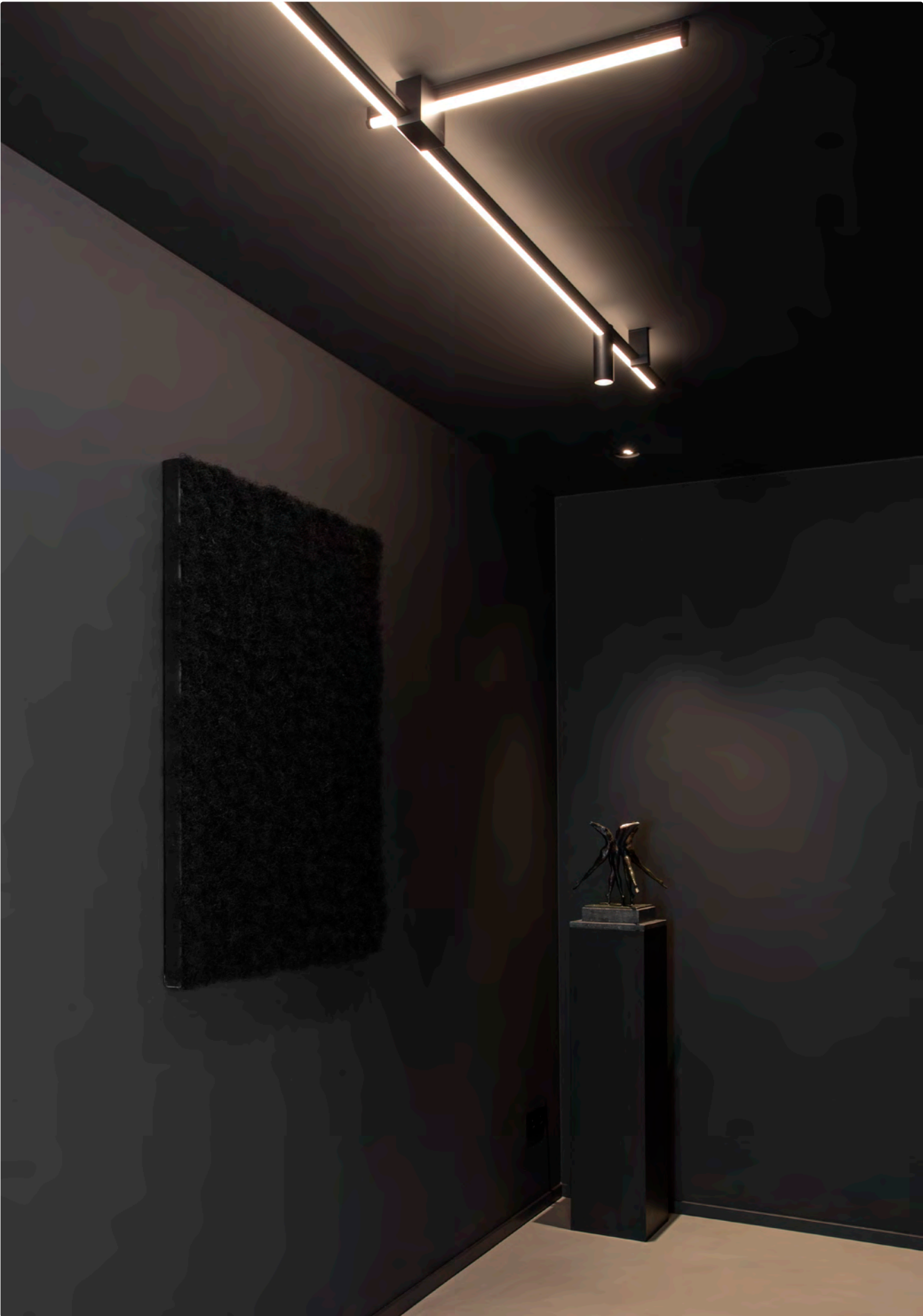







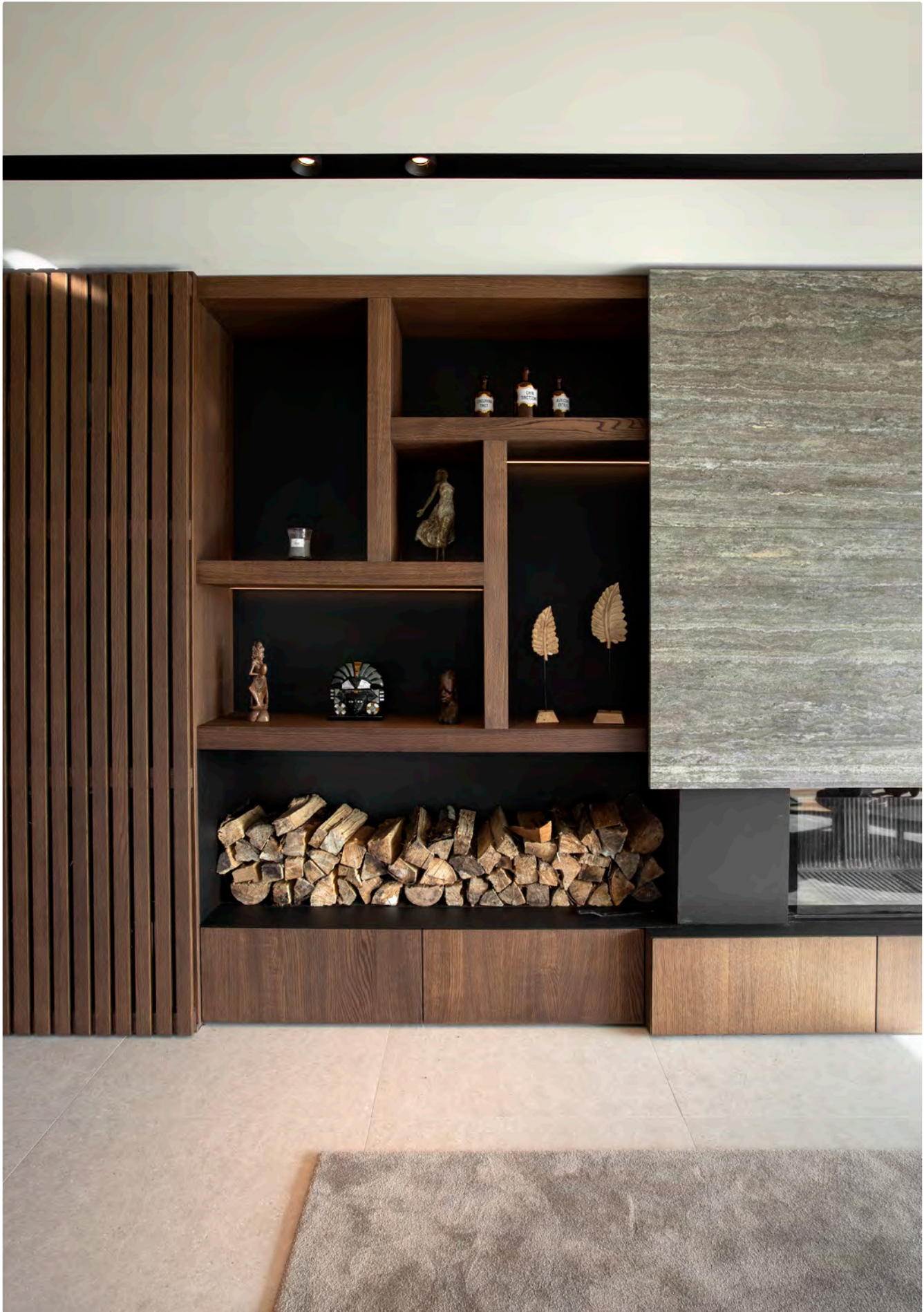
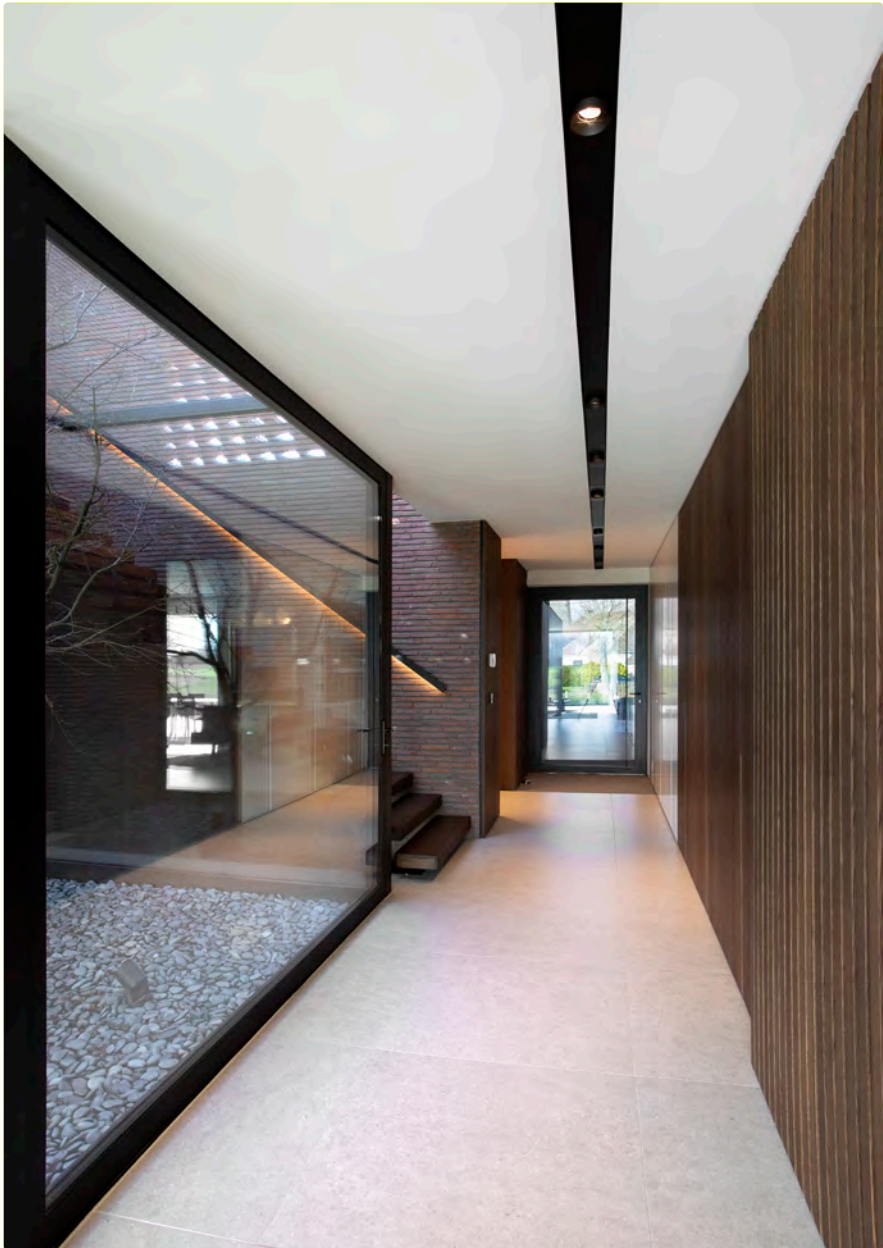













kreon table & desk lights

The main purpose of a desk light is to provide focused additional light to the workspace, without having a distracting effect on the person sitting at the desk. Therefore, the ideal light source for a desk light is covered with a diffuser, providing sufficient light output, but preventing a disturbing direct view and glare of the light. The use of an LED light source with diffusers allows the light to highlight the area in a broader and more gradual way. The height of the light position is the most important feature of a well-designed desk light. It should be adjustable to fit the needs of the user.



esprit desk



oran object





kreon outdoor lighting

A well-designed outdoor plan combines both functional lighting, steplights and wall grazers, with ambient lighting.

kreon outdoor fittings focus on uses within the perimeter of the house and aims to bring the outdoor world indoors. An illuminated garden strengthens the sense of space from the live indoors to the outside world, by creating the possibility to look beyond the windowframe darkened by nightfall. Within this darkness, the light unveils a new play of light and dark. With the use of the right direction spot, a work of art can be subtly illuminated to reinforce the overall picture of the garden. A LED-line can amplify the architectural lines of a modern garden, providing a visual lightline more than the full illumination of the garden. A tree, near the terrace, lit by an uplighter, uses the canopy as a reflection surface, scattering the light into a atmospheric glow.

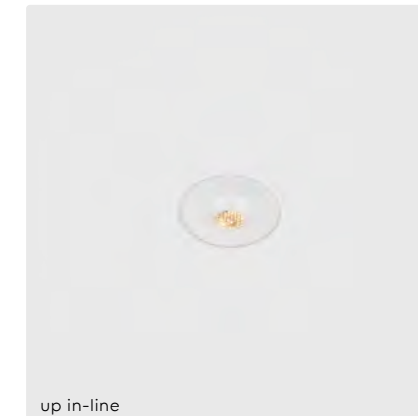





































kreon track systems & projectors

kreon single and track mounted spotlights provide a truly flexible lighting solution for shops, galleries and museums, whereby the lighting scheme can be adjusted and optimised to suit the spacial and display requirements. Spotlights are offered in black and white finishes with a range of lumen outputs. Track profiles are available in recessed, surface mounted or pendant formats.

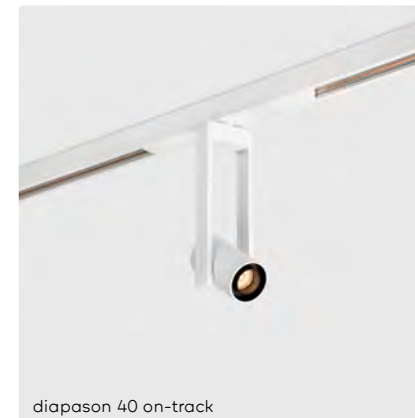

diapason 40 on-track

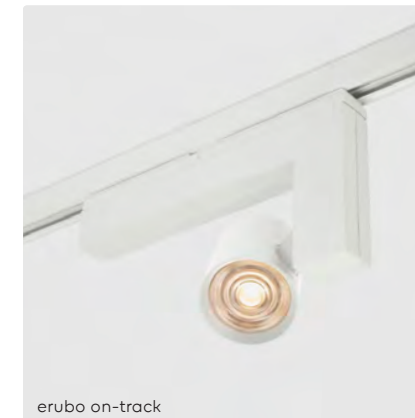

erubo on-track



holon 40 directional on-track



diapason 80



erubo



holon 80 directional



holon 40 on-track







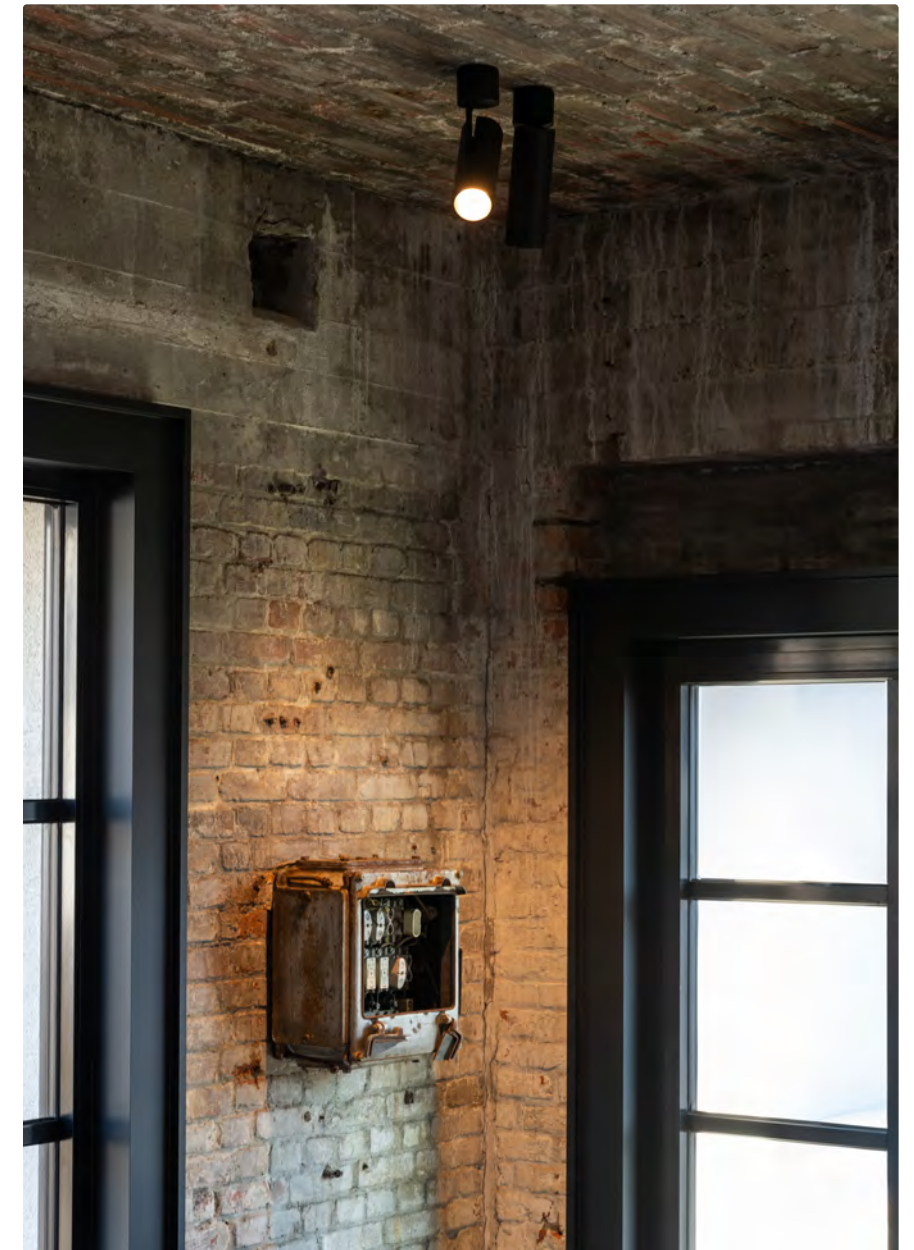



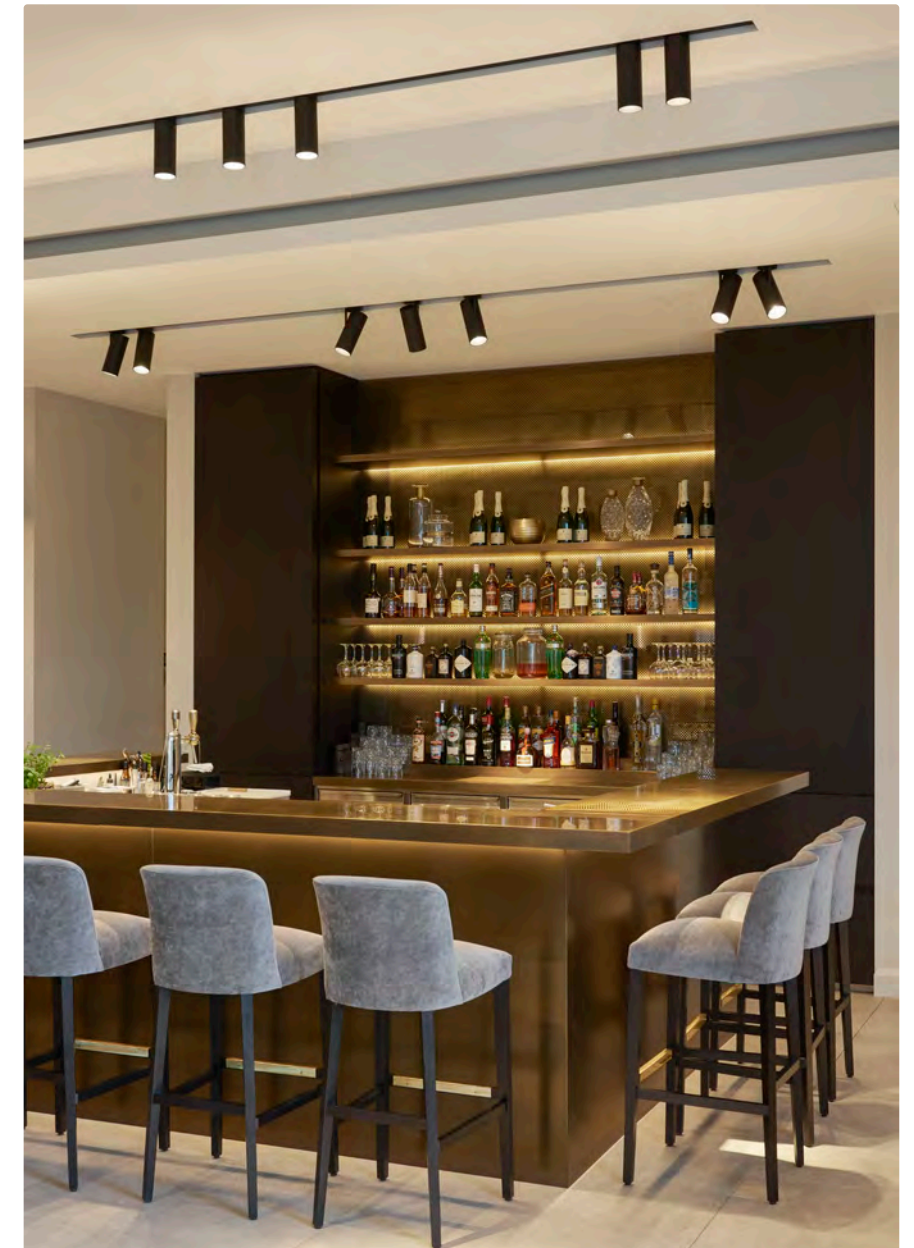

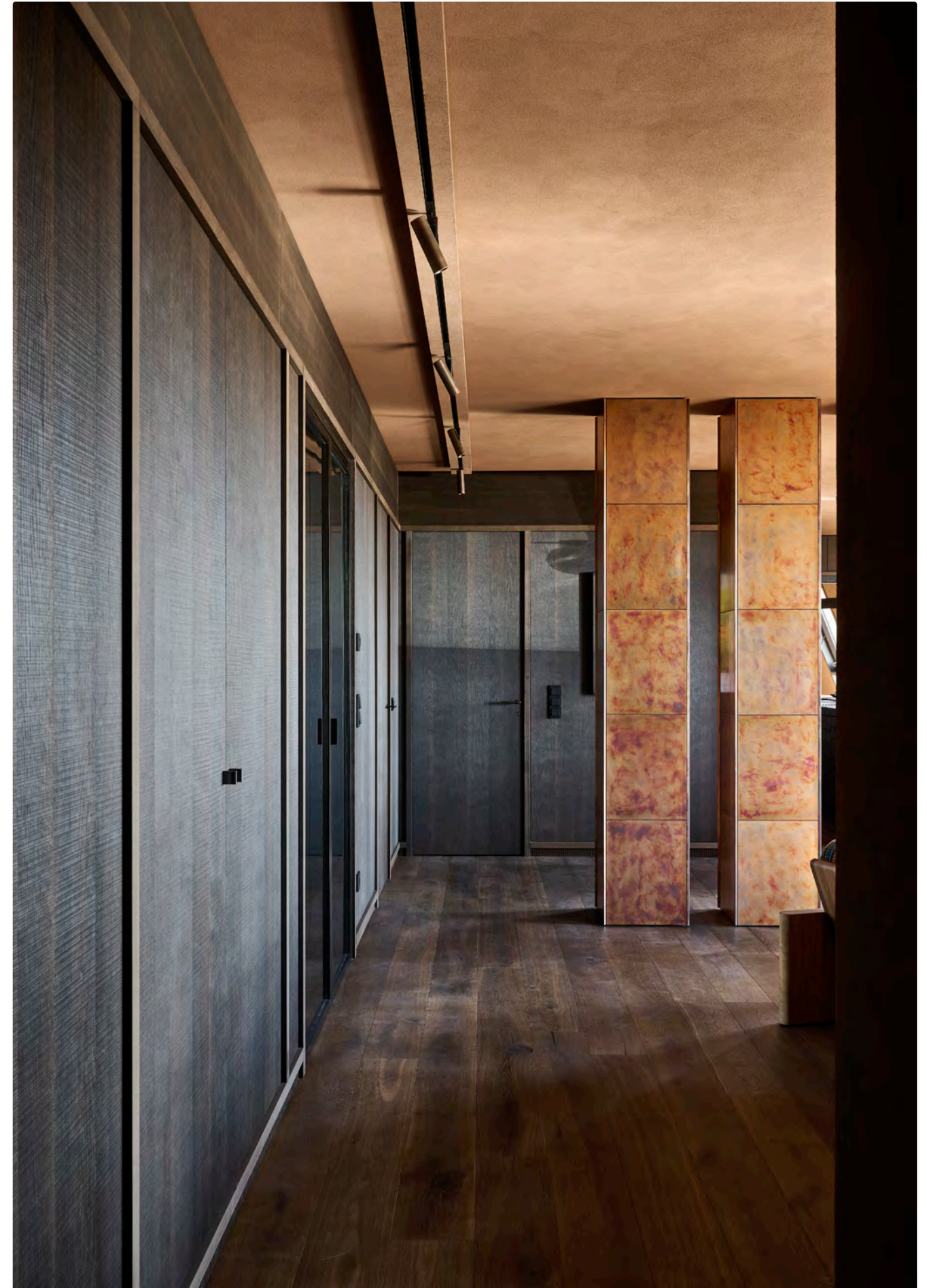
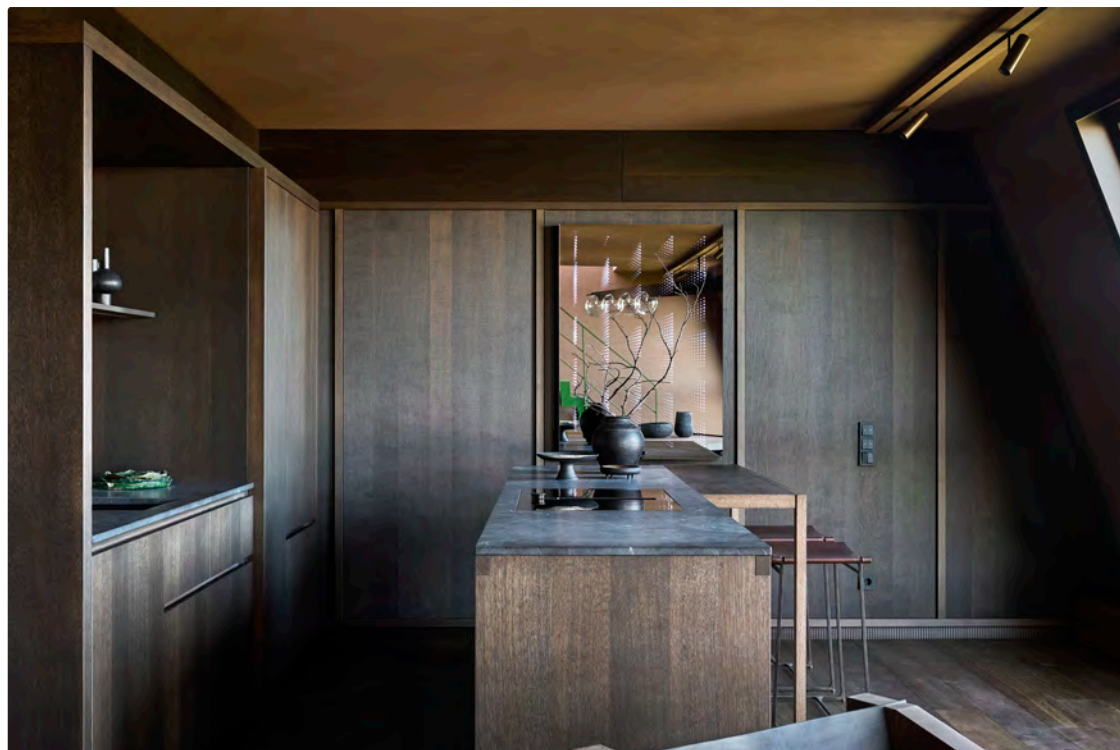













creative spaces	296
project design	300
light lab	308
sustainability	310
bespoke	312
degree of protection	316
vektron	318
belux	320
general information	322
offices	324

kreon plays a leading role in the world of architectural lighting and makes every effort to share this vision with its professional audience. Our showrooms are more than just a presentation of luminaries.



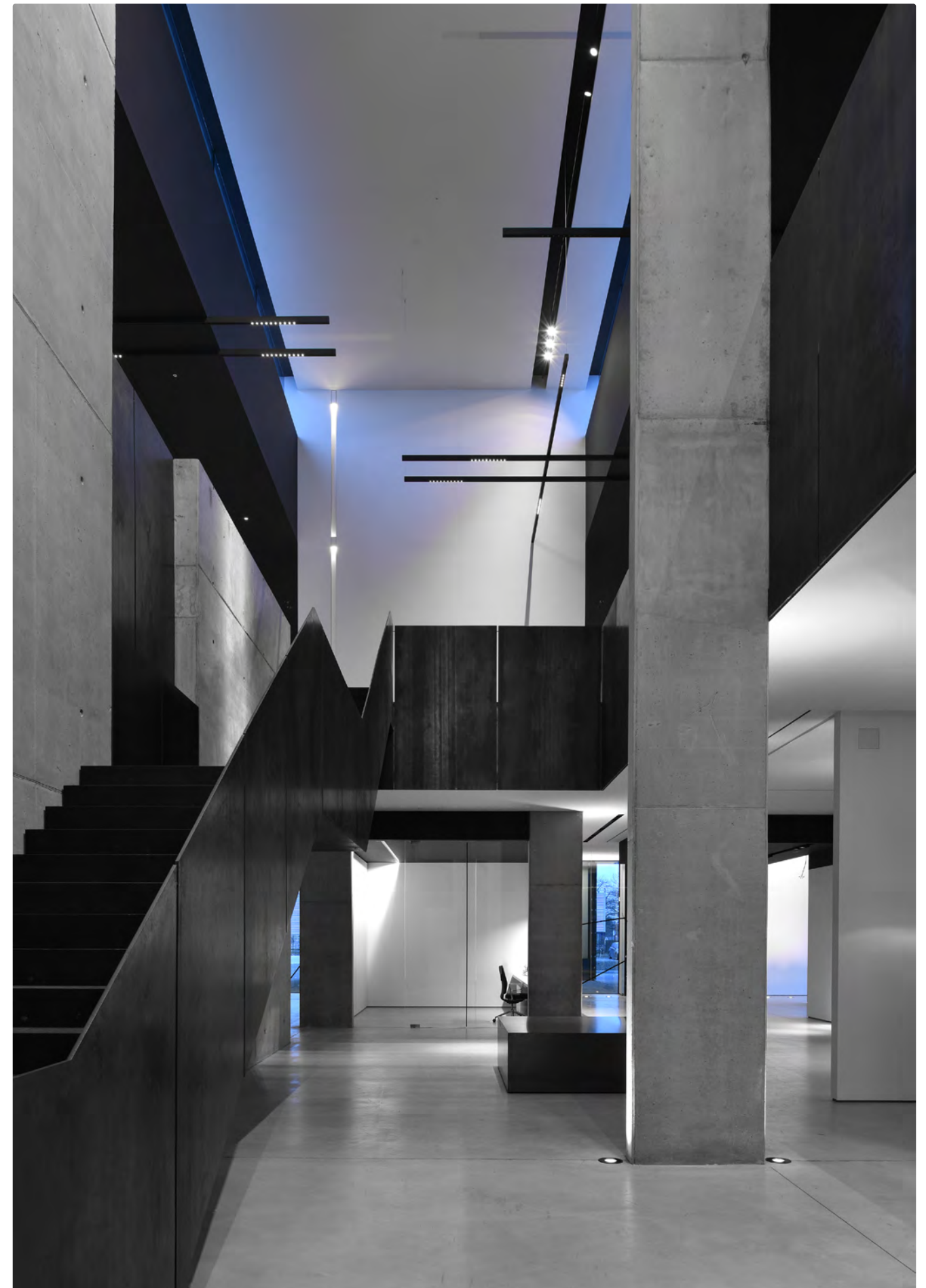

The kreon creative spaces are the perfect translation of the company's identity. Minimal, yet architectural kreon tools of light where proportions and the relation between colour and surface present our lighting solutions in a minimalistic and refined aesthetics. kreon creative spaces emphasize our vision to unite light and architecture.

These showrooms provide flexibility in creating different scenes within a static environment thus impressing upon our clients the added value of lighting design. The subliminal message of the space is that kreon provides good solutions with aesthetically pleasing products, instilling a need in our clients to consider the organization as a whole with added value.

kreon creative spaces are meeting points where specifiers and lighting designers are welcome to share and discuss the importance of lighting as a creative extension of architecture with the professional kreon lighting consultants.







kreon Belgium HQ
T +32 89 81 97 80
mailbox@kreon.com
   



kreon China
T +86 183 1711 3541
china@kreon.com
 





kreon France
T +33 1 44 50 53 54
france@kreon.com
 

kreon Italy
T +39 02 89 42 08 46
italy@kreon.com
 

**kreon Inc.
North America & Canada**
T (201) 298-44 48
usa@kreon.com
   



kreon South East Asia
T +65 62 22 33 93
singapore@kreon.com



kreon Switzerland
T +41 61 316 74 01
switzerland@kreon.com
   

kreon Turkey
T +90 216 430 86 00
turkey@kreon.com
   

kreon Austria
T +43 1 715 44 25
austria@kreon.com
 



kreon Scandinavia
T +31 (0)6 52 39 16 80
auke.bakker@kreon.com

kreon Germany
T +49 221 937 22 0
germany@kreon.com
 

kreon Middle East & India
T +971 56 705 2522
middle.east@kreon.com
 

kreon Poland
T +48 504 788 355
poland@kreon.com

kreon Spain & Portugal
T +34 600 462 551
spain@kreon.com
 

kreon The Netherlands
T +31 (0)6 52 391 680
the.netherlands@kreon.com
 

kreon United Kingdom
T +44 (0)20 7740 2112
uk@kreon.com
 

-  office
-  production facility
-  creative space
-  research & development

Evolutions in techniques and technology have made lighting design crucial for the realisation of an architectural project. The possibilities have become endless. However, seamless integration into modern architecture becomes more complex with the day and requires knowledge.

Lighting design has become a creative extension of architecture. The main objective of lighting in an architectural design can be deduced to compliment the present shapes and colours. In recent years, there has been a broad interest in light, lighting and lighting design among designers throughout the world, but also among architects. One of the main reasons behind this, is the growing awareness of the fact that architecture has become more thoughtful and increasingly uses free forms. This also increases the need for quality architectural lighting. Standardized light concepts might still meet the more static architecture of the recent past, but the variation we see in contemporary architecture requires diverse and distinctive possibilities in terms of lighting.

An architect has no need for lighting devices, but for light, atmosphere and comfort. The product should be minimally present in the architecture and should be kept in the background, so the light can steal the show. Not the luminaire. Successfully integrating lighting in your design requires knowledge and insights about products, technologies and especially about the effects and impact of light.

Because kreon always starts from the architectural design, we can enter into a dialogue with the architecture as an equal partner. kreon project design, helps you create the perfect conditions under which the beauty of your design can come to the surface in the most optimal way.

The kreon professional lighting designers are happy to share and discuss with specifiers and other lighting designers the importance of lighting as a creative extension of architecture.

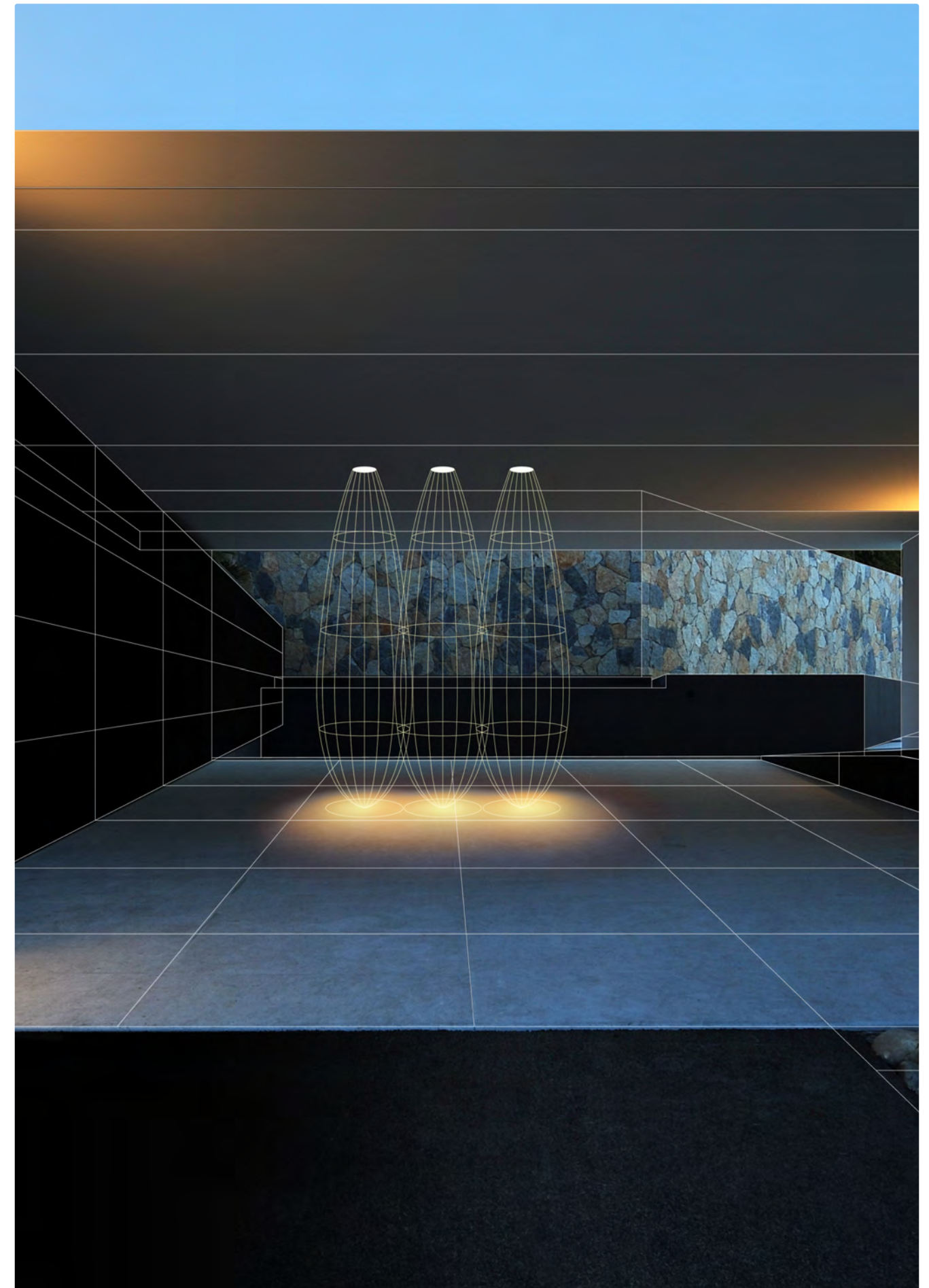

kreon project design

Lighting is an active component in spatial design. Illuminating a space is a quest for light quality. Light shows what is important: an object, a structure, a rhythm or a pattern both inside and outside the architecture. Therefor architecture is the formal basis for the kreon identity. Since 1983 our product range evolved in a swinging movement into a changing architectural framework through brutalism and structuralism to postmodernism and minimalism. Only this is constant: light as a structural material of the architectural development.

Key aspects of this architectural framework are:

- Material as decoration
 - High quality, low gloss paint
 - Natural, untreated materials
- Repetition as a system
 - Repetition in light plan
 - Repetition in lighting fixture
- Uniformity in structure
 - Simplicity and clarity in lighting plan
 - Formal and/or technical uniformity in the product
- Light to see - ambient light
- Light to focus on an object - focal glow
- Light to look at - play of brilliance

Light plan

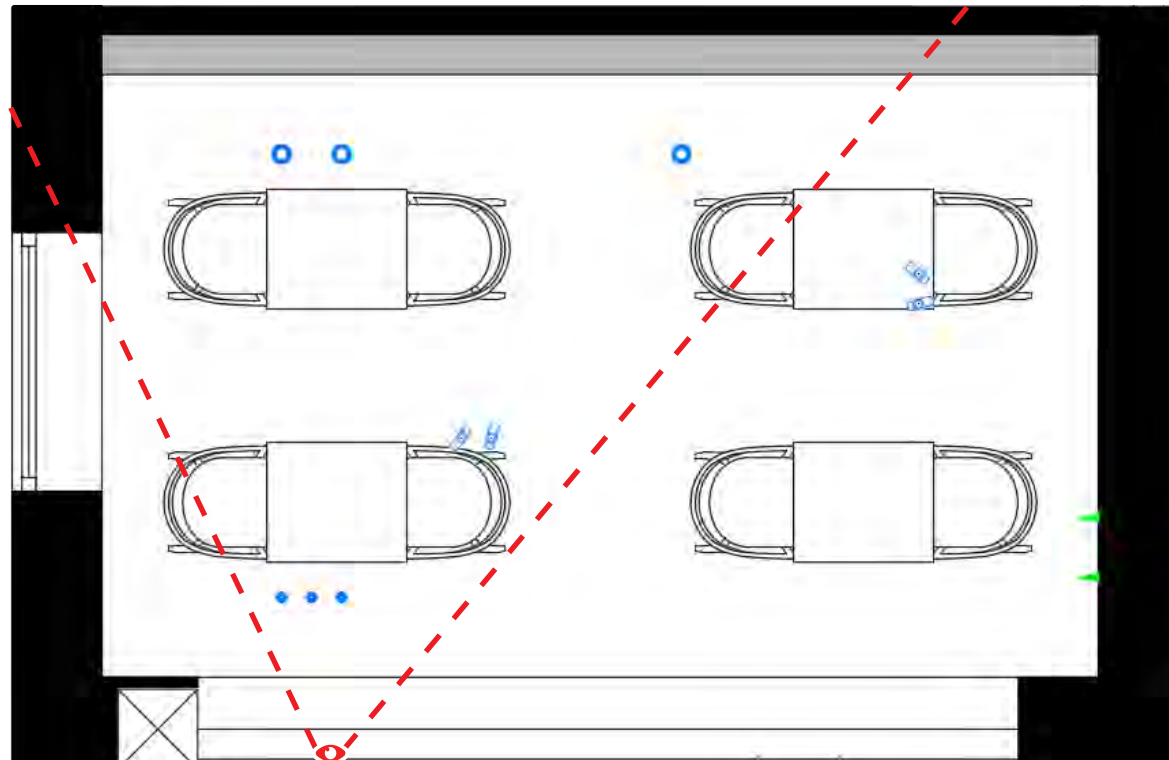

Pseudo colours



3D visualisation



Realisation

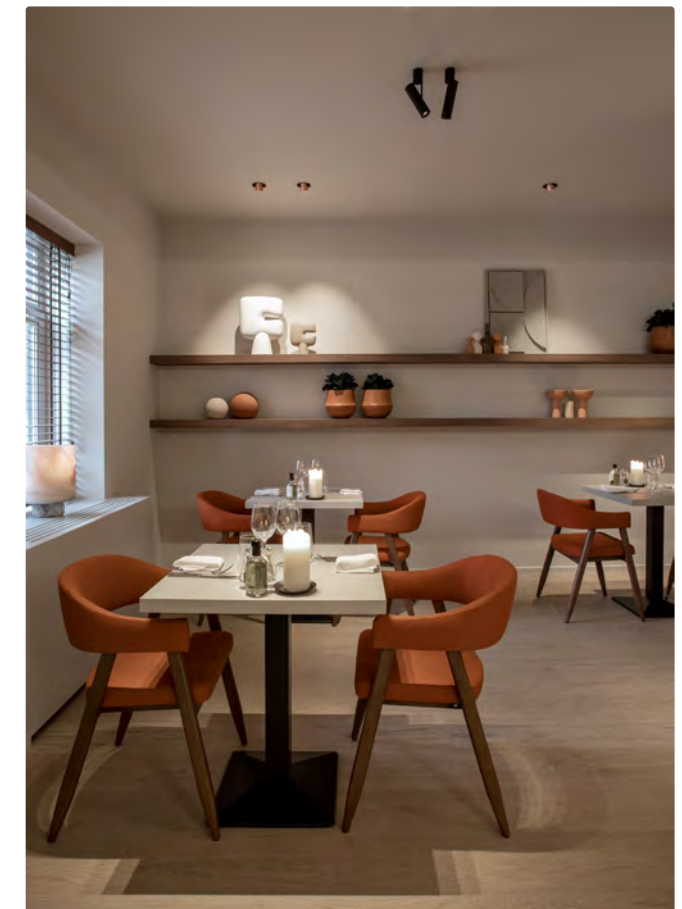

Embark on creative exploration

Our professional lighting designers are happy to present your very own inspiration box. Inside, you'll find a curated selection of innovative lighting products that cater to various styles and preferences.

In-depth details

Dive deep into each product's specifications. Empower yourself with the knowledge needed to make informed decisions.

Real-life applications

Explore real-life project photos showcasing our products in action. Witness how our lighting seamlessly integrates into different spaces and designs.

Visual representation

Flip through 2D drawings that illustrate product placement in various layouts. Get a clear picture of how our lighting can transform your space.

Unveiling creativity

Peek behind the scenes with sketches from our product developers. Experience the journey from raw concept to refined design.



Meeting the standards

kreon focuses on the quality of all products as well as on service towards our professional clients. This can only be obtained by integrating all national and European quality standards, for as far as the product standards ENEC 60598 and CE are concerned and the ISO 9001-certificate.

All existing products as well as all new developments are being ENEC certified and comply with CE regulations and other existing standards. To meet these standards the presence of a professional laboratory is essential.

The kreon laboratory houses:

A fully equipped type C goniophotometer for measuring the luminous flux and luminous intensity distribution of the kreon and fixtures and translate them into LDT and IES files.

A termal test unit used for measuring and controlling the operatonal temperature and the life performance parameters of the different LED engines applied in our fixtures.

A constant climate chamber to run specific stress - and material tetst in which temperature and humidity are modified automatically at set times.



kreon evolves architecture

Our tools of light are designed for today and tomorrow. And for the days after tomorrow. For contemporary and timeless design. We strongly believe that a long-term vision for lighting is the best option for a sustainable result. A design that remains relevant. And adaptable. Each stage of life requires a different intensity of lighting. We take care of that. Every style calls for more shade or more light. We take care of that.

We want to do this with due consideration and respect for our planet and future generations. We have already taken many steps in this regard. And we want to continue taking them.

Raw materials

All our profiles are manufactured from 98% recycled aluminium.

Facilities

Solar panels, hot and cold storage. Minimise dependence on fossil fuels. Conscious choice.

Vision

Our timeless designs, our customisable profiles and our long-term vision for lighting in every room contribute to sustainable results.

Of course, there are also areas where we still have more to achieve.

Thinking today about what is to come, we are taking care of that together. This long-term vision demands a thorough approach from us. That is why we keep looking for more sustainable solutions for our entire operation.



Blog:

The kreon sustainability plan: step by step to a cleaner world

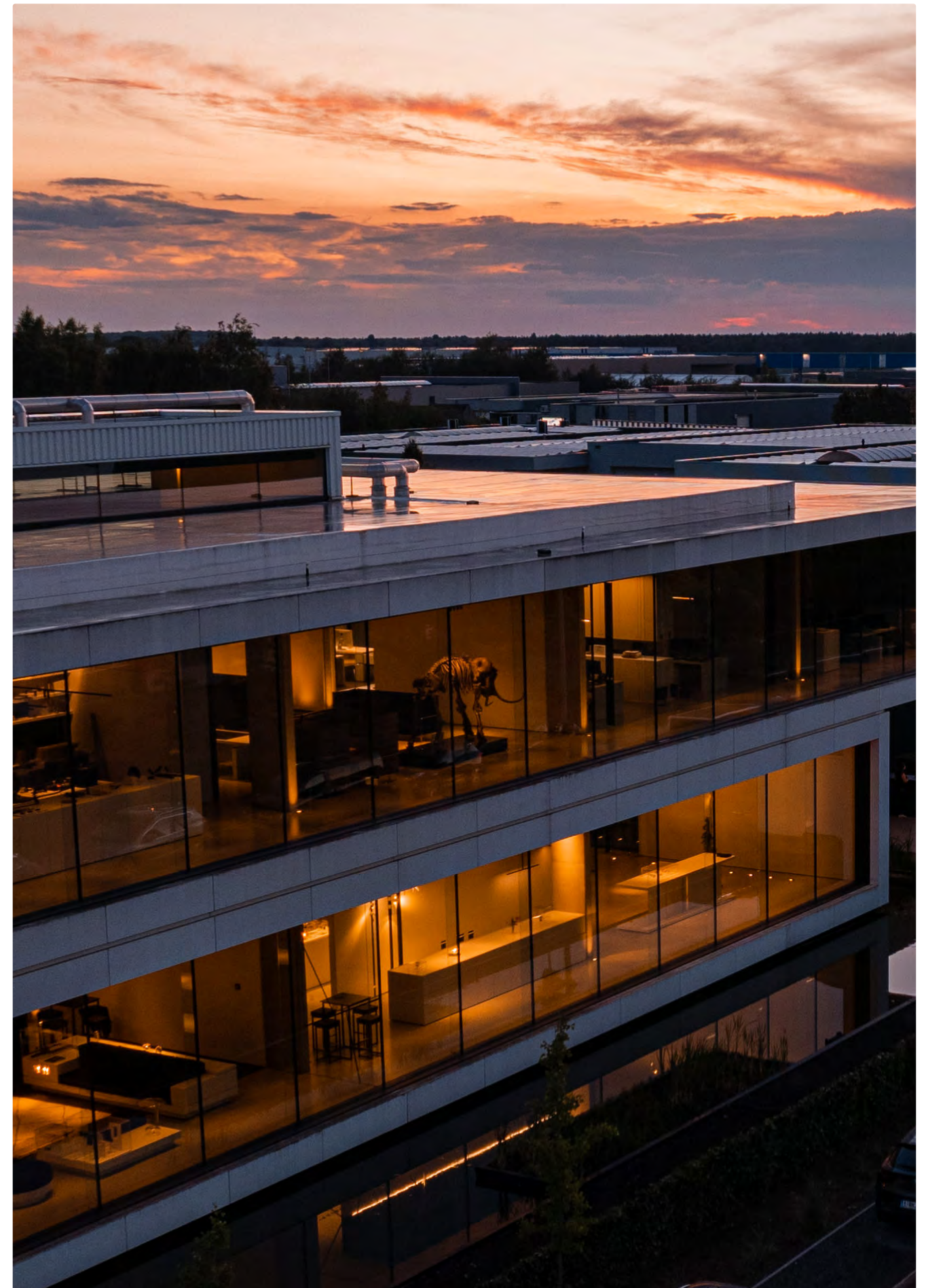

kreon respects architecture. In the world of kreon, purity of design is central. Faithful to our values and vision and mindful of our high quality standards. Our knowledge and way of working enable us to propose products and solutions tailored to each project.

Adjustments to our tools of lights are possible and allow us to optimise our products and collection for a better match.

Personalised development goes a step further to make our tools or lights meet the needs of a specific project.

Complete customisation ensures a unique, never-before-seen approach.

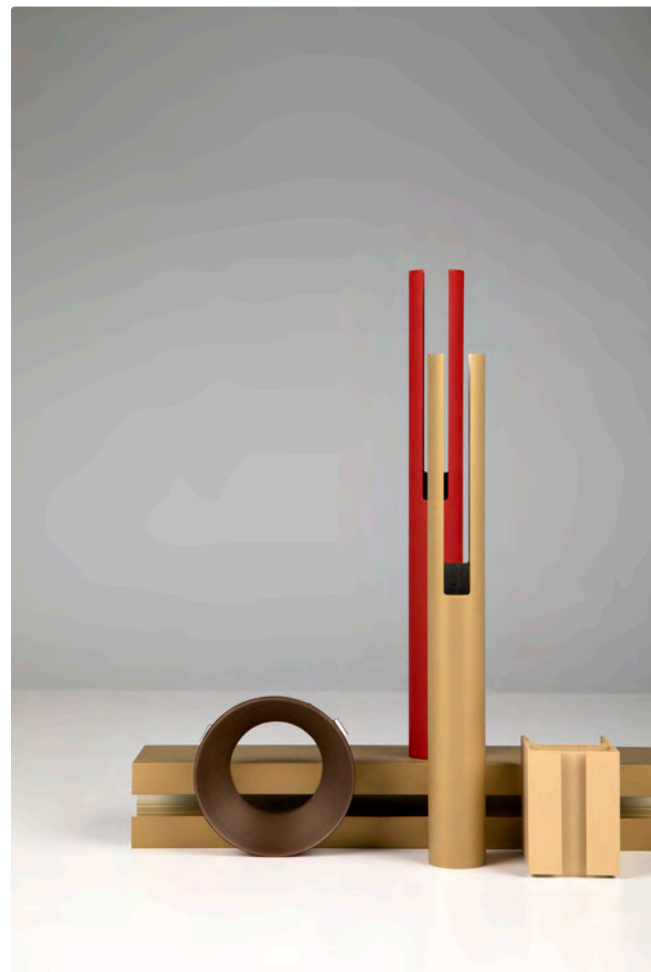
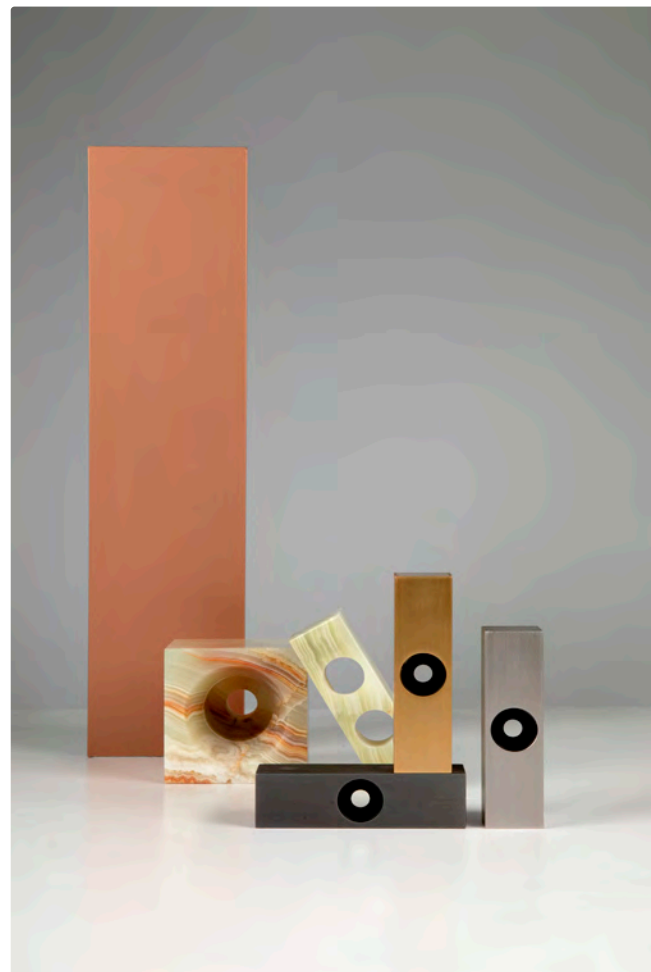



IP classification

	Degree of Protection against penetration of solids
IP 0X	No-Protection
IP 1X	Protection against solid objects greater than 50mm Ø
IP 2X	Protection against solid objects greater than 12mm Ø
IP 3X	Protection against solid objects greater than 2.5mm Ø
IP 4X	Protection against solid objects greater than 1mm Ø
IP 5X	Protection against limited ingress of dust without interference in operation
IP 6X	Protection against any ingress of dust
	Degree of Protection against penetration of liquids
IP X0	No-Protection
IP X1	Protection against vertically dripping water
IP X2	Protection against vertically dripping water up to 15° from vertical
IP X3	Protection against spraying water up to 30° from vertical axis
IP X4	Protection against spraying water from any direction
IP X5	Protection against jets of water from any direction
IP X6	Protection from powerful jets of water with limited ingress with no harmful effect
IP X7	Protection against total immersion in water for limited periods
IP X8	Protection against total immersion in water under pressure for an indefinite period Max. depth shown in metres IPX8 ...m

Attention: Unless otherwise stated, protection is not guaranteed when placing our lighting fixtures in coastal environments.

IK classification

	Level of shock resistance according to CEI EN 50102
IK 00	No-Protection
IK 01	Protection against 0,15 J shocks
IK 02	Protection against 0,2 J shocks
IK 03	Protection against 0,35 J shocks
IK 04	Protection against 0,5 J shocks
IK 05	Protection against 0,7 J shocks
IK 06	Protection against 1 J shocks
IK 07	Protection against 2 J shocks
IK 08	Protection against 5 J shocks
IK 09	Protection against 10 J shocks
IK 10	Protection against 20 J shocks

Protection class	Symbol	Meaning	Advice
I		Luminaires with earth connection to which all touchable metal parts have to be connected so that they can take up voltage immediately in case of an error.	Connection to the mains protective conductor is mandatory. The symbol is fixed to the connection point.
II		With luminaires belonging to this class, no metal parts which could take up voltage immediately in the event of an error are to be touchable (protective insulation or double insulation).	Lamp may have no earth connection or be connected to the mains protective conductor.
III		Luminaires for use with protective low voltage, i.e. with voltages below 50V, that is generated with a safety transformer in accordance with VDE 0551 or with batteries or accumulators.	

Simplicity must not be the result of an uncritical reduction. Instead, it should be convergence and synthesis of the complex requirement imposed on ceiling solutions by contemporary architecture. Taking its cue from this concept, vektron ceiling solutions do more than just span a room. It offers a unique solution for the integration of building service systems that need to be accommodated in the ceiling: lighting, ventilation, cooling, heating, audio, fire protection and much more. vektron's most pursued objective is to offer unity in design translated through technical solutions.

Design that gives prominence to simplicity, permanence and calmness requires precision so as not to become trivial. The more one condenses, omits and simplifies, the more the significance of the detail is increased. Unity and simplicity of details are the very ones to concur to great architecture. vektron is glad to invite you to discuss your architectural requirements with our planning department.

Ceilings usually have an indistinctive character in the space surrounding us. In daily life, as well as in architecture, they are seldom noticed. vektron ceiling solutions will make these anonymous surfaces come alive: structure, relief and symmetric shadow gaps support the architectural rhythm of space whilst creating effects like rest, order... and even chaos.

vektron integrated ceiling solutions are one-of-a-kind custom-made comfort solutions, produced and installed with the greatest attention to detail, created at the specific request of the client for a specific space. These are individual works of artisanship that require detailed design, proper planning, careful production and precise installation, "à la tête du client."

vektron metal ceilings can be arranged and customised to match your vision perfectly. We offer a wide choice of tile dimensions, materials, colours, finishings, perforations, accessories and options.

vektron modular ceilings aim to materialise simplicity, unity and functionality within its design.

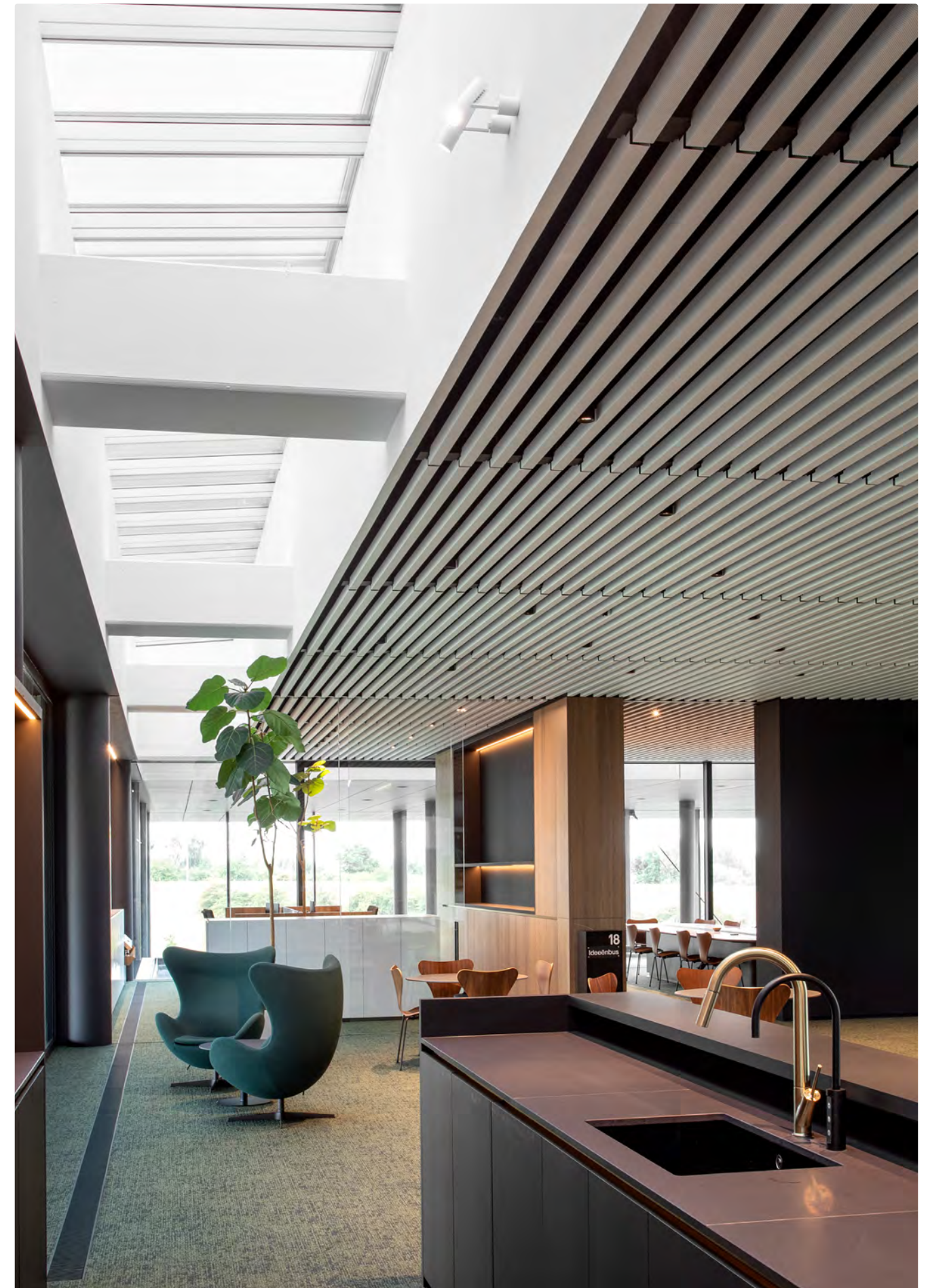

belux is committed to providing optimal solutions for complex lighting requirements both in the contracting sector and in private residential environments. For this purpose, belux develops, produces and markets innovative lighting instruments that are distinguished by modern, energy-efficient lighting technology, functional design, high-quality materials and meticulous fabrication. belux regards lighting as a key element of interior design, which must therefore fulfill the highest functional and aesthetic demands.

Lighting products by belux stand for long-lasting quality, guaranteed by a superior product culture on every level. belux lighting fixtures are manufactured with a passionate attention to detail. This is evident in the selection of premium materials as well as the extraordinary care that goes into the actual production process, which involves a comparatively high degree of precise hand craftsmanship. The belux product range consists primarily of standard production models. Customised products can be made to order if required, especially for projects in the contract sector.

belux maintains lasting business relationships with upmarket retailers and suppliers. As one of its many services, the company provides professional planning advice for specific lighting needs to both lighting experts and quality-conscious end customers.

Lighting products by belux are developed in close collaboration with external designers, whose conceptual and creative ideas are merged with the company's expertise in lighting technology and manufacturing know-how. The starting point for research and development is usually a functional need or technical innovation. The aim is to achieve surprising lighting solutions that are convincing not only with regard to their functional qualities and technical sophistication, but also due to their attractive appearance.

The belux product range contains a series of office luminaires. For more information, go to belux.com



General information	All information in this catalogue is non-binding, supersedes all previous information, and is subject to amendment at any time. kreon has the right to change the technical specifications of its products at any time without prior notice. kreon terms and conditions are applicable at all times. No part of this catalogue may be reproduced without written authorisation from kreon.
Specifications	Because of the constant improvement of its products, kreon reserves the right to modify the characteristics of such products without prior notice.
Fixtures	Unless otherwise mentioned, all products are delivered with a LED lightsource. The indicated maximum power specified must under no circumstances be exceeded.
Lumen output data	The mentioned lumen outputs are the fixture lumen measured at room temperature using standard luminaires with, unless otherwise indicated or not available, flood optics and white finishes, for CRI90 and 2700K
Dimensions	Unless otherwise indicated, all dimensions are specified in millimetres.
Labels	Each product is labelled, specifying the equipment number of the article, its serial number, the type of light source and its maximum power.
Patents/trademarks	kreon holds patents on all products and all product names are registered trademarks.
Liability	kreon products are manufactured in compliance with CE regulations and current standards in force and are delivered with assembly instructions. Each and every modification applied to the product after purchase and/or failure to comply with the assembly instructions may result in the loss of characteristics and in a dangerous situation for its user. kreon disclaims all liability for products subjected to any modification whatever or for which the assembly instructions are not complied with. kreon cannot be held liable for any technical errors in this catalogue.
Guarantee	kreon products are manufactured with maximum care from high-quality materials. Every product is subjected to strict quality control. kreon guarantees this product (light sources exempt) for a period of 12 months from the date of purchase.

kreon nv Industrieweg Noord 1152 BE-3660 Oudsbergen T +32 89 81 97 80 kreon.com mailbox@kreon.com
General terms and conditions kreon nv's general terms and conditions apply. These can be accessed on kreon.com
General information <ul style="list-style-type: none">- Even though kreon takes all the necessary care to ensure the correctness of the published information, it accepts no liability for the correctness and completeness of the contents thereof.- Images of products are by way of example only and may deviate from the original.- We reserve the right to make changes in dimension and construction.- The name kreon, all products shown as well as all photographs are protected by law and must not be used commercially without written permission by kreon NV, Oudsbergen, Belgium. Copying and reproducing this catalogue or parts of it is only allowed with written permission by kreon NV. The general terms and conditions of kreon NV apply for all orders.
© kreon nv 12/2023

COLOPHON
Coordination Catalogue kreon
Typeface kreon
Printer GEWA , Arendonk (B)
Paper Arctic Volume White
<div><div>MIX Paper Supporting responsible forestry FSC® C009846</div></div>
Become part of the #worldofkreon <div><div> kreon.lighting</div><div> @kreon_lighting</div><div> kreon</div><div> kreonlighting</div></div>

kreon offices

kreon HQ
Industrieweg-Noord 1152
3660 Oudsbergen
Belgium
T +32 89 81 97 80
belgium@kreon.com
www.kreon.com

kreon China / The Belgian House
Changle Road Lane 672, No. 33,
Building No. 5,
Jingan, Shanghai
China
T +86 183 1711 3541
china@kreon.com

kreon France
5, rue d'Aboukir
75002 Paris
France
T +33 1 44 50 53 54
france@kreon.com

kreon Germany
Brühler Straße 11-13
50968 Cologne
Germany
T +49 221 937 22 0
germany@kreon.com

kreon Italy
Via V. Forcella 5
20144 Milano
Italy
T +39 02 89 42 08 46
italy@kreon.com

kreon Middle East & India
Dubai Airport Free Zone Area (DAFZA)
West Wing 6
Office 6 WA 634
P.O. Box 293889
Dubai
United Arab Emirates
T +971 56 705 2522
middle.east@kreon.com

kreon Inc.
North America & Canada
20 Murray Hill Parkway
Suite #180
East Rutherford NJ 07073
United States of America
+1 (201) 298-44 48
usa@kreon.com

kreon Scandinavia
T +31 (0)6 52 39 16 80
auke.bakker@kreon.com

kreon South East Asia
T +65 62 22 33 93
singapore@kreon.com

kreon Spain & Portugal
Ángel Guimera 7-9 local C
Barcelona 08017
Spain
T +34 600 462 551
spain@kreon.com

kreon Switzerland
Neufeldweg 6
5103 Möriken
Switzerland
T +41 61 316 74 01
switzerland@kreon.com

kreon The Netherlands
Danzigerbocht 39
1013 AM Amsterdam
The Netherlands
T +31 (0)6 52 391 680
the.netherlands@kreon.com

kreon Turkey
Şehit Murat Demirli Cad.
Resadiye Yolu 76
Alemdag-Ümraniye 34794
Istanbul
Turkey
T +90 216 430 86 00
turkey@kreon.com

kreon UK
67 Maltings Place
169 Tower Bridge Road
London
SE1 3LJ
United Kingdom
T +44 (0)20 7740 2112
uk@kreon.com