



# CS Cavity Slider<sup>®</sup> Pocket Door Frame



# Pocket Frame Systems

The CS Cavity Slider® is a practical solution for those areas where there is not enough space for a swinging door.

In addition to its space saving attributes in restrooms, hallways, and laundries, it can be used with confidence for architectural feature openings around your project.

## Features

- Structurally robust due to its construction from aluminum extrusions
- Easy to assemble and install
- Available for 2x4 and 2x6 framing
- Can be cut down to size on site
- Suitable for residential and commercial projects (meets Type 1 construction code without any combustible materials)

## Rough Opening

DH - Door Height    DW - Door Width

Dimension	Inches
RO Height	DH + 4-1/4"
RO Width   Single	(DW x 2) + 2"
RO Width   Bi-Parting	(DW x 4) + 2"

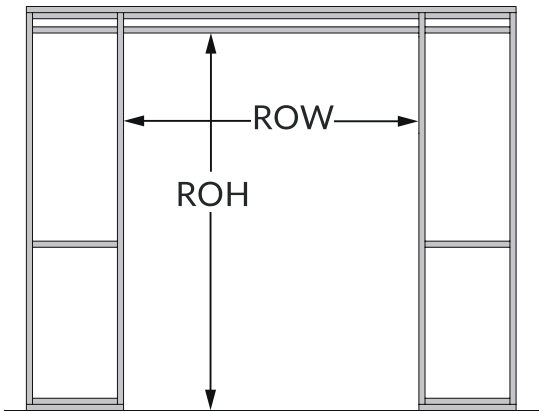

## How to Order

### 1. Choose Framing and Door Size

Frames can be cut down on site to maximize size for each model:

Framing	CS SKU	Max Door Size	
		Inches	Millimeter
4" Framing (2x4 Stud)*	CSS4K3068	3'0" x 6'8"	914 x 2032 mm
	CSS4K3080	3'0" x 8'0"	914 x 2438 mm
	CSS4K4080	4'0" x 8'0"	1219 x 2438 mm
6" Framing (2x6 Stud)	CSU6K2680	2'6" x 8'0"	762 x 2438 mm
	CSU6K3080	3'0" x 8'0"	914 x 2438 mm
	CSU6K4080	4'0" x 8'0"	1219 x 2438 mm
	CSU6K3090	3'0" x 9'0"	914 x 2743 mm
	CSU6K4090	4'0" x 9'0"	1219 x 2743 mm
	CSU6K30100	3'0" x 10'0"	914 x 3048 mm
	CSU6K40100	4'0" x 10'0"	1219 x 3048 mm
	CSU6K50100	5'0" x 10'0"	1524 x 3048 mm

\* More sizes available through distribution. Reach out for more information

### 2. Choose a Carriage Pack (one per door)

Includes: Carriages, mounting plates, T-Guide, fixing screws, and adjusting wrench

Standard	M6 (200 lb / 90 kg)	
	M8 (500 lb / 240 kg)	
	Minimum Door Width	
CS SofStop	No Stop	1 Stop
0 - 200 lb (90 kg)	23" (584 mm)	26" (660 mm)
CS SofStop HD	No Stop	1 Stop
0 - 350 lb (160 kg)	26" (660 mm)	29" (737 mm)

### 3. For 2x4 Stud Frames up to 8', choose your CS Jamb Kit

Includes: Head jambs, split jambs, closing jamb, and fixing screws

Door Size	Jamb Size	Door Thickness	Product SKU
3'0" x 8'0"	4-9/16"	1-3/8"	JK4SW3080-138-4916
		1-3/4"	JK4SW3080-134-4916
	4-7/8"	1-3/8"	JK4SW3080-138-478
		1-3/4"	JK4SW3080-134-478
4'0" x 8'0"	4-9/16"	1-3/4"	JK4SW4080-134-4916
	4-7/8"	1-3/4"	JK4SW4080-134-478

# CS Cavity Slider® Features with CS Jamb Kit™



**Smooth running carriages**  
with encased ball bearings.  
Up to 500 lb (240 kg) capacity

**SofStop Soft Close/Soft Open**  
also available



**Corner joining brackets**  
ensure precise right angled  
assembly

**Head jambs designed  
for serviceability**

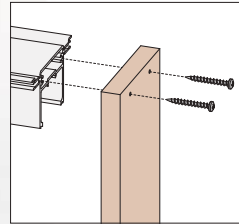

**Pre-drilled closing  
jamb** for seamless  
attachment to track  
profile



**2x4**



**2x6**

**Extruded aluminum  
track** incorporated into  
head unit



**T-joining brackets**  
for easy assembly of  
slats to split jambs &  
back stud

**Split Jambs  
and slats** use  
hollow core  
technology for superior  
rigidity

**Horizontal  
slats** for  
added  
strength

**Can be easily cut  
down on site** for  
custom door sizes

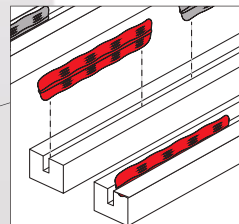

**Pre-grooved for  
Trim Clips** for quick  
& easy installation

Compatible with  
4" and 6" stud  
sizes

**Strong aluminum  
frame** complies with  
Type 1 Construction

**3/4" jamb  
thickness**

**Bottom plate  
assembly**

**Door Thickness**

1-3/8" to 1-3/4"  
2x4 Stud

1-3/8" to 2-1/4"  
2x6 Stud

**Stain-grade  
poplar** prepared  
and ready for  
paint

Patent Pending

**Adjustable  
T-Guide**



Cycle tested  
1 million openings



ADA Compliant



Available with  
SofStop®



Single or  
Bi-Parting units



Maximum door  
weight

Watch Video



# CS Cavity Slider® Pocket Door Frame

## Features

- Accommodates 1-3/8" to 1-3/4" doors (35 to 44.5mm)
- Up to 4'0" x 8'0" door size (1220 x 2438mm) and can be cut down on site
- Designed for 2x4 Stud Size

## Product Specifications

### Elevation

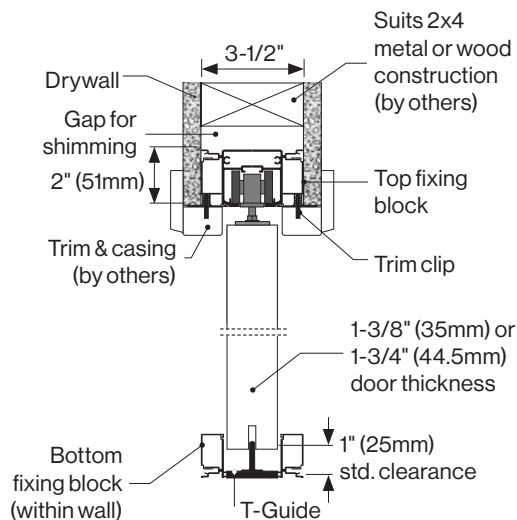

## Technical Specifications

### Plan

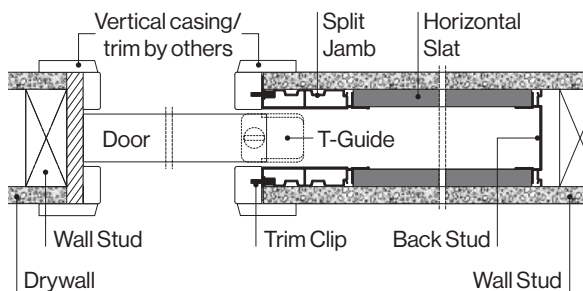

© All copyright and other property in this document is reserved by Cavity Sliders USA Inc. Details and specifications are subject to change without notice. Whilst all care is taken to ensure the accuracy of all information, no responsibility will be accepted for any errors or omissions. 06/2025

**CavitySliders.com**

sales@cavitysliders.com

(888) 466-0030

# CS Cavity Slider® Ultimate Pocket Door Frame

- The gold standard of pocket frames. It is the largest and most robust manufactured pocket frame on the market
- Accommodates 1-3/8" to 2-1/4" doors (35 to 57mm)
- Up to 5'0" x 10'0" door size (1524 x 3048mm) and can be cut down on site
- Designed for 2x6 Stud Size

### Elevation

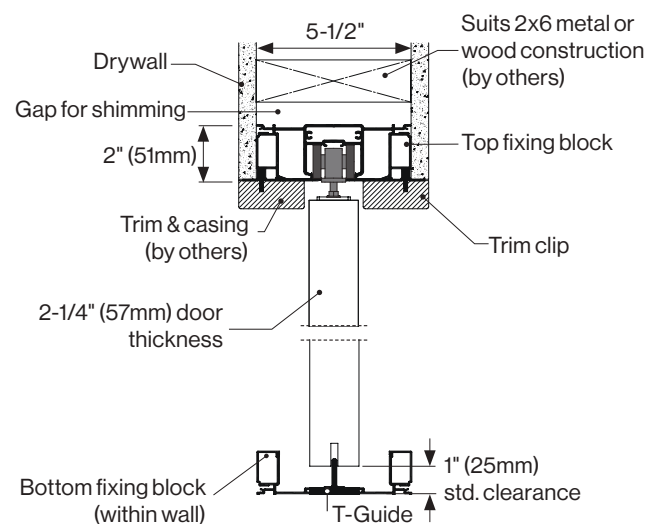

## Standard CS Track Features

- Heavy duty one-piece extruded aluminum track.
- Minimal clearance means the carriages/wheels cannot jump off the track or jam.
- Large diameter wheels with precision ground bearings make for smooth running.
- Radiused track reduces friction and allows dust to be pushed into the gutters so the door always slides smoothly.
- M8 body made from cast stainless steel for strength and reliability. 4-wheel carriages are standard on all doors over 200lb.
- CarriSnap™ quick release system allows the door to be removed easily from the track; no need to unscrew anything and lose door height adjustment.

Specs and Instructions

