

# ELEVATE

It's Time to Rethink the Walls Around You.



**MODULAR BY DESIGN. PROVEN BY EXPERIENCE.**

*Elevated Cabinets Engineered for What's Next in Care.*



# Because Your Facility Doesn't Stand Still

Healthcare keeps moving. Tight budgets, evolving regulations, and a constant stream of patients demand spaces that adapt. Storage should make daily routines easier, support infection control, and create calm, organized environments for patients and staff alike.

That's why we developed the **ELEVATE** wall-mounted cabinet line.

It's built to complement your fixed casework, adding flexible storage where your facility needs it most. Simple to install, easy to reconfigure, and backed by the same Case Systems quality you already trust.





**FLEXIBLE.**

**CLEANABLE.**

**FUTURE-READY.**

We've applied 75 years of casework expertise to meet the demands of today's healthcare environments. **ELEVATE** delivers cleanability, reconfigurability, long-term value, and smart financial performance.

Bracket-mounted, modular, and made in the USA, these cabinets install quickly, clean easily, and evolve with your facility as needs change.

Whether you're planning a renovation or building new, **ELEVATE** integrates seamlessly into your healthcare space.

# Storage That Works With You

## Enhanced Hygiene & Infection Control

### HYGIENE WITHOUT HASSLE

- Elevated mounting eliminates floor contact.
- Sloped tops reduce dust collection.
- Sealed cabinets leave no open seams or gaps.

**RESULT:** Lower HAI risk, cleaner patient environments.



## Optimized Workflow & Patient Experience

### FUNCTION WHERE IT MATTERS

- Modular layouts maximize storage without clutter.
- Glove, towel, and trash integrations at point-of-use.
- Optimized space and workflow.

**RESULT:** Streamlined spaces that give staff more time for care.



## Adaptability & Simple Installation

### CHANGE-FRIENDLY BY DESIGN

- Efficient adjustment brackets.
- Seamless reconfiguration.
- Perfect for renovations or phased upgrades.

**RESULT:** Built for today. Ready for tomorrow.

## Real-World Value & Faster Depreciation

### DESIGNED TO RESPECT YOUR BUDGET

- Classifies as furniture—not fixed assets.
- Depreciates over 7 years vs. 39.
- Durable, reconfigurable construction.

**RESULT:** Faster ROI with lower TCO.

*Ask your Case Systems representative how quickly you can get started!*

### FLEXIBILITY THAT STARTS AT INSTALLATION

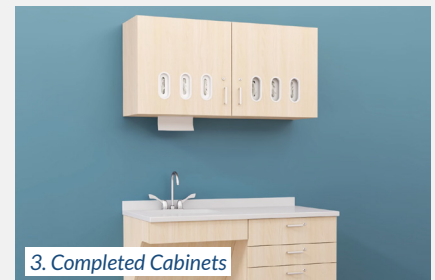
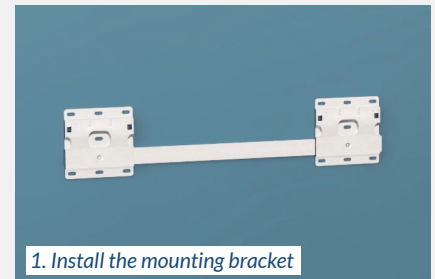

## TOTAL COST OF OWNERSHIP (TCO)

- **Reduced Installation Cost**  
Bracket systems installs faster than fixed systems.
- **Faster Depreciation**  
Classified as furniture = quicker depreciation schedule (7 vs. 39 years).
- **Easier to Clean**  
No base to trap dust and debris.  
Faster EVS routines = lower labor overtime.
- **Low Maintenance**  
Durable construction means fewer repairs and less downtime.
- **Easy Reconfiguration**  
Modular design allows relocation, reassignment, and reconfiguration without demolition.

*Built to perform and to pay-off.*

Disclaimer: The depreciation schedules and accounting information presented herein are provided by Case Systems, Inc. for general informational purposes only. They do not constitute legal, tax, accounting, or investment advice and should not be relied upon as such.





Northside Cherokee Hospital, Canton, GA

## Made in Michigan. Trusted Nationwide.

For over 75 years, Case Systems has delivered durable, American-made casework built to last. Our **ELEVATE** wall-mounted cabinets are the next evolution, blending our legacy of reliability with the flexibility your facility demands.

With **ELEVATE**, you get more than cabinets. You gain a trusted partner with nationwide dealer support and decades of proven performance, and a product line built for change.

### Case Systems in Numbers:

3M + Cabinets Built

30,000 Projects Completed



Riverside Regional Medical Center, Newport News, VA



St. Clair Healthcare, Morehead KY

# Built-In Support for Better Planning

Get everything you need to spec, visualize, and integrate:



## BIM MODELS

A full set of BIM and Revit models is available for the entire line, making it easy to integrate into your project plans and streamline your design process.



## 3-PART SPEC

Comprehensive 3-part specification are available to support accurate planning from design through installation.



## WARRANTY

We stand confidently behind our products, offering a 12-year limited warranty. Case Systems exclusively utilizes tested institutional hardware and the most robust materials.



## MEMBERSHIPS

Case Systems is a Member of:

- AIA
- AWI
- BIFMA



## SUSTAINABILITY

If your project calls for chain of custody, we have Forest Stewardship Council® (FSC®) materials available upon request. Your cabinets may also earn LEED® credits.



## DURABLE MATERIALS

At Case Systems, we use only top-tier core materials because great cabinets start from the inside out.

## Seamless Execution with Trusted Partners.

Case Systems' nationwide network of experienced dealers has partnered with us for decades. From design consultation to installation, your local dealer ensures your project runs smoothly from start to finish.







# Case Systems **ELEVATE**

**MODULAR FLEXIBILITY DELIVERING REAL-WORLD VALUE.**

Effortless cleaning. Faster depreciation. Smarter installs.  
Backed by Case Systems' reputation for quality and service.

Ready to design smarter spaces?  
Contact your Case Systems dealer today.  
**[casesystems.com](https://casesystems.com)**  
**989.496.9510**

