



Joining forces with powerful partners

KWC Professional joins DELABIE

Everything from a single source

We offer expertise in sanitary solutions and
smart water management systems

A high-angle, top-down photograph of a swimmer in a pool. The swimmer is positioned in the lower half of the frame, moving towards the bottom. They are wearing a black swim cap and a dark swimsuit. Their arms are extended forward, and their legs are also extended forward, creating a streamlined position. The water is a deep blue, and there is a significant splash of white water around the swimmer's head and arms. The pool floor is visible at the bottom, showing a grid pattern of dark lines. The overall lighting is bright, creating a clear view of the swimmer and the water.

DELABIE | **KWC**
Professional

KWC Professional becomes DELABIE ...

... and together we will become an even stronger partner as the European market leader for sanitary facilities and intelligent water management systems for commercial, public and semi-public areas.

As a specialised system and solution provider, we meet the highest standards of safety, hygiene and durability and can also offer our customers tailor-made solutions.

Our main segments include public infrastructures such as healthcare facilities, schools, transport and prisons, industrial and office buildings, restaurants and hotels.

We unite international production and sales locations in Germany, France, Portugal, Switzerland, Austria, United Kingdom, Finland and the United Arab Emirates.

With more than 150 years of tradition and innovation, we offer a wealth of expertise in technology and materials. We design aesthetic, unique products from high-quality materials such as 100% recyclable stainless steel or proven mineral granite (MIRANIT). Our electronic components and water management systems ensure excellent drinking water quality, touch-free safety, hygienic use and energy efficiency.

DELABIE – Joining forces with powerful partners	
Interview with Alice Delabie and Vincent Bogard	06
Interview with Gregor Wissler and Nicolas von Castelmur	09
Designing the future together	10
KWC Professional – System and solution provider	12





Our projects	14
360° Tour	24
Application areas – Educational institutions	26
3D washbasin configurator	28
WHX Tech – Review	30
Spot on – New showroom in Finland	32
DELABIE DVS	34
Empowering Care: Insights from a successful year of trade fairs	35
On the road for you	36

DELABIE – Joining forces with powerful partners

When you run a family company for nearly a century, you learn that the best transformations are those that stay true to your roots. The merger between DELABIE and KWC Professional is one of those moments – a turning point that opens new horizons while preserving what made each brand strong.

Vincent Bogard shares his vision for this new chapter. Alongside him, Alice Delabie brings a complementary perspective on design, innovation, and customer experience.

What does this merger change for your customers?

Vincent: When two specialists join forces, the customer should be the first to feel the difference. With KWC Professional, we enrich our expertise in stainless steel and electronic taps; with DELABIE, we bring a century of know-how in public washrooms.

Together, we offer more solutions, more technical depth, and more reliability.

Alice: For architects and designers, this merger means access to a broader palette of technologies and aesthetics.

It's about combining functionality with elegance – solutions that perform and inspire.

What is your vision for the combined Group?

Vincent: We want to build the European leader in washroom solutions for public places – not by erasing differences, but by using them. Each brand brings its strengths, its teams, its culture.

Our role is to assemble them in a way that elevates the whole.

Alice: Our ambition is also cultural: to create a shared identity that values innovation and design. We want every product to reflect durability, sustainability, and a sense of style.

How do you plan to manage the transition in 2026 and the evolution of the branding in 2027?

Vincent: Our priority is clarity and continuity for our partners. Throughout 2026, we will communicate proactively, provide training, and offer dedicated support to help everyone navigate the new ranges.

Alice: In 2027, we will move to a unified brand architecture. The guiding principle is straightforward: make business easier for our customers, help them benefit from an enlarged product portfolio.

Together, DELABIE and KWC Professional make our Group uniquely positioned to cater to all sanitary needs outside of the home.

How will this merger materialise commercially?

Vincent: We are building a single, unified commercial front. In practice, this means one team, one contact person per market, and access to the full range of DELABIE and KWC Professional solutions.

Alice: This simplifies interactions and strengthens our ability to support projects from design to installation. We know a brand's reputation relies on the quality of the services provided and of the products."



What changes can we expect in marketing and communication?

Alice: You will see a clearer, more consistent message. We are merging our catalogues, rebuilding our digital ecosystem, and reinforcing tools such as BIM. Our ambition is to make specification easier. We will invest a lot to be closer to every professional, through our sales teams and through key events and exhibitions.

What about customer service and order processing?

Vincent: We want to offer a seamless experience: faster responses, simplified ordering, clearer information.

Alice: By integrating our customer service teams and tools, we will be able to guarantee consistent quality and better visibility on

lead times, which we will reduce. Our goal is simple: make our partners' daily operations smoother.

What specific benefits will wholesalers gain?

Vincent: A stronger assortment, higher value-added solutions, more availability, and better logistics performance. With complementary ranges and optimised stock levels across Europe, our wholesalers will be able to serve more segments with fewer constraints.

Alice: Most importantly, they will benefit from a recognised brand and a business driven by our focus on specification. We will always strive to build long-lasting partnerships with wholesalers.

from left to right:
Patrick Delabie
Luc Delabie
Alice Delabie
Vincent Bogard



Alice Delabie
CFO, Delabie

How do you support specifiers?

Alice: Specifiers expect suitable solutions, reliability, and clarity. We provide them with dedicated technical support, high-quality digital tools, and ranges designed for long-term performance. We showcase our solutions in our showrooms, in our specification events, and at major exhibitions.

Innovation and sustainability: what is coming?

Vincent: Sustainability is no longer a chapter in the catalogue – it is the starting point. Durability, reparability, water efficiency: this is what guides our R&D.

Alice: Innovation must also inspire. We are accelerating the development of smart systems and new materials, but always with a focus on aesthetics and user experience. Connectivity will play a major role in hygiene and maintenance.

What message do you want to convey to your partners for 2026?

Vincent: 2026 will be a year of movement and opportunity. We are building a stronger Group, with clearer ranges and more services.

Alice: What will not change is our commitment: quality, long-term partnerships, and the certainty that each customer can rely on us. Together, we are shaping the washroom solutions of tomorrow.

Thank you for talking to us.



Vincent Bogard
Deputy Managing Director,
Delabie

DELABIE Showroom

In the centre of the company premises in Friville, you can experience the entire product portfolio live on 750 m² spread over three floors



One Team – One Goal

2026 will be a year of progress. However, every great challenge also comes with new opportunities. Gregor Wissler, CEO, and Nicolas von Castelmur, CFO of KWC Professional, share their insights into the progress of the integration process to now and the priorities for the next phase.

What will be the focus for the near future?

Gregor: We are proud of what has been achieved so far. The connection between our teams is becoming real.

What we see every day is professionalism, mutual curiosity, and the desire to make this integration a success. We must now keep up the pace and the energy, while maintaining business continuity and focus on our customers.

How has the international team interacted so far?

Nicolas: Since the acquisition of KWC Professional in August, our teams have engaged in site visits, introductory meetings, and many exchanges. These interactions have helped us understand each other better, learn from one another, and adjust some of our initial assumptions. This willingness to adjust and learn from one another is what will turn a group of companies into one shared culture.

Which objectives are particularly important in this regard?

Gregor: As we look ahead to 2026, our ambitions remain unchanged: be the leader in our market, build a unified and strong group

by combining DELABIE's and KWC's industrial excellence and extensive market experience.

Nicolas: In 2026, it is particularly important to me that we continue to focus on our customers, even though we are engaged in a challenging integration project. Only if we understand and exceed their expectations will the transformation create real added value and strengthen our position in the market.

What defines market leadership?

Gregor: Our focus as a specialist system provider for washroom solutions will continue to be clearly on applications in commercial and public spaces. Thanks to our combined expertise, we develop and produce modern washroom facilities, taps and intelligent water management systems for the future of washroom technology.

Thank you for talking to us.



Gregor Wissler

CEO, KWC Professional



Nicolas v. Castelmur

CFO, KWC Professional

Designing the future together

Due to new general conditions and government modernisation initiatives, public buildings need to be rethought. Hygienic, safe, inclusive and durable in operation. This change affects healthcare buildings as well as military and municipal facilities.



A place of gathering and community

Hospital and healthcare reform is leading clinics to reorganise their structures and processes. More ambulatory care and clearer service profiles are increasing the requirements for safety and technical hygiene – especially in sanitary facilities and drinking water systems. For planning and construction, this means that washrooms are designed to be functional and easy to clean; intelligent taps and automated flushing programmes ensure consistent drinking water hygiene – regardless of variations in usage.

KWC Professional supports this with Aqua 3000 open and the C-module, which allow flushing processes and hygiene documentation to be controlled flexibly and economically – for different building types and budgets.

Quick, flexible, reliable – the Armed Forces are rebuilding

The Armed Forces are rapidly expanding their accommodation, training and functional buildings as part of the extraordinary fund. Standardised and module-based construction methods speed up construction times – while increasing requirements for operational safety, reliability and supply in crisis situations. For planning and building technology, this means that systems must be scalable, robust and reliably controllable during operation. Modular sanitary facilities simplify installation and maintenance, while digital water management systems ensure drinking water hygiene – and must be cyber-resilient and operable independently of the public network.

KWC Professional supports this with plug-and-play system solutions such as the PLANOX washbasin unit and the wired AQUA 3000 open water management system, which enables protected, network-independent and secure operation.



Tomorrow's sports facilities for everyone

The national programmes for the renovation of municipal sports facilities is being used to refurbish and upgrade existing facilities. The aim is to create open, safe and inclusive sports and meeting places that can be used by schools, clubs and recreational users alike. For planning and building services engineering, this means that durability, ease of cleaning and resource-efficient operation are becoming increasingly important. Washroom equipment should be robust and only provide water and energy when they are actually needed.

KWC Professional offers durable, easy-to-clean sanitary solutions such as MIRANIT basins and touchless, configurable taps across different product ranges. They only provide water when it is needed, reduce resource consumption and enable safe, efficient operation.

Everything from a single source

KWC Professional joins the DELABIE Group – together we will combine our expertise. To support you as a strong partner for washroom solutions and smart water management systems in commercial, public and semi-public areas.

Our main focus is on enriching the quality of life of our customers.

This is what we stand for with our values of safety, sustainability, hygiene and enthusiasm. We guide ourselves and our company according to these values. At KWC Professional, we focus on high-quality, tailor-made solutions that impress and inspire. These values shape our daily work at all locations and provide us with guidance for future developments. We design aesthetic, unique products from high-quality materials such as 100% recyclable stainless steel or proven mineral granite (MIRANIT). Our electronic components ensure touch-free safety, hygienic use and energy efficiency.

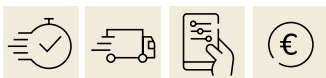

Your benefits:

- ✓ A single point of contact
- ✓ Customised and special solutions
- ✓ Design lines that can be combined
- ✓ Installation: save time and money
- ✓ Logistics: short distances
- ✓ Manages all the parts
- ✓ Service and maintenance
- ✓ Support for planning and execution

Our projects



Sports & leisure



Healthcare



Public washroom facilities



Industry



Educational institutions



Office complexes



Hospitality



Safety & custodial

Our projects





MSG CAMPUS - NURSERY SCHOOL MERSEBURG | GERMANY

Making an impact

A former telephone exchange on the campus of Merseburg University of Applied Sciences was converted by the Halle Student Services Association into a nursery for 42 children aged 0 to 6. A cathedral-like room in the basement, lit from one side, was ideal as a playroom for the children.

The existing building structure also proved to be remarkably flexible for accommodating group rooms, a kitchen and washroom facilities, which were equipped with F5 single-lever mixers with integrated thermostatic scald protection.



KWC F5L-THERM
Thermostatic single-lever pillar mixer
F5LT1001 | 2030066480

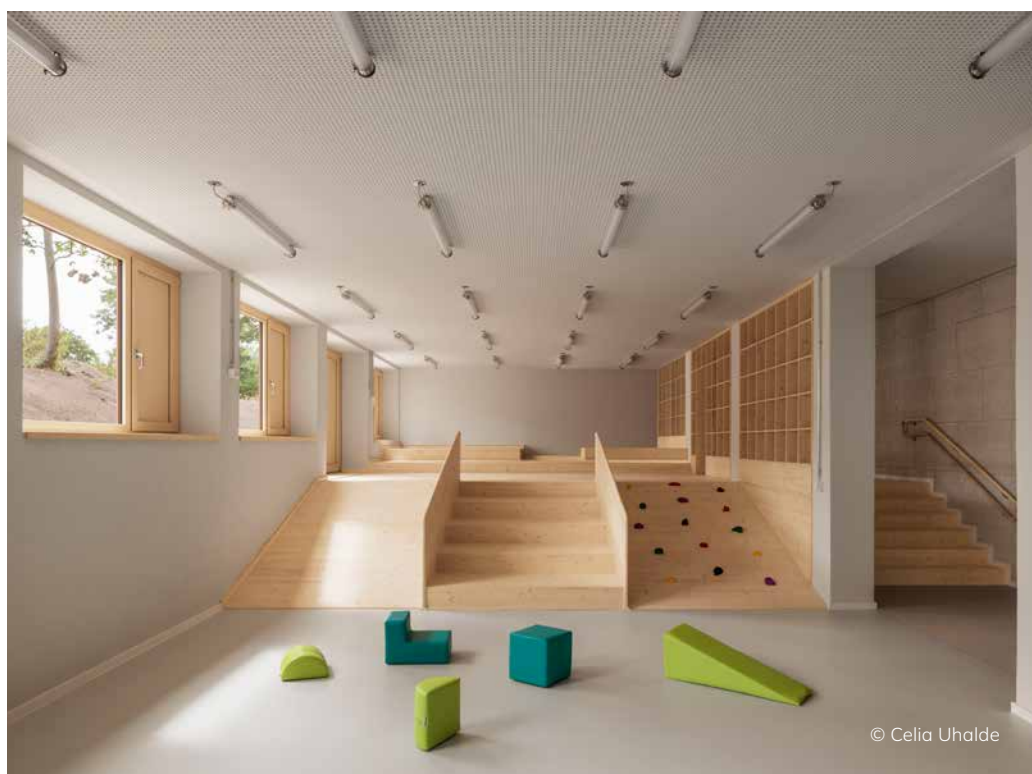



SPORTS HALL LÖDERBURG | GERMANY

A place for gathering and community

The sports hall in Löderburg (a district of Stassfurt) had been out-of-use for more than six years. Due to safety defects and significant damage to the building, it was closed in 2018. Following extensive renovation and modernisation work, the official reopening took place at the end of May 2025.



KWC FUTURA exklusiv
Multiple washbasin
SANW1200 | 2030057405



OLYMPIC-SIZE SWIMMING POOL ST. LORENZ LÜBECK | GERMANY

Ready, Steady, Go!

As Lübeck's largest indoor swimming pool, the St. Lorenz Sports Pool has been the top venue for swimming competitions and elite sports since 1974. Following extensive modernisation at the end of 2022, the pool reopened its doors in January 2025. Swimming enthusiasts can enjoy a premium stainless steel pool complete with a spiral bridge, an additional training pool, a lovingly designed area for toddlers, and a fully refurbished interior.

For the renovation, stainless steel shower panels from the F5 line were installed thanks to their high degree of prefabrication and easy surface-mounted installation.

These panels feature electronically controlled thermostatic mixers with active scald protection. In the washroom area, the opto-electronically controlled F5E-Mix impresses with its elegant design. The clearly visible infrared sensor detects approaching hands and activates the water flow. When hands leave the sensor area, the water flow stops automatically, ensuring no water is wasted unnecessarily.



KWC F5E-Therm
Stainless steel shower panel

F5ET2020 | 2030054250



KWC F5E-MIX
Electronic pillar mixer for
separate power supply

F5EM1004 | 2030036159

MARINA HEILIGENHAFEN | GERMANY

Saving resources

The building at Pier 8 in Marina Heiligenhafen has been completely renovated down to its supporting walls and now features modern, sustainable equipment, including a solar thermal system for renewable hot water generation. Work began as scheduled at the end of the 2024 season and has now been completed thanks to the commitment of all trades and manufacturers involved.



KWC F7E
Electronic pillar mixer

F7EM1001 | 3600001257



Season opening

OUTDOOR POOL NEUHOFEN YBBS | AUSTRIA

Keep your cool

Whether it's swimming laps or simply cooling off and relaxing, the F3 free-standing showers from KWC Professional provide quick refreshment – right by the poolside, on the sunbathing lawn, or in the outdoor wellness area. Durable, stylish, and always ready for use. Here in action at the outdoor pool in Neuhofen, Austria.

	<p>KWC F3S Free-standing shower F3SV2014 3600006748</p>
--	--





GRAVAS CAMPSITE | SWITZERLAND

Hygiene & Comfort

Located on the edge of Lenzerheide village at 1,460 metres above sea level, Gravas Campsite offers an idyllic setting in the heart of Graubünden. Its prime location, with direct access to the Arosa/Lenzerheide holiday region, provides a wealth of sports, leisure, and relaxation opportunities all year round. The area also hosts major sporting events, including the Biathlon World Championships 2025, underscoring its appeal and high demand during peak seasons. The new service building and forest camping pitches were opened at the end of 2024.

Guests can now enjoy modern, spotless facilities featuring custom-made VARIUS washstands crafted from MIRANIT. The VARIUS range delivers tailored sanitary solutions for optimal space utilisation. Here, the rectangular ETON basin has been seamlessly integrated into the countertop, complemented by a discreet apron with waste chutes and bins. Instead of the standard Alpine White, the operators opted for a stylish light-grey granite finish. Seamlessly created from a single cast, MIRANIT products cut an impressive figure due to properties such as high stability, an elegant appearance, and – thanks to the smooth, pore-free, hygienic and easy-care gel coating – outstanding resistance.



Discover now

configurator.kwc-professional.com



HMP WETHERBY | UK

Compact Modular Design

In 2024, KWC DVS acquired Newcastle Joinery Limited (NJL), a strong partner for durable cell furniture and modular sanitary systems in the UK, thereby expanding its extensive product portfolio in the custodial and security sector.

A key advantage is the use of robust glass-fibre reinforced plastic (GRP), an impact-resistant and corrosion-proof composite material. In modular construction, the "In-Cell Shower Pods" are particularly widely used. Each complete unit fits seamlessly into the existing cell structure and includes a WC, washbasin, mirror, shelf, LED lighting, and shower.



DR. SOLIMAN FAKEEH HOSPITAL RIYADH | UAE

Safety first

As one of KWC Professional's flagship projects in the Middle East, the Dr. Soliman Fakeeh Hospital in Riyadh demonstrates our expertise in providing safe, durable, and hygienic sanitary solutions for demanding environments. The installation is designed to ensure patient comfort, accessibility, and long-term performance – even with intensive daily use.

	<p>KWC CAMPUS WC pan</p> <p>Custom-made for the healthcare sector</p>
	<p>KWC HEAVY-DUTY KWC CONTINA Accessories</p>

PRISON NUREMBERG | GERMANY

Multiple construction phases completed

The extreme conditions present in a prison place special demands on planning and product solutions. For this reason, the Nuremberg prison chose sanitary solutions from KWC Professional for its entrance and exit building. Among the installations were robust sanitary combinations made of durable stainless steel. During the renovation of the shower facilities in another construction phase, special wall-mounted fittings from the HEAVY-DUTY range were used. From the outside, only the piezo button embedded in the stainless steel cover plate, secured with safety screws, is visible. Active scald protection is provided by the integrated thermostat. This electronic tap solution can be centrally monitored and controlled via the AQUA 3000 open water management system.



KWC F5ET - A3000 open
Electronic thermostatic in-wall mixer
with covered temperature setting



KWC HEAVY-DUTY
WC washbasin combination
HDTX805M | 2000100954



© euroluftbild.de/Oliver Betz

Discover now

Our HEAVY-DUTY product range



SIR JOHN LEMAN HIGH SCHOOL BECCLES | UK

School refresh

Sir John Leman High School has recently transformed its student washrooms, creating a cleaner, smarter, and more efficient space that supports hygiene and sustainability throughout the school day. This project, delivered in partnership with Inspired Washrooms, showcases how thoughtful design and quality products can positively impact daily school life. To meet the demands of a busy secondary school environment, the refurbishment included new washbasins, water-saving taps, premium soap dispensers, updated flooring, and modern lighting to create bright, welcoming washrooms that are easy to maintain.

The SOLX Miranit washtrough delivers a seamless, non-porous surface crafted from advanced resin and granite composite, ensuring exceptional durability while maintaining a sleek, modern look. Its robust design means it can easily handle the heavy daily use of a busy school environment.

The F3SV self-closing taps reduce water consumption without compromising on ease of use. Featuring a piston-free, self-closing mechanism with adjustable flow time, these taps are simple for students to operate while helping the school lower water waste and utility costs. To further enhance hygiene, RODAN Soap Dispensers were installed throughout the washrooms. Made from satin finished stainless steel, these dispensers combine style with practicality, featuring a 0.8 litre tank for liquid soap and a user-friendly pull lever that encourages effective hand hygiene.



	<p>KWC SOLX Washtrough</p> <p>SOLX1800T 203.0000.238</p>
	<p>KWC F3S Self-closing pillar tap</p> <p>F3SV1101 3600001423</p>
	<p>KWC RODAN Soap dispenser for wall mounting</p> <p>RODX618 2000090067</p>

PILATUS ARENA KRIENS | CH

Places of interest

The development and execution of the modern midsize arena was the responsibility of Halter AG. The result is a unique building complex consisting of the Pilatus Tower and Pilatus Arena, distinguished by its contemporary architecture, versatile usage options, and well-thought-out infrastructure.

The high standards of quality are also evident in the functional areas – here, MIRANIT shower panels from KWC Professional are among the features installed.

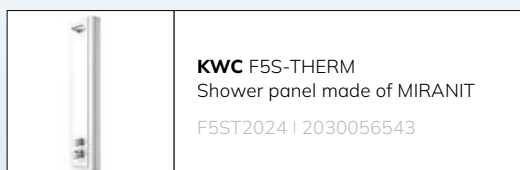

360° Virtual Experience

Start your journey now through inspiring sanitary worlds in a wide variety of application areas. Each room shows a typical installation setup featuring various products from our range for public and commercial sanitary facilities.

You can navigate 360° through the room using your mouse and click on any hotspot. This will take you to specific product pages, product overviews, as well as videos and animations with explanations.



Safety & Custodial

Have a look into a prison cell



Discover now

Start the 360° guided tour



Application areas:

- Health & Care
- Sports & Leisure
- Industry
- Prison & Security
- Science & Research
- Education

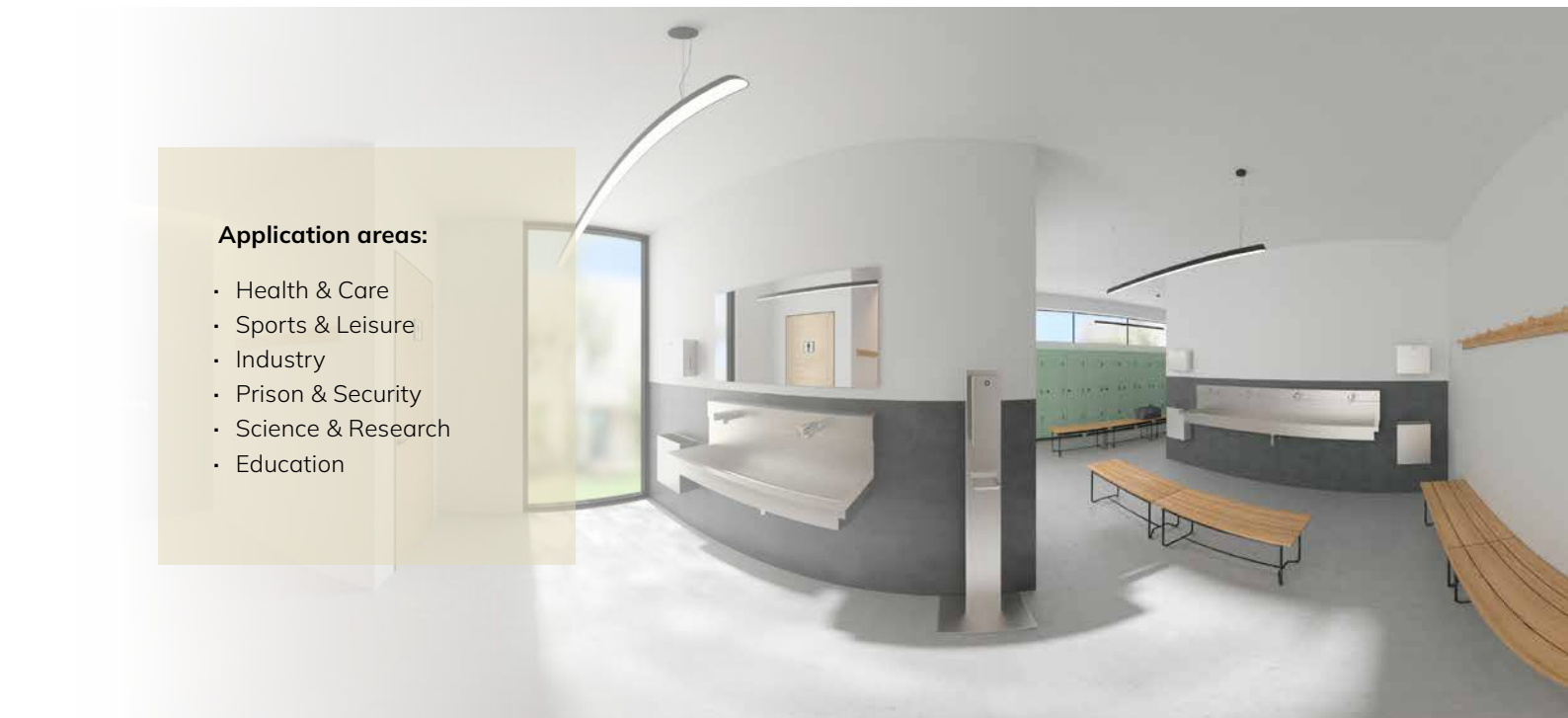



Educational Campus + Heidemarie Lex-Nalis in Vienna

F5L-Therm single-lever mixers, F5 self-closing taps and workroom sinks from KWC Professional were used

© Paul Sebesta

Bring Your Vision to Life

Design your own sanitary space with the KWC Professional 3D Washbasin Configurator

Imagine creating a space that reflects your vision down to the smallest detail. With the KWC Professional 3D Washbasin Configurator, flexibility and individuality become reality. Watch your washbasin come to life in stunning 3D – right on your screen – and discover the endless possibilities of our MIRANIT solutions. Integrate your design into project plans and turn ideas into offers with ease.



Discover now

configurator.kwc-professional.com



Select trough design



VARIUSsign



EXOS.



VARIUSmed



MEDCARE

Define details

- ✓ Installation type: Free-standing in front of the wall, in the corner or in a niche
- ✓ Edge type, e.g. with a bevelled edge or a radius corner
- ✓ Length freely scalable up to a total length of 3,600mm
- ✓ Positioning of the trough, note: It is important to specify the angle for the planned installation in a corner or niche

Other options and accessories:

- ✓ Apron or upstand
- ✓ Tap or soap dispenser hole
- ✓ Integrated cut-outs for paper disposal, paper towel dispenser, tissue dispenser or towel holder
- ✓ Surface and colour options
- ✓ Siphon and waste accessories, and much more

Project example: The refurbishment of a public washroom facility in Radolfzell. Hygiene and a clear focus on cleanability.



WHX Tech – Review

Innovative stainless steel washroom solutions and smart water management solutions for the Middle East market. A visionary exchange.

WHX Tech is the international event where digital innovations in healthcare meet real-world applications.

By participating, KWC Professional set another milestone in strengthening our presence in the Middle East. The trade fair provided a valuable platform to connect with industry leaders, consultants, and partners to showcase our latest solutions for stainless steel washroom systems.

Hygiene first: We showcased taps, touch-free dispensers, and smart systems that reduce contact and improve safety in hospitals.

Smart control: Our INFORM system helps monitor and manage water consumption and ensures reliable hygiene in healthcare facilities. Water saving technologies support both hospital hygiene and sustainability, underscoring our commitment to environmental responsibility.





above:

KWC Professional booth:
Our team shows the smart water management solutions with the C-module, AQUA 3000 open & INFORM for different application areas

right:

Stefano Scuotri delivered a speech about intelligent hygiene solutions in the sanitary sector on the "future x" stage.



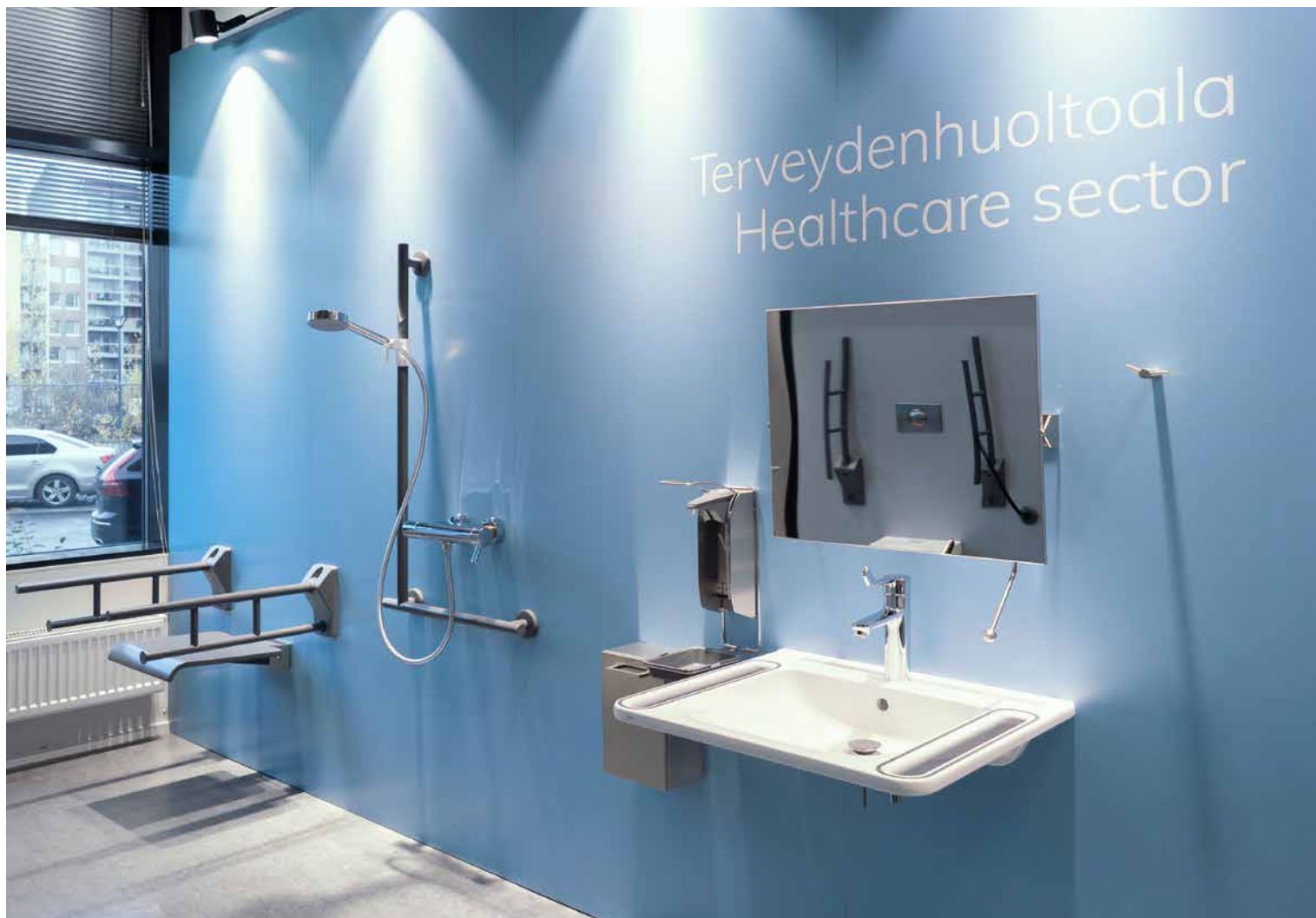

Spot on!

We opened our new showroom in Finland in October 2025 – a space created for inspiration and exchange.



Sometimes a great idea starts quietly – as a desire to not only show our customers products, but to create experiences. This is exactly how the idea of a dedicated showroom for KWC Professional Northern Europe came about.

At the end of October 2025, this wish became reality: in Vantaa (Finland), just a stone's throw from Helsinki-Vantaa Airport, our team created a place where quality can not only be seen, but also felt. A place where stainless steel, sensor technology and water technology suddenly come to life. Here, our colleagues guide customers through real-life application situations, demonstrate functions in detail and bring solutions closer to life in a way that would never be possible on paper. And that is exactly what many of our partners had long wished for.

In the future, the showroom will be a meeting place, a space for inspiration and a stage for joint events – a place that our team has put their heart and soul into creating and is now continuing to fill with life together with our customers.

The official opening was marked by the symbolic cutting of the red ribbon by Jari Mehto, Managing Director of KWC Professional Northern Europe, and Vincent Bogard, Deputy Managing Director of DELABIE.





DELABIE | DVS

Leading the way in Automatic Washroom Technology

In 2026, KWC DVS Ltd. will become DELABIE DVS. Specialising in water saving technology for commercial washrooms, the company has been producing leading automatic washroom technology for over 35 years.

The manufacturer, located in UK, is a market leader in the field of water-saving commercial washroom products along with automatic washroom products for specialist applications, including the healthcare, mental healthcare, custodial and public sector markets.

Alongside the extensive product portfolio of WC flush valves, urinal controls, automatic taps, safe ensuite and water management controls, an expert team of engineers are on hand to support installations, whilst our technical sales teams give tailored project support and specification advice.

The product solutions combine the benefits of reduced water consumption with a focus on hygienic design.

DELABIE DVS are proud to be part of this global Group and produce quality products that have been used reliably in some of the most demanding commercial environments for many years.



Empowering Care: Insights from a successful year of trade fairs

With proven expertise in healthcare – especially in demanding clinical environments – KWC DVS entered a strong trade fair year in 2025.

From washbasins and plaster sinks to electronic fittings and advanced temperature monitoring systems, we deliver everything from standard products to fully customised solutions. Alongside numerous trade fair appearances, KWC DVS is driving the **"Future Health Spaces"** initiative – a collaboration that explores new ways to design healthcare environments with a focus on efficiency, safety, and sustainability.



A special highlight at the **"Design in Mental Health"** exhibition in Manchester was the presentation by Stewart Warwick, KWC DVS INFORM Product Manager. He showcased the features and benefits of INFORM data management for optimising water management in healthcare facilities.

Visitors to the exhibition also had the chance to explore shower pods made from ligature-resistant materials, secure and durable furniture, and of course, the latest innovations in the INFORM water management system – designed for intelligent, safe monitoring.



The **"Healthcare Estates"** exhibition is aimed at professionals in hospital and healthcare construction, building management, technical building services, facility management, and healthcare engineering. Its goal is to showcase the latest developments in the planning, construction, operation, and management of healthcare facilities – and to connect professionals with suppliers, planners, and decision-makers.

KWC DVS proudly participated as the event's main sponsor. We would like to thank everyone for an outstanding trade fair year in 2025, filled with inspiring conversations and valuable industry insights.

Professionals on the road for you

Experience Our Products Live: Expertise You Can Feel!

We bring you a local showroom experience, showcasing the highlights of the KWC Professional product range for public and commercial sanitary spaces: cutting-edge, standards-compliant F3 & F5 tap technologies, the AQUA 3000 open water management system, accessories, taps and so much more.



Variable exhibitor size



10 x 4.50 x 5 m (W x H x D)



7 x 4.50 x 5 m (W x H x D)

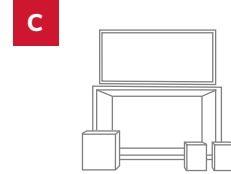

5 x 4.50 x 5 m (W x H x D)

Contact us and get more information

anfrage.de@kwc-professional.com

Review of past exhibitions



KWC Professional Poland

Training for Bims employees, installers, planners, with a focus on: F4 taps, washbasins with integrated handles, urinal units and solutions for prisons



FKT Fair Gelsenkirchen, Germany

7th Hospital Technology Trade Fair with Healthcare Technology Symposium, the MOBOX was parked centrally

© Matthias Tafelmeyer

Imprint

Publisher

KWC Group Management AG
Durisolstrasse 6
CH-5612 Villmergen
T +41 62 207 69 00

Responsible for content
Gregor Wissler (CEO)
Nikolas von Castelmur (CFO)

Copyright

All rights reserved.
Articles may only be reprinted with the written permission of KWC Group Management AG and with precise reference to the source. We reserve the right to make technical modifications to the design of the products. Colour deviations due to printing are possible.

Idea and concept

KWC Professional

Picture credits

02-03: iStock © gorodenkoff
04, 07, 08: DELABIE Group
04, 10, 11: KI-Tool © Leonardo AI
05, 14, 15: © Celia Uhalde
21: © euroluftbild.de/ Oliver Betz
20, 22, 34-35: KWC DVS Ltd.
26-27: © Paul Sebesta
23: © Halter AG
31: KWC ME LLC
32-33: KWC Northern Europe Oy
37: © Matthias Tafelmeyer
39: iStock © AscentXmedia
all other figures: KWC Professional

Errors and technical modifications reserved.



KWC Professional becomes **DELABIE**.

