



Cladding

INSTALLATION GUIDE

2025.02



ARBOR
WOOD co

THERMALLY MODIFIED WOOD

STORAGE & HANDLING

Arbor Wood Co. products should be stored indoors whenever possible and/or remain covered with a waterproof tarp until ready for installation. Boards must be stacked uniformly and elevated off the ground a minimum of 4". Avoid exposure to sunlight/UV as it can cause the boards to become lighter in tone. Always remember to handle with care when moving the product.

Arbor Wood has a lower moisture content and reduced expansion/contraction than standard wood, but it is still a good practice to ensure the wood has properly acclimated to local site conditions. It is recommended to have Arbor Wood Co. products on site for a minimum of one week prior to installation to acclimatize to the moisture and humidity of the installation environment. It is best to avoid storing materials on-site for prolonged periods prior to installation unless stored indoors in a dry location.

COLOR & WEATHERING

Thermal modification changes the naturally occurring sugars in the wood, resulting in beautiful, rich, brown tones which extend through the full thickness of the material. Since Arbor Wood is still a natural product it is subject to variations in weight, density, color, and grain patterns. In an exterior environment, unfinished Arbor Wood products will move to a beautiful silver/gray in 12-18 months. This does not impact the performance characteristics of the wood itself. The speed of this graying process depends on the intensity of exposure to environmental elements like the sun and rain combined with the type of application. Regular maintenance with a penetrating oil will reduce checking and cracking and will extend the life expectancy of the product.



Arbor Wood Ash : Raw



Arbor Wood Ash : Raw - Aged 6-12 mos.



Arbor Wood Ash : Raw - Fully Weathered

To maintain the original color we recommend applying a penetrating oil such as Cutek Extreme® along with a UV Colortone as clear oil finishes alone are not UV resistant. A light sanding or application of Cutek Wood Reviver will remove the surface silvering and restore the original wood tones. Please note, product color and factory applied finishes are not covered under the product warranty.



FINISHING

Pre-finishing all cladding boards prior to assembly is the only way to ensure that all 4 sides are coated evenly. It is highly recommended to coat all wood cladding with a penetrating oil such as Cutek Extreme® along with a UV Colortone prior to installation on all 4 sides. This process helps the wood acclimate more slowly and minimizes surface checking and wood movement. Even if your goal is to allow the wood to naturally gray or silver out over time, finishing at this point will help protect the wood when it is most vulnerable.

NOTE: *Whether you are finishing the project or not, sealing all cut ends with an end grain sealer or clear oil finish is highly recommended to reduce cracking and/or checking near the ends of the boards.*

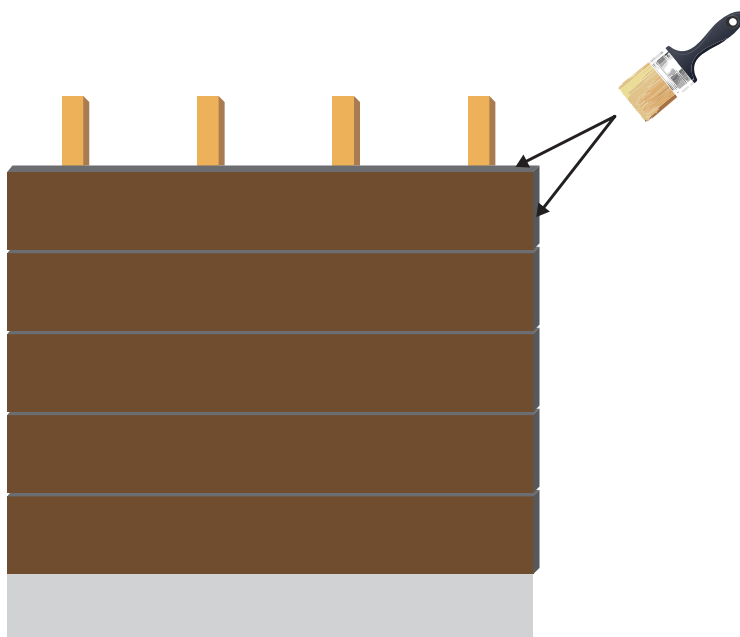

GRAIN PATTERN, CHECKS, & HAIRLINE CRACKS

As Arbor Wood is a natural wood product, there may be a variance in grain from board to board. It is also possible to observe some small surface checking and/or hairline cracks in the wood. These instances are a natural occurrence and are not a reason for a claim. Regular application of Cutek Extreme® can help minimize the occurrence of surface hairline cracks.

CARE & MAINTENANCE

It is important to ensure the surface of your wood remains clean. Black surface stains can be caused by dirt, debris, pollen and other airborne and microscopic elements resting on the surface of the material. Certain environments provide exceptional growing conditions for mold and fungus, conditions that often fall within, but are not limited to shaded decks or cladding. This does not impact the integrity of the wood but it does mean you should be clearing the surface of your deck more often and taking additional preventative care considering surrounding conditions. It is important to remember the same occurrence can happen on any surface, such as rocks, glass, PVC, and composite products. This staining is removable with light pressure washing and a renewing/cleaning agent.



WUI COMPLIANT INSTALLATION

When installing Arbor Wood cladding in a WUI (Wildland Urban Interface) zone it is imperative to install the cladding directly to the sheathing and to forego the use of furring strips in order to have a compliant wall assembly. It is recommended to install Arbor Wood Cladding products over gypsum board or another fire-rated sheathing material. Please consult the local building code in your area for a full list of requirements and to ensure your walls are compliant with requirements for ignition resistant construction in WUI areas. For more information on WUI and requirements please speak with your local building code inspector.

WARRANTY

Arbor Wood Co. Products are covered under a limited 20-year Warranty. This Arbor Wood Co. warranty is made to the original purchaser of the Product(s) (the "Purchaser"); the original owner of the structure on which the Product(s) are installed; and to the next owner of that structure (together "Owner"). Arbor Wood Co. express warranties may not be assigned to any subsequent owners of the structure. Arbor Wood Co. warrants that the Product(s) will remain free from fungal degradation, buckling, structural failure, separating, and rupturing for a period of 20 years from the date the installation is completed. When the Product(s) have been stored, handled, applied, finished and maintained in accordance with Arbor Wood Co.'s installation, application, finishing and maintenance instructions in effect at the time of application. Color and applied finishes are not warranted. These warranties apply only to above-ground installations made in accordance with the instructions. Be sure to consult full product warranty for specific questions.



WARNING

Do not use a mallet or hammer to install Arbor Wood Co. cladding products, doing so will void the warranty. Arbor Wood Co. cladding is designed to have an expansion gap to allow the product to acclimate to the installation location.

Do not use nails to fasten your Arbor Wood Co. cladding. Doing so will void the warranty. Only stainless-steel screws are approved for installation.

**FOR MORE INFORMATION,
INCLUDING FULL WARRANTY,
HOW-TO VIDEOS & MORE,
FOLLOW THE QR CODE.**



Cladding Installation

DISCLAIMER

Consult your local building code to ensure your project is installed in accordance with local requirements and consult your local building office to understand permitting requirements. Drawings and schematics used to show where to place screws and nails are for reference purposes only. Safety glasses and a dust mask should always be worn when working with Arbor Wood. Drilling, sawing, sanding or machining wood products generates wood dust. Avoid inhaling wood dust or use a dust mask or other safeguards for personal protection. Arbor Wood Co. recommends end-sealing cut boards with a clear, water-resistant penetrating oil such as Cutek Extreme®.

Standard Tongue & Groove Installation

FURRING & SPACING

Arbor Wood Co. recommends cladding products to be installed with proper furring strips and rain screen to allow for necessary airflow. Arbor Wood tongue & groove cladding not secured to proper furring will void the warranty. Recommended thickness for furring is $\frac{3}{4}$ ".

NOTE: For WUI compliance, cladding must be secured directly to the sheathing without the use of furring. For more on WUI, see WUI Compliant Installation above. Non-WUI installations should always use furring. The furring should be hung in a way that the cladding can be fastened every 16" OC and the seams break on furring. Seams may require double furring to ensure there is enough to fasten both pieces of cladding properly.

NOTE: If using product that features an end match joint there is no need to end on furring and fasten with a butt joint, simply match the male end of the first board with the female end of the next board (or vice versa) and continue with installation. Ensure the boards are fastened securely on either furring strip to the sides of the end match joint before proceeding.



End Match Joint

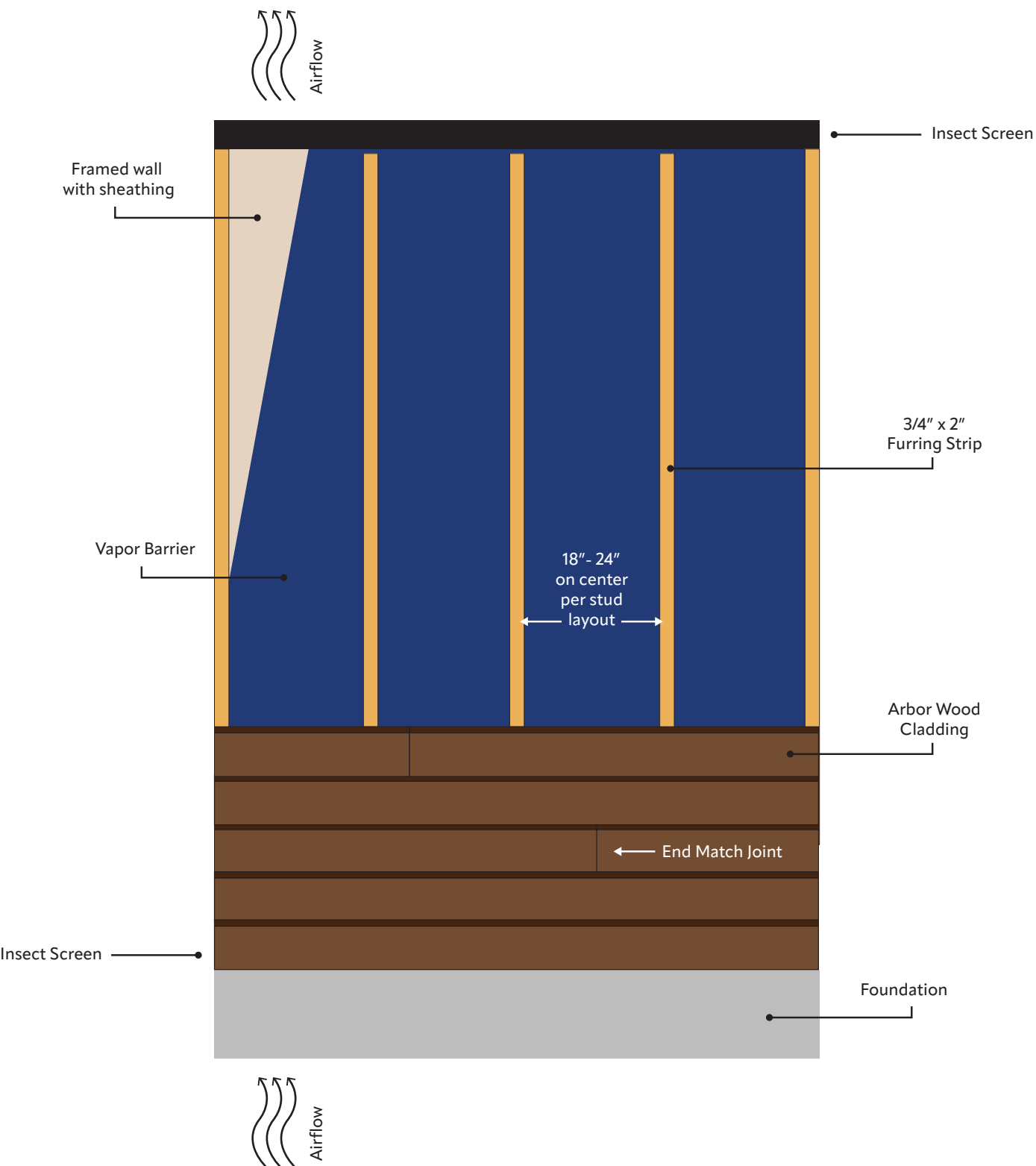

FASTENERS

A minimum 2-1/2" #8 or #7 stainless steel trim head screw is recommended to be driven at a 45° angle at the base of the tongue so that it passes through the full thickness of the cladding. Any screw smaller than a #7 will void the warranty. Sink the screw so it is even with the corner of the tongue, do not over sink or leave screw head exposed.

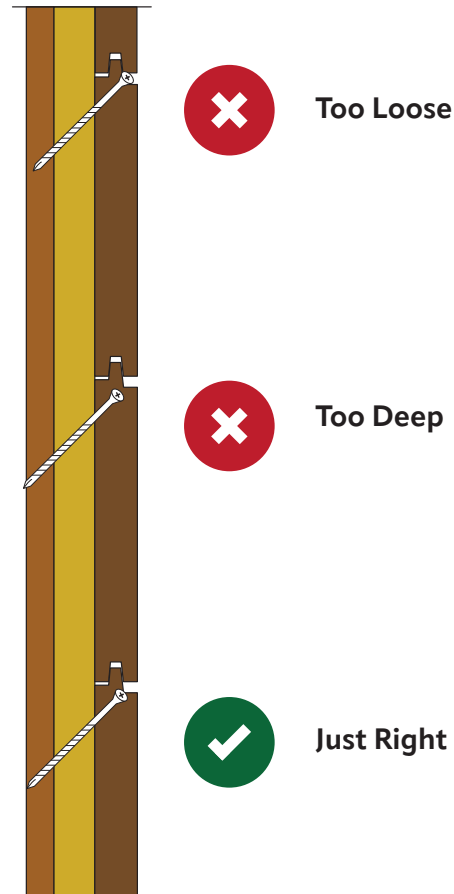

NOTE: If installing cladding wider than nominal 6" a face fastened screw should be added to the bottom of installed board in addition to the tongue.

NOTE: Even if using self-tapping screws, Arbor Wood recommends predrilling to greatly reduce the chance of splitting.

GROUND CLEARANCE

Arbor Wood Co. recommends ground clearance of at least 12" for all cladding projects. At the very least the ventilation gap behind the cladding must stay open from below to ensure air circulation. Furring with proper bug screening should be used at the bottom and top of the installation. Top and bottom must not be obstructed, leave at least 1/4" of gap from soffit on top or water table on bottom. To avoid splitting, secure fastener a minimum of 3/4" of space from edge of the board.



Standard Horizontal Tongue & Groove Installation - Side View

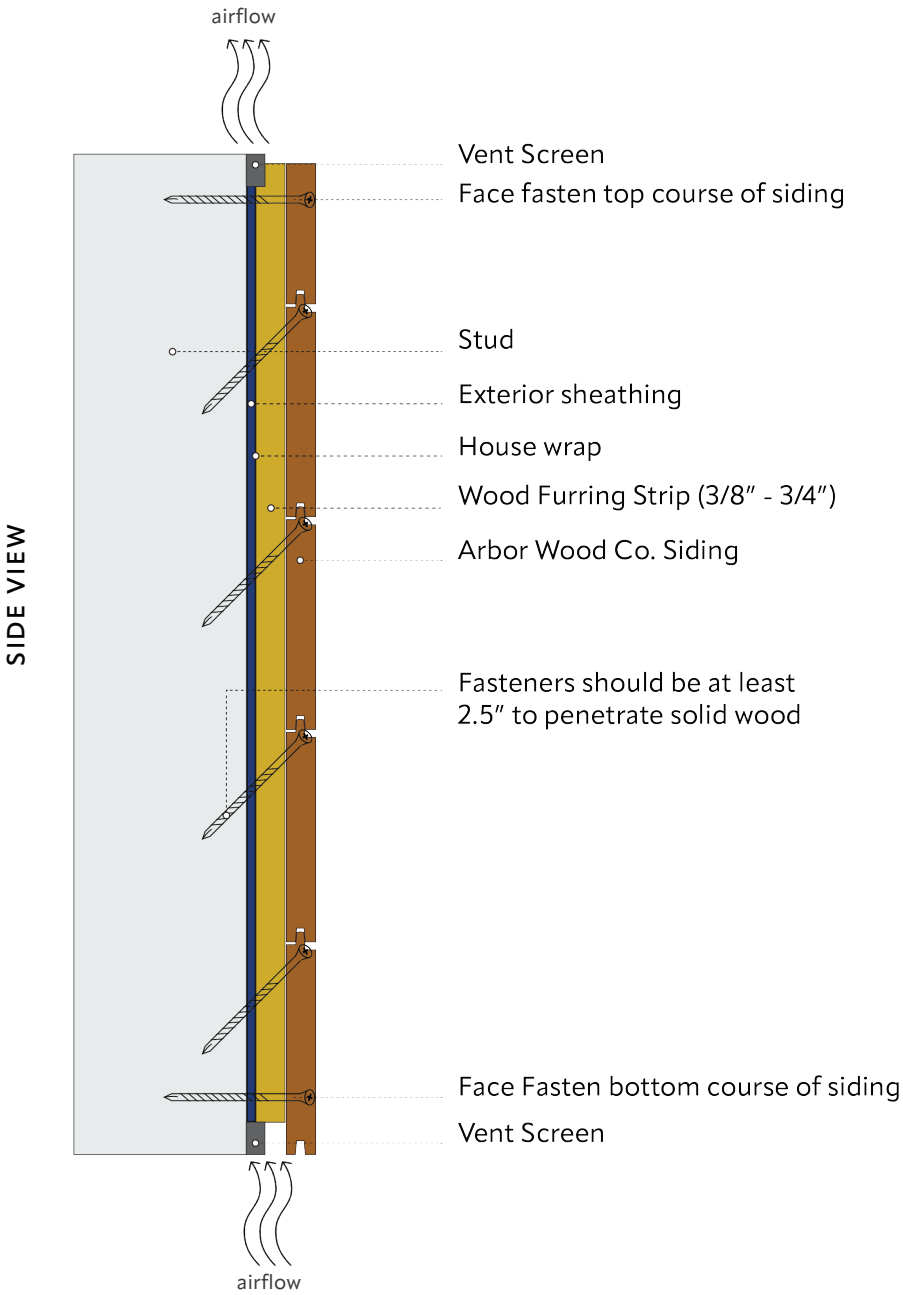

Cladding Spacing

Thermally Modified Cladding will expand slightly in width as it adapts to your specific climate and location. This is a one-time event. Once adapted, the boards will remain stable, but care must be taken during installation to allow for this expansion. A $\frac{3}{16}$ " reveal gap should be provided between each board along with a $\frac{1}{16}$ " gap on the back side to allow for proper expansion and contraction during acclimation.



WARNING

Do not use a mallet or hammer to force boards into place. Failure to install with proper gaps may cause cladding to buckle during expansion.

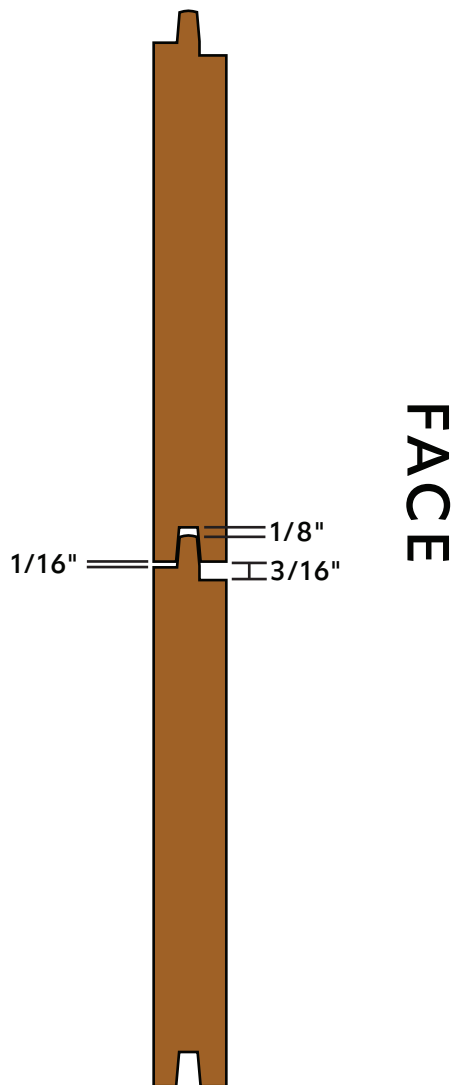

Note: Horizontal installation is required to be installed with the tongue to the top and with the nickel gap exposed to the front. Installing the cladding in any other method is not approved and will void the warranty.



Standard Tongue & Groove Horizontal Installation - Wood Furring, Front View

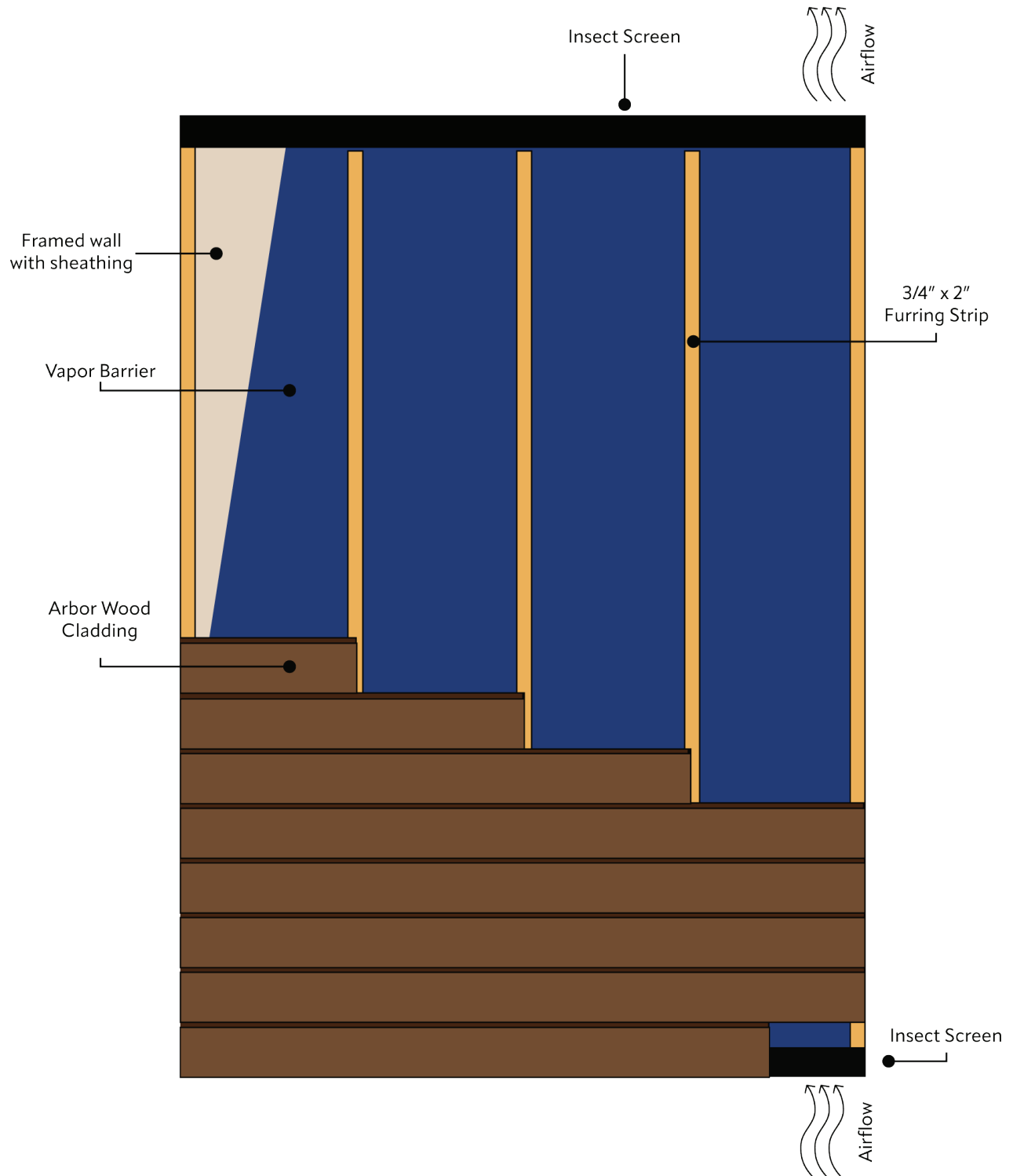

Standard Tongue & Groove Horizontal Installation - Quarrix ProTect, Front View

Please refer to the appendix for manufacturer recommendations

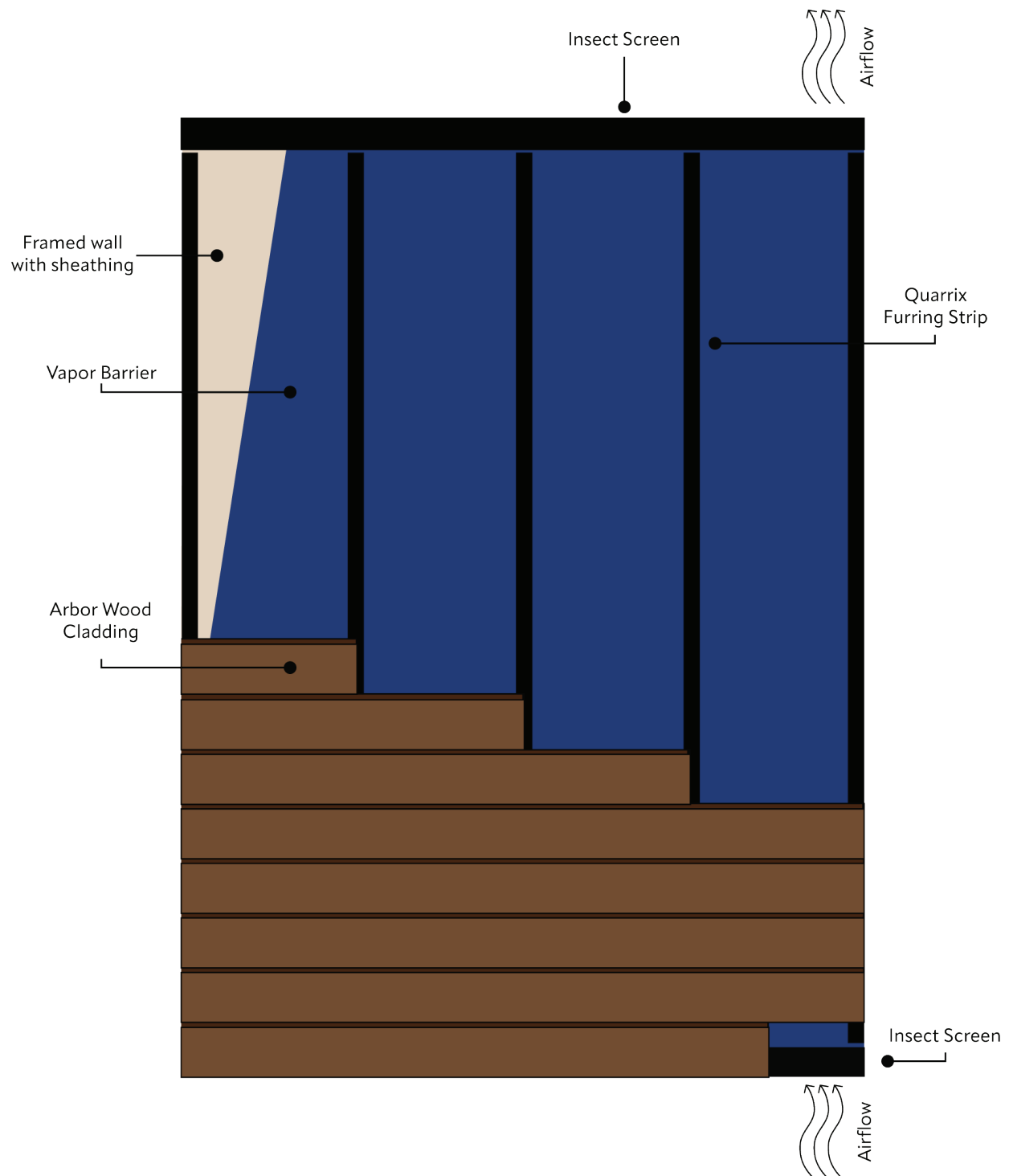

Standard Tongue & Groove Vertical Installation - Quarrix ProTect, Front View

Vertical installation calls for a counter-batten furring method -OR- a breathable furring strip such as Quarrix ProTect Furring Strips. This allows for convection airflow and water drainage to occur behind the cladding.

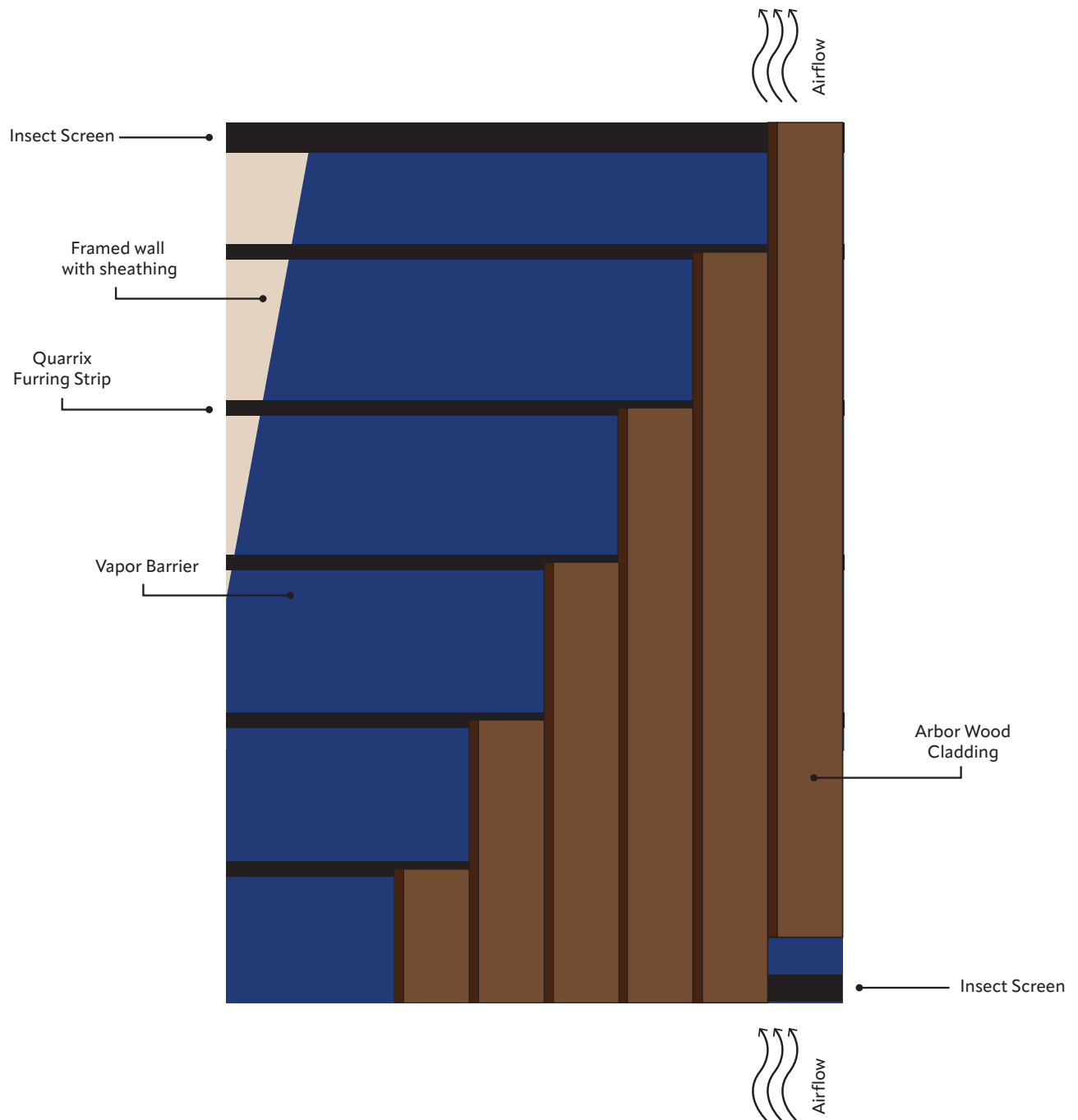

Standard Tongue & Groove Vertical Installation – Counter-Batten Wood Furring, Front View

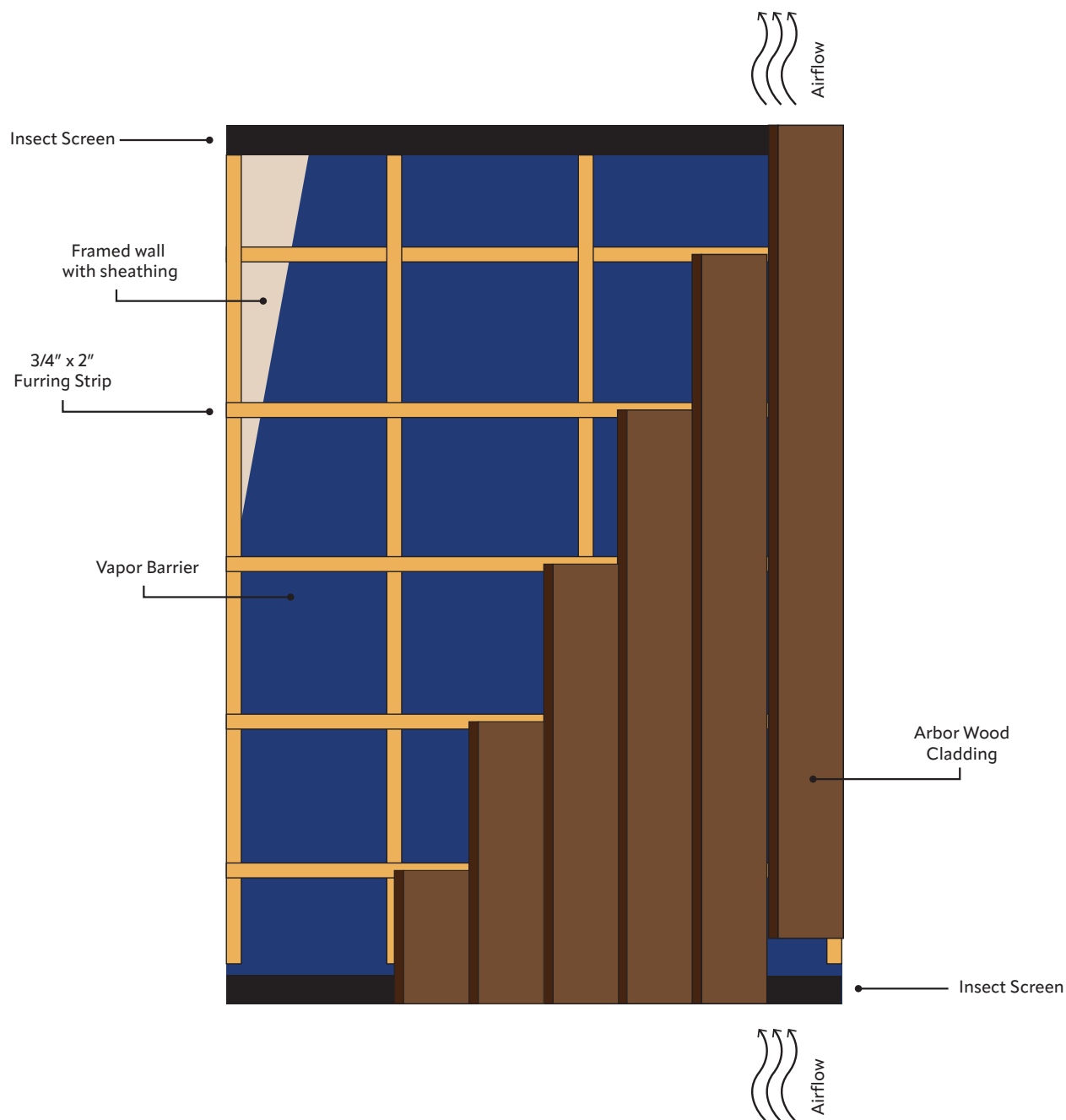

Portal Opening Recommendations

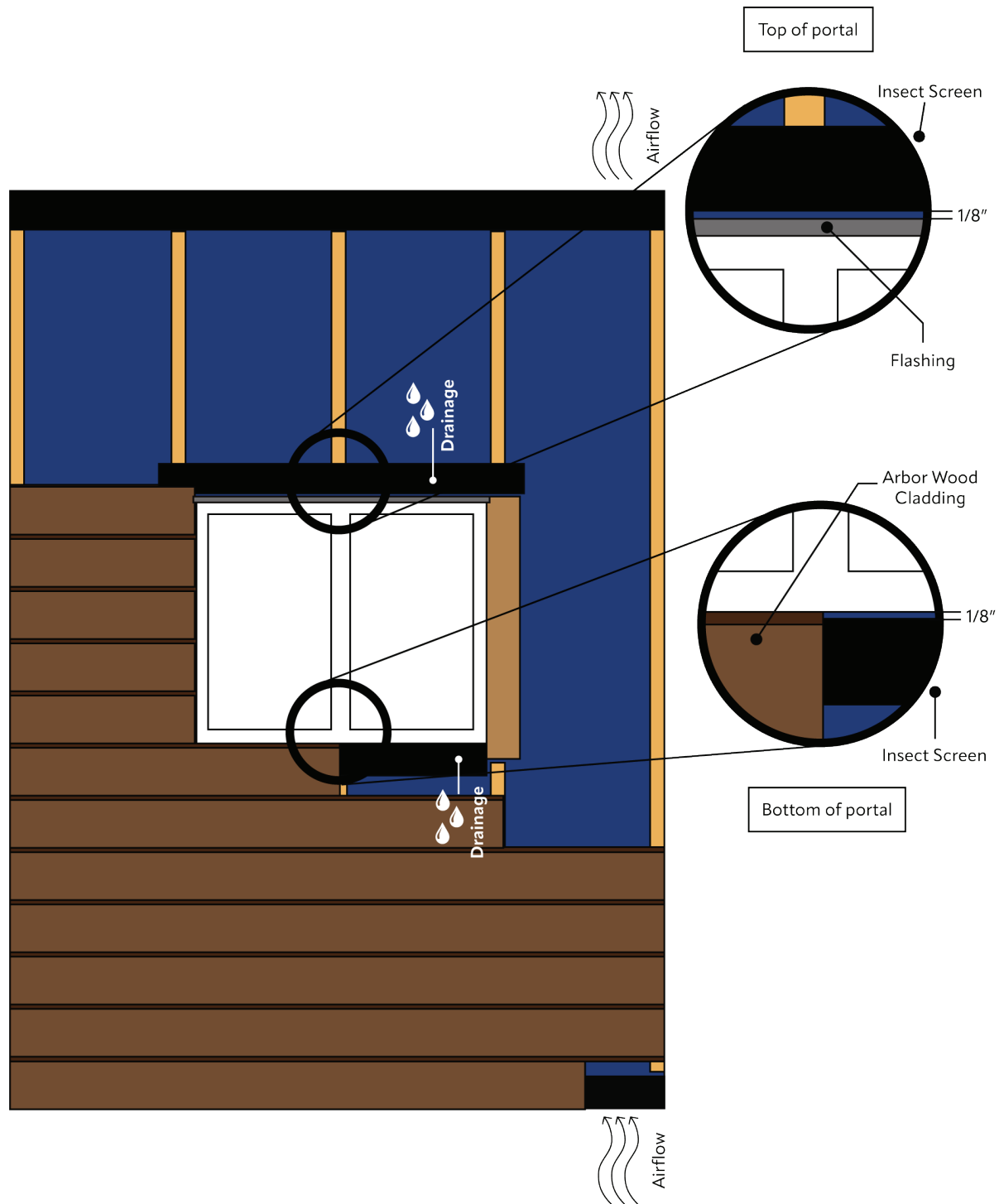

A recommended minimum 1/4" gap from top and bottom of all portal openings to allow for airflow & drainage for best performance.



Corner Detail Installation

Arbor Wood Co. provides a variety of potential options for corner detailing during installation of our cladding products. The following options are not an exhaustive list, rather, a guide to the potential options available for your consideration.

Corner Detail – Butting with 5/4 & 2x Material

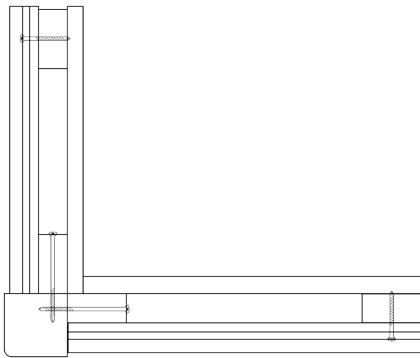

Outside Corner

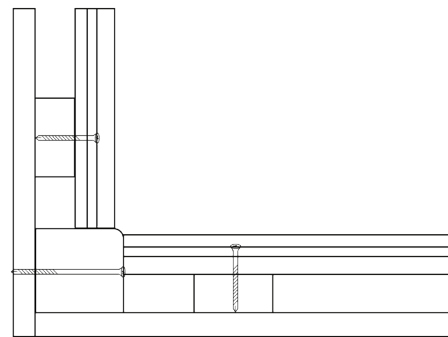

Inside Corner

Corner Detail – Miter Gap

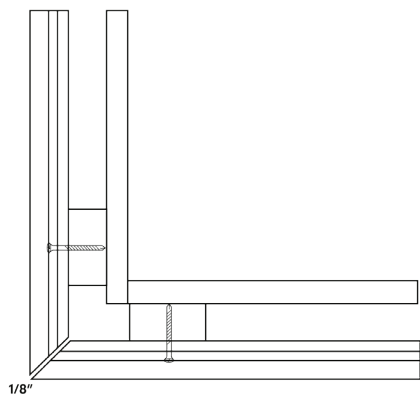

Outside Corner

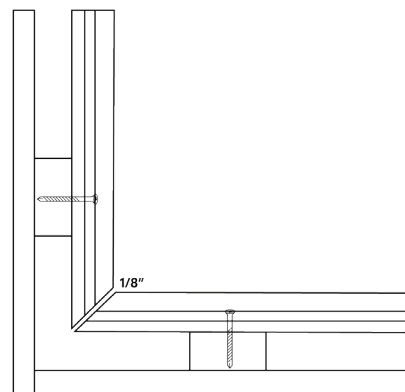

Inside Corner



Soffit Detail

Top & bottom should not be obstructed. Allow for a minimum 1/4" gap from soffit.

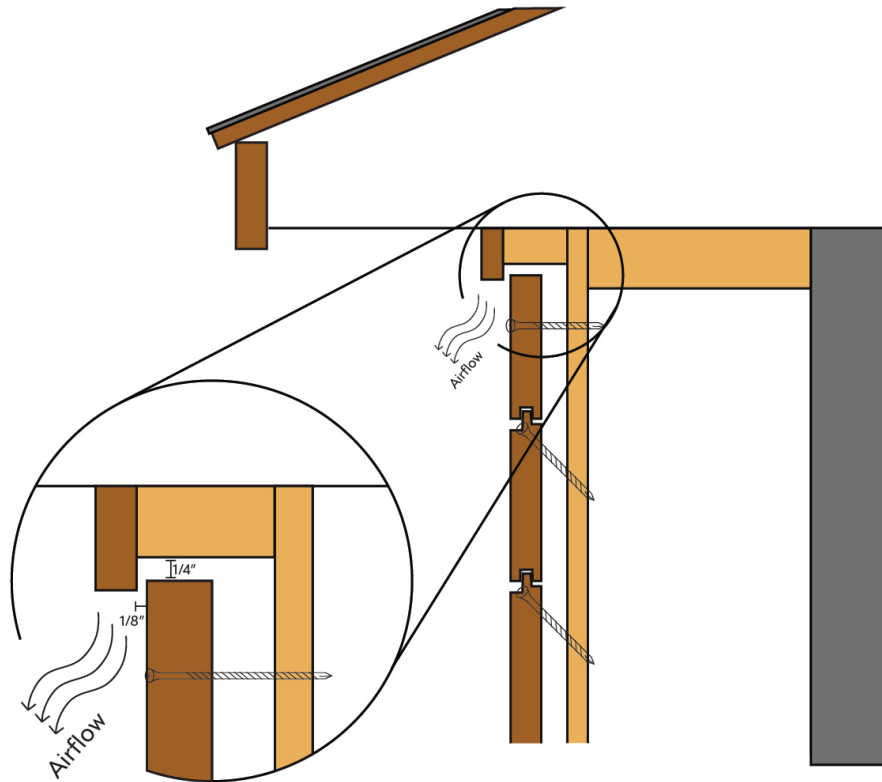



Quarrix®

ProTect

FURRING STRIPS

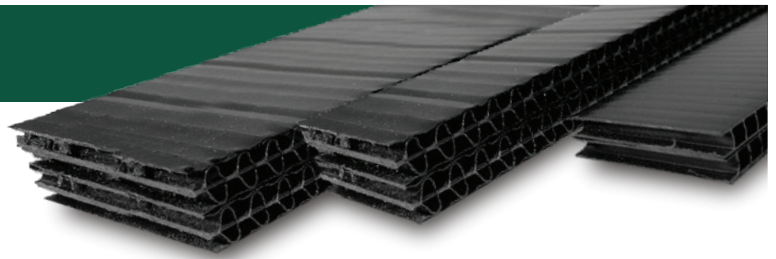

INSTALLATION INSTRUCTIONS

STEP 1

Once house wrap has been installed, install a 3/4" (19mm) Quarrix ProTect Furring Strip horizontally just below the soffit, at the very top of the house wall. Also install a ProTect Furring Strip horizontally at the bottom of the wood on the house wall.

STEP 2

When using a thicker siding, install a second ProTect Furring Strip on top of the horizontal Furring Strips to all the siding to lay flat.

STEP 3

Install ProTect Furring Strips every 16" on center using fasteners that penetrate plywood 1/2".

STEP 4

Quarrix ProTect Furring Strips should be installed approximately 1" from the edge of the wall. Furring Strips should also be used under trim, in corners and around windows. The Furring Strips should be installed to support the width of the trim.

STEP 5

Attach siding according to manufacturers' specifications and building codes using fasteners long enough to sufficiently penetrate into framing.

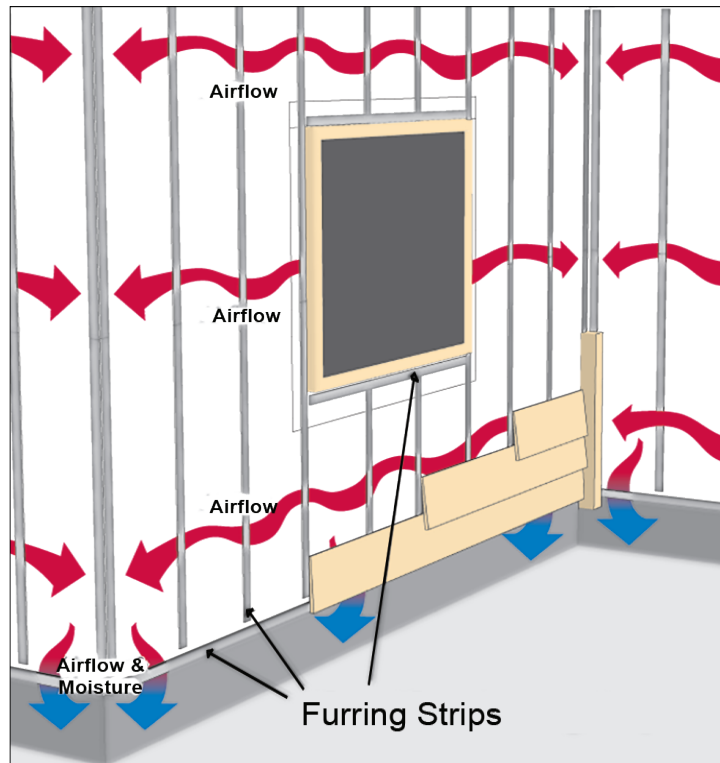

Quarrix.com | 800.438.2920



INST-PTFS09.02.04.21



Arbor Wood. **For Good.**



Arbor Wood Co.
1025 London Road
Duluth, MN 55802
855-414-2727
arborwoodco.com

