

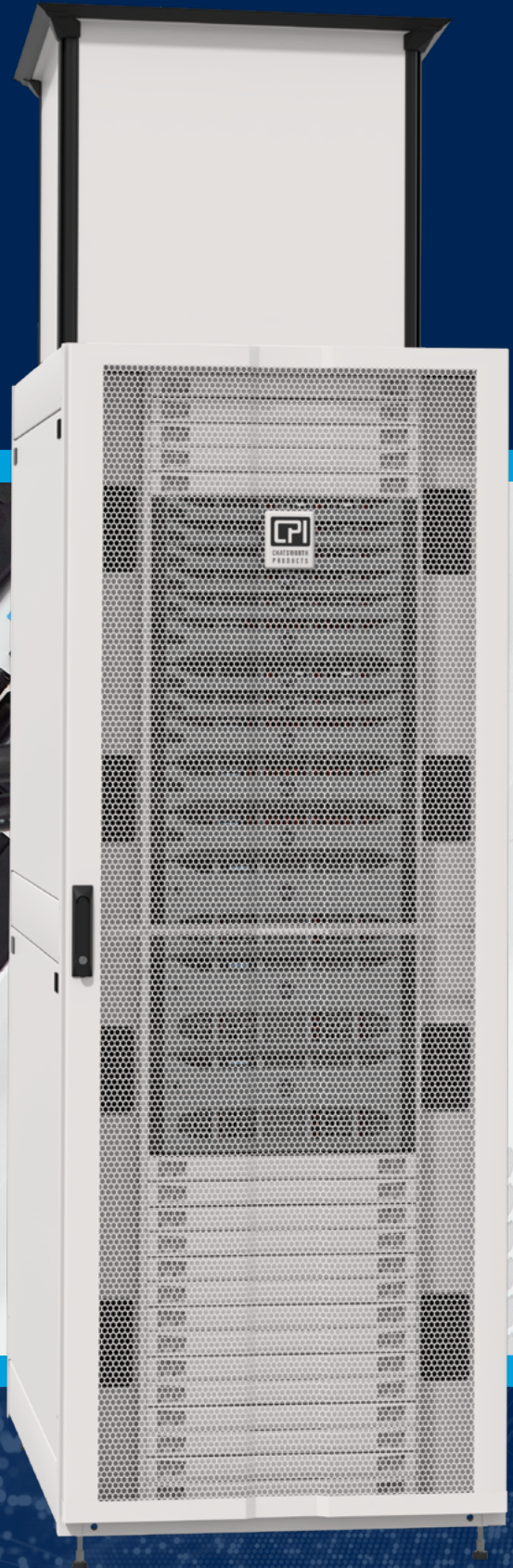

CHATSWORTH
PRODUCTS

Power and Cabinet Ordering Guide



[chatsworth.com](https://www.chatsworth.com)

Steps to Creating Your Own Power and Cabinet Solution

This ordering guide is designed to select all the components you need to create a complete power and cabinet solution. Follow these steps to create and customize your own power and cabinet solution.



Manage power with intelligence.
Select a PDU



Ensure uptime and protect IT assets.
Add rack-mountable UPS



Monitor the environment proactively.
Add environmental monitoring



Protect equipment electronically.
Add electronic locks



Optimize systems remotely.
Add DCIM software



Support equipment with strength.
Select a cabinet



Organize cables with flexibility.
Add cable management



Control airflow effectively.
Add airflow management

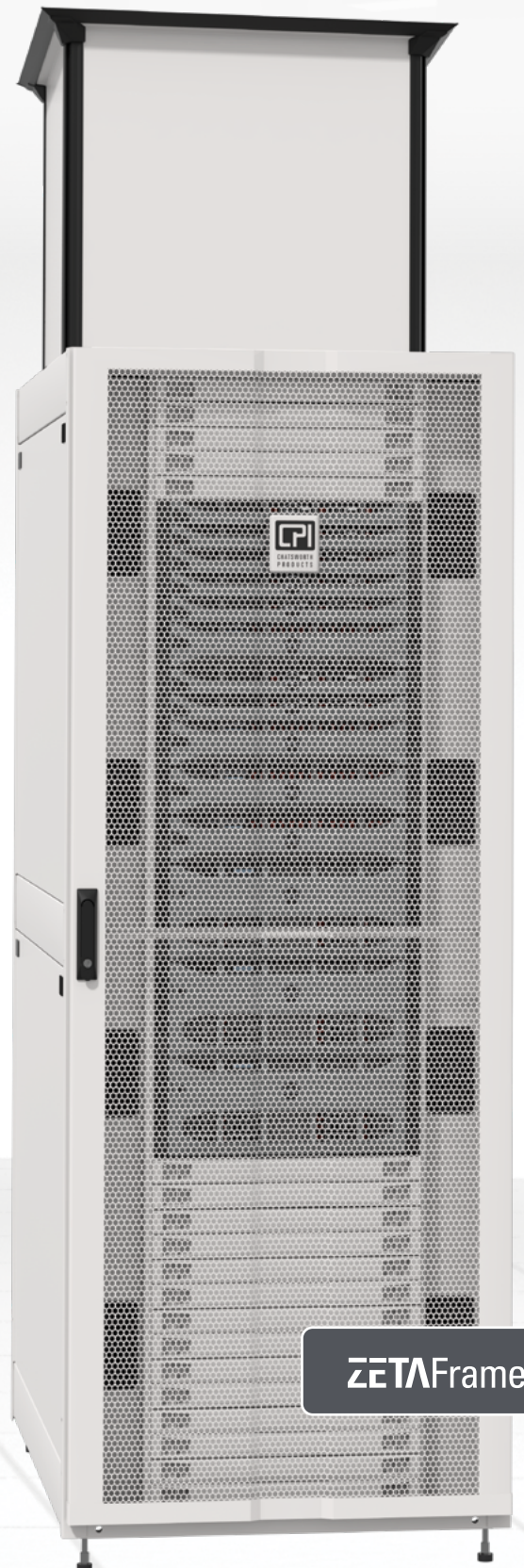

ZETAFrame

Select a Power Distribution Unit

Manage Power with Intelligence

As the last leg of the power chain, power distribution units (PDUs) provide the most granular information needed to understand equipment condition for capacity planning. CPI's eConnect® PDUs help data center managers make informed decisions and have the following features.



Reduced Networking Costs and Complexity



Resistance to High Temperature



Simplified Load Balancing



No Accidental Disconnections



Easy Identification of Failover Unit



Electronic Lock Integration



Gigabit Ethernet



Latest UL Compliance



Cabinet Preinstallation

eConnect

The first step when selecting a rack PDU is to identify the level of functionality. The chart below summarizes the monitoring and control differences.

	Basic	Metered	Monitored	Monitored Pro	Switched	Switched Pro
Basic Power Distribution	✓	✓	✓	✓	✓	✓
Inlet Metering		✓	✓	✓	✓	✓
Branch Circuit Metering			✓	✓	✓	✓
Remote Access			✓	✓	✓	✓
Access Control			✓	✓	✓	✓
Outlet Metering				✓		✓
Switched Outlets					✓	✓

Basic eConnect PDU

Basic Power Distribution

Simple and reliable.

Select Basic eConnect PDUs in low- or high-density applications where no power monitoring is required.

Basic eConnect PDU, Vertical - North America								
Part Number			Input Amperage	Input Plug	Outlets	kW Capacity (UL)	Cabinet Capability	
Black*	Glacier White*	Redundancy Pack**						
120 Volt, Single-Phase Input								
E0-1001-C	E0-1001-E	E0-1001-CE	20A	C20 Inlet to L5-20	(24) 5-20	1.9 kW	42U & higher	
E0-1002-C	E0-1002-E	E0-1002-CE	30A	L5-30	(24) 5-20	2.9 kW	42U & higher	
208 Volt, Single-Phase Input								
E0-1003-C	E0-1003-E	E0-1003-CE	20A	C20 Inlet to L6-20	(24) C13	3.3 kW	42U & higher	
E0-1004-C	E0-1004-E	E0-1004-CE	30A	L6-30	(24) C13	5 kW	42U & higher	
E0-1015-C	E0-1015-E	E0-1015-CE	30A	L6-30	(36) C13 + (6) C19	5 kW	42U & higher	
208 Volt, Three-Phase Input								
E0-1016-C	E0-1016-E	E0-1016-CE	30A	L15-30	(36) C13 + (6) C19	8.6 kW	42U & higher	
E0-1007-C	E0-1007-E	E0-1007-CE	50A	CS8365	(30) C13 + (12) C19	14.4 kW	42U & higher	
E0-1019-C	E0-1019-E	E0-1019-CE	50A	CS8365	(36) C13 + (6) C19	14.4 kW	42U & higher	
E0-1125-C	E0-1125-E	E0-1125-CE	50A	CS8365	(54) C13	14.4 kW	45U & higher	
E0-1008-C	E0-1008-E	E0-1008-CE	60A	IEC 60309 60A 3P+E	(30) C13 + (12) C19	17.2 kW	42U & higher	
E0-1020-C	E0-1020-E	E0-1020-CE	60A	IEC 60309 60A 3P+E	(36) C13 + (6) C19	17.2 kW	42U & higher	
E0-1033-C	E0-1033-E	E0-1033-CE	60A	IEC 60309 60A 3P+E	(12) C13 + (18) C19	17.2 kW	42U & higher	
E0-1126-C	E0-1126-E	E0-1126-CE	60A	IEC 60309 60A 3P+E	(54) C13	17.2 kW	45U & higher	
120/208 Volt, Three-Phase Input								
E0-1013-C	E0-1013-E	E0-1013-CE	20A	L21-20	(30) C13 + (6) C19 + (6) 5-20	5.7 kW	42U & higher	
E0-1017-C	E0-1017-E	E0-1017-CE	20A	L21-20	(36) C13 + (6) C19	5.7 kW	42U & higher	
E0-1014-C	E0-1014-E	E0-1014-CE	30A	L21-30	(30) C13 + (6) C19 + (6) 5-20	8.6 kW	42U & higher	
E0-1018-C	E0-1018-E	E0-1018-CE	30A	L21-30	(36) C13 + (6) C19	8.6 kW	42U & higher	
240/415 Volt, Three-Phase Input								
E0-1021-C	E0-1021-E	E0-1021-CE	30A	L22-30	(36) C13 + (6) C19	17.2 kW	42U & higher	
E0-1127-C	E0-1127-E	E0-1127-CE	30A	L22-30	(54) C13	17.2 kW	45U & higher	
Basic eConnect PDU, Vertical - Worldwide								
Part Number			Input Amperage	Input Plug	Outlets	kW Capacity Worldwide (CE)	kW Capacity North America (UL)	Cabinet Capability
Black*	Glacier White*	Redundancy Pack**						
220 - 240 Volt, Single-Phase Input								
E0-1005-C	E0-1005-E	E0-1005-CE	16A	C20 Inlet to IEC 60309 16A 1P+N+E	(24) C13	3.8 kW	3.8 kW	42U & higher
E0-1006-C	E0-1006-E	E0-1006-CE	32A	IEC 60309 32A 1P+N+E	(24) C13	7.7 kW	6.1 kW	42U & higher
E0-1022-C	E0-1022-E	E0-1022-CE	32A	IEC 60309 32A 1P+N+E	(36) C13 + (6)C19	7.7 kW	6.1 kW	42U & higher
220-240/380-415 Volt, Three-Phase Input								
E0-1023-C	E0-1023-E	E0-1023-CE	16/20A	IEC 60309 16/20A 3P+N+E	(36) C13 + (6) C19	11.5 kW	11.5 kW	42U & higher
E0-1009-C	E0-1009-E	E0-1009-CE	32A	IEC 60309 32A 3P+N+E	(36) C13 + (12) C19	23 kW	18.4 kW	42U & higher
E0-1024-C	E0-1024-E	E0-1024-CE	32A	IEC 60309 32A 3P+N+E	(36) C13 + (6) C19	23 kW	18.4 kW	42U & higher
E0-1128-C	E0-1128-E	E0-1128-CE	32A	IEC 60309 32A 3P+N+E	(54) C13	23 kW	18.4 kW	45U & higher

Notes:

* Shipping weight for each unit is 27 lb (12 kg).

**Redundancy Pack includes 2 PDUs (one in Black, one in Glacier White) for easy identification of the primary and secondary unit; shipping weight is 54 lb (24 kg).

Basic eConnect PDU, Horizontal

Simple and reliable.

Use Horizontal eConnect PDUs in applications that require outlets at the top or bottom of cabinets for quick access, low- to medium-density applications that require fewer connections and in distributed infrastructure for edge applications.



Basic eConnect PDU, Horizontal - North America								
Part Number			Input Amperage	Input Plug	Outlets	kW Capacity (UL)	Form Factor (U) Height	
Black*	Glacier White*	Redundancy Pack**						
120 Volt, Single-Phase Input								
E0-1243-C	E0-1243-E	E0-1243-CE	20A	C20 Inlet to L5-20	(12) 5-20	1.9 kW	1U	
E0-1244-C	E0-1244-E	E0-1244-CE	30A	NEMA L5-30P	(12) 5-20	2.9 kW	1U	
208 Volt, Single-Phase Input								
E0-1245-C	E0-1245-E	E0-1245-CE	20A	C20 Inlet to L6-20	(12) C13	3.3 kW	1U	
E0-1270-C	E0-1270-E	E0-1270-CE	20A	C20 Inlet to L6-20	(8) C13 + (4) C19	3.3 kW	1U	
E0-1246-C	E0-1246-E	E0-1246-CE	30A	NEMA L6-30P	(12) C13	5 kW	1U	
E0-1253-C	E0-1253-E	E0-1253-CE	30A	NEMA L6-30P	(9) C19	5 kW	1U	
E0-1271-C	E0-1271-E	E0-1271-CE	30A	NEMA L6-30P	(8) C13 + (4) C19	5 kW	1U	
120/208 Volt, Three-Phase Input								
E0-1248-C	E0-1248-E	E0-1248-CE	20A	NEMA L21-20P	(12) C13	5.7 kW	1U	
E0-1255-C	E0-1255-E	E0-1255-CE	20A	NEMA L21-20P	(9) C19	5.7 kW	1U	
E0-1273-C	E0-1273-E	E0-1273-CE	20A	NEMA L21-20P	(8) C13 + (4) C19	5.7 kW	1U	
E0-1249-C	E0-1249-E	E0-1249-CE	30A	NEMA L21-30P	(12) C13	8.6 kW	1U	
E0-1256-C	E0-1256-E	E0-1256-CE	30A	NEMA L21-30P	(9) C19	8.6 kW	1U	
E0-1274-C	E0-1274-E	E0-1274-CE	30A	NEMA L21-30P	(8) C13 + (4) C19	8.6 kW	1U	
208 Volt, Three-Phase Input								
E0-1247-C	E0-1247-E	E0-1247-CE	30A	NEMA L15-30P	(12) C13	8.6 kW	1U	
E0-1254-C	E0-1254-E	E0-1254-CE	30A	NEMA L15-30P	(9) C19	8.6 kW	1U	
E0-1272-C	E0-1272-E	E0-1272-CE	30A	NEMA L15-30P	(8) C13 + (4) C19	8.6 kW	1U	
Basic eConnect PDU, Horizontal - Worldwide								
Part Number			Input Amperage	Input Plug	Outlets	kW Capacity (UL)	kW Capacity North America (UL)	Form Factor (U) Height
Black*	Glacier White*	Redundancy Pack**						
220 - 240 Volt, Single-Phase Input								
E0-1250-C	E0-1250-E	E0-1250-CE	16A	C20 Inlet to IEC 60309 16A 1P+N+E	(12) C13	3.8 kW	3.8 kW	1U
E0-1275-C	E0-1275-E	E0-1275-CE	16A	C20 Inlet to IEC 60309 16A 1P+N+E	(8) C13 + (4) C19	3.8 kW	3.8 kW	1U
E0-1252-C	E0-1252-E	E0-1252-CE	32A	IEC 60309 32A 1P+N+E	(12) C13	7.7 kW	6.1 kW	1U
E0-1257-C	E0-1257-E	E0-1257-CE	32A	IEC 60309 32A 1P+N+E	(9) C19	7.7 kW	6.1 kW	1U
E0-1277-C	E0-1277-E	E0-1277-CE	32A	IEC 60309 32A 1P+N+E	(8) C13 + (4) C19	7.7 kW	6.1 kW	1U
220 - 240/380-415 Volt, Three-Phase Input								
E0-1251-C	E0-1251-E	E0-1251-CE	16/20A	IEC 60309 16/20A 3P+N+E	(12) C13	11.5 kW	11.5 kW	1U
E0-1258-C	E0-1258-E	E0-1258-CE	16/20A	IEC 60309 16/20A 3P+N+E	(9) C19	11.5 kW	11.5 kW	1U
E0-1276-C	E0-1276-E	E0-1276-CE	16/20A	IEC 60309 16/20A 3P+N+E	(8) C13 + (4) C19	11.5 kW	11.5 kW	1U

Notes:

*Shipping weight for each unit is 18 lb (8.2 kg).

**Redundancy Pack includes 2 PDUs in Black and Glacier White for easy identification of the primary and secondary unit; shipping weight is 35 lb (15.9 kg)

Basic eConnect PDU, Horizontal

Simple and reliable.

Use Horizontal eConnect PDUs in applications that require outlets at the top or bottom of cabinets for quick access, low- to medium-density applications that require fewer connections and in distributed infrastructure for edge applications.



2U

Basic eConnect PDU, Horizontal - North America								
Part Number			Input Amperage	Input Plug	Outlets	kW Capacity (UL)	Form Factor (U) Height	
Black*	Glacier White*	Redundancy Pack**						
120 Volt, Single-Phase Input								
E0-1401-C	E0-1401-E	E0-1401-CE	20A	C20 Inlet to L5-20	(24) 5-20	1.9 kW	2U	
E0-1402-C	E0-1402-E	E0-1402-CE	30A	NEMA L5-30P	(24) 5-20	2.9 kW	2U	
208 Volt, Single-Phase Input								
E0-1403-C	E0-1403-E	E0-1403-CE	20A	C20 Inlet to L6-20	(24) C13	3.3 kW	2U	
E0-1459-C	E0-1459-E	E0-1459-CE	20A	C20 Inlet to L6-20	(18) C13 + (6) C19	3.3 kW	2U	
E0-1404-C	E0-1404-E	E0-1404-CE	30A	NEMA L6-30P	(24) C13	5 kW	2U	
E0-1461-C	E0-1461-E	E0-1461-CE	30A	NEMA L6-30P	(18) C13 + (6) C19	5 kW	2U	
E0-1478-C	E0-1478-E	E0-1478-CE	30A	NEMA L6-30P	(6) C13 + (12) C19	5 kW	2U	
120/208 Volt, Single-Phase Input								
E0-1469-C	E0-1469-E	E0-1469-CE	30A	NEMA L14-30P	(12) C13 + (6) C19 + (4) 5-20	5 kW	2U	
120/208 Volt, Three-Phase Input								
E0-1439-C	E0-1439-E	E0-1439-CE	20A	NEMA L21-20P	(24) C13	5.7 kW	2U	
E0-1463-C	E0-1463-E	E0-1463-CE	20A	NEMA L21-20P	(18) C13 + (6) C19	5.7 kW	2U	
E0-1480-C	E0-1480-E	E0-1480-CE	20A	NEMA L21-20P	(6) C13 + (12) C19	5.7 kW	2U	
E0-1467-C	E0-1467-E	E0-1467-CE	20A	NEMA L21-20P	(12) C13 + (6) C19 + (4) 5-20	5.7 kW	2U	
E0-1440-C	E0-1440-E	E0-1440-CE	30A	NEMA L21-30P	(24) C13	8.6 kW	2U	
E0-1464-C	E0-1464-E	E0-1464-CE	30A	NEMA L21-30P	(18) C13 + (6) C19	8.6 kW	2U	
E0-1482-C	E0-1482-E	E0-1482-CE	30A	NEMA L21-30P	(6) C13 + (12) C19	8.6 kW	2U	
E0-1468-C	E0-1468-E	E0-1468-CE	30A	NEMA L21-30P	(12) C13 + (6) C19 + (4) 5-20	8.6 kW	2U	
208 Volt, Three-Phase Input								
E0-1441-C	E0-1441-E	E0-1441-CE	30A	NEMA L15-30P	(24) C13	8.6 kW	2U	
E0-1465-C	E0-1465-E	E0-1465-CE	30A	NEMA L15-30P	(18) C13 + (6) C19	8.6 kW	2U	
E0-1483-C	E0-1483-E	E0-1483-CE	30A	NEMA L15-30P	(6) C13 + (12) C19	8.6 kW	2U	
E0-1484-C	E0-1484-E	E0-1484-CE	50A	CS8365	(6) C13 + (12) C19	14.4 kW	2U	
E0-1485-C	E0-1485-E	E0-1485-CE	60A	IEC 60309 60A 3P+E	(6) C13 + (12) C19	17.2 kW	2U	
Basic eConnect PDU, Horizontal - Worldwide								
Part Number			Input Amperage	Input Plug	Outlets	kW Capacity (UL)	kW Capacity North America (UL)	Form Factor (U) Height
Black*	Glacier White*	Redundancy Pack**						
220 - 240 Volt, Single-Phase Input								
E0-1405-C	E0-1405-E	E0-1405-CE	16A	C20 Inlet to IEC 60309 16A 1P+N+E	(24) C13	3.8 kW	3.8 kW	2U
E0-1460-C	E0-1460-E	E0-1460-CE	16A	C20 Inlet to IEC 60309 16A 1P+N+E	(18) C13 + (6) C19	3.8 kW	3.8 kW	2U
E0-1406-C	E0-1406-E	E0-1406-CE	32A	IEC 60309 32A 1P+N+E	(24) C13	7.7 kW	6.1 kW	2U
E0-1462-C	E0-1462-E	E0-1462-CE	32A	IEC 60309 32A 1P+N+E	(18) C13 + (6) C19	7.7 kW	6.1 kW	2U
E0-1479-C	E0-1479-E	E0-1479-CE	32A	IEC 60309 32A 1P+N+E	(6) C13 + (12) C19	7.7 kW	6.1 kW	2U
220 - 240/380-415 Volt, Three-Phase Input								
E0-1442-C	E0-1442-E	E0-1442-CE	16/20A	IEC 60309 16/20A 3P+N+E	(24) C13	11.5 kW	11.5 kW	2U
E0-1466-C	E0-1466-E	E0-1466-CE	16/20A	IEC 60309 16/20A 3P+N+E	(18) C13 + (6) C19	11.5 kW	11.5 kW	2U
E0-1481-C	E0-1481-E	E0-1481-CE	16/20A	IEC 60309 16/20A 3P+N+E	(6) C13 + (12) C19	11.5 kW	11.5 kW	2U
E0-1486-C	E0-1486-E	E0-1486-CE	32A	IEC 60309 32A 3P+N+E	(6) C13 + (12) C19	23 kW	18.4 kW	2U

Notes:

*Shipping weight for each unit is 18 lb (8.2 kg).

**Redundancy Pack includes 2 PDUs in Black and Glacier White for easy identification of the primary and secondary unit; shipping weight is 35 lb (15.9 kg)

Metered eConnect PDU

Safe equipment installation with real-time metering.

Select Metered eConnect PDUs for metering capabilities in non-networked applications.

- Basic Power Distribution
- Inlet Metering

Metered eConnect PDU, Vertical - North America								
Part Number			Input Amperage	Input Plug	Outlets	kW Capacity (UL)	Cabinet Capability	
Black*	Glacier White*	Redundancy Pack**						
120 Volt, Single-Phase Input								
E1-2003-C	E1-2003-E	E1-2003-CE	20A	C20 Inlet to L6-20	(24) C13	3.3 kW	42U & higher	
E1-2004-C	E1-2004-E	E1-2004-CE	30A	L6-30	(24) C13	5 kW	42U & higher	
E1-2015-C	E1-2015-E	E1-2015-CE	30A	L6-30	(36) C13 + (6) C19	5 kW	42U & higher	
208 Volt, Single-Phase Input								
E1-2003-C	E1-2003-E	E1-2003-CE	20A	C20 Inlet to L6-20	(24) C13	3.3 kW	42U & higher	
E1-2004-C	E1-2004-E	E1-2004-CE	30A	L6-30	(24) C13	5 kW	42U & higher	
E1-2015-C	E1-2015-E	E1-2015-CE	30A	L6-30	(36) C13 + (6) C19	5 kW	42U & higher	
208 Volt, Three-Phase Input								
E1-2016-C	E1-2016-E	E1-2016-CE	30A	L15-30	(36) C13 + (6) C19	8.6 kW	42U & higher	
E1-2007-C	E1-2007-E	E1-2007-CE	50A	CS8365	(30) C13 + (12) C19	14.4 kW	42U & higher	
E1-2019-C	E1-2019-E	E1-2019-CE	50A	CS8365	(36) C13 + (6) C19	14.4 kW	42U & higher	
E1-2125-C	E1-2125-E	E1-2125-CE	50A	CS8365	(54) C13	14.4 kW	45U & higher	
E1-2008-C	E1-2008-E	E1-2008-CE	60A	IEC 60309 60A 3P+E	(30) C13 + (12) C19	17.2 kW	42U & higher	
E1-2020-C	E1-2020-E	E1-2020-CE	60A	IEC 60309 60A 3P+E	(36) C13 + (6) C19	17.2 kW	42U & higher	
E1-2126-C	E1-2126-E	E1-2026-CE	60A	IEC 60309 60A 3P+E	(54) C13	17.2 kW	45U & higher	
E1-2033-C	E1-2033-E	E1-2033-CE	60A	IEC 60309 60A 3P+E	(12) C13 + (18) C19	17.2 kW	42U & higher	
120/208 Volt, Three-Phase Input								
E1-2013-C	E1-2013-E	E1-2013-CE	20A	L21-20	(30) C13 + (6) C19 + (6) 5-20	5.7 kW	42U & higher	
E1-2017-C	E1-2017-E	E1-2017-CE	20A	L21-20	(36) C13 + (6) C19	5.7 kW	42U & higher	
E1-2014-C	E1-2014-E	E1-2014-CE	30A	L21-30	(30) C13 + (6) C19 + (6) 5-20	8.6 kW	42U & higher	
E1-2018-C	E1-2018-E	E1-2018-CE	30A	L21-30	(36) C13 + (6) C19	8.6 kW	42U & higher	
240/415 Volt, Three-Phase Input								
E1-2021-C	E1-2021-E	E1-2021-CE	30A	L22-30	(36) C13 + (6) C19	17.2 kW	42U & higher	
E1-2127-C	E1-2127-E	E1-2127-CE	30A	L22-30	(54) C13	17.2 kW	45U & higher	
Metered eConnect PDU, Vertical - Worldwide								
Part Number			Input Amperage	Input Plug	Outlets	kW Capacity Worldwide (CE)	kW Capacity North America (UL)	Cabinet Capability
Black*	Glacier White*	Redundancy Pack**						
220 - 240 Volt, Single-Phase Input								
E1-2005-C	E1-2005-E	E1-2005-CE	16A	C20 Inlet to IEC 60309 16A 1P+N+E	(24) C13	3.8 kW	3.8 kW	42U & higher
E1-2006-C	E1-2006-E	E1-2006-CE	32A	IEC 60309 32A 1P+N+E	(24) C13	7.7 kW	6.1 kW	42U & higher
E1-2022-C	E1-2022-E	E1-2022-CE	32A	IEC 60309 32A 1P+N+E	(36) C13 + (6) C19	7.7 kW	6.1 kW	42U & higher
220-240/380-415 Volt, Three-Phase Input								
E1-2023-C	E1-2023-E	E1-2023-CE	16/20A	IEC 60309 16/20A 3P+N+E	(36) C13 + (6) C19	11.5 kW	11.5 kW	42U & higher
E1-2009-C	E1-2009-E	E1-2009-CE	32A	IEC 60309 32A 3P+N+E	(36) C13 + (12) C19	23 kW	18.4 kW	42U & higher
E1-2024-C	E1-2024-E	E1-2024-CE	32A	IEC 60309 32A 3P+N+E	(36) C13 + (6) C19	23 kW	18.4 kW	42U & higher
E1-2128-C	E1-2128-E	E1-2128-CE	32A	IEC 60309 32A 3P+N+E	(54) C13	23 kW	18.4 kW	45U & higher

Notes:

* Shipping weight for each unit is 27 lb (12 kg).

**Redundancy Pack includes 2 PDUs (one in Black, one in Glacier White) for easy identification of the primary and secondary unit; shipping weight is 54 lb (24 kg).

Monitored eConnect PDU

Robust cabinet-level power management.

Select Monitored eConnect PDUs for remote power monitoring and management to the input and branch circuit level.

- ✓ Basic Power Distribution
- ✓ Inlet Metering
- ✓ Branch Circuit Metering
- ✓ Remote Access
- ✓ Access Control

Monitored eConnect PDU, Vertical - North America								
Part Number			Input Amperage	Input Plug	Outlets	kW Capacity (UL)	Cabinet Capability	
Black*	Glacier White*	Redundancy Pack**						
120 Volt, Single-Phase Input								
EA-3001-C	EA-3001-E	EA-3001-CE	20A	C20 Inlet to L5-20	(24) 5-20	1.9 kW	42U & higher	
EA-3002-C	EA-3002-E	EA-3002-CE	30A	L5-30	(24) 5-20	2.9 kW	42U & higher	
208 Volt, Single-Phase Input								
EA-3003-C	EA-3003-E	EA-3003-CE	20A	C20 Inlet to L6-20	(24) C13	3.3 kW	42U & higher	
EA-3004-C	EA-3004-E	EA-3004-CE	30A	L6-30	(24) C13	5 kW	42U & higher	
EA-3015-C	EA-3015-E	EA-3015-CE	30A	L6-30	(36) C13 + (6) C19	5 kW	42U & higher	
208 Volt, Three-Phase Input								
EA-3016-C	EA-3016-E	EA-3016-CE	30A	L15-30	(36) C13 + (6) C19	8.6 kW	42U & higher	
EA-3007-C	EA-3007-E	EA-3007-CE	50A	CS8365	(30) C13 + (12) C19	14.4 kW	42U & higher	
EA-3019-C	EA-3019-E	EA-3019-CE	50A	CS8365	(36) C13 + (6) C19	14.4 kW	42U & higher	
EA-3125-C	EA-3125-E	EA-3125-CE	50A	CS8365	(54) C13	14.4 kW	45U & higher	
EA-3126-C	EA-3126-E	EA-3126-CE	50A	CS8365	(54) C13	17.2 kW	45U & higher	
EA-3008-C	EA-3008-E	EA-3008-CE	60A	IEC 60309 60A 3P+E	(30) C13 + (12) C19	17.2 kW	42U & higher	
EA-3020-C	EA-3020-E	EA-3020-CE	60A	IEC 60309 60A 3P+E	(36) C13 + (6) C19	17.2 kW	42U & higher	
EA-3033-C	EA-3033-E	EA-3033-CE	60A	IEC 60309 60A 3P+E	(12) C13 + (18) C19	17.2 kW	42U & higher	
120/208 Volt, Three-Phase Input								
EA-3013-C	EA-3013-E	EA-3013-CE	20A	L21-20	(30) C13 + (6) C19 + (6) 5-20	5.7 kW	42U & higher	
EA-3017-C	EA-3017-E	EA-3017-CE	20A	L21-20	(36) C13 + (6) C19	5.7 kW	42U & higher	
EA-3014-C	EA-3014-E	EA-3014-CE	30A	L21-30	(30) C13 + (6) C19 + (6) 5-20	8.6 kW	42U & higher	
EA-3018-C	EA-3018-E	EA-3018-CE	30A	L21-30	(36) C13 + (6) C19	8.6 kW	42U & higher	
240/415 Volt, Three-Phase Input								
EA-3021-C	EA-3021-E	EA-3021-CE	30A	L22-30	(36) C13 + (6) C19	17.2 kW	42U & higher	
EA-3127-C	EA-3127-E	EA-3127-CE	30A	L22-30	(54) C13	17.2 kW	45U & higher	
Monitored eConnect PDU, Vertical - Worldwide								
Part Number			Input Amperage	Input Plug	Outlets	kW Capacity Worldwide (CE)	kW Capacity North America (UL)	Cabinet Capability
Black*	Glacier White*	Redundancy Pack**						
220 - 240 Volt, Single-Phase Input								
EA-3005-C	EA-3005-E	EA-3005-CE	16A	C20 Inlet to IEC 60309 16A 1P+N+E	(24) C13	3.8kW	3.8kW	42U & higher
EA-3006-C	EA-3006-E	EA-3006-CE	32A	C20 Inlet to IEC 60309 32A 1P+N+E	(24) C13	7.7 kW	6.1 kW	42U & higher
EA-3022-C	EA-3022-E	EA-3022-CE	32A	C20 Inlet to IEC 60309 32A 1P+N+E	(36) C13 + (6) C19	7.7 kW	6.1 kW	42U & higher
220-240/380-415 Volt, Three-Phase Input								
EA-3023-C	EA-3023-E	EA-3023-CE	16/20A	IEC 60309 16/20A 3P+N+E	(36) C13 + (6) C19	11.5 kW	11.5 kW	42U & higher
EA-3009-C	EA-3009-E	EA-3009-CE	32A	IEC 60309 32A 3P+N+E	(30) C13 + (12) C19	23 kW	18.4 kW	42U & higher
EA-3024-C	EA-3024-E	EA-3024-CE	32A	IEC 60309 32A 3P+N+E	(36) C13 + (6) C19	23 kW	18.4 kW	42U & higher
EA-3128-C	EA-3128-E	EA-3128-CE	32A	IEC 60309 20A 3P+N+E	(54) C13	23 kW	18.4 kW	45U & higher

Notes:
 * Shipping weight for each unit is 27 lb (12 kg).
 **Redundancy Pack includes 2 PDUs (one in Black, one in Glacier White) for easy identification of the primary and secondary unit; shipping weight is 54 lb (24 kg).

Monitored eConnect PDU, Horizontal

Robust cabinet-level power management.

Use Horizontal eConnect PDUs in applications that require outlets at the top or bottom of cabinets for quick access, low- to medium-density applications that require fewer connections and in distributed infrastructure for edge applications.



Monitored eConnect PDU, Horizontal - North America								
Part Number			Input Amperage	Input Plug	Outlets	kW Capacity (UL)	Form Factor (U) Height	
Black*	Glacier White*	Redundancy Pack**						
120 Volt, Single-Phase Input								
EA-3243-C	EA-3243-E	EA-3243-CE	20A	C20 Inlet to L5-20	(12) 5-20	1.9 kW	1U	
EA-3244-C	EA-3244-E	EA-3244-CE	30A	NEMA L5-30P	(12) 5-20	2.9 kW	1U	
208 Volt, Single-Phase Input								
EA-3245-C	EA-3245-E	EA-3245-CE	20A	C20 Inlet to L6-20	(12) C13	3.3 kW	1U	
EA-3270-C	EA-3270-E	EA-3270-CE	20A	C20 Inlet to L6-20	(8) C13 + (4) C19	3.3 kW	1U	
EA-3246-C	EA-3246-E	EA-3246-CE	30A	NEMA L6-30P	(12) C13	5 kW	1U	
EA-3253-C	EA-3253-E	EA-3253-CE	30A	NEMA L6-30P	(9) C19	5 kW	1U	
EA-3271-C	EA-3271-E	EA-3271-CE	30A	NEMA L6-30P	(8) C13 + (4) C19	5 kW	1U	
120/208 Volt, Three-Phase Input								
EA-3248-C	EA-3248-E	EA-3248-CE	20A	NEMA L21-20P	(12) C13	5.7 kW	1U	
EA-3255-C	EA-3255-E	EA-3255-CE	20A	NEMA L21-20P	(9) C19	5.7 kW	1U	
EA-3273-C	EA-3273-E	EA-3273-CE	20A	NEMA L21-20P	(8) C13 + (4) C19	5.7 kW	1U	
EA-3249-C	EA-3249-E	EA-3249-CE	30A	NEMA L21-30P	(12) C13	8.6 kW	1U	
EA-3256-C	EA-3256-E	EA-3256-CE	30A	NEMA L21-30P	(9) C19	8.6 kW	1U	
EA-3274-C	EA-3274-E	EA-3274-CE	30A	NEMA L21-30P	(8) C13 + (4) C19	8.6 kW	1U	
208 Volt, Three-Phase Input								
EA-3247-C	EA-3247-E	EA-3247-CE	30A	NEMA L15-30P	(12) C13	8.6 kW	1U	
EA-3254-C	EA-3254-E	EA-3254-CE	30A	NEMA L15-30P	(9) C19	8.6 kW	1U	
EA-3272-C	EA-3272-E	EA-3272-CE	30A	NEMA L15-30P	(8) C13 + (4) C19	8.6 kW	1U	
Monitored eConnect PDU, Horizontal - Worldwide								
Part Number			Input Amperage	Input Plug	Outlets	kW Capacity (UL)	kW Capacity North America (UL)	Form Factor (U) Height
Black*	Glacier White*	Redundancy Pack**						
220 - 240 Volt, Single-Phase Input								
EA-3250-C	EA-3250-E	EA-3250-CE	16A	C20 Inlet to IEC 60309 16A 1P+N+E	(12) C13	3.8 kW	3.8 kW	1U
EA-3275-C	EA-3275-E	EA-3275-CE	16A	C20 Inlet to IEC 60309 16A 1P+N+E	(8) C13 + (4) C19	3.8 kW	3.8 kW	1U
EA-3252-C	EA-3252-E	EA-3252-CE	32A	IEC 60309 32A 1P+N+E	(12) C13	7.7 kW	6.1 kW	1U
EA-3257-C	EA-3257-E	EA-3257-CE	32A	IEC 60309 32A 1P+N+E	(9) C19	7.7 kW	6.1 kW	1U
EA-3277-C	EA-3277-E	EA-3277-CE	32A	IEC 60309 32A 1P+N+E	(8) C13 + (4) C19	7.7 kW	6.1 kW	1U
220 - 240/380-415 Volt, Three-Phase Input								
EA-3251-C	EA-3251-E	EA-3251-CE	16/20A	IEC 60309 16/20A 3P+N+E	(12) C13	11.5 kW	11.5 kW	1U
EA-3258-C	EA-3258-E	EA-3258-CE	16/20A	IEC 60309 16/20A 3P+N+E	(9) C19	11.5 kW	11.5 kW	1U
EA-3276-C	EA-3276-E	EA-3276-CE	16/20A	IEC 60309 16/20A 3P+N+E	(8) C13 + (4) C19	11.5 kW	11.5 kW	1U

Notes:

*Shipping weight for each unit is 18 lb (8.2 kg).

**Redundancy Pack includes 2 PDUs in Black and Glacier White for easy identification of the primary and secondary unit; shipping weight is 35 lb (15.9 kg)

Monitored eConnect PDU, Horizontal

Robust cabinet-level power management.

Use Horizontal eConnect PDUs in applications that require outlets at the top or bottom of cabinets for quick access, low- to medium-density applications that require fewer connections and in distributed infrastructure for edge applications.



2U

Monitored eConnect PDU, Horizontal - North America									
Part Number			Input Amperage	Input Plug	Outlets	kW Capacity (UL)	Form Factor (U) Height		
Black*	Glacier White*	Redundancy Pack**							
120 Volt, Single-Phase Input									
EA-3401-C	EA-3401-E	EA-3401-CE	20A	C20 Inlet to L5-20	(24) 5-20	1.9 kW	2U		
EA-3402-C	EA-3402-E	EA-3402-CE	30A	NEMA L5-30P	(24) 5-20	2.9 kW	2U		
208 Volt, Single-Phase Input									
EA-3403-C	EA-3403-E	EA-3403-CE	20A	C20 Inlet to L6-20	(24) C13	3.3 kW	2U		
EA-3459-C	EA-3459-E	EA-3459-CE	20A	C20 Inlet to L6-20	(18) C13 + (6) C19	3.3 kW	2U		
EA-3404-C	EA-3404-E	EA-3404-CE	30A	NEMA L6-30P	(24) C13	5 kW	2U		
EA-3461-C	EA-3461-E	EA-3461-CE	30A	NEMA L6-30P	(18) C13 + (6) C19	5 kW	2U		
EA-3478-C	EA-3478-E	EA-3478-CE	30A	NEMA L6-30P	(6) C13 + (12) C19	5 kW	2U		
120/208 Volt, Single-Phase Input									
EA-3469-C	EA-3469-E	EA-3469-CE	30A	NEMA L14-30P	(12) C13 + (6) C19 + (4) 5-20	5 kW	2U		
120/208 Volt, Three-Phase Input									
EA-3439-C	EA-3439-E	EA-3439-CE	20A	NEMA L21-20P	(24) C13	5.7 kW	2U		
EA-3463-C	EA-3463-E	EA-3463-CE	20A	NEMA L21-20P	(18) C13 + (6) C19	5.7 kW	2U		
EA-3480-C	EA-3480-E	EA-3480-CE	20A	NEMA L21-20P	(6) C13 + (12) C19	5.7 kW	2U		
EA-3467-C	EA-3467-E	EA-3467-CE	20A	NEMA L21-20P	(12) C13 + (6) C19 + (4) 5-20	5.7 kW	2U		
EA-3440-C	EA-3440-E	EA-3440-CE	30A	NEMA L21-30P	(24) C13	8.6 kW	2U		
EA-3464-C	EA-3464-E	EA-3464-CE	30A	NEMA L21-30P	(18) C13 + (6) C19	8.6 kW	2U		
EA-3482-C	EA-3482-E	EA-3482-CE	30A	NEMA L21-30P	(6) C13 + (12) C19	8.6 kW	2U		
EA-3468-C	EA-3468-E	EA-3468-CE	30A	NEMA L21-30P	(12) C13 + (6) C19 + (4) 5-20	8.6 kW	2U		
208 Volt, Three-Phase Input									
EA-3441-C	EA-3441-E	EA-3441-CE	30A	NEMA L15-30P	(24) C13	8.6 kW	2U		
EA-3465-C	EA-3465-E	EA-3465-CE	30A	NEMA L15-30P	(18) C13 + (6) C19	8.6 kW	2U		
EA-3483-C	EA-3483-E	EA-3483-CE	30A	NEMA L15-30P	(6) C13 + (12) C19	8.6 kW	2U		
EA-3484-C	EA-3484-E	EA-3484-CE	50A	CS8365	(6) C13 + (12) C19	14.4 kW	2U		
EA-3485-C	EA-3485-E	EA-3485-CE	60A	IEC 60309 60A 3P+E	(6) C13 + (12) C19	17.2 kW	2U		
Monitored eConnect PDU, Horizontal - Worldwide									
Part Number			Input Amperage	Input Plug	Outlets	kW Capacity (UL)	kW Capacity North America (UL)	Form Factor (U) Height	
Black*	Glacier White*	Redundancy Pack**							
220 - 240 Volt, Single-Phase Input									
EA-3405-C	EA-3405-E	EA-3405-CE	16A	C20 Inlet to IEC 60309 16A 1P+N+E	(24) C13	3.8 kW	3.8 kW	2U	
EA-3460-C	EA-3460-E	EA-3460-CE	16A	C20 Inlet to IEC 60309 16A 1P+N+E	(18) C13 + (6) C19	3.8 kW	3.8 kW	2U	
EA-3406-C	EA-3406-E	EA-3406-CE	32A	IEC 60309 32A 1P+N+E	(24) C13	7.7 kW	6.1 kW	2U	
EA-3462-C	EA-3462-E	EA-3462-CE	32A	IEC 60309 32A 1P+N+E	(18) C13 + (6) C19	7.7 kW	6.1 kW	2U	
EA-3479-C	EA-3479-E	EA-3479-CE	32A	IEC 60309 32A 1P+N+E	(6) C13 + (12) C19	7.7 kW	6.1 kW	2U	
220 - 240/380-415 Volt, Three-Phase Input									
EA-3442-C	EA-3442-E	EA-3442-CE	16/20A	IEC 60309 16/20A 3P+N+E	(24) C13	11.5 kW	11.5 kW	2U	
EA-3466-C	EA-3466-E	EA-3466-CE	16/20A	IEC 60309 16/20A 3P+N+E	(18) C13 + (6) C19	11.5 kW	11.5 kW	2U	
EA-3481-C	EA-3481-E	EA-3481-CE	16/20A	IEC 60309 16/20A 3P+N+E	(6) C13 + (12) C19	11.5 kW	11.5 kW	2U	
EA-3486-C	EA-3486-E	EA-3486-CE	32A	IEC 60309 32A 3P+N+E	(6) C13 + (12) C19	23 kW	18.4 kW	2U	

Notes:

*Shipping weight for each unit is 23 lb (10.4 kg)

**Redundancy Pack includes 2 PDUs in Black and Glacier White for easy identification of the primary and secondary unit; shipping weight is 45 lb (20.4 kg)

Monitored Pro eConnect PDU

Robust and reliable device-level power monitoring.

Select Monitored Pro eConnect PDUs for remote outlet-level power monitoring.

- ✓ Basic Power Distribution
- ✓ Inlet Metering
- ✓ Branch Circuit Metering
- ✓ Remote Access
- ✓ Access Control
- ✓ Outlet Metering

Monitored Pro eConnect PDU, Vertical - North America								
Part Number			Input Amperage	Input Plug	Outlets	kW Capacity (UL)	Cabinet Capability	
Black*	Glacier White*	Redundancy Pack**						
120 Volt, Single-Phase Input								
EA-4001-C	EA-4001-E	EA-4001-CE	20A	C20 Inlet to L5-20	(24) 5-20	1.9 kW	42U & higher	
EA-4002-C	EA-4002-E	EA-4002-CE	30A	L5-30	(24) 5-20	2.9 kW	42U & higher	
208 Volt, Single-Phase Input								
EA-4069-C	EA-4069-E	EA-4069-CE	20A	C20 Inlet to L6-20	(18) C13 + (6) C19	3.3 kW	42U & higher	
EA-4070-C	EA-4070-E	EA-4070-CE	20A	C20 Inlet to L6-20	(24) C13	3.3 kW	42U & higher	
EA-4004-C	EA-4004-E	EA-4004-CE	30A	L6-30	(24) C13	5 kW	42U & higher	
EA-4012-C	EA-4012-E	EA-4012-CE	30A	L6-30	(18) C13 + (6) C19	5 kW	42U & higher	
120 - 208 Volt, Three-Phase Input								
EA-4006-C	EA-4006-E	EA-4006-CE	20A	L21-20	(24) C13	5.7 kW	42U & higher	
EA-4014-C	EA-4014-E	EA-4014-CE	20A	L21-20	(18) C13 + (6) C19	5.7 kW	42U & higher	
EA-4025-C	EA-4025-E	EA-4025-CE	20A	L21-20	(18) C13 + (6) C19 Outlets + (3) 5-20 Convenience Outlets****	5.7 kW	42U & higher	
EA-4007-C	EA-4007-E	EA-4007-CE	30A	L21-30	(24) C13	8.6 kW	42U & higher	
EA-4015-C	EA-4015-E	EA-4015-CE	30A	L21-30	(18) C13 + (6) C19	8.6 kW	42U & higher	
EA-4026-C	EA-4026-E	EA-4026-CE	30A	L21-30	(18) C13 + (6) C19 Outlets + (3) 5-20 Convenience Outlets****	8.6 kW	42U & higher	
EA-4035-C	EA-4035-E	EA-4035-CE	30A	L21-30	(36) C13	8.6 kW	42U & higher	
208 Volt, Three-Phase Input								
EA-4005-C	EA-4005-E	EA-4005-CE	30A	L15-30	(24) C13	8.6 kW	42U & higher	
EA-4013-C	EA-4013-E	EA-4013-CE	30A	L15-30	(18) C13 + (6) C19	8.6 kW	42U & higher	
EA-4034-C	EA-4034-E	EA-4034-CE	30A	L15-30	(36) C13	8.6 kW	42U & higher	
EA-4016-C	EA-4016-E	EA-4016-CE	50A	CS8365	(18) C13 + (6) C19	14.4 kW	42U & higher	
EA-4027-C	EA-4027-E	EA-4027-CE	50A	CS8365	(12) C13 + (12) C19	14.4 kW	42U & higher	
EA-4136-C	EA-4136-E	EA-4136-CE	50A	CS8365	(36) C13	14.4kW	45U & higher	
EA-4144-C	EA-4144-E	EA-4144-CE	50A	CS8365	(24) C13 + (12) C19	14.4 kW	45U & higher	
EA-4017-C	EA-4017-E	EA-4017-CE	60A	IEC 60309 60A 3P+E	(18) C13 + (6) C19	17.2 kW	42U & higher	
EA-4028-C	EA-4028-E	EA-4028-CE	60A	IEC 60309 60A 3P+E	(12) C13 + (12) C19	17.2 kW	42U & higher	
EA-4137-C	EA-4137-E	EA-4137-CE	60A	IEC 60309 60A 3P+E	(36) C13	17.2 kW	45U & higher	
EA-4145-C	EA-4145-E	EA-4145-CE	60A	IEC 60309 60A 3P+E	(24) C13 + (12) C19	17.2 kW	45U & higher	
240/415 Volt, Three-Phase Input								
EA-4018-C	EA-4018-E	EA-4018-CE	30A	L22-30	(18) C13 + (6) C19	17.2 kW	42U & higher	
EA-4029-C	EA-4029-E	EA-4029-CE	30A	L22-30	(12) C13 + (12) C19	17.2 kW	42U & higher	
EA-4038-C	EA-4038-E	EA-4038-CE	30A	L22-30	(36) C13	17.2 kW	42U & higher	
EA-4046-C	EA-4046-E	EA-4046-CE	30A	L22-30	(24) C13 + (12) C19	17.2 kW	42U & higher	

Metered eConnect PDU, Vertical - Worldwide								
Part Number			Input Amperage	Input Plug	Outlets	kW Capacity Worldwide (CE)	kW Capacity North America (UL)	Cabinet Capability
Black*	Glacier White*	Redundancy Pack**						
220 - 240 Volt, Single-Phase Input								
EA-4008-C	EA-4008-E	EA-4008-CE	16A	C20 Inlet to IEC 60309 16A 1P+N+E	(24) C13	3.8kW	3.8kW	42U & higher
EA-4019-C	EA-4019-E	EA-4019-CE	16A	C20 Inlet to IEC 60309 16A 1P+N+E	(18) C13 + (6) C19	3.8kW	3.8kW	42U & higher
EA-4009-C	EA-4009-E	EA-4009-CE	32A	IEC 60309 32A 1P+N+E	(24) C13	7.7 kW	6.1kW	42U & higher
EA-4020-C	EA-4020-E	EA-4020-CE	32A	IEC 60309 32A 1P+N+E	(18) C13 + (6) C19	7.7 kW	6.1kW	42U & higher
220-240/380-415 Volt, Three-Phase Input								
EA-4010-C	EA-4010-E	EA-4010-CE	16/20A	IEC 60309 16/20A 3P+N+E	(24) C13	11.5kW	11.5kW	42U & higher
EA-4021-C	EA-4021-E	EA-4021-CE	16/20A	IEC 60309 16/20A 3P+N+E	(18) C13 + (6) C19	11.5kW	11.5kW	42U & higher
EA-4030-C	EA-4030-E	EA-4030-CE	16/20A	IEC 60309 16/20A 3P+N+E	(12) C13 + (12) C19	11.5kW	11.5kW	42U & higher
EA-4039-C	EA-4039-E	EA-4039-CE	16/20A	IEC 60309 16/20A 3P+N+E	(36) C13	11.5kW	11.5kW	42U & higher
EA-4047-C	EA-4047-E	EA-4047-CE	16/20A	IEC 60309 16/20A 3P+N+E	(24) C13 + (12) C19	11.5kW	11.5kW	42U & higher
EA-4022-C	EA-4022-E	EA-4022-CE	32A	IEC 60309 32A 3P+N+E	(18) C13 + (6) C19	23 kW	18.4kW	42U & higher
EA-4031-C	EA-4031-E	EA-4031-CE	32A	IEC 60309 32A 3P+N+E	(12) C13 + (12) C19	23 kW	18.4kW	42U & higher
EA-4040-C	EA-4040-E	EA-4040-CE	32A	IEC 60309 32A 3P+N+E	(36) C13	23 kW	18.4kW	42U & higher
EA-4048-C	EA-4048-E	EA-4048-CE	32A	IEC 60309 32A 3P+N+E	(24) C13 + (12) C19	23 kW	18.4kW	42U & higher

Notes:

* Shipping weight for each unit is 27 lb (12 kg).

**Redundancy Pack includes 2 PDUs (one in Black, one in Glacier White) for easy identification of the primary and secondary unit; shipping weight is 54 lb (24 kg).

***Convenience outlets do not provide monitoring or switching capabilities.

Monitored Pro eConnect PDU, Horizontal

Robust cabinet-level power management.

Use Horizontal eConnect PDUs in applications that require outlets at the top or bottom of cabinets for quick access, low- to medium-density applications that require fewer connections and in distributed infrastructure for edge applications.



Monitored Pro eConnect PDU, Horizontal - North America									
Part Number			Input Amperage	Input Plug	Outlets	kW Capacity (UL)	Form Factor (U) Height		
Black*	Glacier White*	Redundancy Pack**							
120 Volt, Single-Phase Input									
EA-4274-C	EA-4274-E	EA-4274-CE	20A	C20 Inlet to L5-20	(12) 5-20	1.9 kW	1U		
EA-4275-C	EA-4275-E	EA-4275-CE	30A	NEMA L5-30P	(12) 5-20	2.9 kW	1U		
208 Volt, Single-Phase Input									
EA-4276-C	EA-4276-E	EA-4276-CE	20A	C20 Inlet to L6-20	(12) C13	3.3 kW	1U		
EA-4293-C	EA-4293-E	EA-4293-CE	20A	C20 Inlet to L6-20	(8) C13 + (4) C19	3.3 kW	1U		
EA-4277-C	EA-4277-E	EA-4277-CE	30A	NEMA L6-30P	(12) C13	5 kW	1U		
EA-4284-C	EA-4284-E	EA-4284-CE	30A	NEMA L6-30P	(9) C19	5 kW	1U		
EA-4294-C	EA-4294-E	EA-4294-CE	30A	NEMA L6-30P	(8) C13 + (4) C19	5 kW	1U		
120/208 Volt, Three-Phase Input									
EA-4279-C	EA-4279-E	EA-4279-CE	20A	NEMA L21-20P	(12) C13	5.7 kW	1U		
EA-4279-C	EA-4279-E	EA-4279-CE	20A	NEMA L21-20P	(12) C13	5.7 kW	1U		
EA-4296-C	EA-4296-E	EA-4296-CE	20A	NEMA L21-20P	(8) C13 + (4) C19	5.7 kW	1U		
EA-4280-C	EA-4280-E	EA-4280-CE	30A	NEMA L21-30P	(12) C13	8.6 kW	1U		
EA-4287-C	EA-4287-E	EA-4287-CE	30A	NEMA L21-30P	(9) C19	8.6 kW	1U		
EA-4297-C	EA-4297-E	EA-4297-CE	30A	NEMA L21-30P	(8) C13 + (4) C19	8.6 kW	1U		
208 Volt, Three-Phase Input									
EA-4278-C	EA-4278-E	EA-4278-CE	30A	NEMA L15-30P	(12) C13	8.6 kW	1U		
EA-4285-C	EA-4285-E	EA-4285-CE	30A	NEMA L15-30P	(9) C19	8.6 kW	1U		
EA-4295-C	EA-4295-E	EA-4295-CE	30A	NEMA L15-30P	(8) C13 + (4) C19	8.6 kW	1U		
Monitored Pro eConnect PDU, Horizontal - Worldwide									
Part Number			Input Amperage	Input Plug	Outlets	kW Capacity (UL)	kW Capacity North America (UL)	Form Factor (U) Height	
Black*	Glacier White*	Redundancy Pack**							
220 - 240 Volt, Single-Phase Input									
EA-4281-C	EA-4281-E	EA-4281-CE	16A	C20 Inlet to IEC 60309 16A 1P+N+E	(12) C13	3.8 kW	3.8 kW	1U	
EA-4298-C	EA-4298-E	EA-4298-CE	16A	C20 Inlet to IEC 60309 16A 1P+N+E	(8) C13 + (4) C19	3.8 kW	3.8 kW	1U	
EA-4283-C	EA-4283-E	EA-4283-CE	32A	IEC 60309 32A 1P+N+E	(12) C13	7.7 kW	6.1 kW	1U	
EA-4289-C	EA-4289-E	EA-4289-CE	32A	IEC 60309 32A 1P+N+E	(9) C19	7.7 kW	6.1 kW	1U	
EA-42A0-C	EA-42A0-E	EA-42A0-CE	32A	IEC 60309 32A 1P+N+E	(8) C13 + (4) C19	7.7 kW	6.1 kW	1U	
220 - 240/380-415 Volt, Three-Phase Input									
EA-4282-C	EA-4282-E	EA-4282-CE	16/20A	IEC 60309 16/20A 3P+N+E	(12) C13	11.5 kW	11.5 kW	1U	
EA-4288-C	EA-4288-E	EA-4288-CE	16/20A	IEC 60309 16/20A 3P+N+E	(9) C19	11.5 kW	11.5 kW	1U	
EA-4299-C	EA-4299-E	EA-4299-CE	16/20A	IEC 60309 16/20A 3P+N+E	(8) C13 + (4) C19	11.5 kW	11.5 kW	1U	

Notes:

*Shipping weight for each unit is 18 lb (8.2 kg).

**Redundancy Pack includes 2 PDUs in Black and Glacier White for easy identification of the primary and secondary unit; shipping weight is 35 lb (15.9 kg)

Monitored Pro eConnect PDU, Horizontal

Robust cabinet-level power management.

Use Horizontal eConnect PDUs in applications that require outlets at the top or bottom of cabinets for quick access, low- to medium-density applications that require fewer connections and in distributed infrastructure for edge applications.



2U

Monitored Pro eConnect PDU, Horizontal - North America									
Part Number			Input Amperage	Input Plug	Outlets	kW Capacity (UL)	Form Factor (U) Height		
Black*	Glacier White*	Redundancy Pack**							
120 Volt, Single-Phase Input									
EA-4401-C	EA-4401-E	EA-4401-CE	20A	C20 Inlet to L5-20	(24) 5-20	1.9 kW	2U		
EA-4402-C	EA-4402-E	EA-4402-CE	30A	NEMA L5-30P	(24) 5-20	2.9 kW	2U		
208 Volt, Single-Phase Input									
EA-4470-C	EA-4470-E	EA-4470-CE	20A	C20 Inlet to L6-20	(24) C13	3.3 kW	2U		
EA-4469-C	EA-4469-E	EA-4469-CE	20A	C20 Inlet to L6-20	(18) C13 + (6) C19	3.3 kW	2U		
EA-4404-C	EA-4404-E	EA-4404-CE	30A	NEMA L6-30P	(24) C13	5 kW	2U		
EA-4412-C	EA-4412-E	EA-4412-CE	30A	NEMA L6-30P	(18) C13 + (6) C19	5 kW	2U		
EA-44A1-C	EA-44A1-E	EA-44A1-CE	30A	NEMA L6-30P	(6) C13 + (12) C19	5 kW	2U		
120/208 Volt, Single-Phase Input									
EA-4492-C	EA-4492-E	EA-4492-CE	30A	NEMA L14-30P	(12) C13 + (6) C19 + (4) 5-20	5 kW	2U		
120/208 Volt, Three-Phase Input									
EA-4406-C	EA-4406-E	EA-4406-CE	20A	NEMA L21-20P	(24) C13	5.7 kW	2U		
EA-4414-C	EA-4414-E	EA-4414-CE	20A	NEMA L21-20P	(18) C13 + (6) C19	5.7 kW	2U		
EA-44A3-C	EA-44A3-E	EA-44A3-CE	20A	NEMA L21-20P	(6) C13 + (12) C19	5.7 kW	2U		
EA-4490-C	EA-4490-E	EA-4490-CE	20A	NEMA L21-20P	(12) C13 + (6) C19 + (4) 5-20	5.7 kW	2U		
EA-4407-C	EA-4407-E	EA-4407-CE	30A	NEMA L21-30P	(24) C13	8.6 kW	2U		
EA-4415-C	EA-4415-E	EA-4415-CE	30A	NEMA L21-30P	(18) C13 + (6) C19	8.6 kW	2U		
EA-44A5-C	EA-44A5-E	EA-44A5-CE	30A	NEMA L21-30P	(6) C13 + (12) C19	8.6 kW	2U		
EA-4491-C	EA-4491-E	EA-4491-CE	30A	NEMA L21-30P	(12) C13 + (6) C19 + (4) 5-20	8.6 kW	2U		
208 Volt, Three-Phase Input									
EA-4405-C	EA-4405-E	EA-4405-CE	30A	NEMA L15-30P	(24) C13	8.6 kW	2U		
EA-4413-C	EA-4413-E	EA-4413-CE	30A	NEMA L15-30P	(18) C13 + (6) C19	8.6 kW	2U		
EA-44A6-C	EA-44A6-E	EA-44A6-CE	30A	NEMA L15-30P	(6) C13 + (12) C19	8.6 kW	2U		
EA-44A7-C	EA-44A7-E	EA-44A7-CE	50A	CS8365	(6) C13 + (12) C19	14.4 kW	2U		
EA-44A8-C	EA-44A8-E	EA-44A8-CE	60A	IEC 60309 60A 3P+E	(6) C13 + (12) C19	17.2 kW	2U		
Monitored Pro eConnect PDU, Horizontal - Worldwide									
Part Number			Input Amperage	Input Plug	Outlets	kW Capacity (UL)	kW Capacity North America (UL)	Form Factor (U) Height	
Black*	Glacier White*	Redundancy Pack**							
220 - 240 Volt, Single-Phase Input									
EA-4408-C	EA-4408-E	EA-4408-CE	16A	C20 Inlet to IEC 60309 16A 1P+N+E	(24) C13	3.8 kW	3.8 kW	2U	
EA-4419-C	EA-4419-E	EA-4419-CE	16A	C20 Inlet to IEC 60309 16A 1P+N+E	(18) C13 + (6) C19	3.8 kW	3.8 kW	2U	
EA-4409-C	EA-4409-E	EA-4409-CE	32A	IEC 60309 32A 1P+N+E	(24) C13	7.7 kW	6.1 kW	2U	
EA-4420-C	EA-4420-E	EA-4420-CE	32A	IEC 60309 32A 1P+N+E	(18) C13 + (6) C19	7.7 kW	6.1 kW	2U	
EA-44A2-C	EA-44A2-E	EA-44A2-CE	32A	IEC 60309 32A 1P+N+E	(6) C13 + (12) C19	7.7 kW	6.1 kW	2U	
220 - 240/380-415 Volt, Three-Phase Input									
EA-4410-C	EA-4410-E	EA-4410-CE	16/20A	IEC 60309 16/20A 3P+N+E	(24) C13	11.5 kW	11.5 kW	2U	
EA-4421-C	EA-4421-E	EA-4421-CE	16/20A	IEC 60309 16/20A 3P+N+E	(18) C13 + (6) C19	11.5 kW	11.5 kW	2U	
EA-44A4-C	EA-44A4-E	EA-44A4-CE	16/20A	IEC 60309 16/20A 3P+N+E	(6) C13 + (12) C19	11.5 kW	11.5 kW	2U	
EA-44A9-C	EA-44A9-E	EA-44A9-CE	32A	IEC 60309 32A 3P+N+E	(6) C13 + (12) C19	23 kW	18.4 kW	2U	

Notes:

*Shipping weight for each unit is 23 lb (10.4 kg)

**Redundancy Pack includes 2 PDUs in Black and Glacier White for easy identification of the primary and secondary unit; shipping weight is 45 lb (20.4 kg)

Switched eConnect PDU

Cabinet-level power management, device-level power control.

Select Switched eConnect PDUs for remote equipment provisioning and sequencing, and to prevent efficiency problems identified during monitoring.

- ✓ Basic Power Distribution
- ✓ Inlet Metering
- ✓ Branch Circuit Metering
- ✓ Remote Access
- ✓ Access Control
- ✓ Switched Outlets

Switched eConnect PDU, Vertical - North America								
Part Number			Input Amperage	Input Plug	Outlets	kW Capacity (UL)	Cabinet Capability	
Black*	Glacier White*	Redundancy Pack**						
120 Volt, Single-Phase Input								
EA-5001-C	EA-5001-E	EA-5001-CE	20A	C20 Inlet to L5-20	(24) 5-20	1.9 kW	42U & higher	
EA-5002-C	EA-5002-E	EA-5002-CE	30A	L5-30	(24) 5-20	2.9 kW	42U & higher	
208 Volt, Single-Phase Input								
EA-5069-C	EA-5069-E	EA-5069-CE	20A	C20 Inlet to L6-20	(18) C13 + (6) C19	3.3 kW	42U & higher	
EA-5070-C	EA-5070-E	EA-5070-CE	20A	C20 Inlet to L6-20	(24) C13	3.3 kW	42U & higher	
EA-5004-C	EA-5004-E	EA-5004-CE	30A	L6-30	(24) C13	5 kW	42U & higher	
EA-5012-C	EA-5012-E	EA-5012-CE	30A	L6-30	(18) C13 + (6) C19	5 kW	42U & higher	
120 - 208 Volt, Three-Phase Input								
EA-5006-C	EA-5006-E	EA-5006-CE	20A	L21-20	(24) C13	5.7 kW	42U & higher	
EA-5014-C	EA-5014-E	EA-5014-CE	20A	L21-20	(18) C13 + (6) C19	5.7 kW	42U & higher	
EA-5025-C	EA-5025-E	EA-5025-CE	20A	L21-20	(18) C13 + (6) C19 Outlets + (3) 5-20 Convenience Outlets***	5.7 kW	42U & higher	
EA-5007-C	EA-5007-E	EA-5007-CE	30A	L21-30	(24) C13	8.6 kW	42U & higher	
EA-5015-C	EA-5015-E	EA-5015-CE	30A	L21-30	(18) C13 + (6) C19	8.6 kW	42U & higher	
EA-5026-C	EA-5026-E	EA-5026-CE	30A	L21-30	(18) C13 + (6) C19 Outlets + (3) 5-20 Convenience Outlets***	8.6 kW	42U & higher	
EA-5035-C	EA-5035-E	EA-5035-CE	30A	L21-30	(36) C13	8.6 kW	42U & higher	
208 Volt, Three-Phase Input								
EA-5005-C	EA-5005-E	EA-5005-CE	30A	L15-30	(24) C13	8.6 kW	42U & higher	
EA-5013-C	EA-5013-E	EA-5013-CE	30A	L15-30	(18) C13 + (6) C19	8.6 kW	42U & higher	
EA-5034-C	EA-5034-E	EA-5034-CE	30A	L15-30	(36) C13	8.6 kW	42U & higher	
EA-5016-C	EA-5016-E	EA-5016-CE	50A	CS8365	(18) C13 + (6) C19	14.4 kW	42U & higher	
EA-5027-C	EA-5027-E	EA-5027-CE	50A	CS8365	(12) C13 + (12) C19	14.4 kW	42U & higher	
EA-5136-C	EA-5136-E	EA-5136-CE	50A	CS8365	(36) C13	14.4 kW	45U & higher	
EA-5144-C	EA-5144-E	EA-5144-CE	50A	CS8365	(24) C13 + (12) C19	14.4 kW	45U & higher	
EA-5017-C	EA-5017-E	EA-5017-CE	60A	IEC 60309 60A 3P+E	(18) C13 + (6) C19	17.2 kW	42U & higher	
EA-5028-C	EA-5028-E	EA-5028-CE	60A	IEC 60309 60A 3P+E	(12) C13 + (12) C19	17.2 kW	42U & higher	
EA-5137-C	EA-5137-E	EA-5137-CE	60A	IEC 60309 60A 3P+E	(36) C13	17.2 kW	45U & higher	
EA-5145-C	EA-5145-E	EA-5145-CE	60A	IEC 60309 60A 3P+E	(24) C13 + (12) C19	17.2 kW	45U & higher	
240/415 Volt, Three-Phase Input								
EA-5018-C	EA-5018-E	EA-5018-CE	30A	L22-30	(18) C13 + (6) C19	17.2 kW	42U & higher	
EA-5029-C	EA-5029-E	EA-5029-CE	30A	L22-30	(12) C13 + (12) C19	17.2 kW	42U & higher	
EA-5038-C	EA-5038-E	EA-5038-CE	30A	L22-30	(36) C13	17.2 kW	42U & higher	
EA-5046-C	EA-5046-E	EA-5046-CE	30A	L22-30	(24) C13 + (12) C19	17.2 kW	42U & higher	

Switched eConnect PDU, Vertical - Worldwide								
Part Number			Input Amperage	Input Plug	Outlets	kW Capacity Worldwide (CE)	kW Capacity North America (UL)	Cabinet Capability
Black*	Glacier White*	Redundancy Pack**						
220 - 240 Volt, Single-Phase Input								
EA-5008-C	EA-5008-E	EA-5008-CE	16A	C20 Inlet to IEC 60309 16A 1P+N+E	(24) C13	3.8 kW	3.8 kW	42U & higher
EA-5019-C	EA-5019-E	EA-5019-CE	16A	C20 Inlet to IEC 60309 16A 1P+N+E	(18) C13 + (6) C19	3.8 kW	3.8 kW	42U & higher
EA-5009-C	EA-5009-E	EA-5009-CE	32A	IEC 60309 32A 1P+N+E	(24) C13	7.7 kW	6.1 kW	42U & higher
EA-5020-C	EA-5020-E	EA-5020-CE	32A	IEC 60309 32A 1P+N+E	(18) C13 + (6) C19	7.7 kW	6.1 kW	42U & higher
220-240/380-415 Volt, Three-Phase Input								
EA-5010-C	EA-5010-E	EA-5010-CE	16/20A	IEC 60309 16/20A 3P+N+E	(24) C13	11.5 kW	11.5 kW	42U & higher
EA-5021-C	EA-5021-E	EA-5021-CE	16/20A	IEC 60309 16/20A 3P+N+E	(18) C13 + (6) C19	11.5 kW	11.5 kW	42U & higher
EA-5030-C	EA-5030-E	EA-5030-CE	16/20A	IEC 60309 16/20A 3P+N+E	(12) C13 + (12) C19	11.5 kW	11.5 kW	42U & higher
EA-5039-C	EA-5039-E	EA-5039-CE	16/20A	IEC 60309 16/20A 3P+N+E	(36) C13	11.5 kW	11.5 kW	42U & higher
EA-5047-C	EA-5047-E	EA-5047-CE	16/20A	IEC 60309 16/20A 3P+N+E	(24) C13 + (12) C19	11.5 kW	11.5 kW	42U & higher
EA-5022-C	EA-5022-E	EA-5022-CE	32A	IEC 60309 32A 3P+N+E	(18) C13 + (6) C19	23 kW	18.4 kW	42U & higher
EA-5031-C	EA-5031-E	EA-5031-CE	32A	IEC 60309 32A 3P+N+E	(12) C13 + (12) C19	23 kW	18.4 kW	42U & higher
EA-5040-C	EA-5040-E	EA-5040-CE	32A	IEC 60309 32A 3P+N+E	(36) C13	23 kW	18.4 kW	42U & higher
EA-5048-C	EA-5048-E	EA-5048-CE	32A	IEC 60309 32A 3P+N+E	(24) C13 + (12) C19	23 kW	18.4 kW	42U & higher

Notes:

* Shipping weight for each unit is 27 lb (12 kg).

**Redundancy Pack includes 2 PDUs (one in Black, one in Glacier White) for easy identification of the primary and secondary unit; shipping weight is 54 lb (24 kg).

***Convenience outlets do not provide monitoring or switching capabilities.

Switched Pro eConnect PDU

Device-level power management and control.

Select Switched Pro eConnect PDUs to remotely measure and cycle power for each piece of equipment within the cabinet.

- ✓ Basic Power Distribution
- ✓ Inlet Metering
- ✓ Branch Circuit Metering
- ✓ Remote Access
- ✓ Access Control
- ✓ Outlet Metering
- ✓ Switched Outlets

Switched Pro eConnect PDU, Vertical - North America								
Part Number			Input Amperage	Input Plug	Outlets	kW Capacity (UL)	Cabinet Capability	
Black*	Glacier White*	Redundancy Pack**						
120 Volt, Single-Phase Input								
EA-6001-C	EA-6001-E	EA-6001-CE	20A	C20 Inlet to L5-20	(24) 5-20	1.9 kW	42U & higher	
EA-6002-C	EA-6002-E	EA-6002-CE	30A	L5-30	(24) 5-20	2.9 kW	42U & higher	
208 Volt, Single-Phase Input								
EA-6069-C	EA-6069-E	EA-6069-CE	20A	C20 Inlet to L6-20	(18) C13 + (6) C19	3.3 kW	42U & higher	
EA-6070-C	EA-6070-E	EA-6070-CE	20A	C20 Inlet to L6-20	(24) C13	3.3 kW	42U & higher	
EA-6004-C	EA-6004-E	EA-6004-CE	30A	L6-30	(24) C13	5 kW	42U & higher	
EA-6012-C	EA-6012-E	EA-6012-CE	30A	L6-30	(18) C13 + (6) C19	5 kW	42U & higher	
120 - 208 Volt, Three-Phase Input								
EA-6006-C	EA-6006-E	EA-6006-CE	20A	L21-20	(24) C13	5.7 kW	42U & higher	
EA-6014-C	EA-6014-E	EA-6014-CE	20A	L21-20	(18) C13 + (6) C19	5.7 kW	42U & higher	
EA-6025-C	EA-6025-E	EA-6025-CE	20A	L21-20	(18) C13 + (6) C19 Outlets + (3) 5-20 Convenience Outlets***	5.7 kW	42U & higher	
EA-6007-C	EA-6007-E	EA-6007-CE	30A	L21-30	(24) C13	8.6 kW	42U & higher	
EA-6015-C	EA-6015-E	EA-6015-CE	30A	L21-30	(18) C13 + (6) C19	8.6 kW	42U & higher	
EA-6026-C	EA-6026-E	EA-6026-CE	30A	L21-30	(18) C13 + (6) C19 Outlets + (3) 5-20 Convenience Outlets***	8.6 kW	42U & higher	
EA-6035-C	EA-6035-E	EA-6035-CE	30A	L21-30	(36) C13	8.6 kW	42U & higher	
208 Volt, Three-Phase Input								
EA-6005-C	EA-6005-E	EA-6005-CE	30A	L15-30	(24) C13	8.6 kW	42U & higher	
EA-6013-C	EA-6013-E	EA-6013-CE	30A	L15-30	(18) C13 + (6) C19	8.6 kW	42U & higher	
EA-6034-C	EA-6034-E	EA-6034-CE	30A	L15-30	(36) C13	8.6 kW	42U & higher	
EA-6016-C	EA-6016-E	EA-6016-CE	50A	CS8365	(18) C13 + (6) C19	14.4 kW	42U & higher	
EA-6027-C	EA-6027-E	EA-6027-CE	50A	CS8365	(12) C13 + (12) C19	14.4 kW	42U & higher	
EA-6136-C	EA-6136-E	EA-6136-CE	50A	CS8365	(36) C13	14.4 kW	45U & higher	
EA-6144-C	EA-6144-E	EA-6144-CE	50A	CS8365	(24) C13 + (12) C19	14.4 kW	45U & higher	
EA-6017-C	EA-6017-E	EA-6017-CE	60A	IEC 60309 60A 3P+E	(18) C13 + (6) C19	17.2 kW	42U & higher	
EA-6028-C	EA-6028-E	EA-6028-CE	60A	IEC 60309 60A 3P+E	(12) C13 + (12) C19	17.2 kW	42U & higher	
EA-6137-C	EA-6137-E	EA-6137-CE	60A	IEC 60309 60A 3P+E	(36) C13	17.2 kW	45U & higher	
EA-6145-C	EA-6145-E	EA-6145-CE	60A	IEC 60309 60A 3P+E	(24) C13 + (12) C19	17.2 kW	45U & higher	
240/415 Volt, Three-Phase Input								
EA-6018-C	EA-6018-E	EA-6018-CE	30A	L22-30	(18) C13 + (6) C19	17.2 kW	42U & higher	
EA-6029-C	EA-6029-E	EA-6029-CE	30A	L22-30	(12) C13 + (12) C19	17.2 kW	42U & higher	
EA-6038-C	EA-6038-E	EA-6038-CE	30A	L22-30	(36) C13	17.2 kW	42U & higher	
EA-6046-C	EA-6046-E	EA-6046-CE	30A	L22-30	(24) C13 + (12) C19	17.2 kW	42U & higher	
Switched Pro eConnect PDU, Vertical - Worldwide								
Part Number			Input Amperage	Input Plug	Outlets	kW Capacity Worldwide (CE)	kW Capacity North America (UL)	Cabinet Capability
Black*	Glacier White*	Redundancy Pack**						
220 - 240 Volt, Single-Phase Input								
EA-6008-C	EA-6008-E	EA-6008-CE	16/20A	C20 Inlet to IEC 60309 16/20A 1P+N+E	(24) C13	3.8 kW	3.8 kW	42U & higher
EA-6019-C	EA-6019-E	EA-6019-CE	16/20A	C20 Inlet to IEC 60309 16/20A 1P+N+E	(18) C13 + (6) C19	3.8 kW	3.8 kW	42U & higher
EA-6009-C	EA-6009-E	EA-6009-CE	32A	IEC 60309 32A 1P+N+E	(24) C13	7.7 kW	6.1 kW	42U & higher
EA-6020-C	EA-6020-E	EA-6020-CE	32A	IEC 60309 32A 1P+N+E	(18) C13 + (6) C19	7.7 kW	6.1 kW	42U & higher
220-240/380-415 Volt, Three-Phase Input								
EA-6010-C	EA-6010-E	EA-6010-CE	16/20A	IEC 60309 16/20A 3P+N+E	(24) C13	11.5 kW	11.5 kW	42U & higher
EA-6021-C	EA-6021-E	EA-6021-CE	16/20A	IEC 60309 16/20A 3P+N+E	(18) C13 + (6) C19	11.5 kW	11.5 kW	42U & higher
EA-6030-C	EA-6030-E	EA-6030-CE	16/20A	IEC 60309 16/20A 3P+N+E	(12) C13 + (12) C19	11.5 kW	11.5 kW	42U & higher
EA-6039-C	EA-6039-E	EA-6039-CE	16/20A	IEC 60309 16/20A 3P+N+E	(36) C13	11.5 kW	11.5 kW	42U & higher
EA-6047-C	EA-6047-E	EA-6047-CE	16/20A	IEC 60309 16/20A 3P+N+E	(24) C13 + (12) C19	11.5 kW	11.5 kW	42U & higher
EA-6022-C	EA-6022-E	EA-6022-CE	32A	IEC 60309 32A 3P+N+E	(18) C13 + (6) C19	23 kW	18.4 kW	42U & higher
EA-6031-C	EA-6031-E	EA-6031-CE	32A	IEC 60309 32A 3P+N+E	(12) C13 + (12) C19	23 kW	18.4 kW	42U & higher
EA-6040-C	EA-6040-E	EA-6040-CE	32A	IEC 60309 32A 3P+N+E	(36) C13	23 kW	18.4 kW	42U & higher
EA-6048-C	EA-6048-E	EA-6048-CE	32A	IEC 60309 32A 3P+N+E	(24) C13 + (12) C19	23 kW	18.4 kW	42U & higher

Notes:

* Shipping weight for each unit is 27 lb (12 kg).

**Redundancy Pack includes 2 PDUs (one in Black, one in Glacier White) for easy identification of the primary and secondary unit; shipping weight is 54 lb (24 kg).

***Convenience outlets do not provide monitoring or switching capabilities.

Switched Pro eConnect PDU, Horizontal

Device-level power management and control.

Use Horizontal eConnect PDUs in applications that require outlets at the top or bottom of cabinets for quick access, low- to medium-density applications that require fewer connections and in distributed infrastructure for edge applications.



1U

Switched Pro eConnect PDU, Horizontal - North America

Part Number			Input Amperage	Input Plug	Outlets	kW Capacity (UL)	Form Factor (U) Height
Black*	Glacier White*	Redundancy Pack**					
120 Volt, Single-Phase Input							
EA-6274-C	EA-6274-E	EA-6274-CE	20A	C20 Inlet to L5-20	(12) 5-20	1.9 kW	1U
EA-6275-C	EA-6275-E	EA-6275-CE	30A	NEMA L5-30P	(12) 5-20	2.9 kW	1U
208 Volt, Single-Phase Input							
EA-6276-C	EA-6276-E	EA-6276-CE	20A	C20 Inlet to L6-20	(12) C13	3.3 kW	1U
EA-6293-C	EA-6293-E	EA-6293-CE	20A	C20 Inlet to L6-20	(8) C13 + (4) C19	3.3 kW	1U
EA-6277-C	EA-6277-E	EA-6277-CE	30A	NEMA L6-30P	(12) C13	5 kW	1U
EA-6284-C	EA-6284-E	EA-6284-CE	30A	NEMA L6-30P	(9) C19	5 kW	1U
EA-6294-C	EA-6294-E	EA-6294-CE	30A	NEMA L6-30P	(8) C13 + (4) C19	5 kW	1U
120/208 Volt, Three-Phase Input							
EA-6279-C	EA-6279-E	EA-6279-CE	20A	NEMA L21-20P	(12) C13	5.7 kW	1U
EA-6286-C	EA-6286-E	EA-6286-CE	20A	NEMA L21-20P	(9) C19	5.7 kW	1U
EA-6296-C	EA-6296-E	EA-6296-CE	20A	NEMA L21-20P	(8) C13 + (4) C19	5.7 kW	1U
EA-6280-C	EA-6280-E	EA-6280-CE	30A	NEMA L21-30P	(12) C13	8.6 kW	1U
EA-6287-C	EA-6287-E	EA-6287-CE	30A	NEMA L21-30P	(9) C19	8.6 kW	1U
EA-6297-C	EA-6297-E	EA-6297-CE	30A	NEMA L21-30P	(8) C13 + (4) C19	8.6 kW	1U
208 Volt, Three-Phase Input							
EA-6278-C	EA-6278-E	EA-6278-CE	30A	NEMA L15-30P	(12) C13	8.6 kW	1U
EA-6285-C	EA-6285-E	EA-6285-CE	30A	NEMA L15-30P	(9) C19	8.6 kW	1U
EA-6295-C	EA-6295-E	EA-6295-CE	30A	NEMA L15-30P	(8) C13 + (4) C19	8.6 kW	1U

Switched Pro eConnect PDU, Horizontal - Worldwide

Part Number			Input Amperage	Input Plug	Outlets	kW Capacity (UL)	kW Capacity North America (UL)	Form Factor (U) Height
Black*	Glacier White*	Redundancy Pack**						
220 - 240 Volt, Single-Phase Input								
EA-6281-C	EA-6281-E	EA-6281-CE	16A	C20 Inlet to IEC 60309 16A 1P+N+E	(12) C13	3.8 kW	3.8 kW	1U
EA-6298-C	EA-6298-E	EA-6298-CE	16A	C20 Inlet to IEC 60309 16A 1P+N+E	(8) C13 + (4) C19	3.8 kW	3.8 kW	1U
EA-6283-C	EA-6283-E	EA-6283-CE	32A	IEC 60309 32A 1P+N+E	(12) C13	7.7 kW	6.1 kW	1U
EA-6289-C	EA-6289-E	EA-6289-CE	32A	IEC 60309 32A 1P+N+E	(9) C19	7.7 kW	6.1 kW	1U
EA-62A0-C	EA-62A0-E	EA-62A0-CE	32A	IEC 60309 32A 1P+N+E	(8) C13 + (4) C19	7.7 kW	6.1 kW	1U
220 - 240/380-415 Volt, Three-Phase Input								
EA-6282-C	EA-6282-E	EA-6282-CE	16/20A	IEC 60309 16/20A 3P+N+E	(12) C13	11.5 kW	11.5 kW	1U
EA-6288-C	EA-6288-E	EA-6288-CE	16/20A	IEC 60309 16/20A 3P+N+E	(9) C19	11.5 kW	11.5 kW	1U
EA-6299-C	EA-6299-E	EA-6299-CE	16/20A	IEC 60309 16/20A 3P+N+E	(8) C13 + (4) C19	11.5 kW	11.5 kW	1U

Notes:

*Shipping weight for each unit is 18 lb (8.2 kg).

**Redundancy Pack includes 2 PDUs in Black and Glacier White for easy identification of the primary and secondary unit; shipping weight is 35 lb (15.9 kg)

Switched Pro eConnect PDU, Horizontal

Device-level power management and control.

Use Horizontal eConnect PDUs in applications that require outlets at the top or bottom of cabinets for quick access, low- to medium-density applications that require fewer connections and in distributed infrastructure for edge applications.



2U

Switched Pro eConnect PDU, Horizontal - North America									
Part Number			Input Amperage	Input Plug	Outlets	kW Capacity (UL)	Form Factor (U) Height		
Black*	Glacier White*	Redundancy Pack**							
120 Volt, Single-Phase Input									
EA-6401-C	EA-6401-E	EA-6401-CE	20A	C20 Inlet to L5-20	(24) 5-20	1.9 kW	2U		
EA-6402-C	EA-6402-E	EA-6402-CE	30A	NEMA L5-30P	(24) 5-20	2.9 kW	2U		
208 Volt, Single-Phase Input									
EA-6470-C	EA-6470-E	EA-6470-CE	20A	C20 Inlet to L6-20	(24) C13	3.3 kW	2U		
EA-6469-C	EA-6469-E	EA-6469-CE	20A	C20 Inlet to L6-20	(18) C13 + (6) C19	3.3 kW	2U		
EA-6404-C	EA-6404-E	EA-6404-CE	30A	NEMA L6-30P	(24) C13	5 kW	2U		
EA-6412-C	EA-6412-E	EA-6412-CE	30A	NEMA L6-30P	(18) C13 + (6) C19	5 kW	2U		
EA-64A1-C	EA-64A1-E	EA-64A1-CE	30A	NEMA L6-30P	(6) C13 + (12) C19	5 kW	2U		
120/208 Volt, Single-Phase Input									
EA-6492-C	EA-6492-E	EA-6492-CE	30A	NEMA L14-30P	(12) C13 + (6) C19 + (4) 5-20	5 kW	2U		
120/208 Volt, Three-Phase Input									
EA-6406-C	EA-6406-E	EA-6406-CE	20A	NEMA L21-20P	(24) C13	5.7 kW	2U		
EA-6414-C	EA-6414-E	EA-6414-CE	20A	NEMA L21-20P	(18) C13 + (6) C19	5.7 kW	2U		
EA-64A3-C	EA-64A3-E	EA-64A3-CE	20A	NEMA L21-20P	(6) C13 + (12) C19	5.7 kW	2U		
EA-6490-C	EA-6490-E	EA-6490-CE	20A	NEMA L21-20P	(12) C13 + (6) C19 + (4) 5-20	5.7 kW	2U		
EA-6407-C	EA-6407-E	EA-6407-CE	30A	NEMA L21-30P	(24) C13	8.6 kW	2U		
EA-6415-C	EA-6415-E	EA-6415-CE	30A	NEMA L21-30P	(18) C13 + (6) C19	8.6 kW	2U		
EA-64A5-C	EA-64A5-E	EA-64A5-CE	30A	NEMA L21-30P	(6) C13 + (12) C19	8.6 kW	2U		
EA-6491-C	EA-6491-E	EA-6491-CE	30A	NEMA L21-30P	(12) C13 + (6) C19 + (4) 5-20	8.6 kW	2U		
208 Volt, Three-Phase Input									
EA-6405-C	EA-6405-E	EA-6405-CE	30A	NEMA L15-30P	(24) C13	8.6 kW	2U		
EA-6413-C	EA-6413-E	EA-6413-CE	30A	NEMA L15-30P	(18) C13 + (6) C19	8.6 kW	2U		
EA-64A6-C	EA-64A6-E	EA-64A6-CE	30A	NEMA L15-30P	(6) C13 + (12) C19	8.6 kW	2U		
EA-64A7-C	EA-64A7-E	EA-64A7-CE	50A	CS8365	(6) C13 + (12) C19	14.4 kW	2U		
EA-64A8-C	EA-64A8-E	EA-64A8-CE	60A	IEC 60309 60A 3P+E	(6) C13 + (12) C19	17.2 kW	2U		
Switched Pro eConnect PDU, Horizontal - Worldwide									
Part Number			Input Amperage	Input Plug	Outlets	kW Capacity (UL)	kW Capacity North America (UL)	Form Factor (U) Height	
Black*	Glacier White*	Redundancy Pack**							
220 - 240 Volt, Single-Phase Input									
EA-6408-C	EA-6408-E	EA-6408-CE	16A	C20 Inlet to IEC 60309 16A 1P+N+E	(24) C13	3.8 kW	3.8 kW	2U	
EA-6419-C	EA-6419-E	EA-6419-CE	16A	C20 Inlet to IEC 60309 16A 1P+N+E	(18) C13 + (6) C19	3.8 kW	3.8 kW	2U	
EA-6409-C	EA-6409-E	EA-6409-CE	32A	IEC 60309 32A 1P+N+E	(24) C13	7.7 kW	6.1 kW	2U	
EA-6420-C	EA-6420-E	EA-6420-CE	32A	IEC 60309 32A 1P+N+E	(18) C13 + (6) C19	7.7 kW	6.1 kW	2U	
EA-64A2-C	EA-64A2-E	EA-64A2-CE	32A	IEC 60309 32A 1P+N+E	(6) C13 + (12) C19	7.7 kW	6.1 kW	2U	
220 - 240/380-415 Volt, Three-Phase Input									
EA-6410-C	EA-6410-E	EA-6410-CE	16/20A	IEC 60309 16/20A 3P+N+E	(24) C13	11.5 kW	11.5 kW	2U	
EA-6421-C	EA-6421-E	EA-6421-CE	16/20A	IEC 60309 16/20A 3P+N+E	(18) C13 + (6) C19	11.5 kW	11.5 kW	2U	
EA-64A4-C	EA-64A4-E	EA-64A4-CE	16/20A	IEC 60309 16/20A 3P+N+E	(6) C13 + (12) C19	11.5 kW	11.5 kW	2U	
EA-64A9-C	EA-64A9-E	EA-64A9-CE	32A	IEC 60309 32A 3P+N+E	(6) C13 + (12) C19	23 kW	18.4 kW	2U	

Notes:

*Shipping weight for each unit is 23 lb (10.4 kg)

**Redundancy Pack includes 2 PDUs in Black and Glacier White for easy identification of the primary and secondary unit; shipping weight is 45 lb (20.4 kg)

Uninterruptible Power Supply (UPS)

Ensure uptime and protect IT assets.

As an integral component of a data center or remote site power chain, the uninterruptible power supply (UPS) provides clean power when AC power is present and provides backup power in the event of a power outage.

Chatsworth Products (CPI), a pioneer of power and infrastructure solutions for the information and communications technology (ICT) and industrial automation segments, offers a full line of 350VA – 10kVA UPS solutions for your power needs, including long-lasting lithium ion battery-based and double-conversion online options yielding industry-leading performance.

Lithium Ion Battery

Ideal for remote sites thanks to longer battery life, faster recharge and more recharge cycles.

Lead Acid Battery

Provides a more cost-effective solution through shorter battery life and longer required charging times.



Lithium Ion Standby UPS 350VA–600VA

This compact design is excellent for use in wall-mount networking and computer equipment cabinets when providing protection to network switches, industrial computers, automation systems, programmable logic controllers (PLCs), video walls, kiosks, and point-of-sale (POS) equipment.

Maintain Uptime

CPI UPS solutions utilize several battery technologies to provide backup power if utility power is interrupted.

Manage Power

As you upgrade wireless networks and deploy more IoT sensors at the edge, you'll need to upgrade networks and add compute and storage closer to operations. CPI's UPS solutions are the proven way to manage power and maintain uptime for remote sites whether powering a single switch or a few racks of compute.

Monitor Remotely

CPI solutions will auto-restart when power is restored after an extended outage. However, it is always wise to remotely monitor power use and conditions of the UPS to ensure performance and reduce site visits.

Lithium Ion Standby UPS 350VA–600VA							
Part Number	Capacity VA	Capacity W	Input Plug*	Outlet Receptacles	Runtime 100% Load	Runtime 50% Load	External Battery Option
120 Volt							
LS350A	350	200	C14 Inlet to 5-15P	(3) 5-15R	6	14	No
LS600A	600	360	C14 Inlet to 5-15P	(3) 5-15R	6	14	No
200-240 Volt							
LS350B	350	200	C14 Inlet (no cord)	(2) C13	6	14	No
LS600B	600	360	C14 Inlet (no cord)	(2) C13	6	14	No

*On 120 Volt models, included line cord is 3' (0.9 m) long. On 200-240 Volt models, order a line cord separately. C13 to required plug.

Battery Runtimes:

System Load (W)	Estimated Runtimes On Internal Batteries (mins)									
	20	40	80	120	160	200	240	280	320	360
LS350x	72	35	17	11	9	7	N/A	N/A	N/A	N/A
LS600x	161	79	35	23	17	14	11	9	8	6

Note: Runtimes are shown in minutes and will vary based on battery condition, age, cycles and ambient temperature



Lead Acid Line-Interactive UPS 800VA-5000VA

Reliable and economical backup power protection for servers and network applications.

Lead Acid Line-Interactive UPS 800VA-5000VA								
Part Number	Capacity VA	Capacity W	Input Plug*	Outlet Receptacles	Runtime 100% Load	Runtime 50% Load	External Battery Option	Bypass Distribution Module Compatibility
120 Volt								
VL800A	800	720	5-15P	(8) 5-15R	4	11	No	BDM1A
VL1100A	1100	990	5-15P	(8) 5-15R	3	11	No	BDM1A
VL1500A	1500	1350	5-15P	(8) 5-15R	4	12	VXBP1	BDM1A
VL2000A	2000	1800	5-20P	(8) 5-20R	4	12	VXBP1	BDM1B
VL2200A	2200	2000	5-20P	(8) 5-20R	4	12	VXBP2	BDM1B
VL3000A	3000	2700	L5-30P	(8) 5-20R	4	12	VXBP2	BDM1D
VL3000A-1	3000	2700	L5-30P	(1) L5-30R + (6) 5-20R	4	12	VXBP2	BDM1D
200-240 Volt*								
VL3000B	3000	2700	C19 Inlet to L6-20P	(1) C19 + (8) C13	3	8	VXBP2	BDM1C
VL5000B	5000	4500	L6-30P	(1) L6-30R + (4) C19	2	5	VXBP3	No
VL5000B-1	5000	4500	L6-30P	(2) L6-30R + (2) L6-20R + (1) C19	3	8	VXBP3	No

**For 120 VAC models, Voltage input is 120 nominal, -32% to +27% range without use of battery. Voltage output is 120 VAC nominal with 100/115/127 VAC selectable output. Line cord is 6' (1.8 m) long.

*For 200-240V models, voltage input is 208/220/230/240 VAC nominal, 162-290 VAC range. Voltage output is 230 VAC nominal with 208/220/230/240 VAC selectable output. Line cord on VL3000B is 8' (2.4 m) long. Other line cords are 6' (1.8 m) long.

Battery Runtimes:

Battery Runtimes as a Percentage of Full Load														
UPS Part Number	Capacity (Watts)	Internal Batteries Only				With (1) Battery Pack				With (2) Battery Packs				Battery Part Number
		25%	50%	75%	100%	25%	50%	75%	100%	25%	50%	75%	100%	
VL800A	720	29	11	6	4	N/A	N/A	N/A	N/A	N/A	N/A	N/A	N/A	N/A
VL1100A	990	26	11	5	3	N/A	N/A	N/A	N/A	N/A	N/A	N/A	N/A	N/A
VL1500A	1350	31	12	6	4	124	53	31	22	216	102	61	42	VXBP1
VL2000A	1800	30	12	6	4	119	50	30	20	211	97	58	40	VXBP1
VL2200A	2000	32	12	6	4	125	54	32	22	219	104	62	43	VXBP2
VL3000A	2700	30	12	6	4	119	50	30	20	211	97	58	40	VXBP2
VL3000A-1	2700	30	12	6	4	119	50	30	20	211	97	58	40	VXBP2
VL3000B	2700	13	8	5	3	56	34	24	20	107	66	47	38	VXBP3
VL5000B	4500	10	5	3	2	38	24	18	14	71	45	33	27	VXBP3
VL5000B-1	4500	10	5	3	2	38	24	18	14	71	45	33	27	VXBP3

Battery runtimes shown in minutes and will vary based on battery condition, age, cycles and ambient temperature. Maximum of two external battery packs per UPS.



Lithium Ion Online UPS 1500VA–3000VA

Lithium Ion UPS provides more than twice the life, higher temperature tolerance, longer runtime, and faster recharge when compared to typical lead-acid battery solutions. Double-conversion online technology makes this UPS ideal for protection of network, server, edge, light industrial and distributed IT applications.

Lithium Ion Online UPS 1500VA–3000VA							
Part Number	Capacity VA	Capacity W	Input Plug*	Outlet Receptacles	Runtime 100% Load	Runtime 50% Load	Bypass Distribution Module Compatibility
120 Volt**							
LD1500A	1500	1350	5-15P	(8) 5-15R	8	19	BDM1A
LD2000A	2000	1800	5-20P	(8) 5-20R	14	30	BDM1B
LD3000A	3000	2700	L5-30P	(1) L5-30P + (6) 5-20R	11	23	BDM1D
LD1500A	1500	1350	5-15P	(8) 5-15R	8	19	BDM1A
LD2000A	2000	1800	5-20P	(8) 5-20R	14	30	BDM1B
LD3000A	3000	2700	L5-30P	(1) L5-30P + (6) 5-20R	11	23	BDM1D
200-240 Volt*							
LD1500B	1500	1350	C14 Inlet to L6-20P	(8) C13	8	19	BDM1C
LD2000B	2000	1800	C20 Inlet to L6-20P	(8) C13	14	30	BDM1C
LD3000B	3000	2700	C20 Inlet to L6-20P	(1) C19+ (8) C13	11	23	BDM1C

***Voltage input: 55-150 VAC (depending on load level)

**Voltage output: 100/110/115/120/127 VAC selectable. Derate capacity to 80% when output voltage is adjusted to 100 VAC.

**Line cord is 6' (1.8 m) long.

*Voltage input 110-330 VAC (depending on load level)

*Voltage output: 200/208/220/230/240 VAC selectable. Derate capacity to 80% when output voltage is adjusted to 200 or 208 VAC.

*VLine cord is 8' (2.4 m) long.

Battery Runtimes:

Battery Runtimes as a Percentage of Full Load										
UPS Part Number	Percentage Load									
	10%	20%	30%	40%	50%	60%	70%	80%	90%	100%
LD1500X	111	54	34	25	19	16	13	11	9	8
LD2000X	163	79	51	38	30	24	21	18	16	14
LD3000X	127	62	40	29	23	19	16	14	12	11

Runtimes are shown in minutes and will vary based on battery condition, age, cycles and ambient temperature.



Lead Acid Online UPS 1000VA–3000VA

Reliable and economical backup power protection for servers and network applications.

Lead Acid Online UPS 1000VA–3000VA								
Part Number	Capacity VA	Capacity W	Input Plug*	Outlet Receptacles	Runtime 100% Load	Runtime 50% Load	External Battery Option	Bypass Distribution Module Compatibility
120 Volt**								
VD1000A1U	1000	800	C14 Inlet to 5-15P	(3) 5-15R	8	20	No	BDM1A
VD1000A	1000	1000	5-15P	(8) 5-15R	3	6	No	BDM1A
VD1500A	1500	1450	5-15P	(8) 5-15R	3	10	VXBP4 or VXBP5	BDM1A
VD2000A	2000	1930	5-20P	(8) 5-20R	3	10	VXBP6	BDM1B
VD3000A	3000	2880	L5-30P	(1)L5-30R + (6) 5-20R	3	10	VXBP7	BDM1D
200-240 Volt*								
VD1000B1U	1000	800	C14 Inlet to L6-20P	(3) C13	8	20	No	BDM1C
VD1500B	1500	1450	C14 Inlet to L6-20P	(8) C13	3	10	VXBP4 or VXBP5	BDM1C
VD2000B	2000	1930	C20 Inlet to L6-20P	(8) C13	3	10	VXBP6	BDM1C
VD3000B	3000	2880	C20 Inlet to L6-20P	(1) C19 + (8) C13	3	10	VXBP7	BDM1C

**For 120 VAC models, Voltage input range is 55-150 VAC (depending on load level). Voltage output is 120 VAC nominal. 2U models support 100/110/115/127 VAC selectable output. Capacities are based on highest selectable voltage. Some models derate at lower voltages.

*For 200-240 VAC models, Voltage input is 208/220/230/240 VAC (depending on load level). Voltage output is 230 VAC nominal. 2U models support 200/208/220/230/240 VAC selectable output.

Capacity derates to 90% at 208 Volts.

Line cord on VD1000A1U is 5' (1.5 m) long, Line cord on other 120 VAC models are 6' (1.8 m) long.

Line cords on 200-240 VAC models are 8' (2.4 m) long.

Battery Runtimes:

Battery Runtimes as a Percentage of Full Load																		
UPS Part Number	Capacity (Watts)	Internal Batteries Only		(1) Battery Pack		(2) Battery Packs		(3) Battery Packs		(4) Battery Packs		(5) Battery Packs		(5) Battery Packs		(5) Battery Packs		Battery Part Number
		50%	100%	50%	100%	50%	100%	50%	100%	50%	100%	50%	100%	50%	100%			
VD1000A1U	800	20	8	N/A	N/A	N/A	N/A	N/A	N/A	N/A	N/A	N/A	N/A	N/A	N/A	N/A	N/A	N/A
VD1000A	1000	6	3	N/A	N/A	N/A	N/A	N/A	N/A	N/A	N/A	N/A	N/A	N/A	N/A	N/A	N/A	N/A
VD1500A	1450	10	3	42	17	84	33	120	51	157	72	199	93	244	112	289	128	VXBP4
VD1500A	1450	10	3	84	33	157	72	244	122	339	146	N/A	N/A	N/A	N/A	N/A	N/A	VXBP5
VD2000A	1930	10	3	42	17	84	33	121	51	157	72	200	93	244	112	289	128	VXBP6
VD3000A	2880	10	3	42	17	84	33	121	52	158	73	201	94	246	112	292	129	VXBP7
VD1000B1U	800	20	8	N/A	N/A	N/A	N/A	N/A	N/A	N/A	N/A	N/A	N/A	N/A	N/A	N/A	N/A	N/A
VD1500B	1450	10	3	42	17	84	33	120	51	157	72	199	93	244	112	289	128	VXBP4
VD1500B	1450	10	3	84	33	157	72	244	112	339	146	449	189	523	233	N/A	N/A	VXBP5
VD2000B	1930	10	3	42	17	84	33	121	51	157	72	200	93	244	112	290	128	VXBP6
VD3000B	2880	10	3	42	17	84	33	121	52	158	73	201	94	246	112	292	129	VXBP7

Runtimes are shown in minutes and will vary based on battery condition, age, cycles and ambient temperature. Maximum of seven battery packs with Models VD1500x, VD2000x and VD3000x. Note N/A indicates battery pack limit for various UPS and battery pack combinations.

Environmental Monitoring

Monitor the environment proactively.

Monitor temperature and humidity of supply air and exhaust air at the cabinet to ensure proper operating conditions for equipment. Adding or removing equipment — and even adjusting workloads — can change the operating conditions at each cabinet.

If you are using a Monitored, Monitored Pro, Switched or Switched Pro eConnect PDU, you can simply add up to two sensors to each PDU and monitor temperature and humidity with power.



Temperature and Humidity Sensors		
Part Number	Description	Shipping Weight lb (kg)
Sensors that Integrate with eConnect PDU		
14665-001	USB Temperature and Humidity Sensor for Monitored, Monitored Pro, Switched or Switched Pro eConnect PDUs	3 (1.4)
Standalone Environmental Monitoring Appliance and Sensors		
60100-001	RIM-750, with 4 Temperature/Humidity inputs, Standalone system with separate network connection.	2 (0.9)
60108-002	Temperature and Humidity Sensor for RIM-750, RJ11, 25'L (7.6 m) cord	1 (0.5)

Quick Tip

If you are using a Basic or Metered PDU, or want a separate appliance or network for monitoring environmental conditions, use the RIM-750 with required sensors to monitor temperature and humidity independent of power.





RFID Electronic Lock

Protect equipment electronically.

Electronic locks make it easy to manage authorized access to cabinets and keep an automated record of each access attempt, while featuring swinghandles with integrated dual-frequency card reader technology.

Power IQ® for eConnect

Optimize systems remotely.

Take your operations a step further with DCIM integration. Power IQ for eConnect allows data center managers to visualize trends of all activities in the room and cabinet in a single screen.

Temperature and Humidity Sensors		
Part Number	Description	Shipping Weight lb (kg)
RFID Electronic Locks that Integrate with eConnect PDUs		
14666-001	eConnect® RFID Electronic Lock Kit* for Monitored, Monitored Pro, Switched and Switched Pro eConnect PDUs	3 (1.4)
Standalone RFID Electronic Lock Systems		
14667-001	Networked RFID Electronic Lock Kit* Standalone system with separate network connection.	7 (3.2)
14668-001	Security System RFID Electronic Lock Kit (Wiegand)* Standalone system, integrates with BMS system	3 (1.4)

Note: Use with 125 kHz CSN and/or 13.56 MHz UID RFID cards. Does not support PACs smart cards. See complete list of cards in specifications for RFID Electronic Lock Kits.

Power IQ for eConnect Software and License, With 1-Year Maintenance Plan			
Part Number	Number of Licenses	Part Number	Number of Licenses
36603-001	Up to 10 Devices	36603-020	Up to 200 Devices
36603-002	Up to 20 Devices	36603-030	Up to 300 Devices
36603-005	Up to 50 Devices	36603-040	Up to 400 Devices
36603-010	Up to 100 Devices	36603-050	Up to 500 Devices



ZETAFrame

Support equipment with strength.

In a perfect world, all data center applications would be alike. But this interconnected reality demands a mix of enterprise-owned, cloud-based and edge services. The most efficient approach to simplifying hybrid operations is to rely on a single cabinet design that supports equipment, cable management, airflow management, intelligent power distribution, environmental monitoring, physical security and system optimization.

ZetaFrame™ Cabinet is a highly engineered data center cabinet solution that delivers faster built-to-order configurability, industry-leading strength and scalability, regardless of the application. ZetaFrame Cabinet is a total, turnkey solution that integrates with power, cable and thermal management accessories to support next-generation compute.



Speedy Deployment



Fast Selection and Customization



Integrated Bonding



Future-Proof Strength



Enhanced Cable Management



Integrated Airflow Management

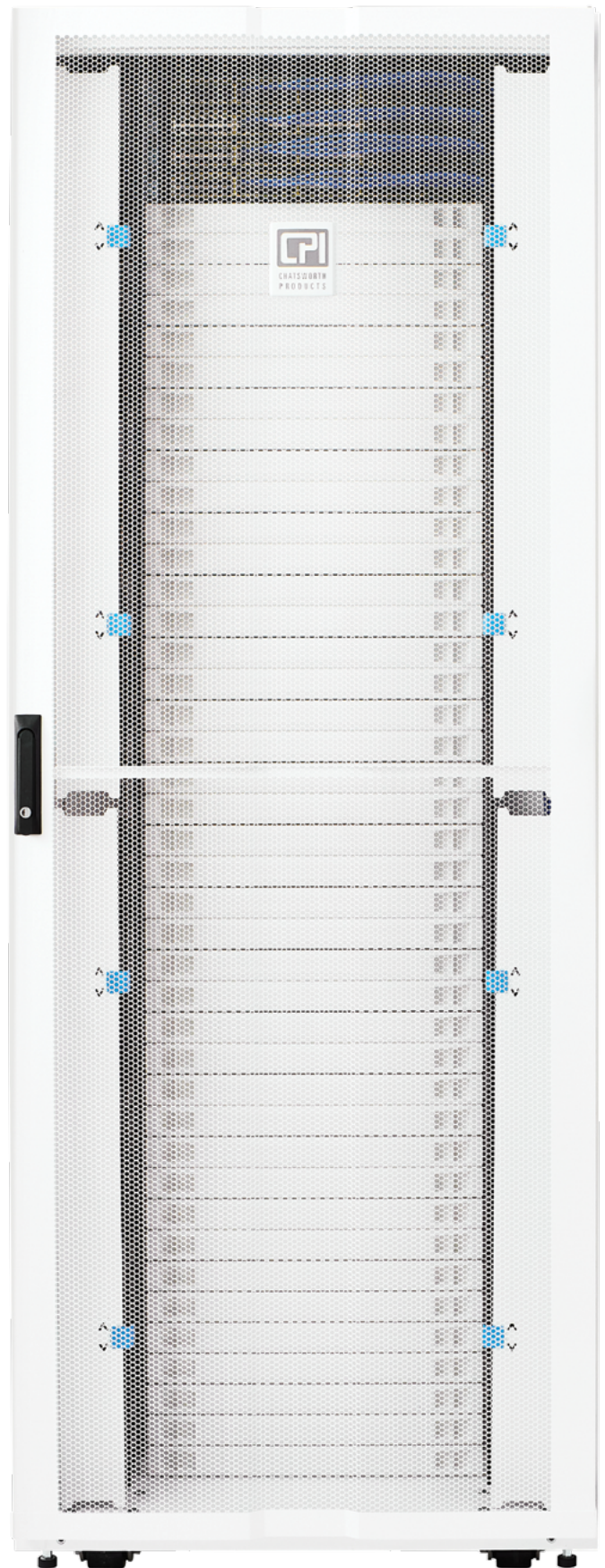

Unlimited Configurability & Speedy Deployment

Highly configurable design makes the ZetaFrame Cabinet the ideal solution for any application.

ZetaFrame delivers fast built-to-order configurability, industry-leading strength and scalability, including the following features and benefits:



Intuitive Cable Management

Simple and efficient cable management. Fast attachment and adjustment of accessories



Robust Construction for Heavy Loads

Roll-formed, tubular and fully welded steel frame



Integrated Bonding

Door hinge and side panel design with integrated bonding



Heavy-Duty Caster Design

Load-bearing casters and easily adjustable leveling feet



Equipment Mounting Rail Brush Kit

Optional brush seal allows quick cabling changes while maintaining disciplined airflow management in wider cabinets. Select Air Dam Kit with brush-sealed rails when ordering your cabinet.

Ships on Standard Pallet or Shock Pallet

Use the part number configurator below to select a standard ZetaFrame Cabinet.

Choose the Height, Width, Depth, Panels, Thermal Configuration and Color. Example part number: ZB45-A120A-E1

Z 1 2 3 - 4 5 6 7 8 - 9 10

1. Height			
U	in	mm	
42	79.4	2017	A
45	84.6	2149	B
48	89.9	2283	C
52	96.9	2461	D

Height includes casters.

2. Width		
in	mm	
23.6	600	1
27.6	700	2
29.5	750	3
31.5	800	4

3. Depth		
in	mm	
31.5	800	1
39.4	1000	2
41.3	1050	3
43.3	1100	4
47.2	1200	5

Frame depth does not include doors. Doors add approximately 3.1" (79 mm) to overall depth of the cabinet.

4. Doors	
None	0
Single Perforated Front/ Double Perforated Rear	A
No Front/ Double Perforated Rear	B

5. Top Panel	
0	None
1	Grommet-Sealed
2	Brush-Sealed

6. Side Panel	
0	None
1	1 Side
2	2 Sides

8. Thermal Management	
0	None
A	Air Dam
B	Air Dam, Brushed-Sealed Rail

Brush-Sealed Front Rails are not available for 23.6"W (600 mm) cabinets.

7. Bottom Panel	
0	None
1	Grommet-Sealed
2	Brush-Sealed

9. Color	
7	Black
E	Glacier White

10. Shipping	
1	Standard Pallet
2	Shock Pallet

Shock Pallet is available for 42U, 45U, 48U cabinet heights and 43.3"D (1100 mm) and 47.2"D (1200 mm) cabinet depths.

All cabinets ship with two pairs of square-punched equipment mounting rails. Rails for 27.6"W (700 mm) and wider cabinets include four grommet-sealed cable openings (per rail).



Vertical Exhaust Duct Configuration for Front-to-Top Airflow

Use the part number configurator below to create a standard ZetaFrame Cabinet with a Vertical Exhaust Duct. Choose the Height, Width, Depth, Panels, Thermal Configuration and Color. Example part number: ZB45-DB22B-71

Z 1 2 3 - 4 5 6 7 8 - 9 10

1. Height			
U	in	mm	
42	79.4	2017	A
45	84.6	2149	B
48	89.9	2283	C
52	96.9	2461	D

Height includes casters.

2. Width		
in	mm	
23.6	600	1
27.6	700	2
29.5	750	3
31.5	800	4

3. Depth		
in	mm	
41.3	1050	3
43.3	1100	4
47.2	1200	5

Frame depth does not include doors. Doors add approximately 3.1" (79 mm) to overall depth of the cabinet.

4. Doors	
Single Perforated Front/ Single Solid Rear	D
No Front/ Single Solid Rear	E

5. Top Panel	
A	15-20" H (381 - 508 mm) Vertical Exhaust Duct
B	20-34" H (508 - 863 mm) Vertical Exhaust Duct
C	34-60" H (863 - 1524 mm) Vertical Exhaust Duct
D	15-20" H (381 - 508 mm) Vertical Exhaust Duct, Air Director
E	20-34" H (508 - 863 mm) Vertical Exhaust Duct, Air Director
F	34-60" H (863 - 1524 mm) Vertical Exhaust Duct, Air Director

A half brush seal is included at the lower rear of the duct.

10. Shipping	
1	Standard Pallet

9. Color	
7	Black
E	Glacier White

8. Thermal Management	
A	Air Dam
B	Air Dam, Brushed-Sealed Rail

Brush-Sealed Front Rails are not available for 23.6"W (600 mm) cabinets.

7. Bottom Panel	
0	None
1	Grommet-Sealed
2	Brush-Sealed

6. Side Panel	
0	None
1	1 Side
2	2 Sides

All cabinets ship with two pairs of square-punched equipment mounting rails. Rails for 27.6"W (700 mm) and wider cabinets include four grommet-sealed cable openings (per rail).



Airflow Management for ZetaFrame Cabinet

Control airflow effectively.

ZetaFrame delivers fast built-to-order configurability, industry-leading strength and scalability, including the following features and benefits:

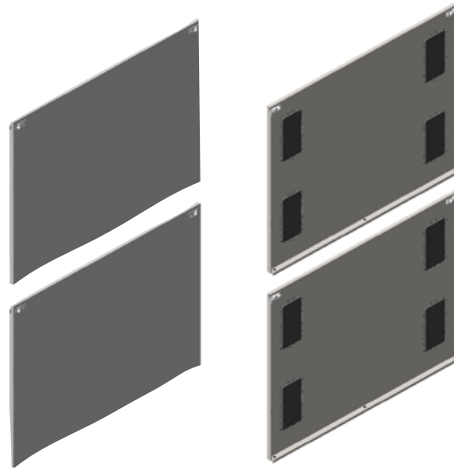

Air Dam Kit

Air Dam blocks airflow around the sides and top of the equipment mounting space, so conditioned air passes through equipment and exhaust air does not recirculate around equipment. Configure with cabinet or order separately.

Air Dam Kit					
Part Number - Cabinet Width				Height (U)	Shipping Weight lb (kg)
23.6" W (600 mm)	27.6" W (700 mm)	29.5" W (750 mm)	31.5" W (800 mm)		
38649-X44	38649-X55	38649-X77	38649-X66	42	11 (5.0)
38649-X47	38649-X58	38649-X80	38649-X69	45	11 (5.0)
38649-X50	38649-X61	38649-X83	38649-X72	48	11 (5.0)
38649-X54	38649-X65	38649-X87	38649-X76	52	12 (5.1)

Note: X=color: 7=Black, E=Glacier White. Shipping weights are for 800 mm configurations

Side Panels

Two-piece design with top and bottom halves for easier handling. Available in Solid or with Grommets. Configure with cabinet or order separately.

Side Panels							
Solid	Grommet	Part Number				Cabinet Frame Depth in (mm)	Shipping Weight lb (kg)
		Height (U)					
		42	45	48	52		
39763	39774	-X00	-X51	-XAC	-XDL	31.5 (800)	34 (15.5)
		-X08	-X59	-XAL	-XDW	39.4 (1000)	41 (18.6)
		-X10	-X61	-XAN	-XEA	41.3 (1050)	43 (19.1)
		-X12	-X63	-XAR	-XEC	43.3 (1100)	45 (20.2)
		-X16	-X67	-XAW	-XEG	47.2 (1200)	48 (21.7)

Note: X=color: 7=Black, E=Glacier White. Shipping weights are for 52U configurations

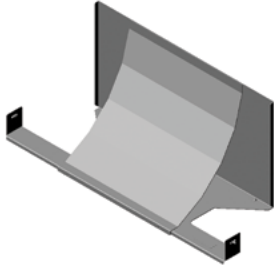

Air Director

Air Director is an angled panel used at the back of cabinets with Vertical Exhaust Duct top panels to guide exhaust air toward the top of the cabinet.

Air Director		
Part Number	Description	Shipping Weight lb (kg)
39802-X00	For 23.6"W (600 mm) Cabinets	12 (5.2)
39802-X01	For 27.6"W (700 mm) Cabinets	13 (5.9)
39802-X02	For 29.5"W (750 mm) Cabinets	14 (6.2)
39802-X03	For 31.5"W (800 mm) Cabinets	15 (6.5)

Note: X=color: 7=Black, E=Glacier White.



Snap-In Filler Panel

Snap-In Filler Panel blocks airflow in between equipment by sealing unused rack-mount spaces (U) in the cabinet. Use with Air Dam Kit and Bottom Panel to separate cold and hot air within the cabinet.

Snap-In Filler Panel		
Part Number	Description	Shipping Weight lb (kg)
34537-X00	1U x 19"W (482.6 mm), Single	14 (6.4)
34537-X01	1U x 19"W (482.6 mm), 6 Pack	14 (6.4)
34538-X00	2U x 19"W (482.6 mm), Single	21 (9.5)
34538-X01	2U x 19"W (482.6 mm), 6 Pack	21 (9.5)

Note: X=color: 0=Black, E=Glacier White.



Raised Floor Grommets

Raised Floor Grommets provide a reliable seal around cable bundles. Split design allows for retrofitting over existing cable bundles in access floor tiles.

Raised Floor Grommet		
Part Number	Description	Shipping Weight lb (kg)
13671-001	Floor Grommet, with Hardware, Single, Black	2 (1.4)
13671-002	Floor Grommet, with Hardware, 10 Pack, Black	18 (8.2)
13874-001	4" (102 mm) Round Raised Floor Grommet, with Hardware, Single, Black	1 (0.5)
13874-002	4" (102 mm) Round Raised Floor Grommet, with Hardware, 10 Pack, Black	6 (2.7)



Equipment Mounting Rail Grommet Kit

Set of (8) flexible plastic grommets that cover cable openings in the equipment mounting rails. Configure with cabinet or order separately.



Equipment Mounting Rail Brush Kit

Set of (8) brush covers that conceal cable openings in the equipment mounting rails. Configure with cabinet or order separately.

Equipment Mounting Rail/Grommet Kit		
Part Number	Description	Shipping Weight lb (kg)
39731-001	Grommet Kit, for 27.6"W (700 mm) and 29.5"W (750 mm) Cabinets; Pack of 8; Black	2 (0.9)
39731-002	Grommet Kit, for 31.5"W (800 mm) Cabinet; Pack of 8; Black	2 (0.9))
39716-001	Brush Kit, for 27.6"W (700 mm) and 29.5"W (750 mm) Cabinets; Pack of 8; Black	2 (0.9)
39716-002	Brush Kit, for 31.5"W (800 mm) Cabinet; Pack of 8; Black	3 (1.4)

Cable Management for ZetaFrame Cabinet

Organize cables with flexibility.

ZetaFrame Cabinet features innovative cable management accessories to provide optimal use of space within the cabinet.

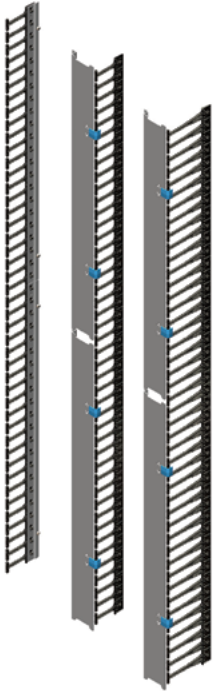

Vertical Cable Manager

Keep network cables separate and organized with long or short fingers while integrating CPI's Air Dam Kit and Cable Lashing Panel for a flexible solution.

Vertical Cable Manager					
Part Number - Cabinet Width				Height (U)	Shipping Weight lb (kg)
23.6" W (600 mm)	27.6" W (700 mm)	29.5" W (750 mm)	31.5" W (800 mm)		
Vertical Cable Manager with Long Fingers					
N/A	38647-X11	38647-X22	38647-X33	42	11 (5.0)
N/A	38647-X14	38647-X25	38647-X36	45	11 (5.0)
N/A	38647-X17	38647-X28	38647-X39	48	11 (5.0)
N/A	38647-X21	38647-X32	38647-X43	52	12 (5.1)
Vertical Cable Manager with Short Fingers					
39835-X00	38646-X11	38646-X22	38646-X33	42	9 (4.1)
39835-X03	38646-X14	38646-X25	38646-X36	45	10 (4.5)
39835-X06	38646-X17	38646-X28	38646-X39	48	10 (4.5)
39835-X10	38646-X21	38646-X32	38646-X43	52	10 (4.5)

Note: X=color: 7=Black, E=Glacier White. Shipping weights are for 800 mm configurations.

Inside Dimensions, Usable Internal Area, Rail Setback, U Opening					
Cabinet Width	Width in (mm)	Depth in (mm)	Cable Area in ² (mm ²)	Rail Setback in (mm)	U Opening in ² (mm ²)
Vertical Cable Manager with Long Fingers					
27.6 (700)	2.2 (56)	7.5 (191)	17.0 (10 967)	10.1 (257)	6.6 (460)
29.5 (750)	3.2 (81)	7.5 (191)	24.5 (15 806)	10.1 (257)	6.6 (460)
31.5 (800)	4.2 (107)	7.5 (191)	31.9 (20 580)	10.1 (257)	6.6 (460)
Vertical Cable Manager with Short Fingers					
23.6 (600)	0.4 (10)	5 (127)	1.8 (1161)	7.6 (193)	3.5 (2260)
27.6 (700)	2.2 (56)	5 (127)	11.2 (7225)	7.6 (193)	3.5 (2260)
29.5 (750)	3.2 (81)	5 (127)	16.2 (10 451)	7.6 (193)	3.5 (2260)
31.5 (800)	4.2 (107)	5 (127)	21.2 (13 677)	7.6 (193)	3.5 (2260)

Rail setback is the minimum distance required between the front edge of the cabinet frame and the front edge of the equipment mounting rail. U opening is the size of the side opening at each U space between T-shaped fingers.



Cable Lashing Panel

Creates simple, vertical pathways for small cable bundles. Patented Cable Bundle Swivels provide quick attachment, removal and adjustment of cable bundles.

Cable Lashing Panel				
Part Number			Height (U)	Shipping Weight lb (kg)
2-3/4 (70 mm)	4.5"W (115 mm)	7.0"W (178 mm)		
38634-X00	38635-X00	38636-X00	42	13 (5.9)
38634-X03	38635-X03	38636-X03	45	14 (6.4)
38634-X06	38635-X06	38636-X06	48	15 (6.8)
38634-X10	38635-X10	38636-X10	52	16 (7.3)
32657-001	Cable Bundle Swivel, Pack of 12			1 (0.5)

Note: X=Color: 7=Black, E=Glacier White. Shipping weights are for 7"W (178 mm) Lashing Panels.



Front-to-Rear Cable Manager

Attaches to the back of equipment mounting rails wherever there are cable openings, creating a cable pathway between front and rear rails.

Front-to-Rear Cable Manager					
Part Number - Cabinet Width				Rail Depth Range in (mm)	Shipping Weight lb (kg)
23.6"W (600 mm)	27.6"W (700 mm)	29.5"W (750 mm)	31.5"W (800 mm)		
N/A	38648-X01	38648-X02	38648-X03	20-32 (508 - 812)	11 (5.0)

Note: X=Color: 7=Black, E=Glacier White. Shipping weight is for 800 mm configuration



Full Height PDU Bracket

Accommodate a variety of PDU chassis widths with a full height PDU Bracket, available in Single or Dual options. Use Full Height PDU Bracket to ship or move the cabinet with PDUs installed.

Full Height PDU Bracket				
Part Number - PDU Chassis Width			Height (U)	PDU Bracket Capacity
2.2" (56 mm)	2.4-2.7" (51 - 69 mm)	4.0" (102 mm)		
38637-X00	38637-X11	38638-X00	42	Single
38637-X03	38637-X14	38638-X03	45	Single
38637-X06	38637-X17	38638-X06	48	Single
38637-X10	38637-X21	38638-X10	52	Single
38638-X00	38638-X11	N/A	42	Double
38638-X03	38638-X14	N/A	45	Double
38638-X06	38638-X17	N/A	48	Double
38638-X10	38638-X21	N/A	52	Double

Note: X=Color: 7=Black, E=Glacier White. Shipping weights are for Dual PDU Brackets

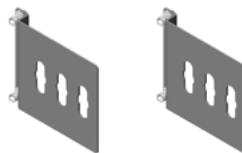

Standard PDU Bracket

Attach to the cabinet frame in either back corner with this easy-solution bracket, which includes one pair of brackets and installation hardware.

Standard PDU Bracket		
Part Number	Description	Shipping Weight lb (kg)
38645-700	2-Piece, Black	2 (0.9)

Note: One Standard PDU Bracket is included with each ZetaFrame Cabinet.



**CHATSWORTH
PRODUCTS**

United States & Canada

Simi Valley, CA
800-834-4969
Toronto, Ontario, Canada
+905-850-7770
[chatsworth.com](https://www.chatsworth.com)

Latin America

Mexico City, Mexico
+52-55-5203-7525
Toll Free within Mexico
01-800-201-7592
[chatsworth.com.co](https://www.chatsworth.com.co)

Europe

Buckinghamshire, England, UK
+44-1628-524-834
[chatsworth.com](https://www.chatsworth.com)

Middle East & Africa

Dubai, UAE
+971-4-2602125
Doha, Qatar
+974-4-4267422
[chatsworth.com](https://www.chatsworth.com)

Asia Pacific

Jing'an District, Shanghai, China
+86 21 6880-0266
[chatsworth.com.cn](https://www.chatsworth.com.cn)

Find more information
about CPI solutions at:
[chatsworth.com](https://www.chatsworth.com)

+1-800-834-4969 (U.S. & Canada)
or techsupport@chatsworth.com

[chatsworth.com](https://www.chatsworth.com)

Manufacturing Capability and Global Availability

Headquartered in the United States, CPI operates from multiple sites worldwide, including offices in Mexico, Canada, China, the Middle East and the United Kingdom. CPI's manufacturing facilities are located in the United States, Asia and Europe.

Standard products are readily available through a global network of industry-leading distributors. With stock availability, and CPI's consistently short factory lead times, you can be assured that CPI solutions will be accessible to meet your project scheduling needs.

How to Buy

CPI sales are conducted in partnership with a global network of distributors, contractors and resellers to ensure a high level of stock availability. Use CPI's Online Catalog to place an order with a distributor near you. Go to [chatsworth.com](https://www.chatsworth.com) to learn more.

About CPI

CPI, a 100% employee-owned company, was founded in June 1991, when 90 workers joined together and purchased the Dracon Division of Harris Corporation using an Employee Stock Ownership Plan (ESOP). Employee ownership is central to the success of CPI. Employee owners are committed to a philosophy of quality through teamwork, caring and commitment, which are extended to customers through our solutions and services.



All products quoted are subject to availability based on manufacturing capacity and shipping dates should be considered estimates only. While every effort has been made to ensure the accuracy of all information, CPI does not accept liability for any errors or omissions and reserves the right to change information and descriptions of listed services and products.

©2023 Chatsworth Products, Inc. All rights reserved. Chatsworth Products, Clik-Nut, CPI, CPI Passive Cooling, CUBE-IT, Secure Array, eConnect, Evolution, GlobalFrame, MegaFrame, QuadraRack, RMR, Saf-T-Grip, SeismicFrame, SlimFrame, TeraFrame, Motive and Velocity are federally registered trademarks of Chatsworth Products. EuroFrame, H-Plane, Hi-Bar, In-Plane, M-Frame, NetPoint, Simply Efficient, Skybar, Wi-Tile and ZetaFrame are trademarks of Chatsworth Products and Oberon, a division of Chatsworth Products. All other trademarks belong to their respective companies.
Published Rev.3 01/23 MKT-60020-750