

## Applique



## “Tailored” by *Matteo Thun*

When light blends together with an essential and innovative design, a unique sense of elegance arises with a strong emotional impact. Simple shapes and primitive geometries characterize the range “Tailored” by Matteo Thun, from the creative collaboration between Simes and the prestigious Italian architect and designer.

A perfect balance between sustainable and diverse material expressions: the range was developed using a combination of wood teak that conveys a warm effect and the minimalist lines of aluminium, new finishes specifically dedicated to improve the quality of the lighting performance. Natural elegance and lighting poetry that dress with charm the environments with an unmistakable style.



Surface wall mounted



Bollard

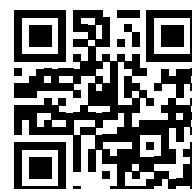





## "TAYLORED" BY MATTEO THUN Applique, bollard, surface wall mounted

Die-cast EN AB-47100 aluminium housing with high corrosion resistance.  
 Oiled TEAK wood finish 8mm thick.  
 Toughened glass diffuser.  
 Stainless steel screws.  
 Luminaire supplied with 1m of cable (Miniskill).  
 Luminaire with double cable entry and grommet (Skill).  
 Pre-wired luminaire with 1m of neoprene cable (Look and Cool Applique).  
 Pre-wired luminaire with neoprene cable and connector (Look and Cool Bollard).  
 Luminaire suitable for single grommet.  
 Silicone gaskets.  
**Double powder paint.**

### Protection class

IP65

### Isolation class

CLASS III ⚡ MINISKILL 24V c.c.

CLASS II 📏 LOOK and COOL

CLASS I ⚡ SKILL

### Mechanical resistance

IK 06 LOOK and COOL

IK 08 SKILL

🔧 08 LOOK and COOL

Leds 4000K CRI90 versions are available on request.

*This luminaire has been manufactured with hand crafted procedures, therefore small imperfections, subsidence of the wood surface, actual cracks and future, colour ripples and variations over time, are deliberately present and they are a feature of the wood, proving the hand-made manufacturing procedure.*

### PATENTED

### Colours:

- White + teak wood (code 01)
- Burnished bronze + teak wood (code 20)

*For the latest technical information and luminaire updates with LED technology please refer to [www.simes.it](http://www.simes.it)*

Miniskill vertical

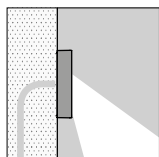

**L.9230W**

MID-POWER LEDs **3000K** CRI90 424lm  
 Rated luminaire luminous flux 187lm  
 Rated input power 4,7W **24V DC**

Requires a remote constant voltage driver  
 (page 468-469)

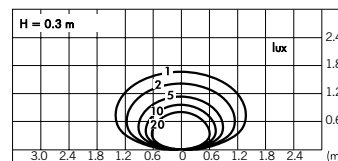
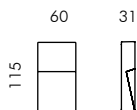

Skill square

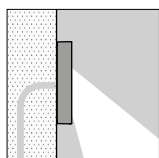
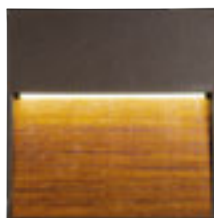

**L.9260W**

MID-POWER LEDs **3000K** CRI90 1016lm  
 Rated luminaire luminous flux 360lm  
 Rated input power 9,7W  
 220V-240V AC 50/60Hz / DC Not Dimmable

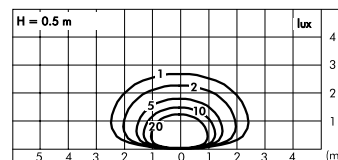
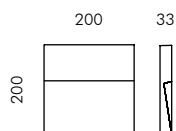

Skill rectangular

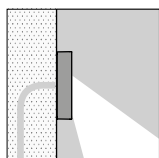

**L.9240W**

MID-POWER LEDs **3000K** CRI90 1270lm  
 Rated luminaire luminous flux 422lm  
 Rated input power 13W  
 220V-240V AC 50/60Hz / DC Not Dimmable

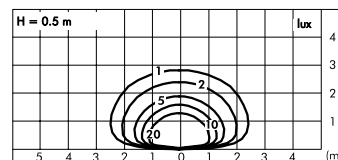
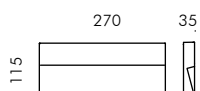

# LOOK WOOD

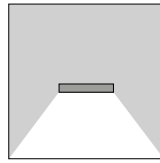

**L.9201W** □ **single emission**  
 MID-POWER LEDs **3000K** CRI90 1090lm  
 Rated luminaire luminous flux 475lm  
 Rated input power 12,5W  
 220V-230V AC 50/60Hz / DC Not Dimmable

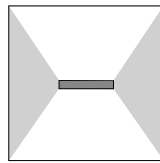
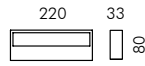
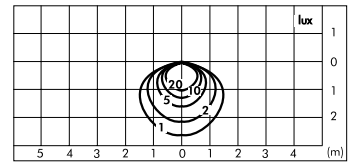

**L.9202W** □ **double emission**  
 MID-POWER LEDs **3000K** CRI90 1090lm  
 Rated luminaire luminous flux 389lm  
 Rated input power 12,5W  
 220V-230V AC 50/60Hz / DC Not Dimmable

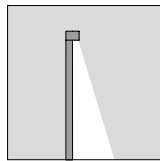
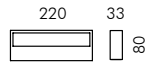
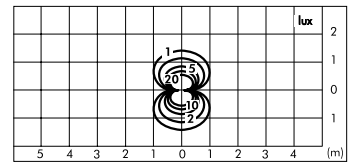

**L.9211W** □ **Minilook bollard H 580 mm**  
 MID-POWER LEDs **3000K** CRI90 970lm  
 Rated luminaire luminous flux 334lm  
 Rated input power 12,5W  
 220V-230V AC 50/60Hz / DC Not Dimmable

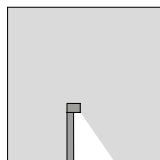
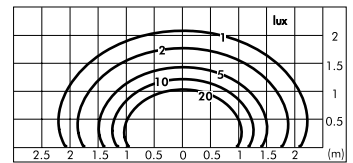

**L.9206W** □ **Minilook bollard H 220 mm**  
 MID-POWER LEDs **3000K** CRI90 970lm  
 Rated luminaire luminous flux 334lm  
 Rated input power 12,5W  
 220V-230V AC 50/60Hz / DC Not Dimmable

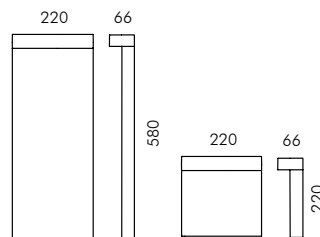
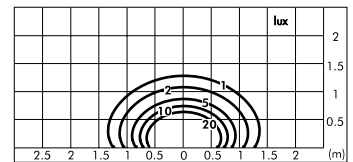

**S.7249**  
**FLANGE FOR MINILOOK BOLLARD**  
 To be buried in concrete for L.9206W e L.9211W.



**S.5506**  
 4 way connector for through wiring (in/out).

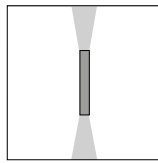

**L.9231W** □ **Applique**  
 MID-POWER LEDs **3000K** CRI90 1090lm  
 Rated luminaire luminous flux 488lm  
 Rated input power 12,5W  
 220V-230V AC 50/60Hz / DC Not Dimmable

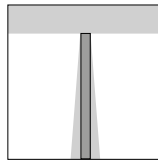
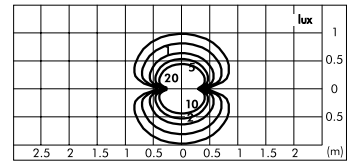
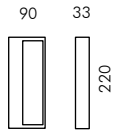

**L.9241W** □ **Bollard H 580mm**  
 MID-POWER LEDs **3000K** CRI90 1090lm  
 Rated luminaire luminous flux 488lm  
 Rated input power 12,5W  
 220V-230V AC 50/60Hz / DC Not Dimmable

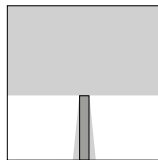

**L.9236W** □ **Bollard H 220mm**  
 MID-POWER LEDs **3000K** CRI90 1090lm  
 Rated luminaire luminous flux 488lm  
 Rated input power 12,5W  
 220V-230V AC 50/60Hz / DC Not Dimmable

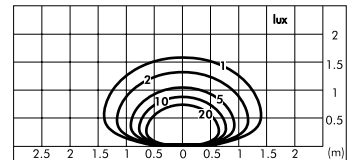
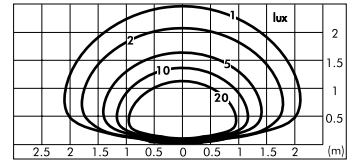
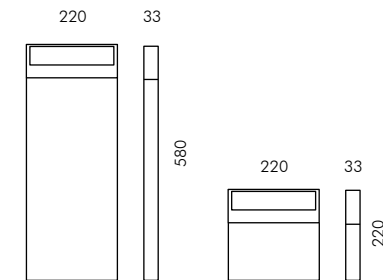

**S.7249**  
**FLANGE FOR MINICOOL BOLLARD**  
 To be buried in concrete for  
 L.9236W e L.9241W.



**S.5506**  
 4 way connector for through  
 wiring (in/out).