

SISTEMA DE PRENSAR EN ACERO INOXIDABLE PARA VAPOR SATURADO



inoxPRES
STEAM

1.0 Descripción

El sistema de presar **inoxPRES STEAM** está testado y certificado para dar respuesta a las exigencias de las instalaciones de vapor saturado, ofrece al instalador múltiples ventajas entre ellas, rapidez, seguridad y garantía. Los usos principales del vapor en la industria suele ser:

- Limpieza y esterilización
- Calefacción
- Ebullición, evaporación, pasteurización.
- Lavado y desengrasado.
- Humidificación.



Fig. 27 - Accesorio INOXPRES STEAM

Los accesorios de presar son de acero inoxidable se fabrican en calidad AISI-316L (1.4404). La tubería puede suministrarse en AISI-316L (1.4404) o bien en acero inoxidable AISI-304 (1.4301) de la serie 2.

Los accesorios vienen con una junta tórica de color blanco insertada de origen que denominamos RM STEAM, estas juntas han sido testada en condiciones extremas de funcionamiento para garantizar la seguridad de la unión.

En el sistema de acero inoxidable **inoxPRES STEAM**:

- La unión se realiza por deformación mecánica del accesorio y el tubo mediante una herramienta electrohidráulica.
- La unión resultante es irreversible y permanente.
- El sistema está certificado a una presión de 7 bar a temperatura de 165 °C.

2.0 Campos de aplicación

TABLA 14: CAMPO DE APLICACIÓN DEL SISTEMA INOXPRES STEAM

| Aplicación | Tubería | Junta | Nota | P (bar) | T (°C) |
|----------------|----------------------|-------------------|--------------|---------|--------|
| Vapor saturado | AISI-316L / AISI-304 | RM STEAM (blanca) | Tubo serie 2 | 7 | 165 |

La información arriba indicada, es orientativa / informativa, el técnico proyectista se responsabiliza del diseño y el análisis de riesgos de acuerdo con la Directiva 97/23/CE PED de aparatos a presión cuando aplique.

Aplicación principal en el ámbito industrial:

- Producción de celulosa y papel.
- Industria: cosmética, alimentaria, química o petroquímica.
- Lavanderías y planchado.
- Refino de azúcar
- Líneas de embotellado.

3.0 Máquinas y mordazas para vapor

El sistema **inoxPRES STEAM** se rige por unas medidas de control y calidad, que garantiza la seguridad de sus uniones. Para ello ha sido testado y evaluado con máquinas de presar que garantizan un correcto funcionamiento. Las máquinas recomendadas para esta aplicación quedan recogidas en la tabla 18 de la página 88.

El conjunto tubería, accesorio y máquina, son imprescindibles en la certificación del sistema **inoxPRES STEAM**.

Para garantizar un correcto prensado, debemos utilizar mordazas que estén en perfecto estado de revisión. Las mordazas **inoxPRES STEAM** están controladas con un sello de revisión obligatoria por el SAT, este sistema evita errores y da mayor confianza en la unión.

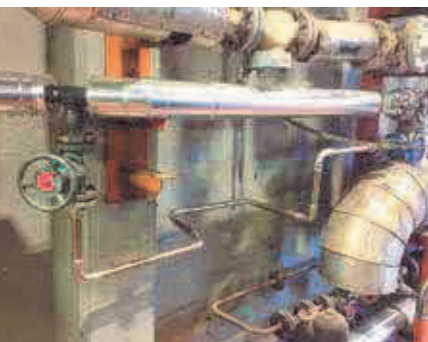





Fig. 28 - Instalación vapor saturado en la industria alimentaria

ACCESORIOS DE PRESIÓN VAPOR ACERO INOXIDABLE

AISI-316L / 1.4404

| Norma EN 10312 | Código | | D mm | Espesor | L. tubo (m) | Peso (Kg/m) | Paquete de tubo (m) | Tubería con soldadura |
|---------------------------|-----------|-----------|------|---------|-------------|-------------|---------------------|---|
| | 304 | 316L | | | | | | |
| Mat.-Nr. | 102015X1 | 104015X1 | 15 | 1,0 | 6 | 0,351 | 678 |  |
| 1.4404 (AISI 316L) | 102018X1 | 104018X1 | 18 | 1,0 | 6 | 0,425 | 678 | |
| 1.4301 (AISI 304) | 102022X12 | 104022X12 | 22 | 1,2 | 6 | 0,625 | 678 | |
| | 102028X12 | 104028X12 | 28 | 1,2 | 6 | 0,805 | 678 | |
| Serie 2 (DVGW) | 102035X15 | 104035X15 | 35 | 1,5 | 6 | 1,258 | 546 | |
| | 102042X15 | 104042X15 | 42 | 1,5 | 6 | 1,521 | 366 | |
| | 102054X15 | 104054X15 | 54 | 1,5 | 6 | 1,972 | 366 | |
| | 102076X20 | 104076X20 | 76 | 2,0 | 6 | 3,711 | 144 | |
| | 102088X20 | 104088X20 | 88 | 2,0 | 6 | 4,352 | 114 | |
| | 102108X20 | 104108X20 | 108 | 2,0 | 6 | 5,310 | 114 | |

| Código | D mm | Radio | L mm | Z mm | Uds. | Curva 90° HH |
|------------|------|-------|------|------|------|--|
| | | | | | | |
| 26C90HH015 | 15 | 1,2·D | 38 | 20 | 1 |  |
| 26C90HH018 | 18 | 1,2·D | 41,5 | 20 | 1 | |
| 26C90HH022 | 22 | 1,2·D | 47 | 21 | 1 | |
| 26C90HH028 | 28 | 1,2·D | 56 | 23 | 1 | |
| 26C90HH035 | 35 | 1,2·D | 68 | 26 | 1 | |
| 26C90HH042 | 42 | 1,2·D | 80 | 30 | 1 | |
| 26C90HH054 | 54 | 1,2·D | 100 | 35 | 1 | |
| 26C90HH076 | 76 | 1,2·D | 160 | 55 | 1 | |
| 26C90HH088 | 88 | 1,2·D | 182 | 60 | 1 | |
| 26C90HH108 | 108 | 1,2·D | 220 | 75 | 1 | |

| Código | D mm | Radio | L mm | Z mm | H mm | Uds. | Curva 90° HM |
|------------|------|-------|------|------|------|------|---|
| | | | | | | | |
| 26C90HM015 | 15 | 1,2·D | 38 | 20 | 48 | 1 |  |
| 26C90HM018 | 18 | 1,2·D | 41,5 | 20 | 48,5 | 1 | |
| 26C90HM022 | 22 | 1,2·D | 47 | 21 | 57 | 1 | |
| 26C90HM028 | 28 | 1,2·D | 56 | 23 | 64 | 1 | |
| 26C90HM035 | 35 | 1,2·D | 68 | 26 | 82 | 1 | |
| 26C90HM042 | 42 | 1,2·D | 80 | 30 | 101 | 1 | |
| 26C90HM054 | 54 | 1,2·D | 100 | 35 | 120 | 1 | |
| 26C90HM076 | 76 | 1,2·D | 160 | 55 | 180 | 1 | |
| 26C90HM088 | 88 | 1,2·D | 182 | 60 | 197 | 1 | |
| 26C90HM108 | 108 | 1,2·D | 220 | 75 | 236 | 1 | |

| Código | D mm | Radio | L mm | Z mm | Uds. | Curva 45° HH |
|------------|------|-------|------|------|------|---|
| | | | | | | |
| 26C45HH015 | 15 | 1,2·D | 27,5 | 20 | 1 |  |
| 26C45HH018 | 18 | 1,2·D | 29,5 | 20 | 1 | |
| 26C45HH022 | 22 | 1,2·D | 32 | 21 | 1 | |
| 26C45HH028 | 28 | 1,2·D | 37 | 23 | 1 | |
| 26C45HH035 | 35 | 1,2·D | 43 | 26 | 1 | |
| 26C45HH042 | 42 | 1,2·D | 50 | 30 | 1 | |
| 26C45HH054 | 54 | 1,2·D | 62 | 35 | 1 | |
| 26C45HH076 | 76 | 1,2·D | 133 | 55 | 1 | |
| 26C45HH088 | 88 | 1,2·D | 144 | 60 | 1 | |
| 26C45HH108 | 108 | 1,2·D | 169 | 75 | 1 | |

Curva 45° HM



| Código | D mm | Radio | L mm | Z mm | H mm | Uds. |
|------------|------|-------|------|------|------|------|
| 26C45HM015 | 15 | 1,2-D | 27,5 | 20 | 36 | 1 |
| 26C45HM018 | 18 | 1,2-D | 29,5 | 20 | 38 | 1 |
| 26C45HM022 | 22 | 1,2-D | 32 | 21 | 42 | 1 |
| 26C45HM028 | 28 | 1,2-D | 37 | 23 | 46 | 1 |
| 26C45HM035 | 35 | 1,2-D | 43 | 26 | 57 | 1 |
| 26C45HM042 | 42 | 1,2-D | 50 | 30 | 71 | 1 |
| 26C45HM054 | 54 | 1,2-D | 62 | 35 | 82 | 1 |
| 26C45HM076 | 76 | 1,2-D | 133 | 55 | 143 | 1 |
| 26C45HM088 | 88 | 1,2-D | 144 | 60 | 160 | 1 |
| 26C45HM108 | 108 | 1,2-D | 169 | 75 | 186 | 1 |

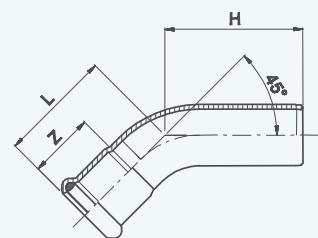

Manguito HH



| Código | D mm | L mm | Z mm | Uds. |
|--------|------|------|------|------|
| 26M015 | 15 | 49 | 20 | 1 |
| 26M018 | 18 | 50 | 20 | 1 |
| 26M022 | 22 | 53 | 21 | 1 |
| 26M028 | 28 | 56 | 23 | 1 |
| 26M035 | 35 | 63 | 26 | 1 |
| 26M042 | 42 | 72 | 30 | 1 |
| 26M054 | 54 | 83 | 35 | 1 |
| 26M076 | 76 | 142 | 55 | 1 |
| 26M088 | 88 | 166 | 60 | 1 |
| 26M108 | 108 | 203 | 75 | 1 |

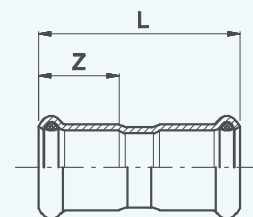

Te igual HHH



| Código | D mm | L1 mm | L2 mm | Z mm | Uds. |
|--------|------|-------|-------|------|------|
| 26T015 | 15 | 34 | 39 | 20 | 1 |
| 26T018 | 18 | 37 | 41 | 20 | 1 |
| 26T022 | 22 | 39 | 45 | 21 | 1 |
| 26T028 | 28 | 44 | 50 | 23 | 1 |
| 26T035 | 35 | 51 | 57 | 26 | 1 |
| 26T042 | 42 | 59 | 65 | 30 | 1 |
| 26T054 | 54 | 70 | 77 | 35 | 1 |
| 26T076 | 76 | 108 | 118 | 55 | 1 |
| 26T088 | 88 | 132 | 131 | 60 | 1 |
| 26T108 | 108 | 155 | 159 | 75 | 1 |

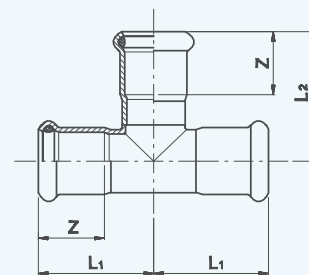

Te hembra roscada



| Código | D mm | L1 mm | L2 mm | Z1 mm | Z2 mm | Uds. |
|------------|------------|-------|-------|-------|-------|------|
| 26TH015015 | 15-1/2"-15 | 34 | 40 | 20 | 15 | 1 |
| 26TH018015 | 18-1/2"-18 | 37 | 42 | 20 | 15 | 1 |
| 26TH018020 | 18-3/4"-18 | 37 | 45 | 20 | 17 | 1 |
| 26TH022015 | 22-1/2"-22 | 39 | 44 | 21 | 15 | 1 |
| 26TH022020 | 22-3/4"-22 | 39 | 47 | 21 | 17 | 1 |
| 26TH028015 | 28-1/2"-28 | 44 | 47 | 23 | 15 | 1 |
| 26TH028020 | 28-3/4"-28 | 44 | 50 | 23 | 17 | 1 |
| 26TH028025 | 28-1"-28 | 44 | 53 | 23 | 19 | 1 |
| 26TH035025 | 35-1"-35 | 51 | 47 | 26 | 19 | 1 |
| 26TH042025 | 42-1"-42 | 59 | 60 | 30 | 19 | 1 |
| 26TH054050 | 54-2"-54 | 70 | 81 | 35 | 26 | 1 |
| 26TH076050 | 76-2"-76 | 108 | 93 | 55 | 26 | 1 |
| 26TH088050 | 88-2"-88 | 132 | 100 | 60 | 26 | 1 |
| 26TH108050 | 108-2"-108 | 155 | 110 | 75 | 26 | 1 |

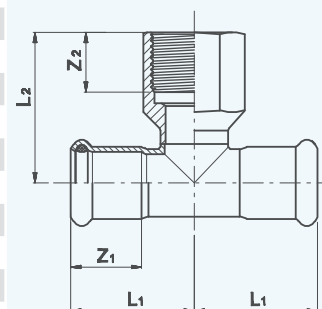

ACCESORIOS DE PRESIÓN VAPOR ACERO INOXIDABLE

AISI-316L / 1.4404

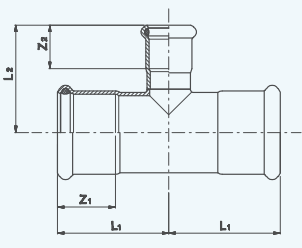
| | Código | D mm | L1 mm | L2 mm | Z1 mm | Z2 mm | Uds. | Te reducida HHH | |
|---|-------------------|-----------------|-------|-------|-------|-------|------|-----------------|--|
| | | | | | | | | | |
|  | 26TR018015 | 18-15-18 | 37 | 41 | 20 | 20 | 1 | | |
| | 26TR022015 | 22-15-22 | 39 | 43 | 21 | 20 | 1 | | |
| | 26TR022018 | 22-18-22 | 39 | 44 | 21 | 20 | 1 | | |
| | 26TR028015 | 28-15-28 | 44 | 46 | 23 | 20 | 1 | | |
| | 26TR028018 | 28-18-28 | 44 | 46 | 23 | 20 | 1 | | |
| | 26TR028022 | 28-22-28 | 44 | 47 | 23 | 21 | 1 | | |
| | 26TR035022 | 35-22-35 | 51 | 51 | 26 | 21 | 1 | | |
| | 26TR035028 | 35-28-35 | 51 | 54 | 26 | 23 | 1 | | |
| | 26TR042028 | 42-28-42 | 59 | 57 | 30 | 23 | 1 | | |
| | 26TR042035 | 42-35-42 | 59 | 61 | 30 | 26 | 1 | | |
| | 26TR054028 | 54-28-54 | 70 | 65 | 35 | 23 | 1 | | |
| | 26TR054035 | 54-35-54 | 70 | 68 | 35 | 26 | 1 | | |
| | 26TR054042 | 54-42-54 | 70 | 72 | 35 | 30 | 1 | | |
| | 26TR076028 | 76-28-76 | 108 | 77 | 55 | 23 | 1 | | |
| | 26TR076035 | 76-35-76 | 108 | 80 | 55 | 26 | 1 | | |
| | 26TR076042 | 76-42-76 | 108 | 84 | 55 | 30 | 1 | | |
| | 26TR076054 | 76-54-76 | 108 | 90 | 55 | 35 | 1 | | |
| | 26TR088042 | 88-42-88 | 132 | 91 | 60 | 30 | 1 | | |
| 26TR088054 | 88-54-88 | 132 | 97 | 60 | 35 | 1 | | | |
| 26TR088076 | 88-76-88 | 132 | 125 | 60 | 55 | 1 | | | |
| 26TR108054 | 108-54-108 | 155 | 107 | 75 | 35 | 1 | | | |
| 26TR108076 | 108-76-108 | 155 | 135 | 75 | 55 | 1 | | | |
| 26TR108088 | 108-88-108 | 155 | 141 | 75 | 60 | 1 | | | |

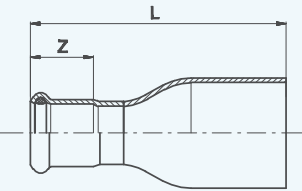

| | Código | D mm | L mm | Z mm | Uds. | Reducción MH | |
|---|---------------|--------------|------|------|------|--------------|--|
| | | | | | | | |
|  | 26RE018015 | 18-15 | 57 | 20 | 1 | | |
| | 26RE022018 | 22-18 | 60 | 20 | 1 | | |
| | 26RE028015 | 28-15 | 77 | 20 | 1 | | |
| | 26RE028022 | 28-22 | 65 | 21 | 1 | | |
| | 26RE035022 | 35-22 | 70 | 21 | 1 | | |
| | 26RE035028 | 35-28 | 71 | 23 | 1 | | |
| | 26RE042028 | 42-28 | 93 | 23 | 1 | | |
| | 26RE042035 | 42-35 | 81 | 26 | 1 | | |
| | 26RE054028 | 54-28 | 109 | 23 | 1 | | |
| | 26RE054042 | 54-42 | 98 | 30 | 1 | | |
| | 26RE076054 | 76-54 | 147 | 35 | 1 | | |
| | 26RE088076 | 88-76 | 184 | 55 | 1 | | |
| 26RE108088 | 108-88 | 207 | 60 | 1 | | | |

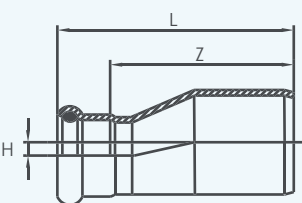

| | Código | D mm | L mm | Z mm | H mm | Uds. | Reducción excéntrica MH | |
|---|-------------|--------------|-------|-------|------|------|-------------------------|--|
| | | | | | | | | |
|  | 26REX042028 | 42-28 | 101,5 | 78,5 | 6 | 1 | | |
| | 26REX054028 | 54-28 | 123,5 | 100,5 | 12 | 1 | | |
| | 26REX054035 | 54-35 | 127 | 101,5 | 8,5 | 1 | | |
| | | | | | | | | |
| | | | | | | | | |
| | | | | | | | | |
| | | | | | | | | |



Drenaje de condensados



| Código | D mm | L mm | Z mm | H mm | L1 mm | Uds. |
|------------|-------|------|------|------|-------|------|
| 26DC054018 | 54-18 | 69,5 | 49,5 | 35 | 135 | 1 |
| | | | | | | |
| | | | | | | |
| | | | | | | |
| | | | | | | |
| | | | | | | |
| | | | | | | |

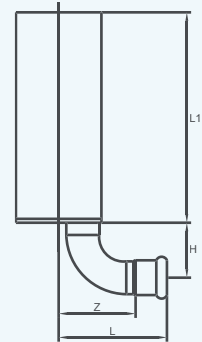

Tapón



| Código | D mm | L mm | Z mm | Uds. |
|---------|------|------|------|------|
| 26TA015 | 15 | 44 | 20 | 1 |
| 26TA018 | 18 | 44 | 20 | 1 |
| 26TA022 | 22 | 45 | 21 | 1 |
| 26TA028 | 28 | 48 | 23 | 1 |
| 26TA035 | 35 | 52 | 26 | 1 |
| 26TA042 | 42 | 56 | 30 | 1 |
| 26TA054 | 54 | 62 | 35 | 1 |
| 26TA076 | 76 | 93 | 55 | 1 |
| 26TA088 | 88 | 99 | 60 | 1 |
| 26TA108 | 108 | 117 | 75 | 1 |
| | | | | |
| | | | | |

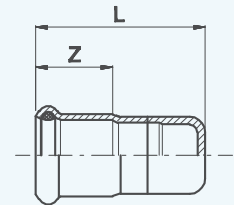

Unión macho



| Código | D mm | L mm | Z mm | Ø mm | Uds. |
|------------|-----------|------|------|------|------|
| 26UM015015 | 15-1/2" | 41 | 20 | 24 | 1 |
| 26UM018015 | 18-1/2" | 41 | 20 | 27 | 1 |
| 26UM022015 | 22-1/2" | 42 | 21 | 32 | 1 |
| 26UM022020 | 22-3/4" | 44 | 21 | 32 | 1 |
| 26UM022025 | 22-1" | 46 | 21 | 36 | 1 |
| 26UM028020 | 28-3/4" | 47 | 23 | 38 | 1 |
| 26UM028025 | 28-1" | 48 | 23 | 38 | 1 |
| 26UM035032 | 35-1.1/4" | 55 | 26 | 45 | 1 |
| 26UM042040 | 42-1.1/2" | 59 | 30 | 54 | 1 |
| 26UM054050 | 54-2" | 71 | 35 | 65 | 1 |
| 26UM076065 | 76-2.1/2" | 124 | 55 | 80 | 1 |
| 26UM088080 | 88-3" | 138 | 60 | 95 | 1 |
| 26UM108100 | 108-4" | 163 | 75 | 115 | 1 |
| | | | | | |

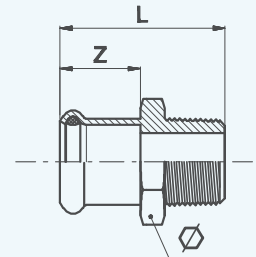

Unión hembra



| Código | D mm | L mm | Z mm | Ø mm | Uds. |
|------------|-----------|------|------|------|------|
| 26UH015015 | 15-1/2" | 38 | 20 | 27 | 1 |
| 26UH018015 | 18-1/2" | 38 | 20 | 27 | 1 |
| 26UH018020 | 18-3/4" | 39 | 20 | 32 | 1 |
| 26UH022020 | 22-3/4" | 40 | 21 | 32 | 1 |
| 26UH028020 | 28-3/4" | 42 | 23 | 38 | 1 |
| 26UH028025 | 28-1" | 45 | 23 | 41 | 1 |
| 26UH035032 | 35-1.1/4" | 52 | 26 | 46 | 1 |
| 26UH035040 | 35-1.1/2" | 52 | 26 | 55 | 1 |
| 26UH042040 | 42-1.1/2" | 56 | 30 | 54 | 1 |
| 26UH054050 | 54-2" | 65 | 35 | 65 | 1 |
| | | | | | |
| | | | | | |

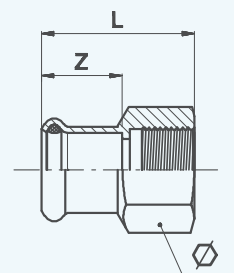

ACCESORIOS DE PRESIÓN VAPOR ACERO INOXIDABLE

AISI-316L / 1.4404

Brida adaptador PN 16

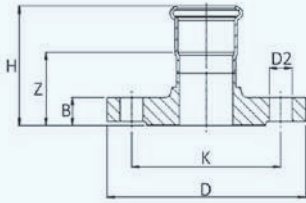

| Código | Ø mm | DN mm | Z mm | H mm | B mm | D mm | D2 mm | Nº Tal. mm | K mm | Uds. |
|---------|------|-------|------|------|------|------|-------|------------|------|------|
| 26BA015 | 15 | 15 | 35 | 55 | 14 | 95 | 14 | 4 | 65 | 1 |
| 26BA018 | 18 | 15 | 35,5 | 55,5 | 14 | 95 | 14 | 4 | 65 | 1 |
| 26BA022 | 22 | 20 | 37,5 | 58,5 | 16 | 105 | 14 | 4 | 75 | 1 |
| 26BA028 | 28 | 25 | 38,5 | 61,5 | 16 | 115 | 14 | 4 | 85 | 1 |
| 26BA035 | 35 | 32 | 39,5 | 65,5 | 16 | 140 | 18 | 4 | 100 | 1 |
| 26BA042 | 42 | 40 | 39 | 69 | 16 | 150 | 18 | 4 | 110 | 1 |
| 26BA054 | 54 | 50 | 42 | 78 | 18 | 165 | 18 | 4 | 125 | 1 |
| 26BA076 | 76 | 65 | 50 | 105 | 18 | 185 | 18 | 4 | 145 | 1 |
| 26BA088 | 88 | 80 | 56 | 116 | 20 | 200 | 18 | 8 | 160 | 1 |
| 26BA108 | 108 | 100 | 57 | 132 | 20 | 220 | 18 | 8 | 180 | 1 |



Racor 2 piezas

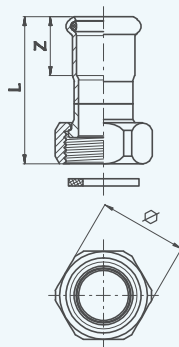

| Código | D mm | L mm | Z mm | Ø mm | Uds. |
|-------------|-----------|------|------|------|------|
| 26R2P015015 | 15-1/2" | 52 | 20 | 27 | 1 |
| 26R2P018015 | 18-1/2" | 54 | 20 | 27 | 1 |
| 26R2P022020 | 22-3/4" | 48 | 21 | 30 | 1 |
| 26R2P028025 | 28-1" | 51,5 | 23 | 36 | 1 |
| 26R2P035032 | 35-1.1/4" | 57,5 | 26 | 46 | 1 |
| 26R2P042040 | 42-1.1/2" | 63,5 | 30 | 52 | 1 |
| 26R2P054050 | 54-2" | 72 | 35 | 64 | 1 |



PTFE

Racor 3 piezas rosca macho

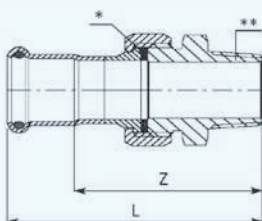

* EPDM
** Inoxidable AISI-316L

| Código | D mm | L mm | Z mm | Ø mm | Uds. |
|--------------|-----------|------|------|------|------|
| 26R3PM015015 | 15-1/2" | 77 | 56 | 30 | 1 |
| 26R3PM018015 | 18-1/2" | 77 | 56 | 30 | 1 |
| 26R3PM022020 | 22-3/4" | 81 | 59 | 36 | 1 |
| 26R3PM028025 | 28-1" | 90 | 67 | 46 | 1 |
| 26R3PM035032 | 35-1.1/4" | 101 | 74 | 52 | 1 |
| 26R3PM042040 | 42-1.1/2" | 102 | 71,5 | 64 | 1 |
| 26R3PM054050 | 54-2" | 111 | 77 | 81 | 1 |



Racor 3 piezas rosca hembra

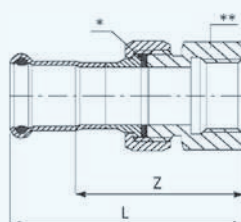

* EPDM
** Inoxidable AISI-316L

| Código | D mm | L mm | Z mm | Ø mm | Uds. |
|--------------|-----------|------|------|------|------|
| 26R3PH015015 | 15-1/2" | 71 | 50 | 30 | 1 |
| 26R3PH018015 | 18-1/2" | 72 | 51 | 30 | 1 |
| 26R3PH022020 | 22-3/4" | 76 | 54 | 36 | 1 |
| 26R3PH028025 | 28-1" | 83 | 60 | 46 | 1 |
| 26R3PH035032 | 35-1.1/4" | 93 | 66 | 52 | 1 |
| 26R3PH042040 | 42-1.1/2" | 93 | 62,5 | 64 | 1 |
| 26R3PH054050 | 54-2" | 111 | 77 | 81 | 1 |



Manguito multitoma





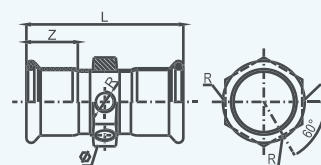

















| Código | D mm | L mm | Z mm | R bsp | Ø mm | Uds. |
|----------|------|------|------|-------|------|------|
| 26MMT035 | 35 | 128 | 26 | 1/2" | 60 | 1 |
| 26MMT042 | 42 | 135 | 30 | 1/2" | 60 | 1 |
| 26MMT054 | 54 | 135 | 35 | 1/2" | 74 | 1 |
| 26MMT076 | 76 | 190 | 55 | 1/2" | 92 | 1 |
| 26MMT088 | 88 | 210 | 60 | 1/2" | 106 | 1 |
| 26MMT108 | 108 | 240 | 75 | 1/2" | 130 | 1 |
| | | | | | | |
| | | | | | | |
| | | | | | | |



Nº de tomas según cota R: 3 Ud.

SISTEMA DE PRENSAR EN CUPRONIQUEL



| | | | | |
|---|---|---|--------------------------|---------------|
|  |  | GIUNTI MECCANICI PER TUBOLATURE - MARINEPRES MECHANICAL JOINTS FOR PIPES - MARINEPRES | MAC - 067019CS/001 - 002 | Ø 15 - 108 mm |
|  |  | RACCORDI A PRESSARE IN CUPRONICHEL / CUPRONICKEL PRESSFITTINGS PRODOTTI E COMPONENTI UTILIZZATI A CONTATTO CON ACQUA POTABILE PRODUCT AND ELEMENTS IN CONTACT WITH DRINKING WATER | ICIM - CAP - 009671 - 00 | Ø 15 - 108 mm |
|  |  | TUBE FITTINGS - MARINEPRES | TAP 000007B | Ø 15 - 108 mm |
|  |  | PIPE, DUCT, TRUNK - MARINEPRES | MEDB 00007F1 | Ø 15 - 108 mm |
|  |  | PRESS FIT SYSTEM OF COMPRESSION TYPE FOR PIPING SYSTEMS | 15/20055 (E1) | Ø 15 - 108 mm |
|  |  | MARINEPRES PIPE PENETRATION (STANDARD FIRE TEST) Ø 15 - 108 MM  | MED D000027 V | Ø 15 - 108 mm |
|  |  | PIPE COUPLING WITH O-RING SEAL MARINEPRES SYSTEM | 38059/BO BV | Ø 15 - 108 mm |
|  |  | MARINEPRES, PIPING SYSTEM AND FITTING | 19-GE1920312-PDA | Ø 15 - 108 mm |
|  |  | MARINEPRES, MECHANICAL JOINTS | ML 20PTB00014 | Ø 15 - 108 mm |
|  |  | MARINEPRES PRESSFITTING SYSTEM | POCC IT.AM05 H05079 | Ø 15 - 108 mm |