



Stadium 205

Technical specifications

› **Structure**

- Made of tube and steel plate arc welding with continuous wire.

› **Paint**

- Indoor: Electrostatic polyester powder.
- Outdoor: Electrostatic polyester powder (with electrolytic coating)
- Coating thickness:
 - Indoor: 70-80 microns.
 - Outdoor: 90-100 microns.
- Grid adherence according UNE-EN ISO 2409: 100%.

› **Polypropylene**

- Material:
 - Indoor: Copolymer Polypropylene IF-727.
 - Outdoor: Copolymer Polypropylene IF-728 with U.V colour stabilisers.
- Tensile stress at yield according ISO 527-2: 26 Mpa.
- Tensile modulus according ISO 527-2: 1250 Mpa.

› **Fire rating**

- BS 5852. Clause 12. Ignition Sources 0, 1 and 5. (With approved fabric)
- USA: CAL T.B. 133 (With approved fabric).

General dimensions

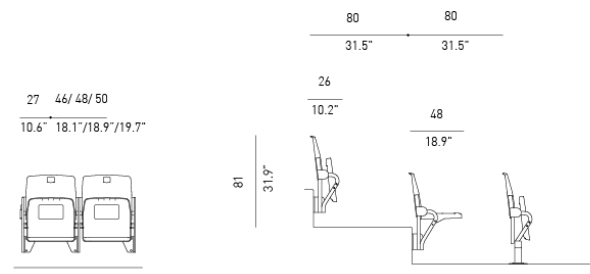

Stadium 204

Mod. 208

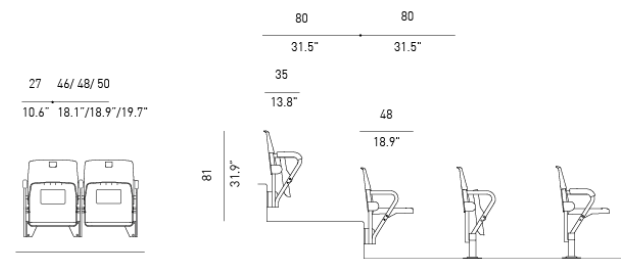

Stadium 205

Mod. 206 Mod. 207 Mod. 209

However, for the purpose of facilitating to the customer the latest novelties, FIGUERAS reserves the right to introduce the modifications and variations that it considers most appropriate and suitable for marketing its products.

General description

› Automatic gravity-folding seating system designed for indoor and outdoor use in stadiums, sports centres, gymnasiums and, in general, in all types of sports facilities. It complies with the features recommended by FIFA.



· The seat consists of two independent elements (seat and backrest) attached to metal structures adapted to the characteristics of the seating tier. With this system a great freedom of aisle between the rows is obtained without harming the comfort of the user. In addition, the accumulation of dirt on the seat is prevented, reducing the need for maintenance of the installation.

· Seat and backrest are made of injection-moulded Polypropylene Copolymer.

· The backrest has a housing to accommodate a numbered plate, preventing it from being torn off. With this system, the visibility of the seat number is optimal. The seat has anti-slip herringbone stripes for correct positioning of the user.

· At the front of the seat and at the back of the backrest there is a space of 130 x 220 mm. which allows advertising and image elements to be inserted, usually on a screen-printed adhesive support. This space is dimensioned to accommodate up to 50 adhesive units without having to remove the old one to place the new one.

· Optionally, you can incorporate a cup holder in the back space between backrests. In this way, the user has easy access to the cup holder and the correct visibility of the advertising inserted in the back of the seat is not prevented.

· The seat pivots on two axes, which are connected to the structure without maintenance. The folding of the seat is automatic by gravity, without mechanisms, exempt of any type of maintenance and, therefore, of great durability.

· The metal counterweight for automatic return is located at the bottom of the seat. It's totally protected from outside agents. The backrest is attached to the lateral structure by means of special screws that are housed inside and blocked.

· The anchorage is carried out on the riser of the bleachers. The side structures consist of an oval steel tube that acts as an armrest. In its lower part they end in a plate that forms an angle of 90° with three points of anchorage to the tier. The support is fixed to the bleacher by means of expansion plugs. The depth of the entire assembly with the seat folded is only 350 mm. The wheelbase is fixed at 500mm.

· A PUR armrest is available.

Materials and finishes

› Characteristics of plastic parts

· High pressure injection moulded polypropylene copolymer high impact casing. High durability pigmented coloured plastic.

› Pigments for plastic parts



› Pigments for metal parts

