

## FASCIA SHADE INSTALLATION GUIDE

Thank you for your purchase! This will guide you through the Fascia style shade installation process. If you ever need any help throughout, reach out to us at (417) 553-0504.

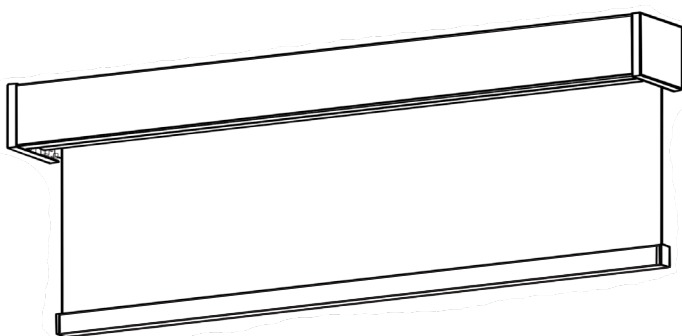

Before installing the Fascia style roller shade, Please have measurements from your order handy. Your shade will come labeled with the room name and shade name on the outside of the box to help you correctly identify the shade.



### REQUIRED TOOLS AND HARDWARE

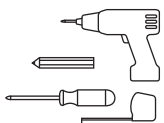

SCREWS



FASCIA



IDLER PIN

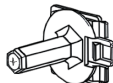

BRACKET



END CAPS

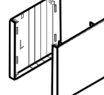

FILL-UP RING



### INSTALLATION

#### STEP 1

Determine the correct window for the shade to be installed and whether the shade was ordered to be inside or outside mounted. Please also consider the control side of the shade. You can reference the packaging of the shade or you can refer to your order on the PowerShades Portal for this information.

## STEP 2

Before installation, its a good idea to pre-assemble the shade. Start by attaching the idler pin into the idler side bracket.

- 1 Slide the idler pin into the middle prong of the bracket.
- 2 Screw it in tightly to secure the pin.

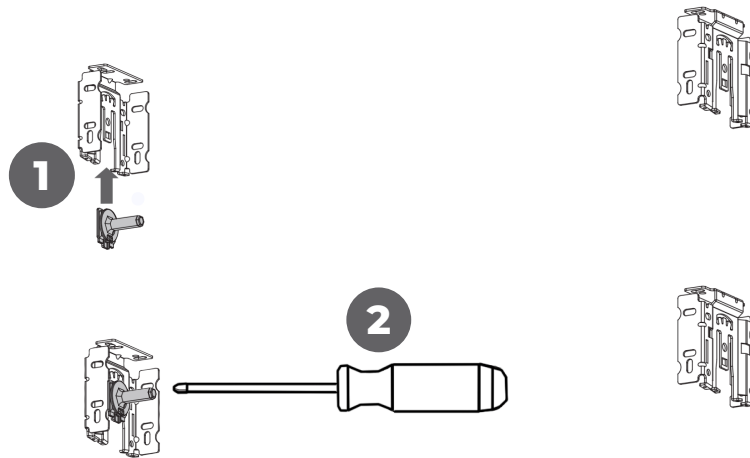

! For lighter-duty shades, such as manual and small motorized shades. The idler pin will only need to snap into the bracket and will not come with a screw-head.

## STEP 3

Apply the fill-up ring to the attached idler pin. This piece of hardware is used to balance the light-gap of the shade. This is only used for motorized shades.

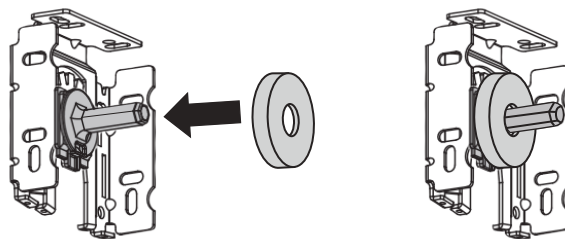

! For an optimal balanced light gap and function, the direction of the fill-up ring needs to be applied with the concaved inner ring side facing the bracket.

#### STEP 4

Once the hardware is preassembled, confirm that your measurements are correct. After confirmation, the shade is ready to be mounted.

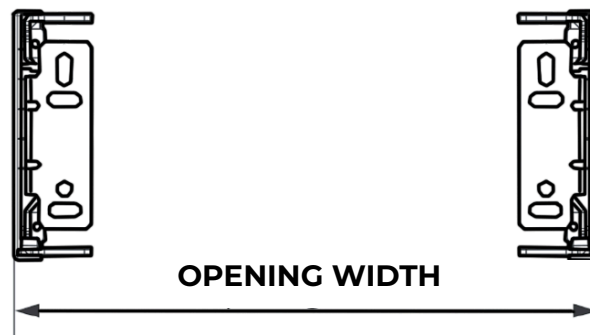

It is encouraged to dry-fit the shade before any holes are drilled. This will ensure that the fully assembled shade will fit in the window and will assist in marking your drill holes.

#### STEP 5

Pre-drill and screw the brackets onto the left and right-hand side at the top of the window jamb, level and respective to measurements.

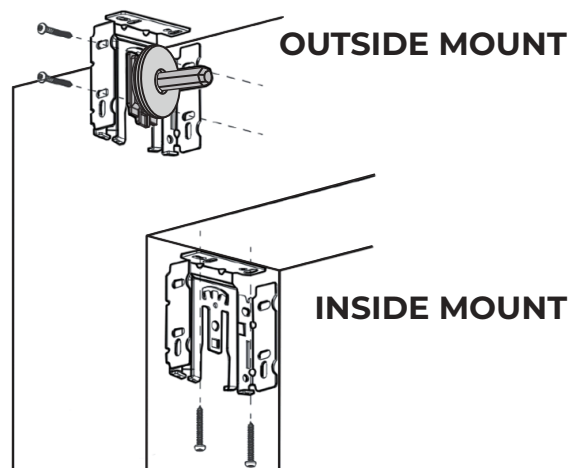

You may need to detach your idler pin to screw in your bracket if you are not able access your screw. Reattach the pin when done.

## STEP 6

Mount the shade onto the brackets

- 1 Mount the idler side of the shade onto the idler pin bracket.
- 2 Lift the control-side of the shade and connect the clip to the middle prong of the bracket securing the shade.

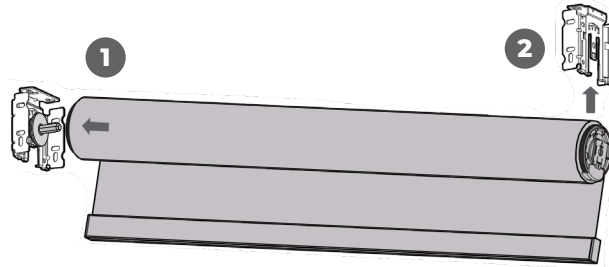

## REMOVE TENSION CLIP (MANUAL SPRING-OPERATED SHADES ONLY)

When mounting the control-side of the shade and connecting the clip to the middle prong of the bracket, the spring tension clip (shown in red) should pop out from the spring drive. This is normal and needs to happen for the shade to operate. The purpose of this tension clip is to maintain the shade's tension through shipment.

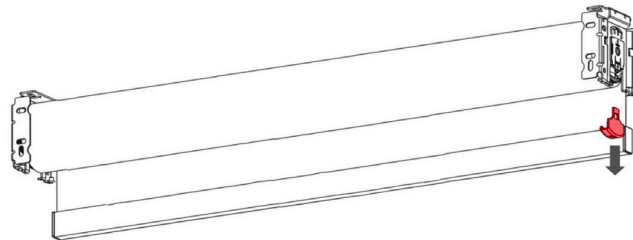

## STEP 7

To attach the fascia cover, place it over the brackets at an angle at each end then pivot the fascia down to snap to the bottom of the brackets.

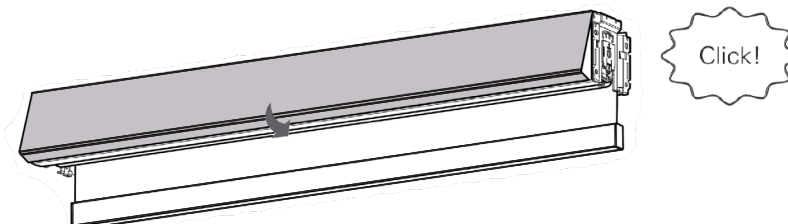

## STEP 8

If you ordered the shade with end caps, snap the end caps to each side of the shade. Our Fascia end caps are designed to be cut and altered to cover peeking brackets in inside mount applications.

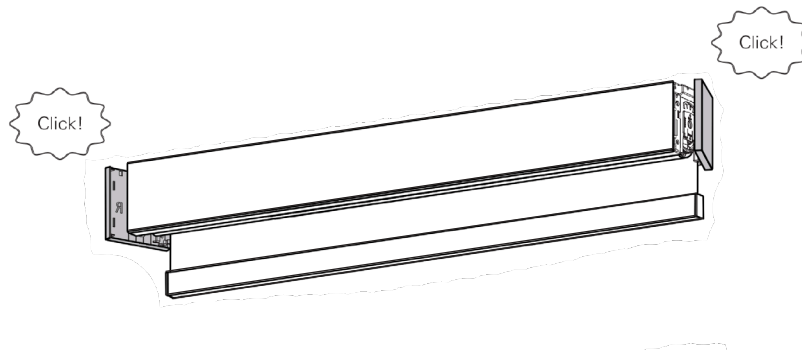

## SPRING ADJUSTMENTS (MANUAL SPRING-OPERATED SHADES ONLY)

PowerShades' manual spring-pull shades come pre-tensioned with limits already set based on the measurements when ordered through the portal. If the installer needs to make any adjustments to these, please see tips below.

### ADJUST SHADE TENSION

ADD tension to the shade by turning the spring head on the drive side **CLOCKWISE**.

LOWER tension of the shade by turning the spring head on the drive side **COUNTER CLOCKWISE**.

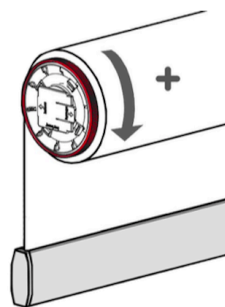

ADD TENSION

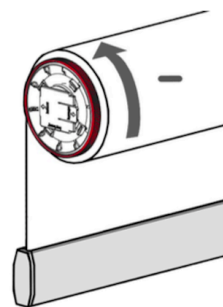

LOWER TENSION

Installers must strictly follow the instructions outlined in our installation guide. Failure to adhere to these guidelines could compromise the structural integrity of the shade, potentially resulting in malfunction, property damage, personal injury, or even death.