



CS1 ST WASHER DISINFECTOR

Digital Temperature Display



Lid

Generator Reset Button



Override Keys
To be kept in a safe place

Control Panel
Hands Free Display for Visible Disinfection

Serial Number Badge

Foot Pedal

OPERATION MANUAL

CONTACT DETAILS

SALES



01689 806500



sales@stanbridge.co.uk

SPARES:



01689 806500



spares@stanbridge.co.uk

SERVICE:



01689 806500



service@stanbridge.co.uk



OFFICE ADDRESS

Stanbridge Ltd.
Unit 78
Powder Mill Lane, Questor
Dartford, Kent
DA1 1JA



WEBSITE

www.stanbridge.co.uk

FIND US ON:



WARNING

- Do not attempt to use this machine until it has been correctly installed in accordance with our installation manual.
- Please read the instruction details before attempting to run the machine.
- An A4 laminated loading chart is included with each machine – Please fix this to a wall close to the machine and ensure it is visible to bedpan washer operatives.
- Only use cleaning agents and equipment designed for cleaning Stainless Steel to clean the exterior of this machine.
- Please complete weekly maintenance checks on the laminated chart that has been supplied along with this operational manual.

GUARANTEE

- All Stanbridge products are thoroughly checked before leaving our site.
- Each machine is subjected to actual operational tests, during which a large number of complete cycles are undertaken whilst the machine is 'in situ' in our own in-house sluice room.
- Should any component fail due to faulty manufacture or workmanship within twelve months of the dispatch date from our factory, the faulty component must be returned to us for inspection, and a replacement will be sent to you Free of Charge to the original delivery address.

TO OPEN MACHINE

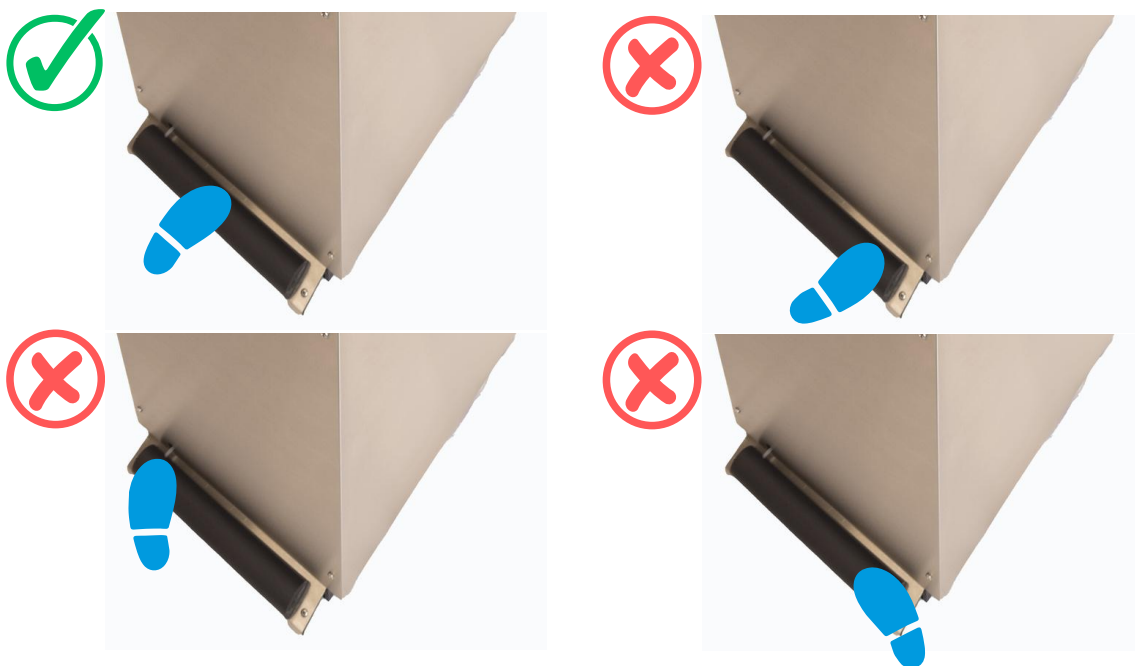

- To open the machine press foot in centre of bar as pictured.
- Please ensure your foot is placed in the centre of the pedal and fully over the pedal bar.



OPERATING INSTRUCTIONS

**DO NOT SCRUB POTS AND BEDPANS BEFORE PLACING IN BEDPAN WASHER
IF USING SAFETY GEL PRE EMPTY PAN OR BOTTLE IN SLUICE SINK & RINSE**

- Press foot pedal in Centre of bar to open as shown below.
- Place bedpan and contents directly into bedpan washer as shown below.
- Ensure bedpan is secured in machine cage and is facing jet.
- Close lid - **DO NOT SLAM**.
- Select Wash Program:

For Bottle, PRESS	
For Soiled Pans, PRESS	

- Remove gloves/apron and place in appropriate waste bin.
- Decontaminate hands thoroughly using designated hand wash basin.

ONLY HUMAN WASTE AND TOILET TISSUE IN PAN
Do NOT place ANY other items in the machine

- Once the machine has finished its cycle release the lid with the foot pedal as shown below.
- Remove utensils and place them on a rack to dry.

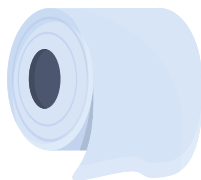

OPERATING INSTRUCTIONS

The washer disinfector in this manual is intended to wash and disinfect the utensils shown on the data sheet provided on page 6. Please see the below given examples of correct loading applications for your CS1 Model:



PLEASE CHECK THE COMMODE POT HANDLE IS SECURELY POSITIONED ABOVE THE POT AS SHOWN

IF USING SAFETY GEL PLEASE PRE-EMPTY PAN OR BOTTLE IN SLUICE SINK AND RINSE ENSURING ALL GEL IS REMOVED



OPERATING INSTRUCTIONS

ONLY Stanbridge approved utensils should be used in the machine, incorrect utensils could result in inadequate cleaning disinfection. The machine could also become damaged due to incorrect loading which could affect your warranty.



OPERATING INSTRUCTIONS

DO **NOT** place **ANY** other items in the machine.



No Gloves or
Aprons



No Syringes



No Plastic Bags

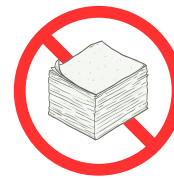

No Paper
Towels



No Nappies or
Pads



No Cotton
Buds or Swabs



No Wet
Wipes

OPERATING AND CYCLE DETAILS

This machine has been designed to include the following features:-

- Bottle Wash
- Pan Wash
- Disinfection - 80c for 70 seconds (machine reaches 85C)
- Integral programmer with fault finding

MACHINE READY

WASH

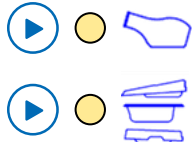

BOTTLE WASH - CYCLE RUNNING

WASH

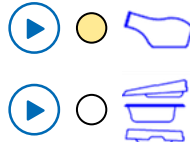

PAN WASH - CYCLE RUNNING

WASH



BOTTLE WASH

- Press bottle wash button

Machine will go through the following cycles:

- Pulsed Cold Wash - 5 seconds on 5 seconds off (8 times) or 40 seconds single cold.
- Hold. Machine stops until 80C has been achieved inside the canister.
- Once 80-85C has been achieved -disinfection takes place for 70 seconds.
- Cold Rinse - 5 seconds or 10 seconds single cold or hot wash.
- Cycle complete – After a slight delay the Lid can be opened.

PAN WASH

- Press pan wash button

Machine will go through the following cycles:

- Cold water flush wash
- Pulsed Cold Wash - 5 seconds on 5 seconds off (8 times) or 40 seconds single cold. Hold.
- Machine stops until 80C has been achieved inside the canister.
- Once 80-85C has been achieved - disinfection takes place for 70 seconds. Cold
- Rinse - 5 seconds or 10 seconds single cold or hot wash.
- Cycle complete - After a slight delay the Lid can be opened.



SPECIFICATION

UTENSIL LOAD CAPACITY	CS1	CS2
Slipper Pan	1	2
In Bed Pan	1	2
Commode Pot & Lid	1	2
Square Basin*	1	1
Commode Insert Pan	1	2
Support Carrier*	1	2
White Commode Pot & Lid	1	2
Grey Commode Pot	1	1
Urine Bottle	1	1
Cycle Times (estimated)	6-12mins	6-12mins
Washing Cycles	2	2
Water Supply	Cold	Cold
Electrcial Supply (single phase)	230V/50Hz/16a	230V/50Hz/16a
Stainless Steel Panels	YES	YES
Dimensions H x W x D (mm)	915 x 435 x 655	915 x 435 x 655
Nett Weight (kg)	77	77

Subject to change without notification. Cycle times are estimated and vary

*May require a special cage



MACHINE MAINTENANCE CHECKLIST

MACHINE SERIAL NO. :

WEEKLY MAINTENANCE CHECKLIST	SIGN DATE						
Details							
Check operation of machine - run one cycle							
Check door for water leaks							
Check disinfection temperature on digital is 85							
Check overall condition of machine							
Check all panels are clean							
Check no screws are missing from panels							
Check foot switch works and is clean							
Check condition of utensils - replace if required							
After cycle has finished, open door and:							
Check condition of seal							
Check condition of carrier							
Check rotating jet(s) are free to spin							
Check jet(s) are not blocked							
Check cleanliness of chamber							
Dosing system:							
Check the liquid level - top up if required							
Check operation of dosing pump							

